

LEE-HI INDUSTRIAL PARK

2711 Dorr Avenue, Fairfax, Virginia

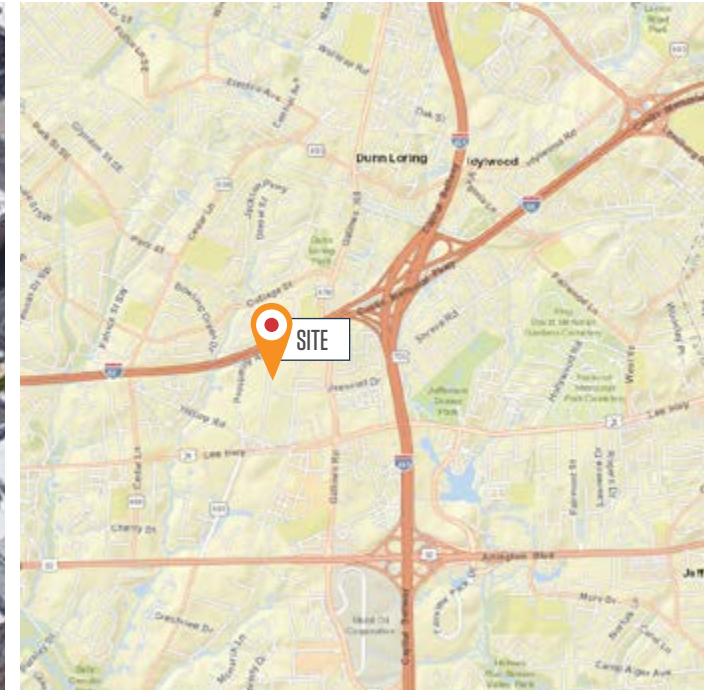

WAREHOUSE FOR LEASE

AVAILABILITY:

Suite J & H - 1,680-3,360 SF

- \$18.50 PSF IG + CAM (\$1.74 PSF estimated)
- Drive-In & Loading Dock

PROPERTY FEATURES:

- Available Immediately
- Zoning: I-4, Fairfax County
- 16' Ceiling Height
- Conveniently located in the heart of Merrifield, within walking distance to Dunn Loring/Merrifield Metro and close to I-495, I-66, and Route 50
- Restaurants, Retail, & Hotels within walking distance

Ryan Moody
rmoody@klnb.com
703-268-2739

8065 Leesburg Pike, Suite 700
Tysons, VA 22182
klnb.com



LEE-HI INDUSTRIAL PARK

2711 Dorr Avenue, Fairfax, Virginia

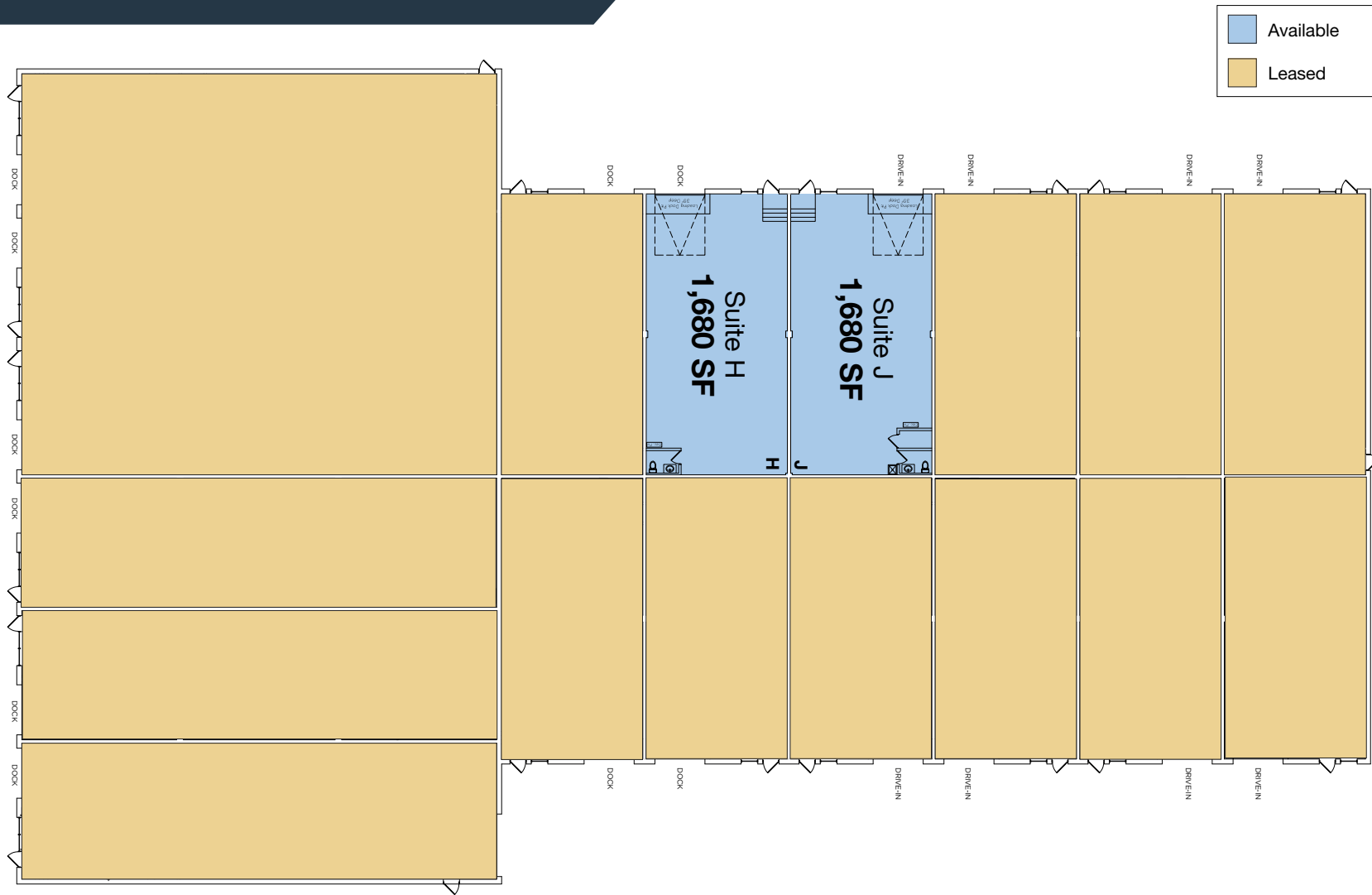

FLOOR PLAN

[VISIT PROPERTY WEBSITE](#)



facebook.com/KLNB



@KLNBLCC



linkedin.com/company/klnb



instagram.com/klnbllc

While we have no reason to doubt the accuracy of any of the information supplied, we cannot, and do not, guarantee its accuracy. All information should be independently verified prior to a purchase or lease of the property. We are not responsible for errors, omissions, misuse, or misinterpretation of information contained herein and make no warranty of any kind, express or implied, with respect to the property or any other matters.