

OFFICE/WAREHOUSE

7380 Coca Cola Drive, Hanover, MD 21076
Anne Arundel County

14,800 SF AVAILABLE



FOR SUBLEASE

- **Location:** Great location just off of Route 100, minutes to I-295, I-695, & I-95
- **Office Area:** 9,935 SF
- **Warehouse:** 4,865 SF
- **Total:** 14,800 SF
- **Sublease Expiration:** April 30, 2020
- **Ceiling Height:** 16 foot clear warehouse; 10 foot clear office

- **Taxes & CAM:** \$3.17 per SF
- **Heating:** Gas
- **Zoning:** Howard County, M-2 zoning
- **Loading Docks:** Two (2)
- **Parking:** 4.11/1000 SF
- **HVAC:** Individually controlled & separately metered
- **Distance:** 2.9 miles to Arundel Mills Mall & 4.7 to BWI

Abby Glassberg
aglassberg@klnb.com
443-574-1433

Chuck Breitenother
cbreitenother@klnb.com
443-574-1422

6011 University Blvd, Suite 350
Ellicott City, MD 21043
klnb.com



OFFICE/WAREHOUSE

7380 Coca Cola Drive, Hanover, MD 21076
Anne Arundel County

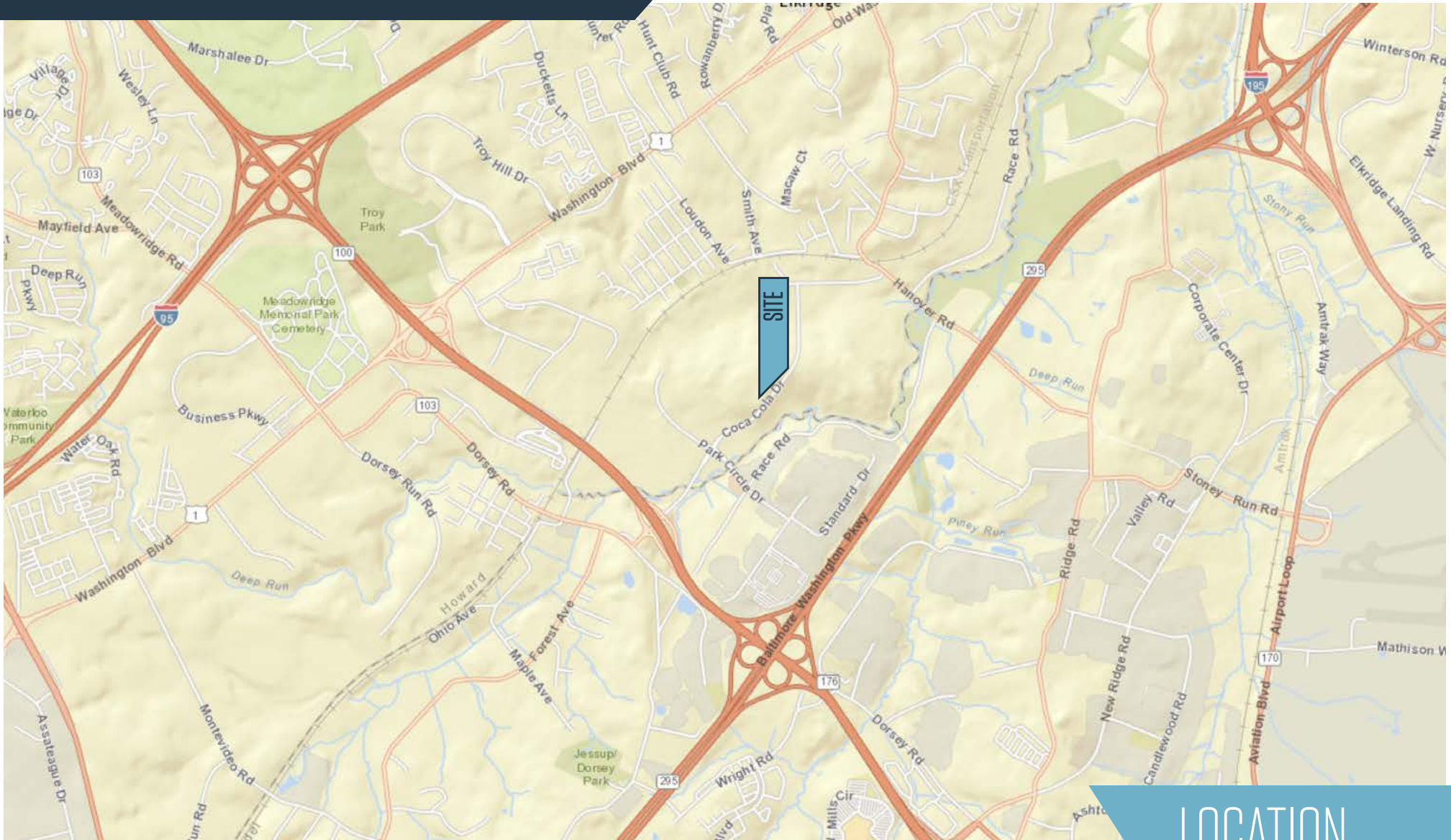

LOCATION

Abby Glassberg
aglassberg@klnb.com
443-574-1433

Chuck Breitenother
cbreitenother@klnb.com
443-574-1422

6011 University Blvd, Suite 350
Ellicott City, MD 21043
klnb.com



OFFICE/WAREHOUSE

7380 Coca Cola Drive, Hanover, MD 21076
Anne Arundel County



7380 - Building A	Office/Flex	85,080 SF
7390 - Building B	Office/Flex	54,000 SF

SITE PLAN

Abby Glassberg
aglassberg@klnb.com
443-574-1433

Chuck Breitenother
cbreitenother@klnb.com
443-574-1422

6011 University Blvd, Suite 350
Ellicott City, MD 21043
klnb.com



OFFICE/WAREHOUSE

7380 Coca Cola Drive, Hanover, MD 21076
Anne Arundel County

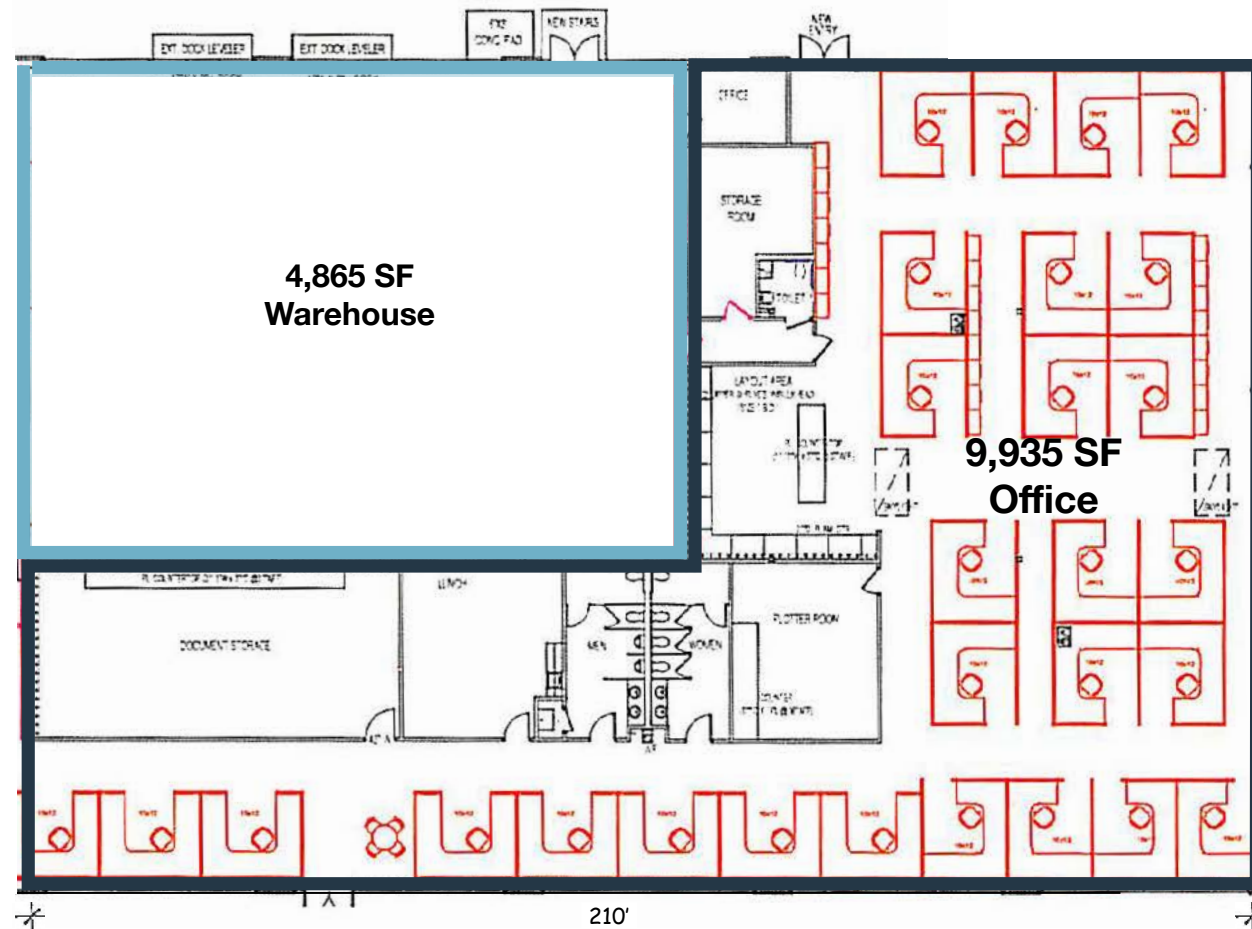

FLOOR PLAN

Abby Glassberg
aglassberg@klnb.com
443-574-1433

Chuck Breitenother
cbreitenother@klnb.com
443-574-1422

6011 University Blvd, Suite 350
Ellicott City, MD 21043
klnb.com



OFFICE/WAREHOUSE

7380 Coca Cola Drive, Hanover, MD 21076
Anne Arundel County

CLICK TO VIEW PROPERTY WEBSITE

For More Information, Please Contact:

Abby Glassberg

aglassberg@klnb.com
443-574-1433

Chuck Breitenother

cbreitenother@klnb.com
443-574-1422

6011 University Boulevard, Suite 350
Ellicott City, MD 21043

klnb.com

 facebook.com/KLNB

 [@KLNBLLC](https://twitter.com/KLNBLLC)

 linkedin.com/company/klnb

 instagram.com/klnbllc

While we have no reason to doubt the accuracy of any of the information supplied, we cannot, and do not, guarantee its accuracy. All information should be independently verified prior to a purchase or lease of the property. We are not responsible for errors, omissions, misuse, or misinterpretation of information contained herein and make no warranty of any kind, express or implied, with respect to the property or any other matters.

NAI klnb