

EASTPOINT MALL

7839 Eastpoint Mall, Baltimore, MD 21224
Baltimore County



RETAIL FOR LEASE



- AVAILABLE SPACE: 5,779 SF former restaurant, 6,000 SF former Bank
- 857,366 square foot regional mall
- Strategically positioned at the intersection of Eastern Avenue and North Point Boulevard
- Minimal competition in the trade area



Matt Copeland
mcopeland@klnb.com
443-632-2051

100 West Road, Suite 505
Towson, MD 21204
klnb.com

klnb

EASTPOINT MALL

7839 Eastpoint Mall, Baltimore, MD 21224
Baltimore County

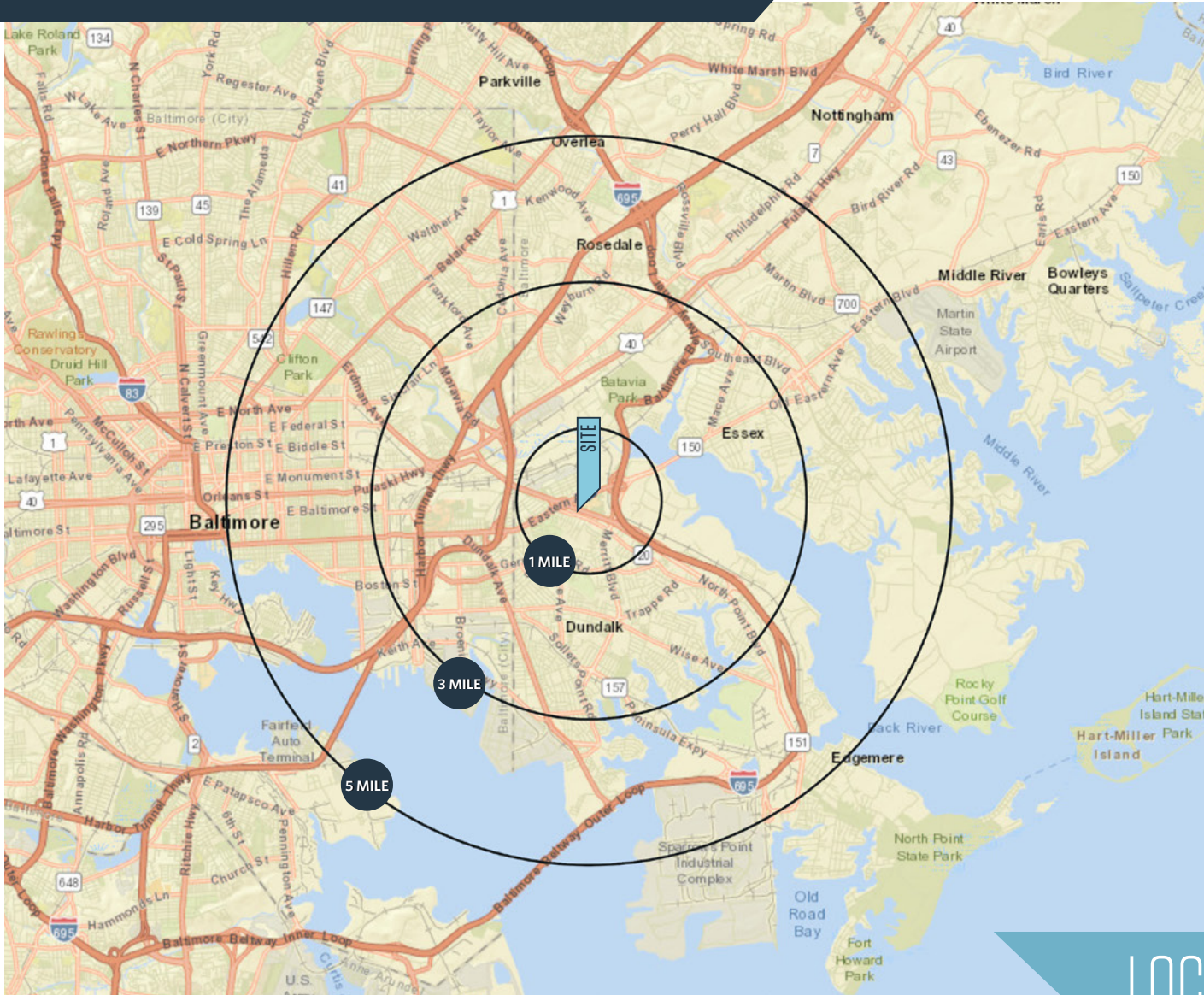

AVAILABLE SPACE

5,779 SF Applebee's Space
6,000 SF Bank of America Space

DEMOGRAPHICS | 2019:

	1-MILE	3-MILE	5-MILE
Population	12,113	110,887	328,629
Daytime Population	6,765	48,451	139,783
Households	4,403	42,656	128,416
Average HH Income	\$64,311	\$64,517	\$75,569

[CLICK TO DOWNLOAD DEMOGRAPHIC REPORT](#)

TRAFFIC COUNTS | 2016:

North Point Blvd	30,892 ADT
Eastern Ave	27,711 ADT

LOCATION & DEMOGRAPHICS

Matt Copeland
mcopeland@klnb.com
443-632-2051

100 West Road, Suite 505
Towson, MD 21204
klnb.com

klnb

EASTPOINT MALL

7839 Eastpoint Mall, Baltimore, MD 21224
Baltimore County

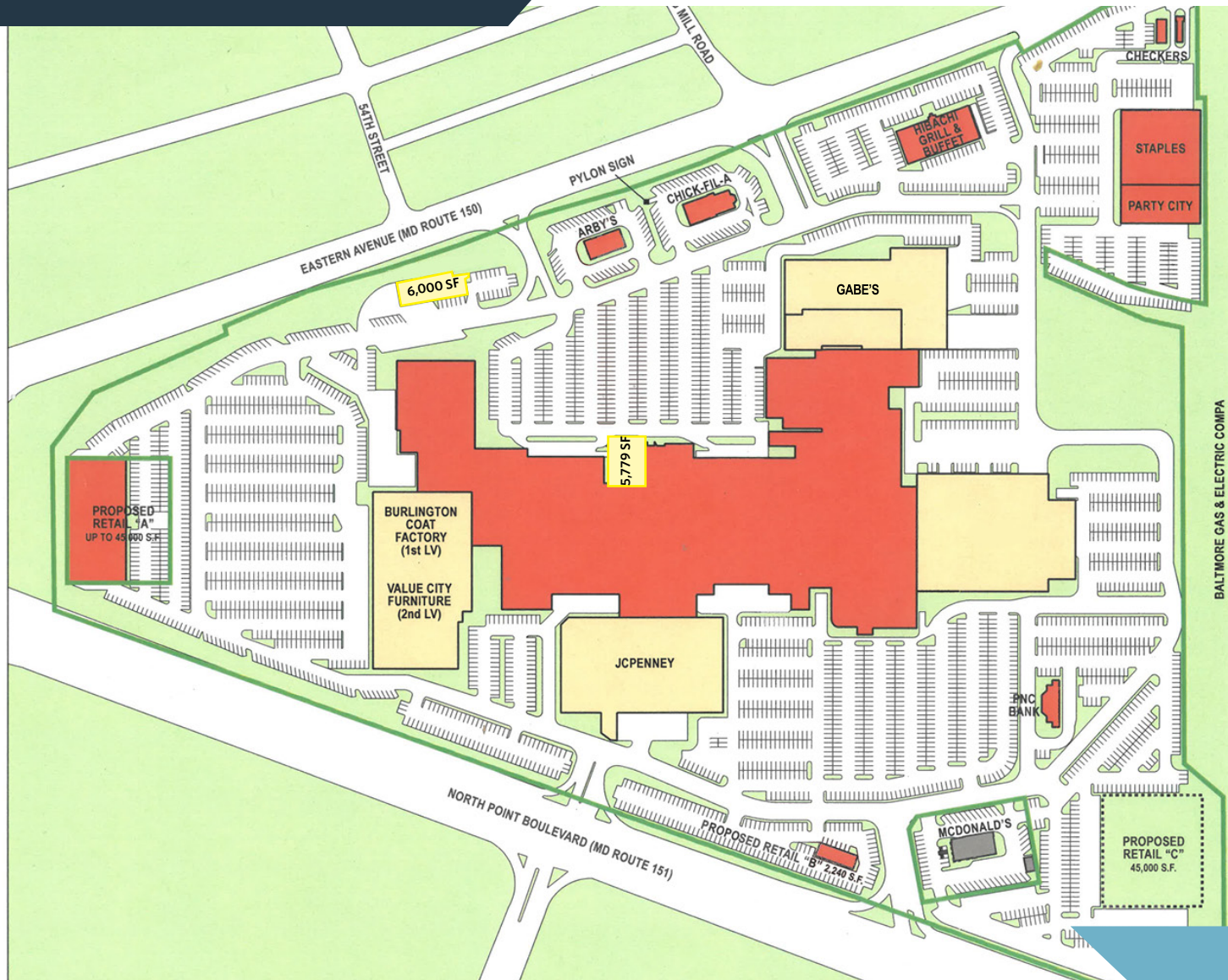

SITE PLAN

Matt Copeland
mcopeland@klnb.com
443-632-2051

100 West Road, Suite 505
Towson, MD 21204
klnb.com

klnb

EASTPOINT MALL

7839 Eastpoint Mall, Baltimore, MD 21224
Baltimore County

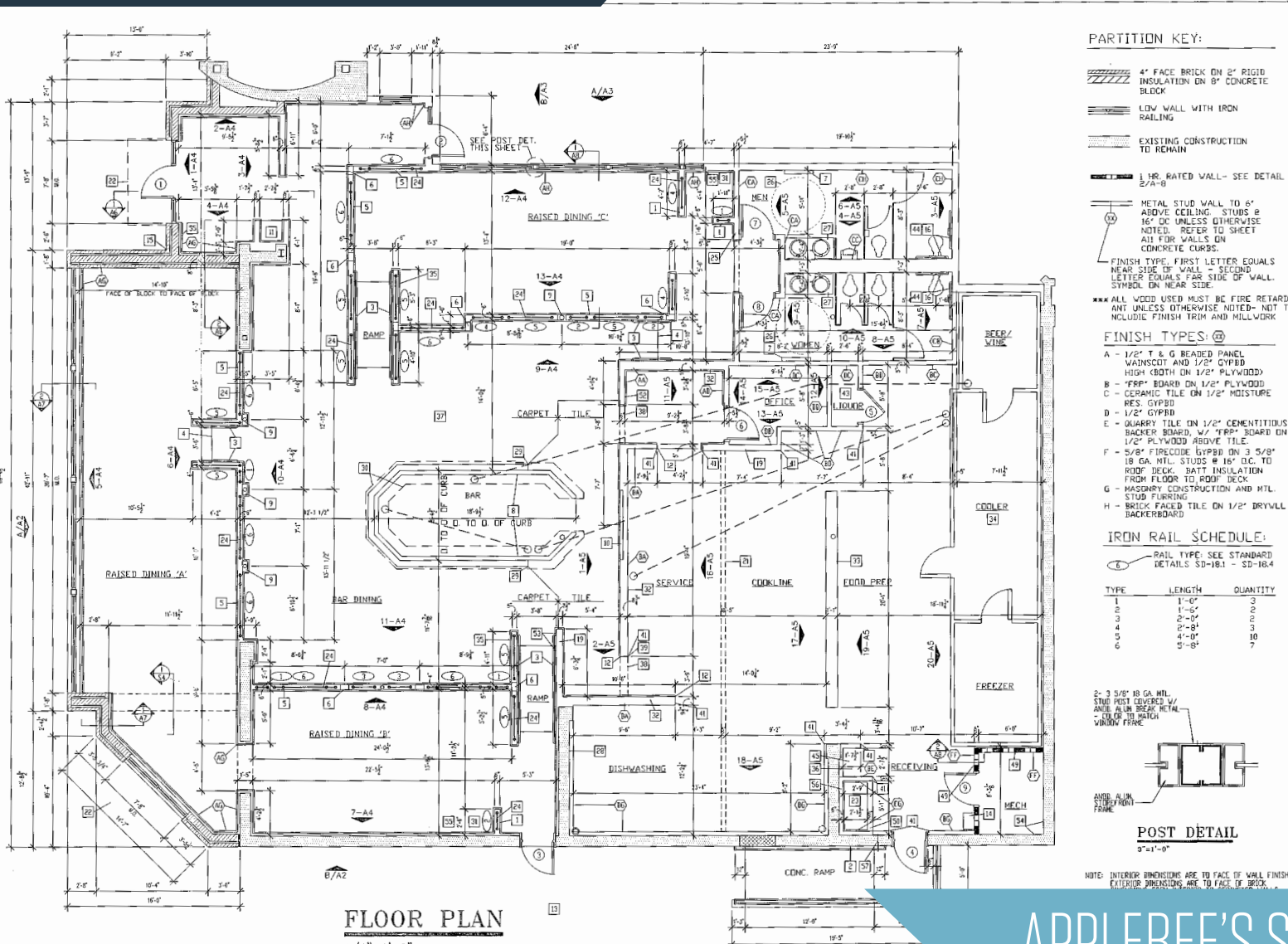

PARTITION KEY:

- 4" FACE BRICK ON 2" RIGID INSULATION ON 8" CONCRETE SLAB
- LOW WALL WITH IRON RAILING
- EXISTING CONSTRUCTION TO REMAIN
- 1 HR. RATED WALL - SEE DETAIL 27A-B
- METAL STUD WALL TO 6" ABOVE CEILING. STUDS @ 16" OC UNLESS OTHERWISE NOTED. REFER TO SHEET A11 FOR WALLS ON CONCRETE CURBS.
- FINISH TYPE, FIRST LETTER EQUALS NEAR SIDE OF WALL - SECOND LETTER EQUALS FAR SIDE OF WALL. SYMBOL ON NEAR SIDE.

FINISH TYPES:

- A - 1/2" T & G BEADED PANEL WAINSCOT AND 1/2" GYPB HIGH-BOTTOM ON 1/2" PLYWOOD
- B - "FRP" BOARD ON 1/2" PLYWOOD
- C - CERAMIC TILE ON 1/2" MOISTURE RES. GYPB
- D - QUARRY TILE ON 1/2" CEMENTITIOUS BACKER BOARD, W/ "FRP" BOARD ON 1/2" PLYWOOD ABOVE TILE.
- F - 5/8" FIRECODE GYPB ON 3 5/8" 18 GA. MIL. STUDS @ 16" OC TO ROOF DECK. BATT INSULATION FROM FLOOR TO ROOF DECK.
- G - MASONRY CONSTRUCTION AND MTL. STUD FURRING
- H - BRICK FACED TILE ON 1/2" DRYVLL BACKERBOARD

IRON RAIL SCHEDULE:

RAIL TYPE: SEE STANDARD DETAILS SD-18.1 - SD-18.4

TYPE	LENGTH	QUANTITY
1	1'-0"	2
2	1'-5"	2
3	2'-0"	3
4	2'-8"	3
5	4'-0"	10
6	5'-8"	7

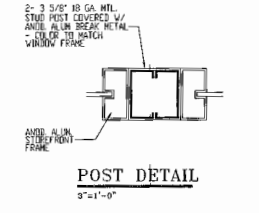

NOTE: INTERIOR DIMENSIONS ARE TO FACE OF WALL FINISH EXTERIOR DIMENSIONS ARE TO FACE OF BRICK

NOTES

1. LOW PARTITION, REFER TO STANDARD DETAIL SD-18.1
2. 2" ABOVE PARTITION 2x6 MOUNTED ON 2"x4 ABOVE PARTITION WITH 2" HOOKS FOR MET WALLS
3. HORIZONTAL, REFER TO STANDARD DETAIL SD-18.1
4. 2" ABOVE PARTITION 2x6 MOUNTED ON 2"x4 ABOVE PARTITION WITH 2" HOOKS FOR MET WALLS
5. LOW PARTITION, REFER TO STANDARD DETAIL SD-18.1
6. COLUMN, REFER TO STANDARD DETAIL SD-18.1
7. SUPPORT JOISTING PANEL, REFER TO STANDARD DETAIL SD-18.1
8. 2" ABOVE PARTITION 2x6 MOUNTED ON 2"x4 ABOVE PARTITION WITH 2" HOOKS FOR MET WALLS
9. 2" ABOVE PARTITION 2x6 MOUNTED ON 2"x4 ABOVE PARTITION WITH 2" HOOKS FOR MET WALLS
10. REFER TO STANDARD DETAIL SD-18.1
11. METAL STUD WALL, REFER TO STANDARD DETAIL SD-18.1
12. END OF 1" x 6" BRICK PANELS
13. FINISH TYPE, FIRST LETTER EQUALS NEAR SIDE OF WALL - SECOND LETTER EQUALS FAR SIDE OF WALL. SYMBOL ON NEAR SIDE
14. "FRP" BOARD ON 1/2" PLYWOOD
15. 1/2" CONTROL JOINT
16. GRAN BOND REFER TO TOILET ACCESSORY SCHEDULE. SEE NOTE 44
17. NOT USED
18. NOT USED
19. 6" 18 GA. MIL. STUDS @ 16" OC
20. NOT USED
21. IMPROVE DETAIL. SEE ELEVATION W/ SHEET 20A-20B
22. LINE OF AWNING ABOVE
23. NOT USED
24. HORN PANELS, REFER TO SD-18.1 - SD-18.4
25. SEE 18-15 FOR FINISHING DETAIL
26. CLEAR TURNING CIRCLE FOR WHEELCHAIRS. SEE NOTE 44
27. VARIETY COUNTER TO STANDARD DETAIL SD-18.1
28. RETARDING PARTITION, REFER TO STANDARD DETAIL SD-18.1
29. END OF TILE TOP
30. 1/2" GYPB
31. REFER TO STANDARD DETAIL SD-18.1
32. 1/2" GYPB
33. REFER TO STANDARD DETAIL SD-18.1
34. REFER TO STANDARD DETAIL SD-18.1
35. REFER TO STANDARD DETAIL SD-18.1
36. REFER TO STANDARD DETAIL SD-18.1
37. REFER TO STANDARD DETAIL SD-18.1
38. REFER TO STANDARD DETAIL SD-18.1
39. REFER TO STANDARD DETAIL SD-18.1
40. REFER TO STANDARD DETAIL SD-18.1
41. REFER TO STANDARD DETAIL SD-18.1
42. NOT USED
43. UNDER STORAGE SHELVING, REFER TO STANDARD DETAIL SD-18.1
44. INSTALL 1/2" METAL FRAMING FLAT BETWEEN PARTITION AND METAL FRAMING FLAT FOR SECURE ANCHORAGE OF TOILET PARTITION. GRAN BOND REFER TO TOILET ACCESSORY SCHEDULE AND TOILET ACCESSORIES SCHEDULE FOR COMPLETE
45. ALUMINUM STUD FRAME
46. NOT USED
47. NOT USED
48. NOT USED
49. SEAL TOP OF WALL TO UNDERPIECE OF RECY & SEAL ALL WALL PENETRATIONS. SEE DETAIL SD-18.7 FOR CURB @ HOP BANK
50. NOT USED
51. REFER TO DETAIL SD-18.7 FOR CURB @ HOP BANK
52. SEE SD-22 & SD-23
53. REFER TO DETAIL SD-18.7 FOR CURB @ HOP BANK
54. REFER TO DETAIL SD-18.7 FOR CURB @ HOP BANK
55. REFER TO DETAIL SD-18.7 FOR CURB @ HOP BANK
56. REFER TO DETAIL SD-18.7 FOR CURB @ HOP BANK
57. REFER TO DETAIL SD-18.7 FOR CURB @ HOP BANK
58. REFER TO DETAIL SD-18.7 FOR CURB @ HOP BANK
59. REFER TO DETAIL SD-18.7 FOR CURB @ HOP BANK
60. REFER TO DETAIL SD-18.7 FOR CURB @ HOP BANK

PROPOSED NEW **Applebee's** RESTAURANT FOR
Rose Casual Dining, L.P.
ESSEX, MD.

CALENDA LAURO ARCHITECTS, P.C.
1700 GOLFVIEW AVENUE, SUITE 200
KENNETHWOOD, NEW JERSEY 07033
Tel: 908-245-8400 Fax: 908-245-8488
Suzanne A. Lynch, AIA, LEED AP # 0180-01

APPLEBEE'S SPACE PLAN

Matt Copeland
mcpeland@klnb.com
443-632-2051

100 West Road, Suite 505
Towson, MD 21204
klnb.com



EASTPOINT MALL

7839 Eastpoint Mall, Baltimore, MD 21224
Baltimore County



MARKET AERIAL

Matt Copeland
mcopeland@klnb.com
443-632-2051

100 West Road, Suite 505
Towson, MD 21204
klnb.com



EASTPOINT MALL

7839 Eastpoint Mall, Baltimore, MD 21224
Baltimore County

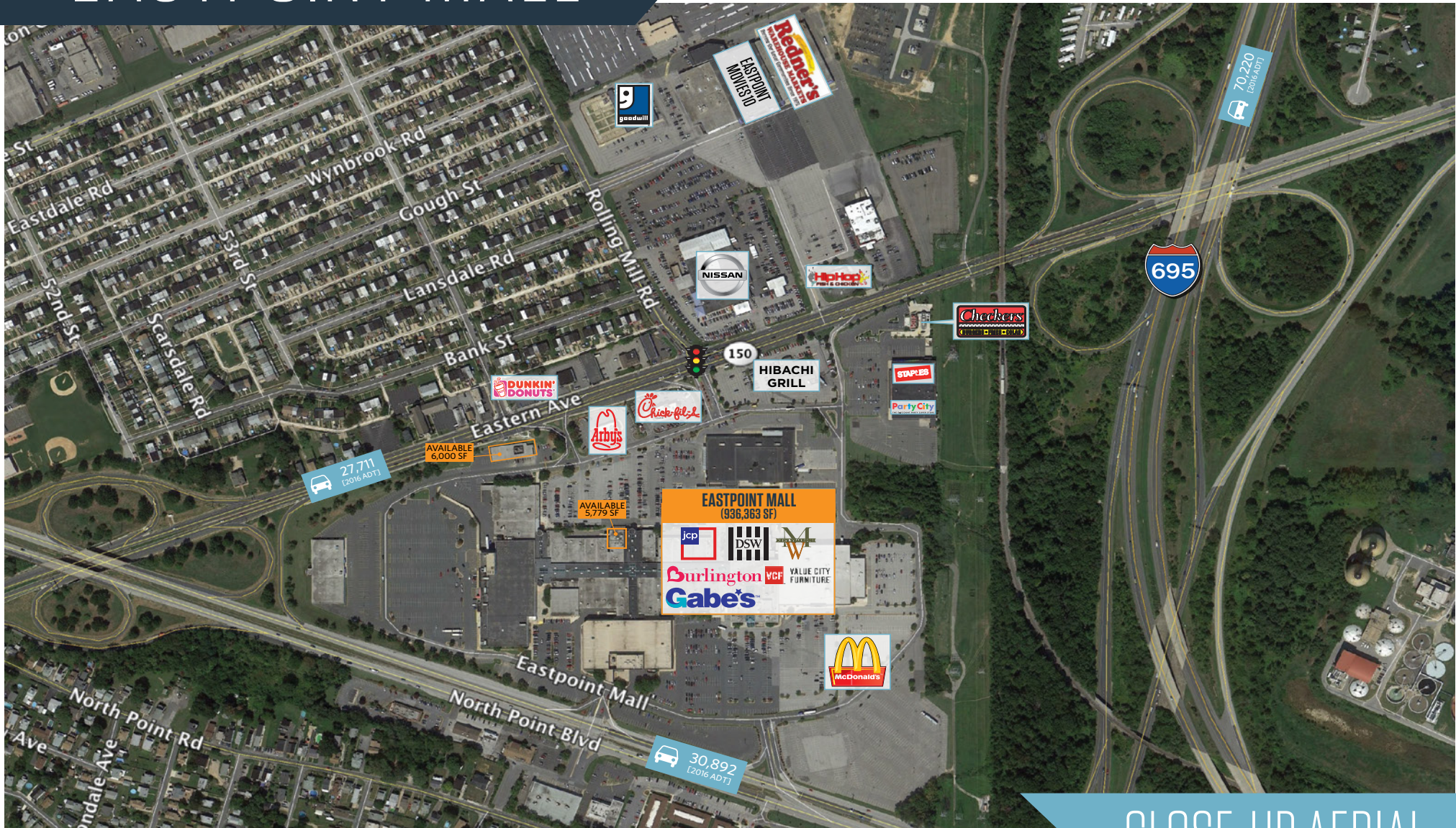

CLOSE-UP AERIAL

Matt Copeland
mcopeland@klnb.com
443-632-2051

100 West Road, Suite 505
Towson, MD 21204
klnb.com

klnb

EASTPOINT MALL

7839 Eastpoint Mall, Baltimore, MD 21224
Baltimore County

CLICK TO VIEW PROPERTY WEBSITE

For More Information, Please Contact:

Matt Copeland

mcopeland@klnb.com

443-632-2051

100 West Road, Suite 505

Towson, MD 21204

klnb.com

 facebook.com/KLNB

 [@KLNBLLC](https://twitter.com/KLNBLLC)

 linkedin.com/company/klnb

 instagram.com/klnbllc

While we have no reason to doubt the accuracy of any of the information supplied, we cannot, and do not, guarantee its accuracy. All information should be independently verified prior to a purchase or lease of the property. We are not responsible for errors, omissions, misuse, or misinterpretation of information contained herein and make no warranty of any kind, express or implied, with respect to the property or any other matters.

klnb