



## JOIN THESE RETAILERS



## RETAIL FOR LEASE

- 1,518 square foot Geico Insurance space available December 1, 2020
- Approximately 21 feet of prime frontage along Rockville Pike
- Full access intersection on Rockville Pike (54,075 ADT) directly across the street from Wintergreen Plaza
- Parking available in the front and rear
- Recently renovated facade

**MATT SKALET**

m skalet@klnb.com | 202-420-7775

**BEN BECKER**

b becker@klnb.com | 202-420-7773

# LOCATION

# 842B ROCKVILLE PIKE

ROCKVILLE, MARYLAND 20852

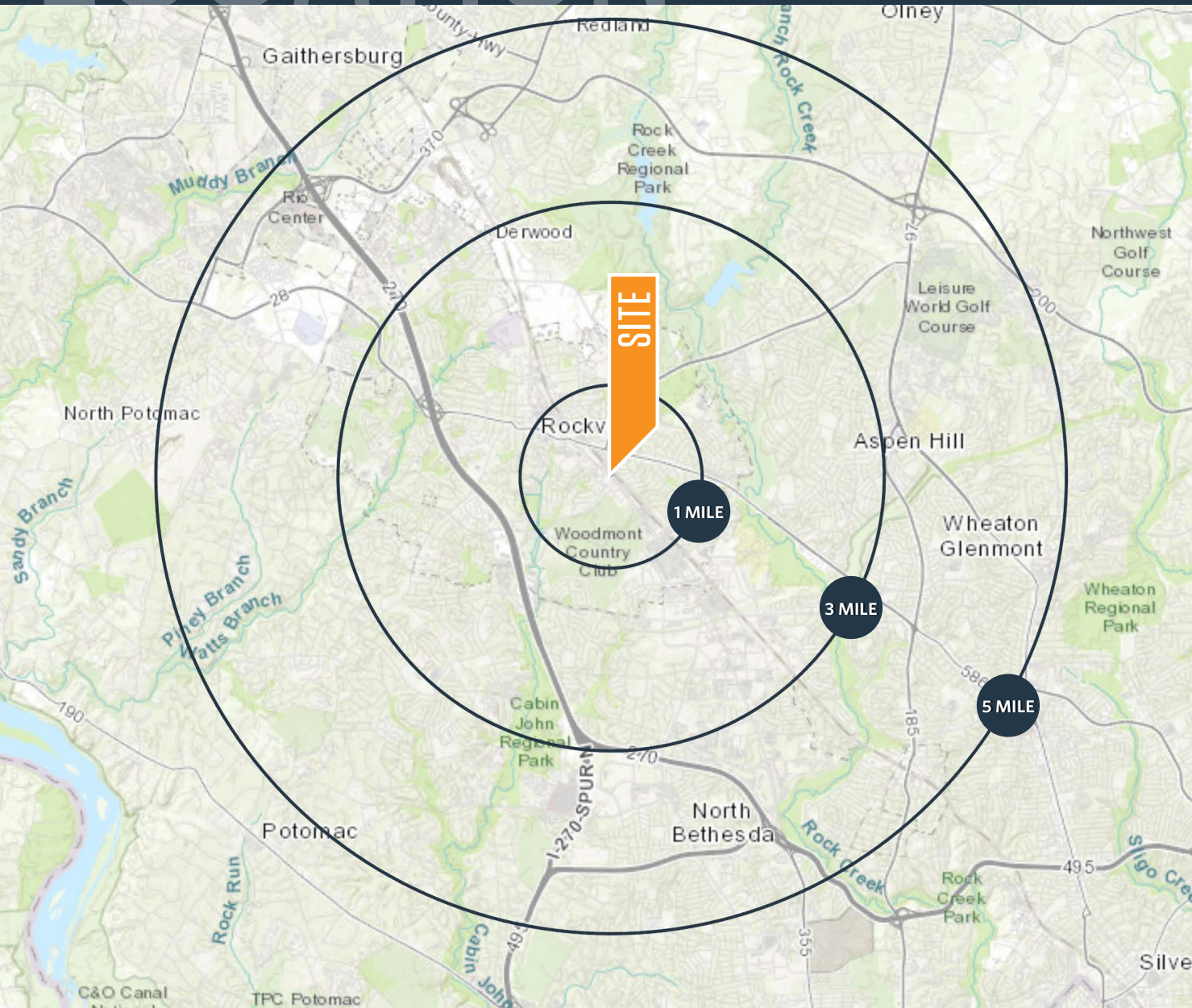

## AVAILABLE SPACE

SIZE	RATE	CONDITION	DELIVERY
1,518 SF	\$33.00 PSF + \$8.00 PSF NNN	Retail Shell	12/1/2020

## DEMOGRAPHICS | 2019:

### DRIVE TIME

10-MIN	1-MILE	3-MILE	5-MILE
Population			
160,304	17,373	121,760	325,358
Daytime Population			
121,518	12,960	94,990	188,153
Households			
61,236	6,407	45,924	122,874
Average HH Income			
\$151,320	\$112,846	\$148,991	\$149,952

## TRAFFIC COUNTS | 2019:

Rockville Pike	54,075 ADT
First Street	24,920 ADT
Wootton Pkwy	19,175 ADT

**MATT SKALET**

m skalet@klnb.com | 202-420-7775

**BEN BECKER**

b becker@klnb.com | 202-420-7773



# SITE PLAN

# 842B ROCKVILLE PIKE

ROCKVILLE, MARYLAND 20852

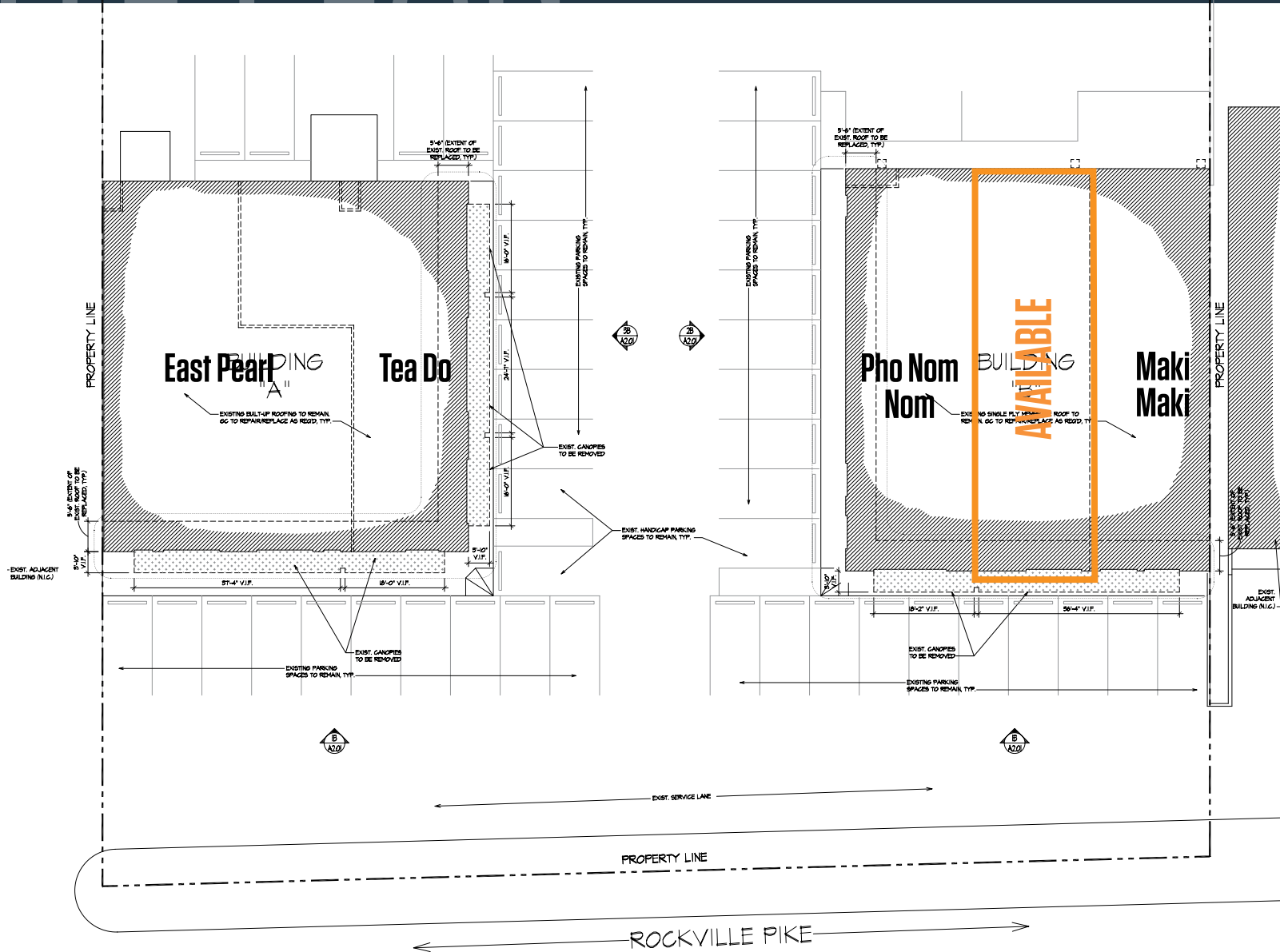

**MATT SKALET**

maskalet@klnb.com | 202-420-7775

**BEN BECKER**

bbecker@klnb.com | 202-420-7773



# AERIAL

# 842B ROCKVILLE PIKE

ROCKVILLE, MARYLAND 20852



**MATT SKALET**

maskalet@klnb.com | 202-420-7775

**BEN BECKER**

bbecker@klnb.com | 202-420-7773

**klnb**

# 842B ROCKVILLE PIKE

ROCKVILLE, MARYLAND 20852

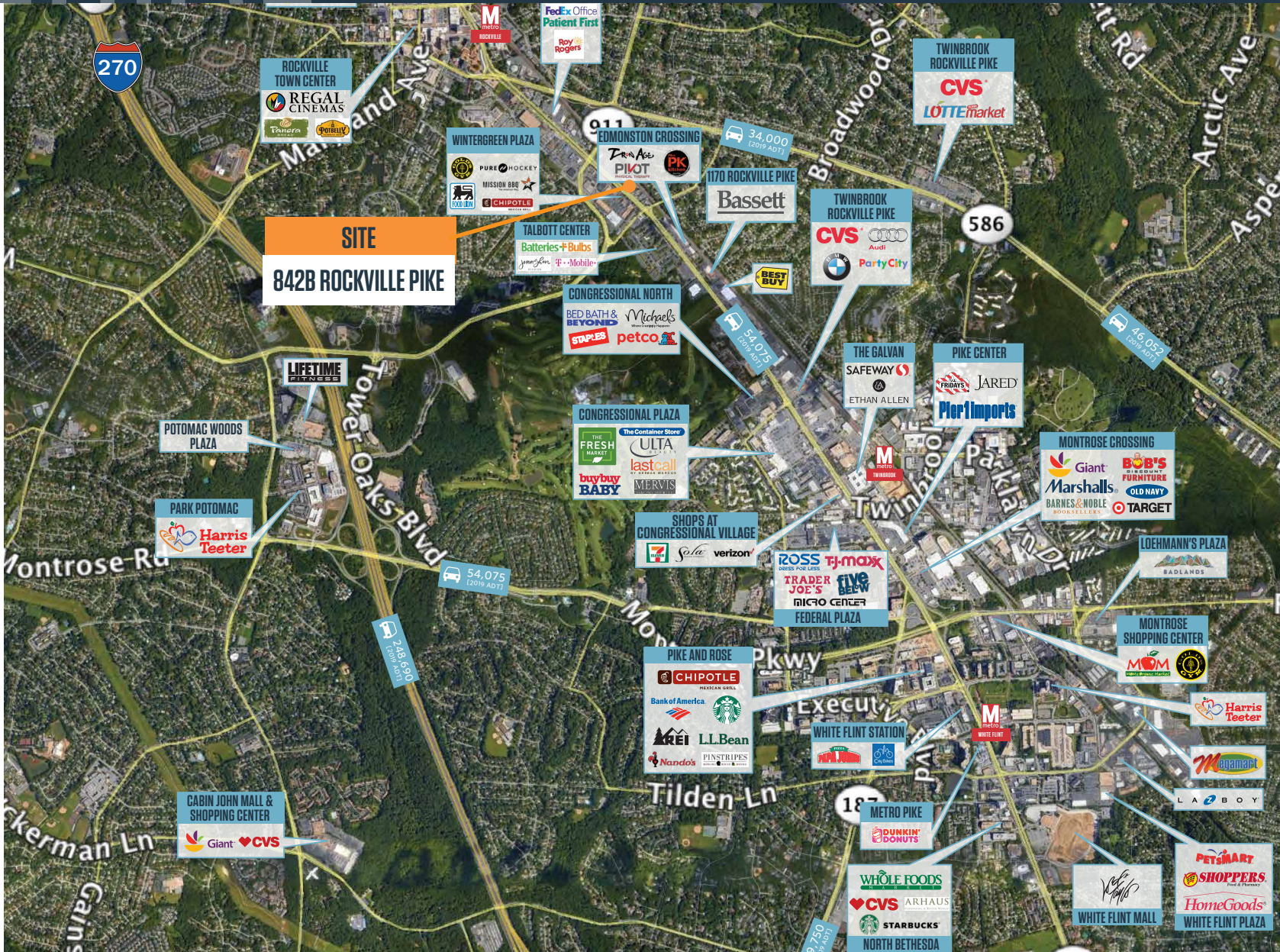

**MATT SKALET**

m skalet@klnb.com | 202-420-7775

**BEN BECKER**

b becker@klnb.com | 202-420-7773





# 842B ROCKVILLE PIKE

ROCKVILLE, MARYLAND 20852

## FOR MORE INFORMATION, PLEASE CONTACT:

### MATT SKALET

[mskalet@klnb.com](mailto:maskalet@klnb.com)

202-420-7775

### BEN BECKER

[bbecker@klnb.com](mailto:bbecker@klnb.com)

202-420-7773

1130 Connecticut Avenue, Suite 600, Washington, DC 20036

.....

[klnb.com](http://klnb.com)

 [facebook.com/KLNB](https://facebook.com/KLNB)

 [@KLNBLLC](https://twitter.com/KLNBLLC)

 [linkedin.com/company/klnb](https://linkedin.com/company/klnb)

 [instagram.com/klnbllc](https://instagram.com/klnbllc)

[CLICK TO VIEW PROPERTY WEBSITE](#)

While we have no reason to doubt the accuracy of any of the information supplied, we cannot, and do not, guarantee its accuracy. All information should be independently verified prior to a purchase or lease of the property. We are not responsible for errors, omissions, misuse, or misinterpretation of information contained herein and make no warranty of any kind, express or implied, with respect to the property or any other matters.