

ELDERSBURG STATION

Londontown Blvd & Sykesville Rd, Eldersburg, MD 21784
Carroll County



RETAIL FOR LEASE

NEARBY RETAILERS:



- Site will accommodate theater with restaurant pad sites and inline retail
- Adjacent to: Safeway, Martin's, The Home Depot, Kohl's
- Average Household Incomes in trade area exceed \$100,000
- Site will feature pedestrian-friendly development with unique outdoor amenities

Adam Miller
amiller@klnb.com
443-632-2050

Brian Finkelstein
bfinkelstein@klnb.com
443-632-2076

Michael Ginsburg
mginsburg@klnb.com
443-632-2041

100 West Road, Suite 505
Towson, MD 21204
klnb.com



ELDERSBURG STATION

Londontown Blvd & Sykesville Rd, Eldersburg, MD 21784
Carroll County

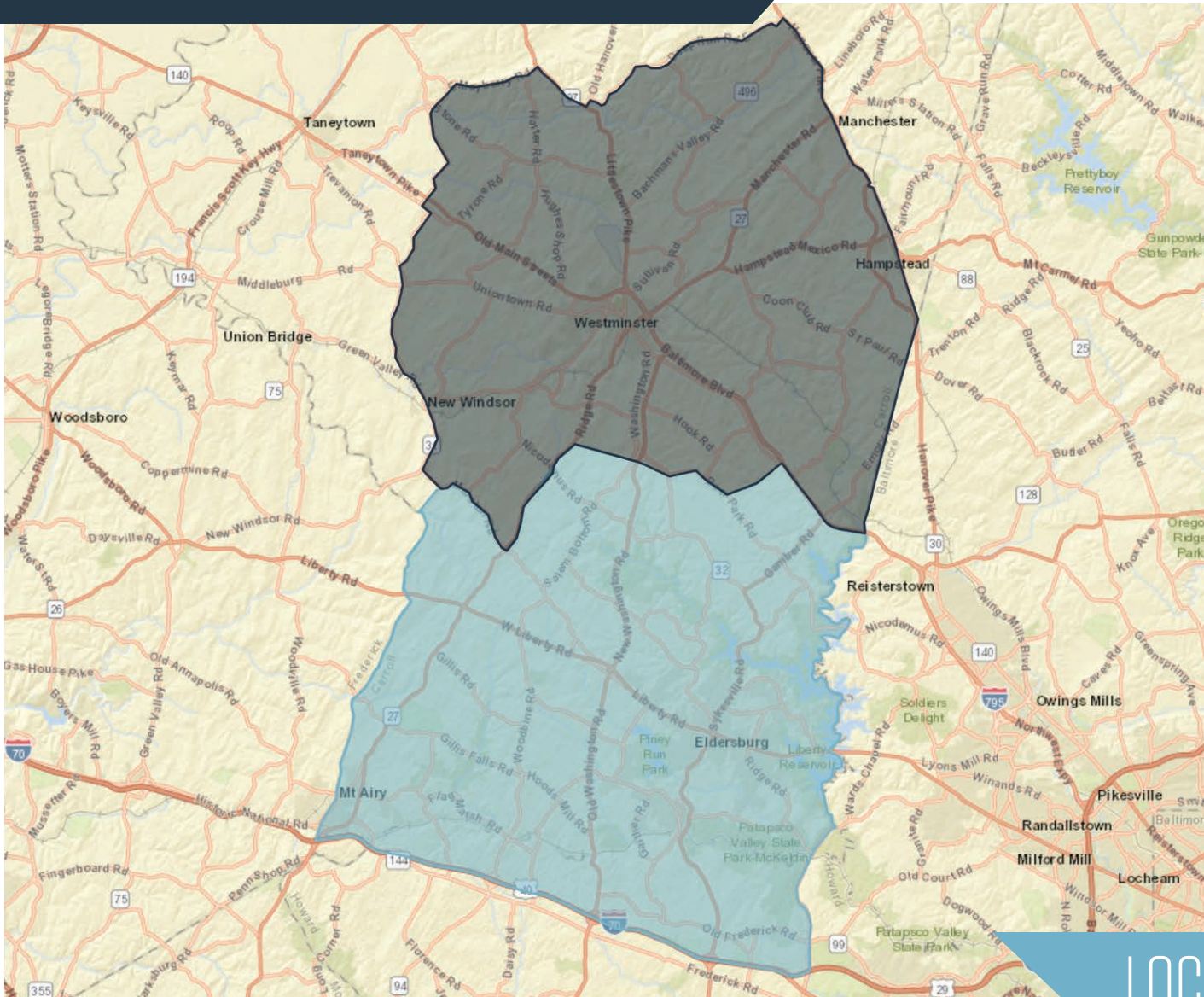

DEMOGRAPHICS | 2021:

PRIMARY	SECONDARY	COMBINED
Population		
78,310	68,406	146,716
Daytime Population		
23,025	34,066	57,091
Households		
27,046	25,143	52,189
Average HH Income		
\$154,154	\$110,954	\$265,108

[CLICK TO DOWNLOAD DEMOGRAPHIC REPORT](#)

TRAFFIC COUNTS | 2019:

Liberty Rd	31,520 ADT
Sykesville Rd	14,251 ADT

LOCATION & DEMOGRAPHICS

Adam Miller
amiller@klnb.com
443-632-2050

Brian Finkelstein
bfinkelstein@klnb.com
443-632-2076

Michael Ginsburg
mginsburg@klnb.com
443-632-2041

100 West Road, Suite 505
Towson, MD 21204
klnb.com

klnb

ELDERSBURG STATION

Londontown Blvd & Sykesville Rd, Eldersburg, MD 21784
Carroll County



MARKET AERIAL

Adam Miller
amiller@klnb.com
443-632-2050

Brian Finkelstein
bfinkelstein@klnb.com
443-632-2076

Michael Ginsburg
mginsburg@klnb.com
443-632-2041

100 West Road, Suite 505
Towson, MD 21204
klnb.com



ELDERSBURG STATION

Londontown Blvd & Sykesville Rd, Eldersburg, MD 21784
Carroll County



CLOSE-UP AERIAL

Adam Miller
amiller@klnb.com
443-632-2050

Brian Finkelstein
bfinkelstein@klnb.com
443-632-2076

Michael Ginsburg
mginsburg@klnb.com
443-632-2041

100 West Road, Suite 505
Towson, MD 21204
klnb.com

klnb

ELDERSBURG STATION

Londontown Blvd & Sykesville Rd, Eldersburg, MD 21784
Carroll County

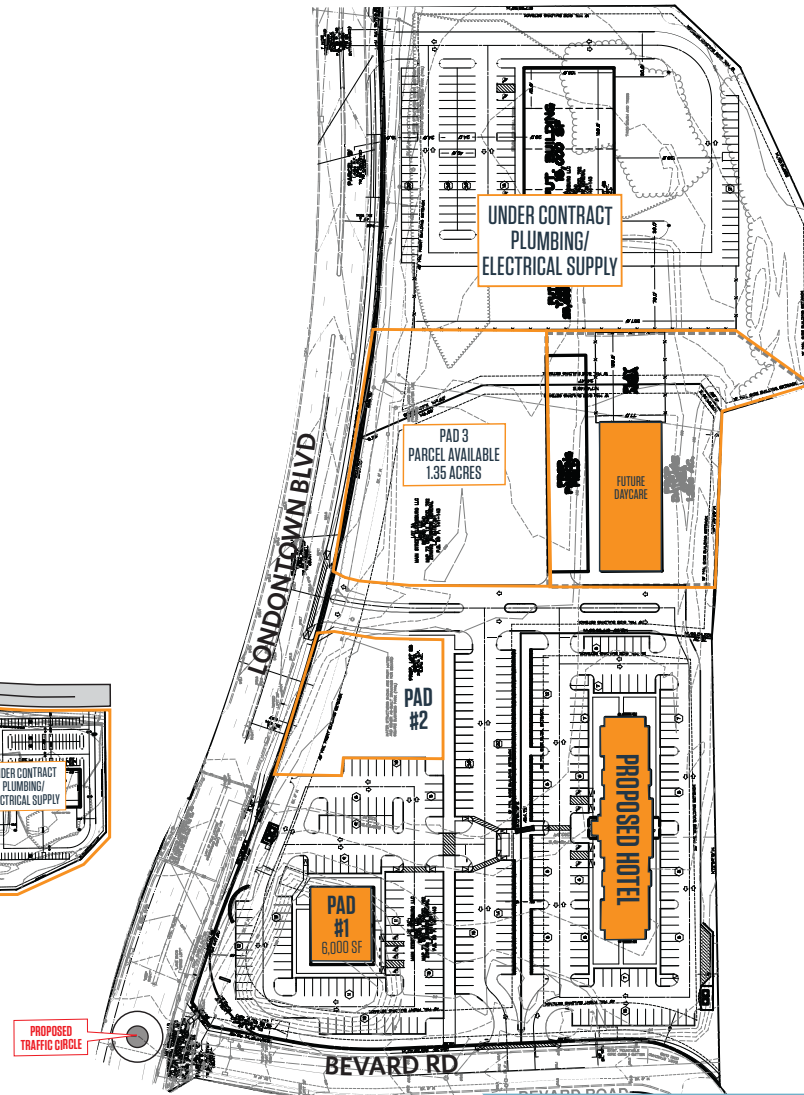

SITE PLAN

Adam Miller
amiller@klnb.com
443-632-2050

Brian Finkelstein
bfinkelstein@klnb.com
443-632-2076

Michael Ginsburg
mginsburg@klnb.com
443-632-2041

100 West Road, Suite 505
Towson, MD 21204
klnb.com



ELDERSBURG STATION

Londontown Blvd & Sykesville Rd, Edlersburg, MD 21784
Carroll County

CLICK TO VIEW PROPERTY WEBSITE

For More Information, Please Contact:

Adam Miller

amiller@klnb.com
443-632-2050

Brian Finkelstein

bfinkelstein@klnb.com
443-632-2076

Michael Ginsburg

mginsburg@klnb.com
443-632-2041

100 West Road, Suite 505
Towson, MD 21204

klnb.com

 facebook.com/KLNB

 [@KLNBLLC](https://twitter.com/KLNBLLC)

 linkedin.com/company/klnb

 instagram.com/klnbllc

While we have no reason to doubt the accuracy of any of the information supplied, we cannot, and do not, guarantee its accuracy. All information should be independently verified prior to a purchase or lease of the property. We are not responsible for errors, omissions, misuse, or misinterpretation of information contained herein and make no warranty of any kind, express or implied, with respect to the property or any other matters.

klnb