



OFFICE / MEDICAL FOR LEASE

PROPERTY HIGHLIGHTS:

Suite Highlights

- **Vacancies:**
 - 1st Floor:* • 3,882 SF of kitchen/deli/catering space
 - 2nd Floor:* • 42,226 SF (divisible to 20,000 sf) of office/medical/school space
 - Could add dedicated elevator entry for long term
- **Rent:** \$12 - \$16 PSF NNN
- **Parking:** Ample on-site parking (940 spaces)
- Building signage available
- Multi-functional space with open concept floor plans

Location Overview

- Situated in Montgomery Industrial Park
- Conveniently located near I-495, I-95 and Route 29
- The property benefits from a rich amenity base due to its close proximity to Downtown Silver Spring, White Oak Town Center, Westech Village Center, and New Adventist Hospital site.



11800 TECH ROAD

Silver Spring, MD 20904 | Montgomery County

FULL-BUILDING PLAN

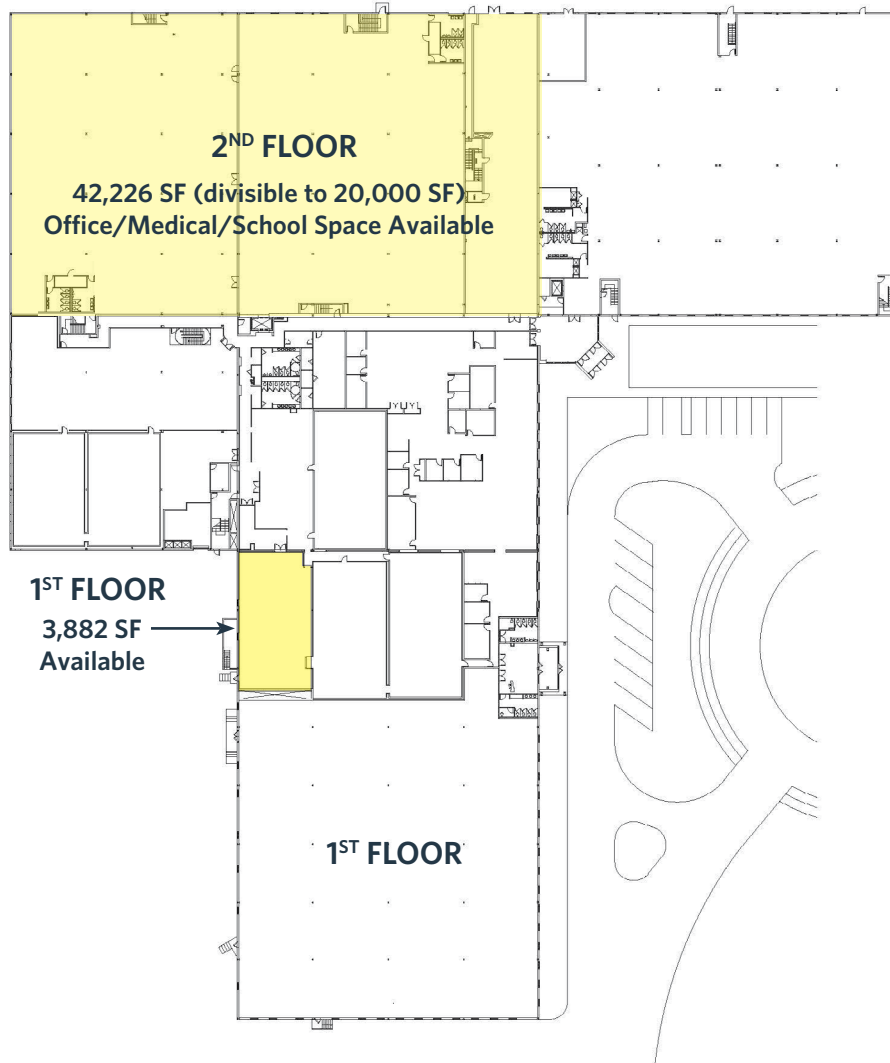

WIDE VARIETY OF PERMITTED USES BUT NOT LIMITED TO:

- Daycare (ability for outdoor play area)
- School
- Medical
- Church
- Medical
- Office/R&D
- Health Club/Fitness
- Recreation and Entertainment Facilities
- Retail/Service
- Vehicle Sales (Indoor)
- Medical/Scientific Manufacturing & Production

Aaron Carroll
acarroll@klnb.com
443-574-1499

Spence Daw
sdaw@klnb.com
443-574-1429

SITE PLAN

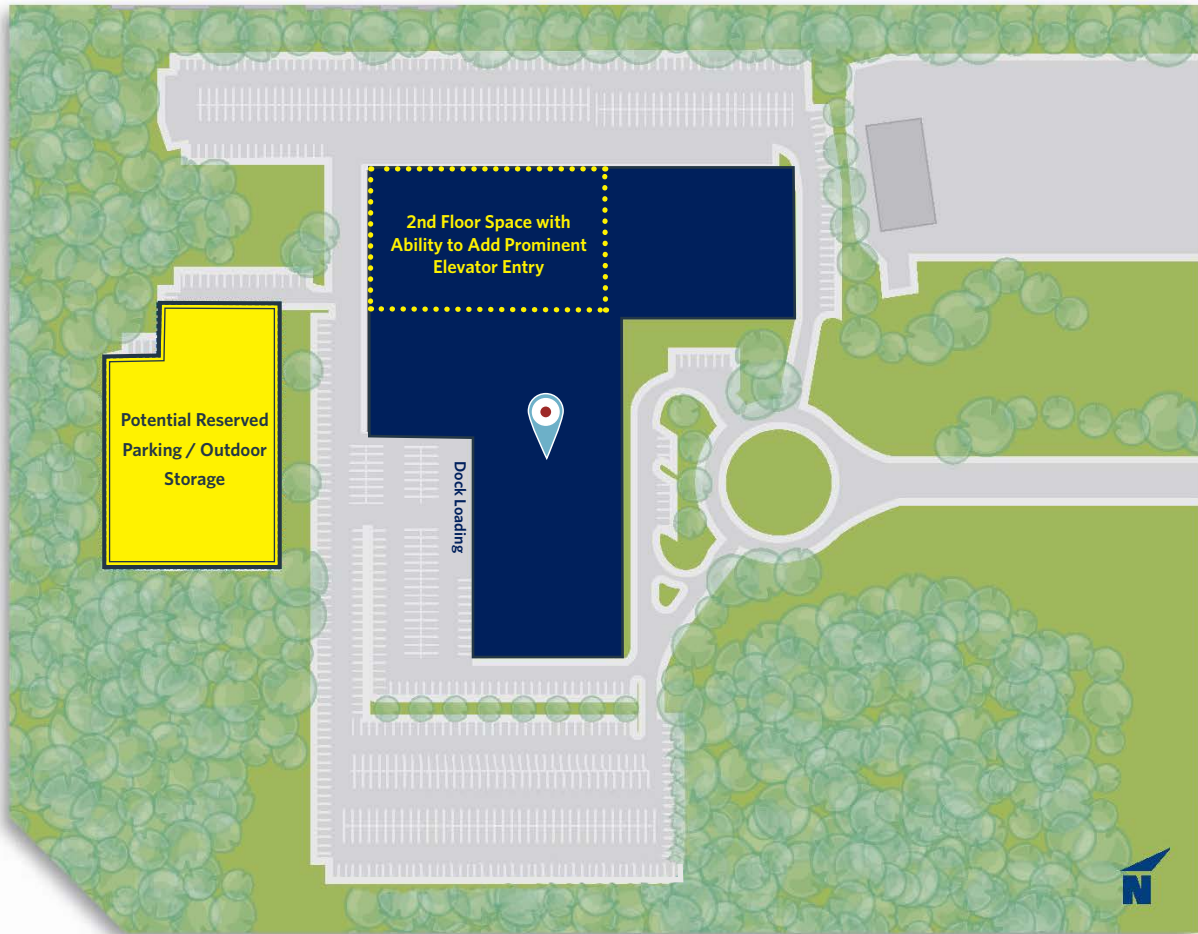

PHOTOS



11800 TECH ROAD

Silver Spring, MD 20904 | Montgomery County

[CLICK TO VIEW PROPERTY WEBSITE](#)

For More Information, Please Contact:

Aaron Carroll

acarroll@klnb.com

443-574-1409

Spence Daw

sdaw@klnb.com

443-574-1429

9881 Broken Land Parkway, Suite 300
Columbia, MD 21046

klnb.com

 facebook.com/KLNB

 [@KLNBLLC](https://twitter.com/KLNBLLC)

 linkedin.com/company/klnb

 instagram.com/klnbllc

While we have no reason to doubt the accuracy of any of the information supplied, we cannot, and do not, guarantee its accuracy. All information should be independently verified prior to a purchase or lease of the property. We are not responsible for errors, omissions, misuse, or misinterpretation of information contained herein and make no warranty of any kind, express or implied, with respect to the property or any other matters.

