

# HAMPTON COMMERCE CENTER

9217 - 9219 Hampton Overlook  
Capitol Heights, MD 20743, Prince George's County

2 Oversized Drive-Ins



OFFICE/WAREHOUSE FOR LEASE

## PROPERTY FEATURES

- **Project:** Hampton Commerce Center 1 & 2
- **Total Size & Ceiling Height:**
  - » Building 1: 45,000 SF; 18' clear
  - » Building 2: 28,830 SF; 16' clear
- **Lease Rate:** \$10.95 psf, NNN
- **Zoning:** I-1 Light Industrial
- **Parking Ratio:** 2.6 per 1,000 square feet

## CURRENT SPACE AVAILABILITY

- **9217 - 9219 Hampton Overlook: 4,224 Sq. Ft.**
  - » **Available 11/1/2022**
  - » Approximately 30% office; 70% warehouse
  - » Two (2) oversized drive-ins

OWNED & MANAGED BY:



**Spence Daw**  
sdaw@klnb.com  
443-574-1429

**Aaron Carroll**  
acarroll@klnb.com  
202-652-2333

9881 Broken Land Pkwy, #300  
Columbia, MD 21046  
klnb.com



# HAMPTON COMMERCE CENTER

9217 - 9219 Hampton Overlook  
Capitol Heights, MD 20743, Prince George's County

9217 & 9219

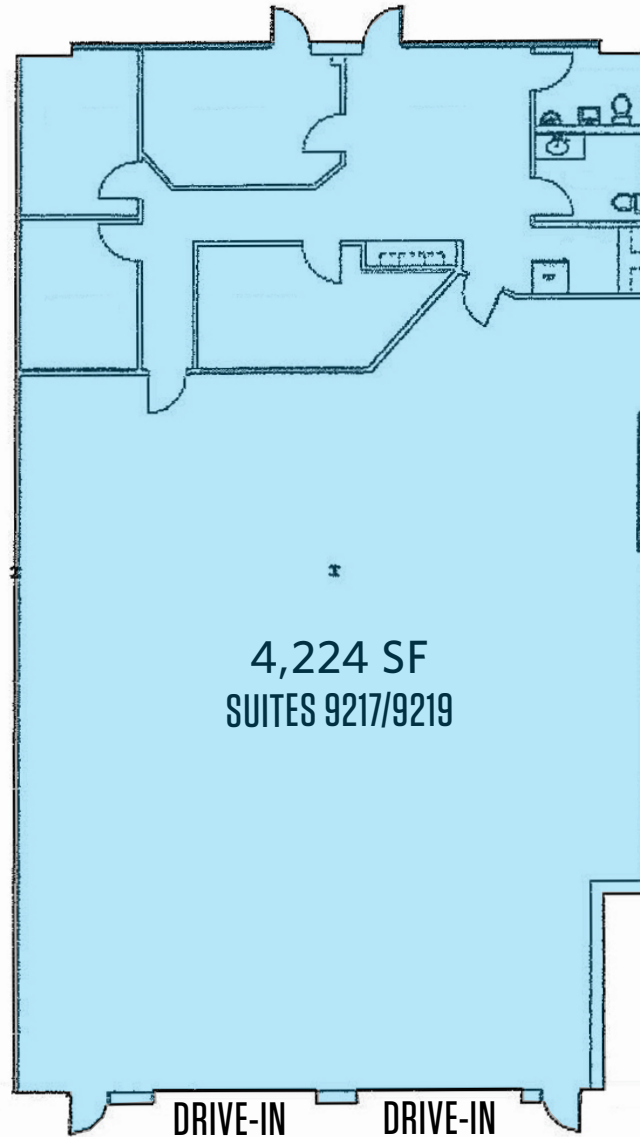

OWNED & MANAGED BY:



FLOOR PLAN

Spence Daw  
sdaw@klnb.com  
443-574-1429

Aaron Carroll  
acarroll@klnb.com  
202-652-2333

9881 Broken Land Pkwy, #300  
Columbia, MD 21046  
klnb.com



# HAMPTON COMMERCE CENTER

9217 - 9219 Hampton Overlook  
Capitol Heights, MD 20743, Prince George's County

BUILDING 1: Dock Loading  
BUILDING 2: Drive-In Loading

BUILDING 1

BUILDING 2

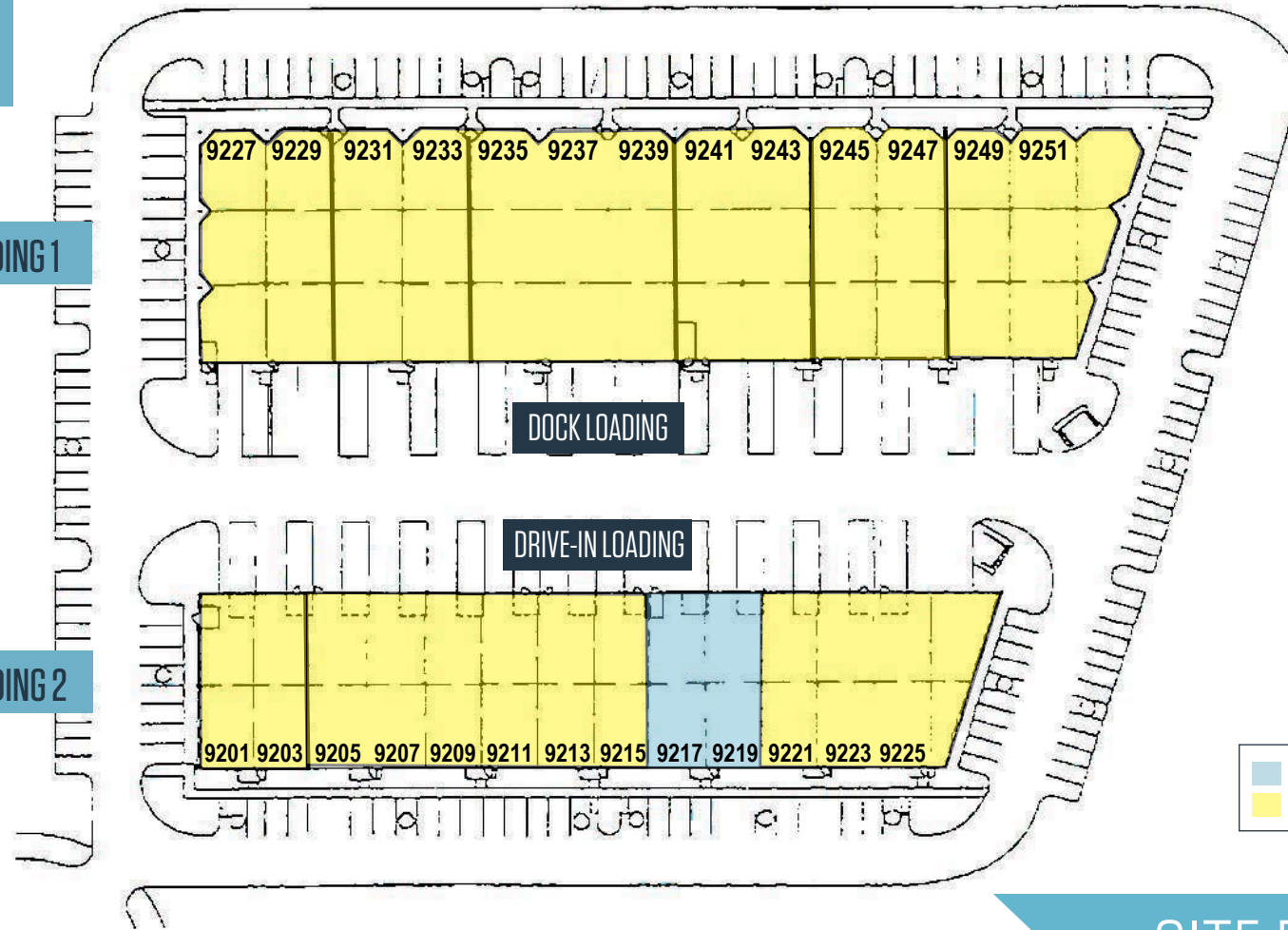

AVAILABLE  
LEASED

OWNED & MANAGED BY:



SITE PLAN

Spence Daw  
sdaw@klnb.com  
443-574-1429

Aaron Carroll  
acarroll@klnb.com  
202-652-2333

9881 Broken Land Pkwy, #300  
Columbia, MD 21046  
klnb.com



# HAMPTON COMMERCE CENTER

9217 - 9219 Hampton Overlook  
Capitol Heights, MD 20743, Prince George's County

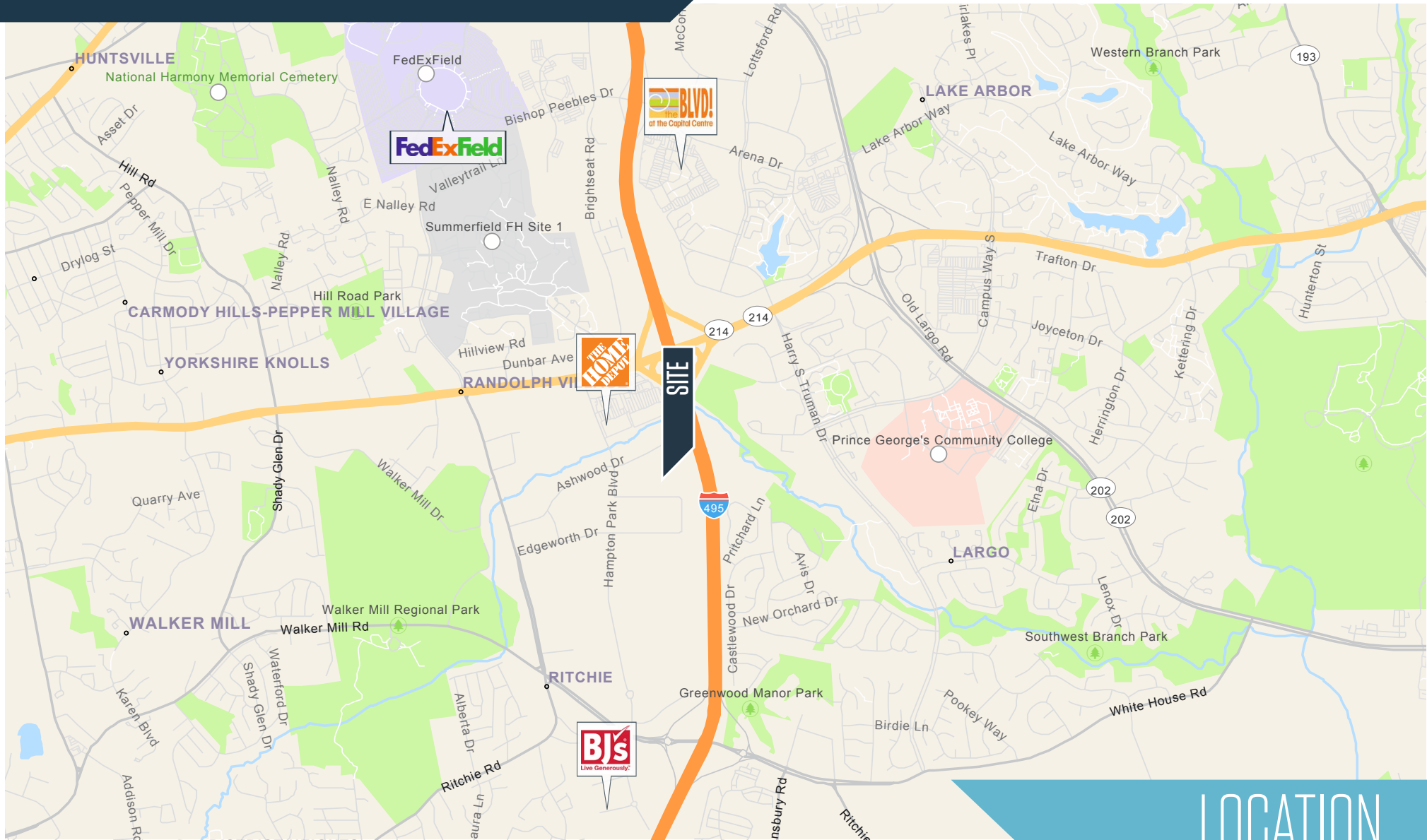

LOCATION

Spence Daw  
sdaw@klnb.com  
443-574-1429

Aaron Carroll  
acarroll@klnb.com  
202-652-2333

9881 Broken Land Pkwy, #300  
Columbia, MD 21046  
klnb.com



# HAMPTON COMMERCE CENTER

9217 - 9219 Hampton Overlook  
Capitol Heights, MD 20743, Prince George's County

CLICK TO VIEW PROPERTY WEBSITE

For More Information, Please Contact:

**Spence Daw**

sdaw@klnb.com

443-574-1429

**Aaron Carroll**

acarroll@klnb.com

202-652-2333

9881 Broken Land Parkway, Suite 300  
Columbia, MD 21046

[klnb.com](http://klnb.com)

 [facebook.com/KLNB](https://facebook.com/KLNB)

 [@KLNBLLC](https://twitter.com/KLNBLLC)

 [linkedin.com/company/klnb](https://linkedin.com/company/klnb)

 [instagram.com/klnblc](https://instagram.com/klnblc)

While we have no reason to doubt the accuracy of any of the information supplied, we cannot, and do not, guarantee its accuracy. All information should be independently verified prior to a purchase or lease of the property. We are not responsible for errors, omissions, misuse, or misinterpretation of information contained herein and make no warranty of any kind, express or implied, with respect to the property or any other matters.

OWNED & MANAGED BY:

