

# CRAIN COMMONS

7620 Crain Highway, Upper Marlboro, MD 20772  
Prince George's County

## POSSIBLE DEVELOPMENT LAYOUT



## PAD FOR LEASE

JOIN:



- 1 Acre pad for lease
- 76 newly proposed townhomes
- Excellent visibility and access from Crain highway
- Signalized intersection
- Dual access

Joe Mekulski  
jmekulski@klnb.com  
443-632-1343

Patrick Miller  
pmiller@klnb.com  
443-632-2042

100 West Road, Suite 505  
Towson, MD 21204  
klnb.com



# CRAIN COMMONS

7620 Crain Highway, Upper Marlboro, MD 20772  
Prince George's County

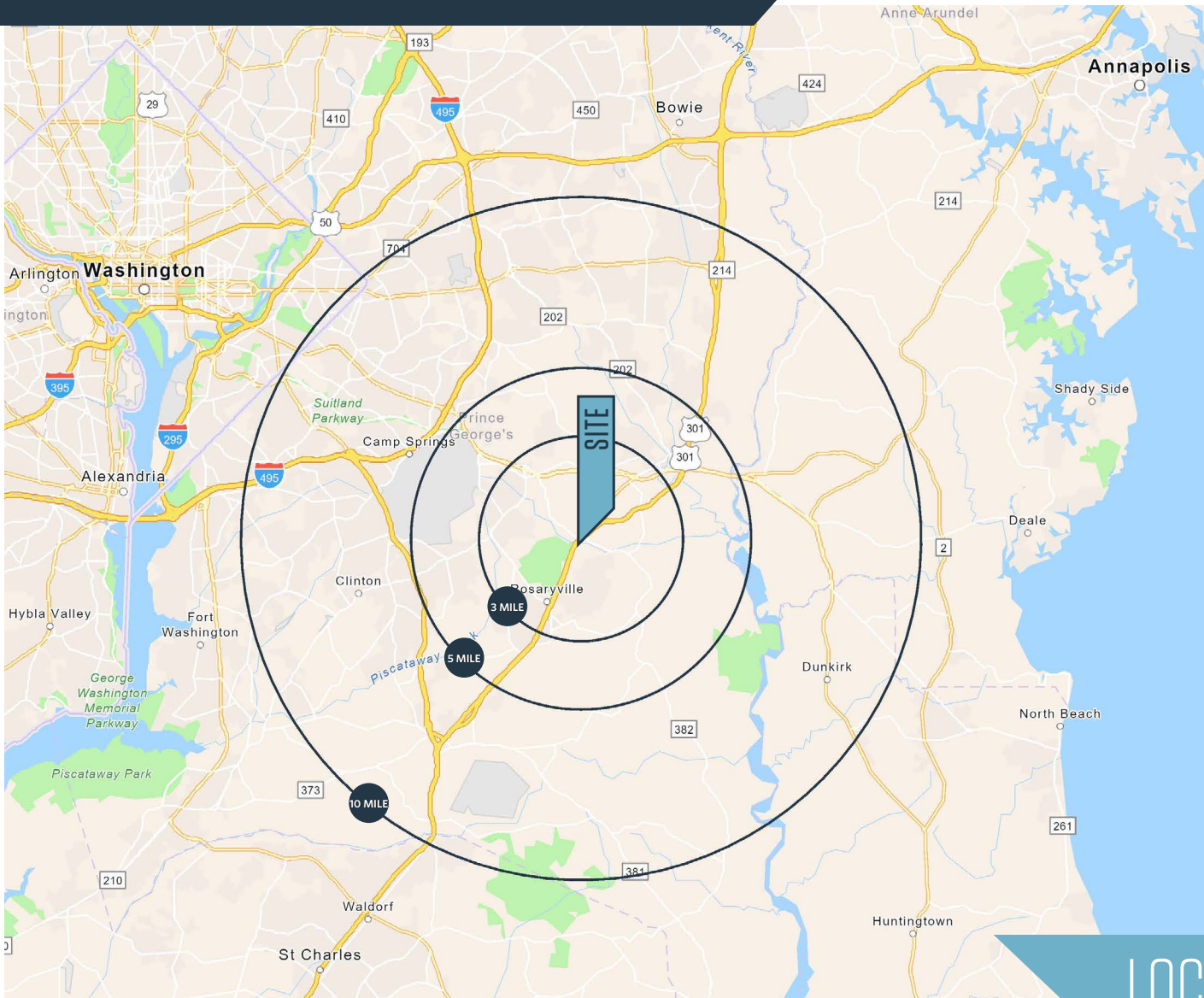

## AVAILABLE SPACE

1 Acre pad for lease

## DEMOGRAPHICS | 2022:

3-MILE	5-MILE	10-MILE
Population		
31,011	64,403	401,522
Daytime Population		
4,893	17,962	107,441
Households		
10,786	23,358	151,207
Average HH Income		
\$158,962	\$156,403	\$125,424

[CLICK TO DOWNLOAD DEMOGRAPHIC REPORT](#)

## TRAFFIC COUNTS | 2019:

Crain Hwy	33,212 ADT
Osborne Rd	11,481 ADT

## LOCATION & DEMOGRAPHICS

Joe Mekulski  
jmekulski@klnb.com  
443-632-1343

Patrick Miller  
pmiller@klnb.com  
443-632-2042

100 West Road, Suite 505  
Towson, MD 21204  
klnb.com

klnb

# CRAIN COMMONS

7620 Crain Highway, Upper Marlboro, MD 20772  
Prince George's County



MARKET AERIAL

Joe Mekulski  
jmekulski@klnb.com  
443-632-1343

Patrick Miller  
pmiller@klnb.com  
443-632-2042

100 West Road, Suite 505  
Towson, MD 21204  
klnb.com



# CRAIN COMMONS

7620 Crain Highway, Upper Marlboro, MD 20772  
Prince George's County

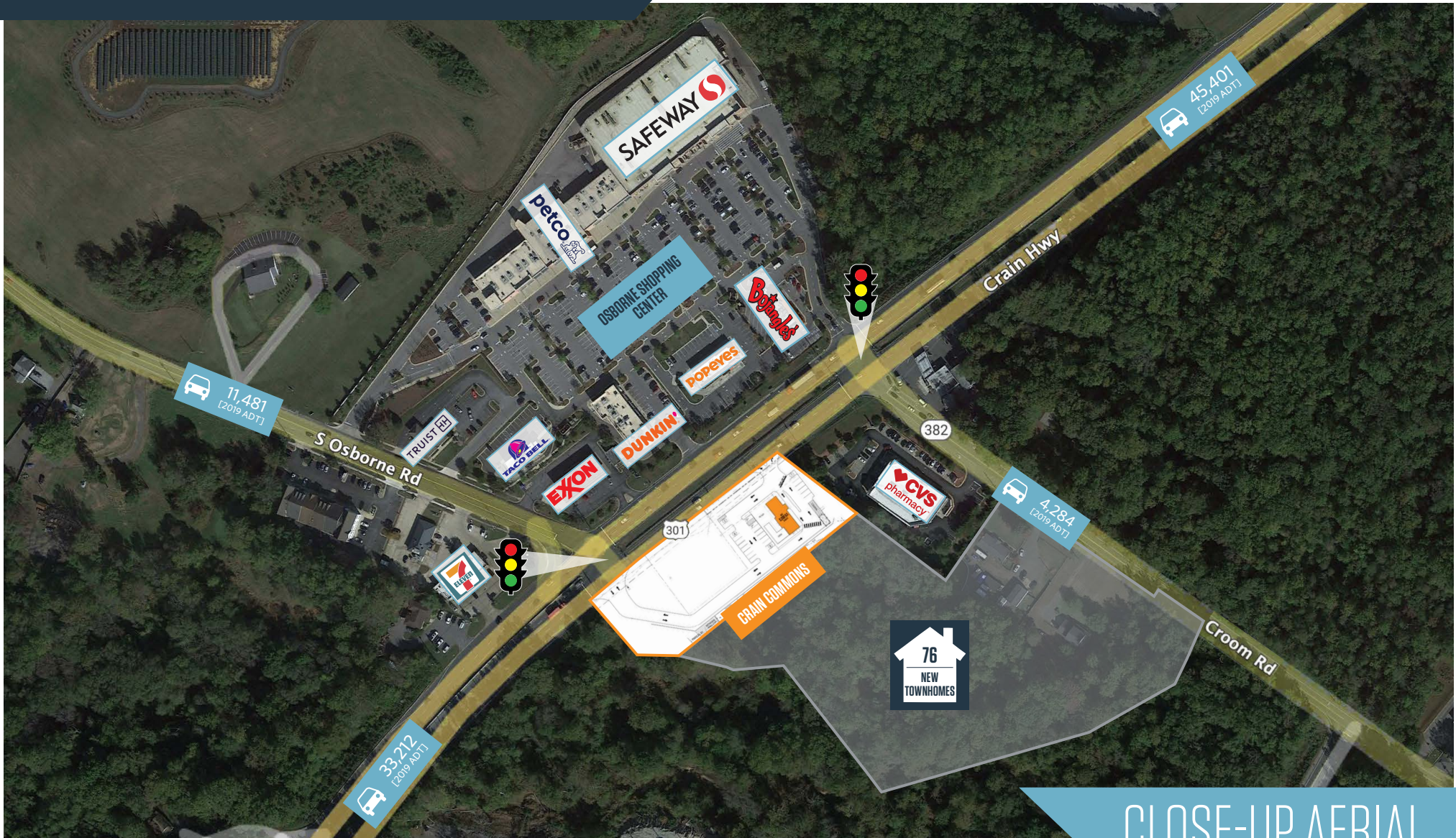

CLOSE-UP AERIAL

Joe Mekulski  
jmekulski@klnb.com  
443-632-1343

Patrick Miller  
pmiller@klnb.com  
443-632-2042

100 West Road, Suite 505  
Towson, MD 21204  
klnb.com

klnb

# CRAIN COMMONS

7620 Crain Highway, Upper Marlboro, MD 20772  
Prince George's County

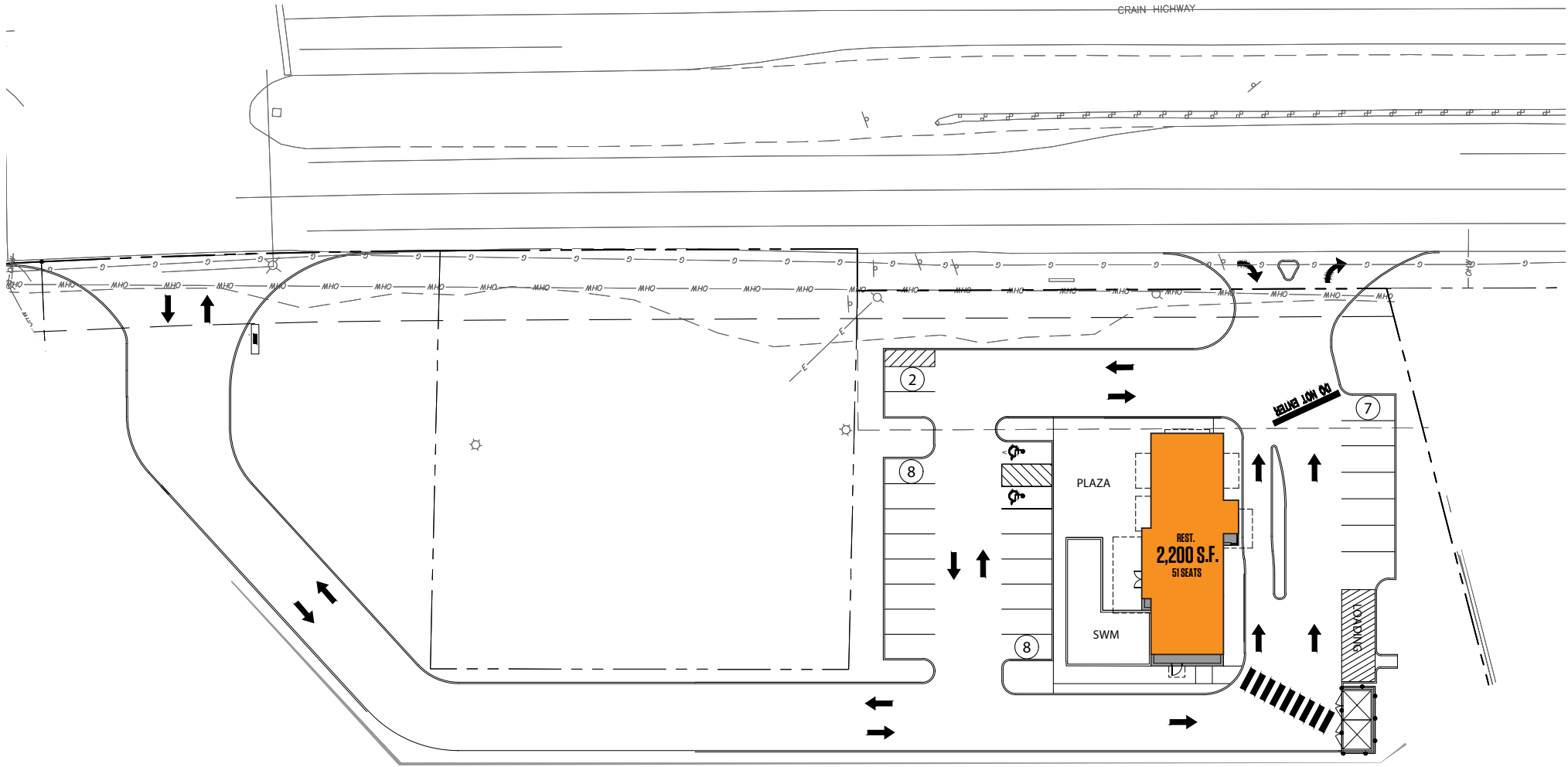

1 ACRE PAD

Joe Mekulski  
jmekulski@klnb.com  
443-632-1343

Patrick Miller  
pmiller@klnb.com  
443-632-2042

100 West Road, Suite 505  
Towson, MD 21204  
klnb.com

klnb

# CRAIN COMMONS

7620 Crain Highway, Upper Marlboro, MD 20772  
Prince George's County



SURVEY

Joe Mekulski  
jmekulski@klnb.com  
443-632-1343

Patrick Miller  
pmiller@klnb.com  
443-632-2042

100 West Road, Suite 505  
Towson, MD 21204  
klnb.com



# CRAIN COMMONS

7620 Crain Highway, Upper Marlboro, MD 20772  
Prince George's County

[CLICK TO VIEW PROPERTY WEBSITE](#)

For More Information, Please Contact:

**Joe Mekulski**

[jmekulski@klnb.com](mailto:jmekulski@klnb.com)  
443-632-1343

**Patrick Miller**

[pmiller@klnb.com](mailto:pmiller@klnb.com)  
443-632-2042

100 West Road, Suite 505  
Towson, MD 21204

[klnb.com](http://klnb.com)

 [facebook.com/KLNB](https://facebook.com/KLNB)

 [@KLNBLLC](https://twitter.com/KLNBLLC)

 [linkedin.com/company/klnb](https://linkedin.com/company/klnb)

 [instagram.com/klnbllc](https://instagram.com/klnbllc)

While we have no reason to doubt the accuracy of any of the information supplied, we cannot, and do not, guarantee its accuracy. All information should be independently verified prior to a purchase or lease of the property. We are not responsible for errors, omissions, misuse, or misinterpretation of information contained herein and make no warranty of any kind, express or implied, with respect to the property or any other matters.

**klnb**