



## JOIN THESE RETAILERS



## RETAIL FOR LEASE

- 3,973 SF of Prime Retail Space in Woodley Park
- Steps from the Omni Shoreham Hotel (836 rooms), and the Wardman Park Marriott re-development site (416,000 SF)
- Tremendous Foot traffic in an underserved neighborhood
- Steps away from the Woodley Park Metro (5,495 ADR)
- Ceiling height 16' 4"
- Space has 2 entrances and signage on both Connecticut Avenue and 24th Street, NW

**STEVE COMBS**

scombs@klnb.com | 202-420-7776

**MATT SKALET**

maskalet@klnb.com | 202-420-7775

# LOCATION

# 2616 CONNECTICUT AVENUE, NW

WASHINGTON, DC 20008

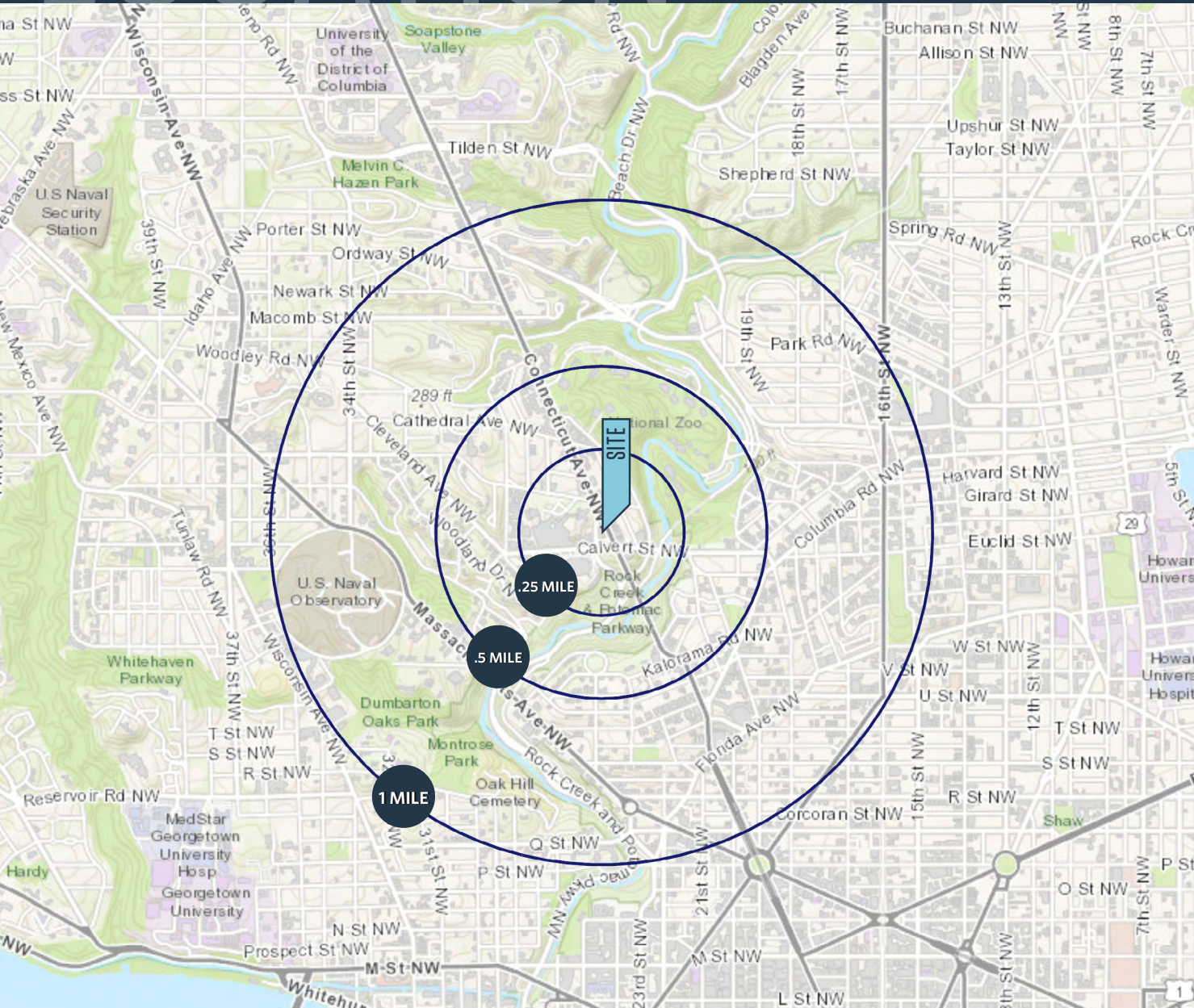

## AVAILABLE SPACE

SIZE	RATE	AVAILABLE
3,973 SF	\$60 Gross including Taxes, CAM and Insurance	Vacant

## DEMOGRAPHICS | 2021:

	.25-MILE	.5-MILE	1-MILE	10 MIN WALK
Population	3,755	11,903	57,152	9,146
Daytime Population	2,961	4,888	26,314	8,690
Households	2,183	6,993	33,462	5,255
Average HH Income	\$192,222	\$199,195	\$177,255	\$230,584

## TRAFFIC COUNTS | 2021:

Connecticut Ave NW	33,000 ADT
Calvert Street NW	13,542 ADT



**STEVE COMBS**

scombs@klnb.com | 202-420-7776

**MATT SKALET**

mkalet@klnb.com | 202-420-7775



# SITE PLAN

# 2616 CONNECTICUT AVENUE, NW

WASHINGTON, DC 20008



ENTRANCE & SIGNAGE FROM 24TH STREET, NW

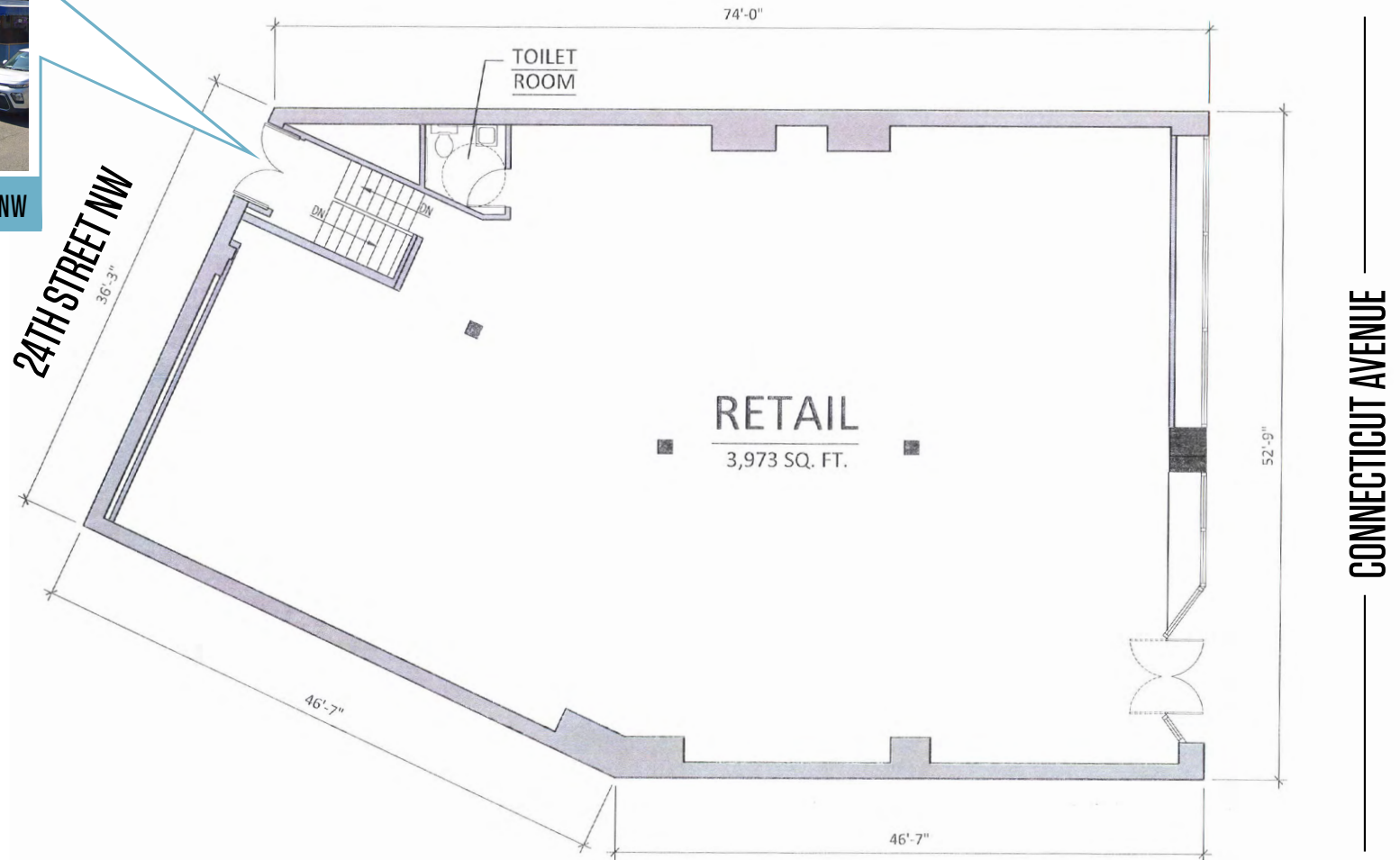

**STEVE COMBS**

scombs@klnb.com | 202-420-7776

**MATT SKALET**

mkalet@klnb.com | 202-420-7775

**klnb**

# AERIAL

# 2616 CONNECTICUT AVENUE, NW

WASHINGTON, DC 20008

**Woodley Park**  
Washington | District of Columbia

**klnb**

- Google Earth Pro -  
2018 Aerial Photograph

While we have no reason to doubt the accuracy of any of the information supplied, we cannot, and do not, guarantee its accuracy.



ROCK CREEK

**SITE**  
2616 CONNECTICUT AVE.

**Marriott**  
1,335 Rooms

**OMNI HOTELS**  
836 Rooms

**MEDATERRA**

**ITALIAN PIZZA KITCHEN**

**DISTRICT**

**Mr. Chen's**

**Open City**

**NEW HEIGHTS**

**CHIPOTLE**

**Petits Plats**

**CAFÉ PARADISO**

**MANHATTAN MARKET**

**Japanese Taverna**

**Nando's**

**TASTE OF INDIA**

**Woodley Cafe**

**TONO SUSHI**

**Rajaji**

**CVS pharmacy**

**Algham Grill**

**Café de Paris**

**STEVE COMBS**

scombs@klnb.com | 202-420-7776

**MATT SKALET**

mkalet@klnb.com | 202-420-7775

**klnb**



# 2616 CONNECTICUT AVENUE, NW

WASHINGTON, DC 20008

## FOR MORE INFORMATION, PLEASE CONTACT:

### STEVE COMBS

scombs@klnb.com

202-420-7776

### MATT SKALET

mskalet@klnb.com

202-420-7775

1130 Connecticut Avenue, Suite 600, Washington, DC 20036

.....

## klnb.com

 [facebook.com/KLNB](https://facebook.com/KLNB)

 [@KLNBLLC](https://twitter.com/KLNBLLC)

 [linkedin.com/company/klnb](https://linkedin.com/company/klnb)

 [instagram.com/klnbllc](https://instagram.com/klnbllc)

**CLICK TO VIEW PROPERTY WEBSITE**

While we have no reason to doubt the accuracy of any of the information supplied, we cannot, and do not, guarantee its accuracy. All information should be independently verified prior to a purchase or lease of the property. We are not responsible for errors, omissions, misuse, or misinterpretation of information contained herein and make no warranty of any kind, express or implied, with respect to the property or any other matters.