



# 2 STORY OPPORTUNITY AT IVY CITY

1509 NEW YORK AVE NE, WASHINGTON, DC 20002

**JUST SIGNED!**

## Tatte

BAKERY & CAFÉ  
COMISSARY KITCHEN

**14,220 SF  
LEASED**

**4,686 SF  
AVAILABLE**

- IDEAL FOR:**
- OFFICE
  - SALON SUITES
  - VET
  - URGENT CARE
  - SHOWROOM

**VICTOR SALCIDO**

vsalcido@klnb.com | 240-755-2704

**JOE FLEISCHMANN**

joef@klnb.com | 703-268-2708

**MICHAEL PRATT**

mpratt@klnb.com | 202-420-7765

**klnb.com**

# 2 STORY OPPORTUNITY AT IVY CITY

1509 NEW YORK AVE NE, WASHINGTON, DC 20002

NEW YORK AVENUE NE (US RT. 50)



NEW YORK AVENUE NE (US RT. 50)

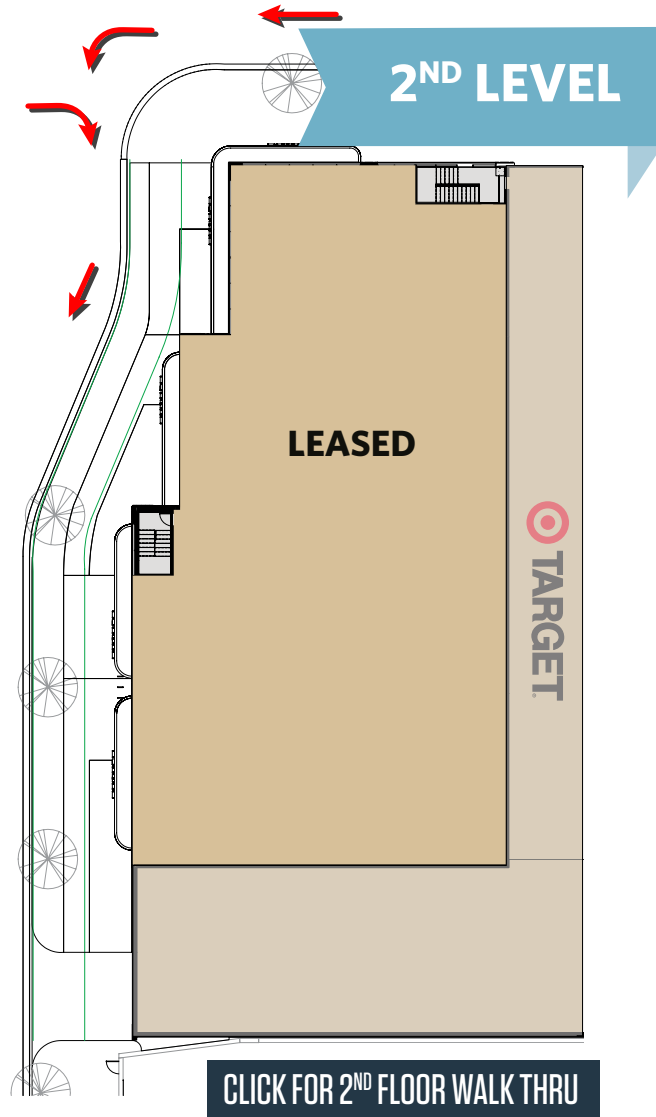

VICTOR SALCIDO

vsalcido@klnb.com | 240-755-2704

JOE FLEISCHMANN

joef@klnb.com | 703-268-2708

MICHAEL PRATT

mpratt@klnb.com | 202-420-7765

# SITE PLAN

# 2 STORY OPPORTUNITY AT IVY CITY

1509 NEW YORK AVE NE, WASHINGTON, DC 20002



## 630 DEDICATED RETAIL PARKING SPACES (LEVELS P1-P4)

FREE FOR FIRST 90 MINUTES

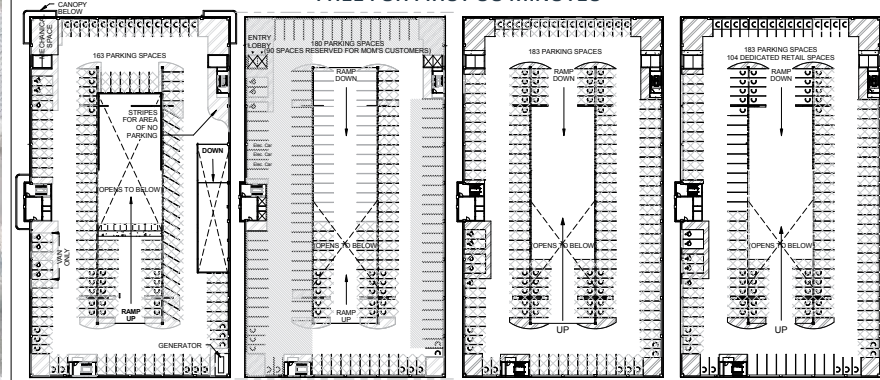

P-1: SECOND FLOOR PLAN

P-2: THIRD FLOOR PLAN

P-3: FOURTH FLOOR PLAN

P-4: FIFTH FLOOR PLAN

## RESIDENTIAL UNITS



**VICTOR SALCIDO**  
vsalcido@klnb.com | 240-755-2704

**JOE FLEISCHMANN**  
joef@klnb.com | 703-268-2708

**MICHAEL PRATT**  
mpratt@klnb.com | 202-420-7765



# LOCATION

# 2 STORY OPPORTUNITY AT IVY CITY

1509 NEW YORK AVE NE, WASHINGTON, DC 20002

## 10 MINUTE DRIVE TIME TAPESTRY



### LAPTOPS & LATTES

HOUSEHOLDS: 22,852 (21.1%)  
MEDIAN AGE: 37.4



### METRO RENTERS

HOUSEHOLDS: 20,323 (18.7%)  
MEDIAN AGE: 32.5



### TRENDSETTERS

HOUSEHOLDS: 13,391 (12.3%)  
MEDIAN AGE: 36.3

## 10 MIN DRIVE 10 MIN WALK

	POPULATION	255,196	2,099
	DAYTIME POPULATION	252,327	2,012
	AVG HH INCOME	\$134,075	\$63,647
	EDUCATION	34.7%	31.3%
	HOUSEHOLDS	108,447	841

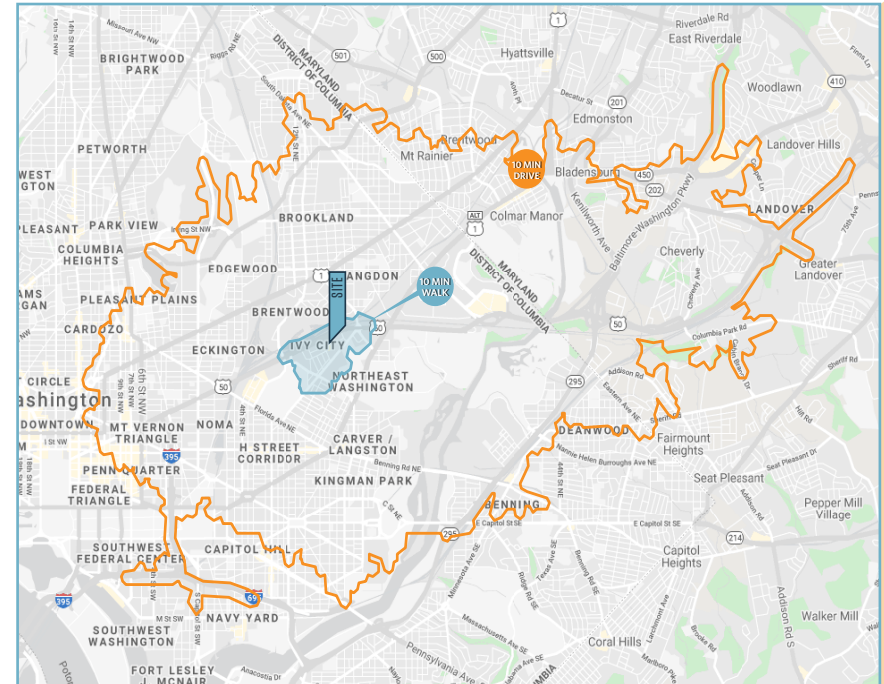

## TRAFFIC COUNTS

NEW YORK AVE.....71,068 ADT

**VICTOR SALCIDO**

vsalcido@klnb.com | 240-755-2704

**JOE FLEISCHMANN**

joef@klnb.com | 703-268-2708

**MICHAEL PRATT**

mpratt@klnb.com | 202-420-7765

**klnb**



# 2 STORY OPPORTUNITY AT IVY CITY

1509 NEW YORK AVE NE, WASHINGTON, DC 20002



FOR MORE INFORMATION, PLEASE CONTACT:

<b>VICTOR SALCIDO</b>	<b>JOE FLEISCHMANN</b>	<b>MICHAEL PRATT</b>
valscido@klnb.com	joef@klnb.com	mpratt@klnb.com
240-755-2704	703-268-2708	202-420-7765

[CLICK TO VIEW PROPERTY WEBSITE](#)

While we have no reason to doubt the accuracy of any of the information supplied, we cannot, and do not, guarantee its accuracy. All information should be independently verified prior to a purchase or lease of the property. We are not responsible for errors, omissions, misuse, or misinterpretation of information contained herein and make no warranty of any kind, express or implied, with respect to the property or any other matters.