

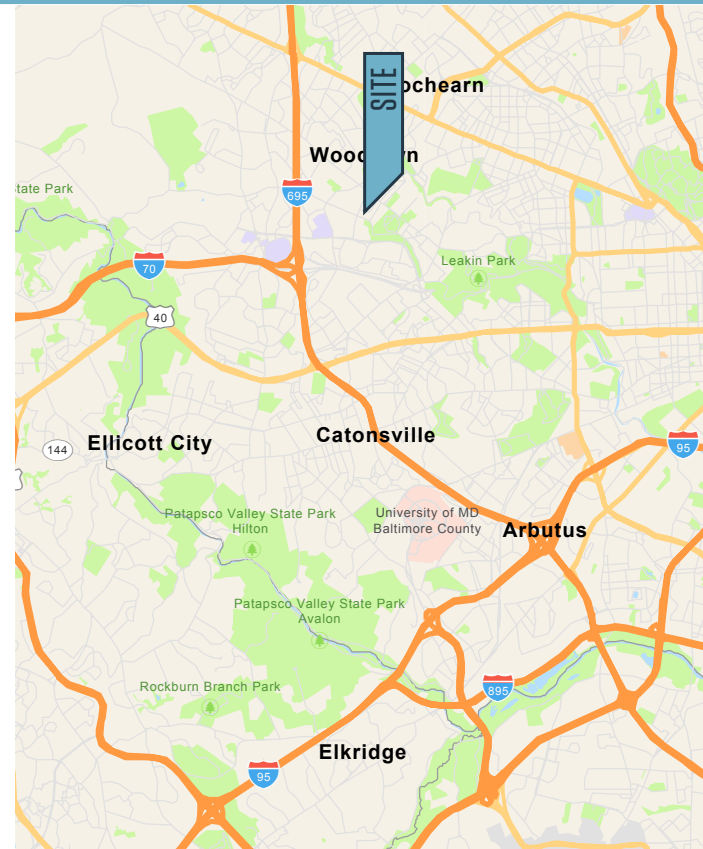

# FOR LEASE

## PROPERTY HIGHLIGHTS:

- Fully renovated, 41,746 SF two-story office building
- Rental Rate: \$11.95 PSF, NNN
- 12,713 SF available for lease
- Ample parking - 174 parking spaces
- Flexible ML zoning permits a wide variety of office, medical, and clinical uses
- Located near I-70 and I-695
- Close to food, shopping, banking, lodging & other amenities





# 1849 GWYNN OAK AVENUE

Woodlawn, MD 21207 | Baltimore County

## PHOTOS



**Austin Eber**  
aeber@klnb.com  
443-791-8280

**Colin Dempsey**  
cdempsey@klnb.com  
443-841-0529



## PROPOSED PLAN: TOTAL VACANCY = 12,713 SF

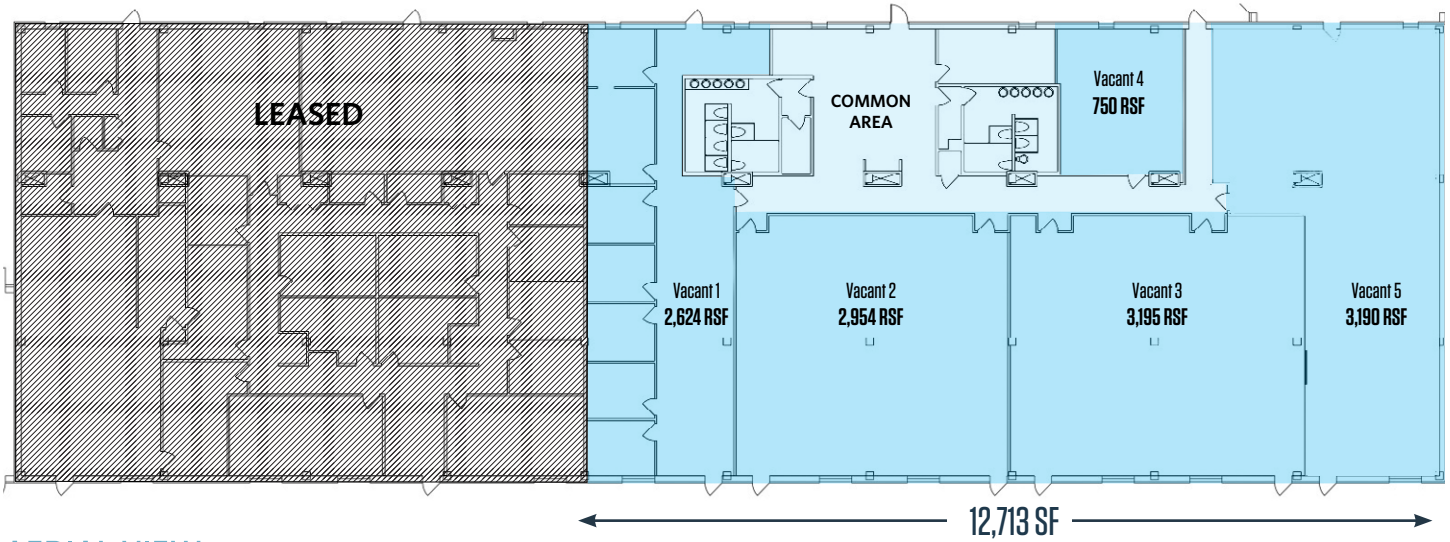

## AERIAL VIEW





# 1849 GWYNN OAK AVENUE

Woodlawn, MD 21207 | Baltimore County



## MARKET AERIAL



While we have no reason to doubt the accuracy of any of the information supplied, we cannot, and do not, guarantee its accuracy. All information should be independently verified prior to a purchase or lease of the property. We are not responsible for errors, omissions, misuse, or misinterpretation of information contained herein and make no warranty of any kind, express or implied, with respect to the property or any other matters.

**Austin Eber**  
aeber@klnb.com  
443-791-8280

**Colin Dempsey**  
cdempsey@klnb.com  
443-841-0529