

**MEDICAL / RETAIL / OFFICE SPACE**



**FOR LEASE**

## PROPERTY HIGHLIGHTS

- **Move-in Ready Premium Medical/Retail/Office Space**
- **Available Space:** Unit 1-2: 5,730 SF
- **Rental Rate:** \$24.50 PSF/NNN
- **Operating Expenses:** \$3.59 PSF
- **Size:** 30,000 SF Building on 4.62 Acre Site
- **Zoning:** CECLI (Ambulatory health care facilities permitted)
- **Space Use:** Medical / Retail / Office
- **Location:** Building faces Washington Blvd. (Rt. 1) with signalized intersection at Rt. 1 & Business Pkwy
- **Year Built:** 2005
- **Access:** Excellent access to Route 1, I-95 & Route 100
- **Average Daily Traffic Count:** 28,890 cars per day

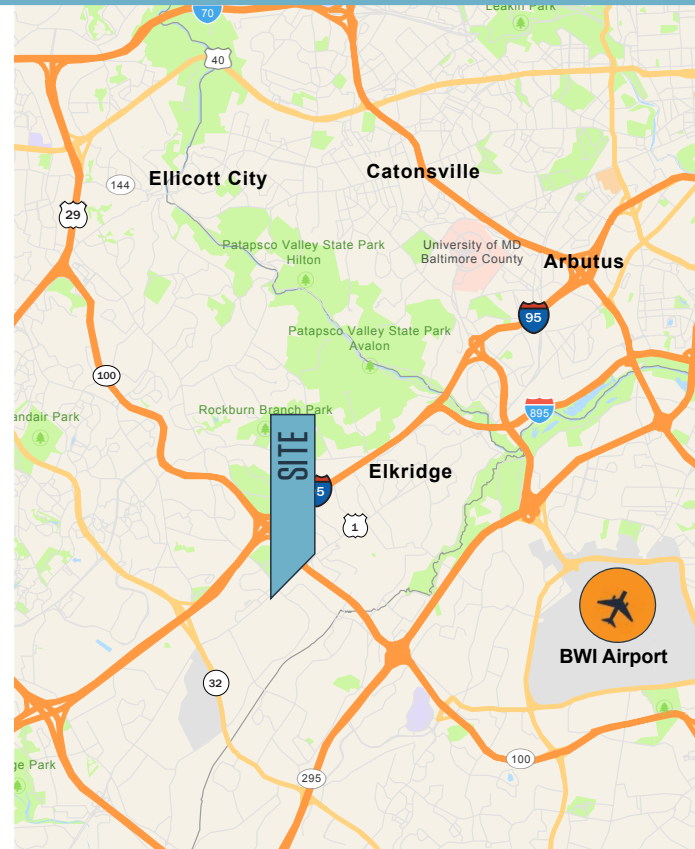

# 6785 BUSINESS PKWY

Elkridge, MD 21075 | Howard County

## FLOOR PLAN | UNIT 1-2

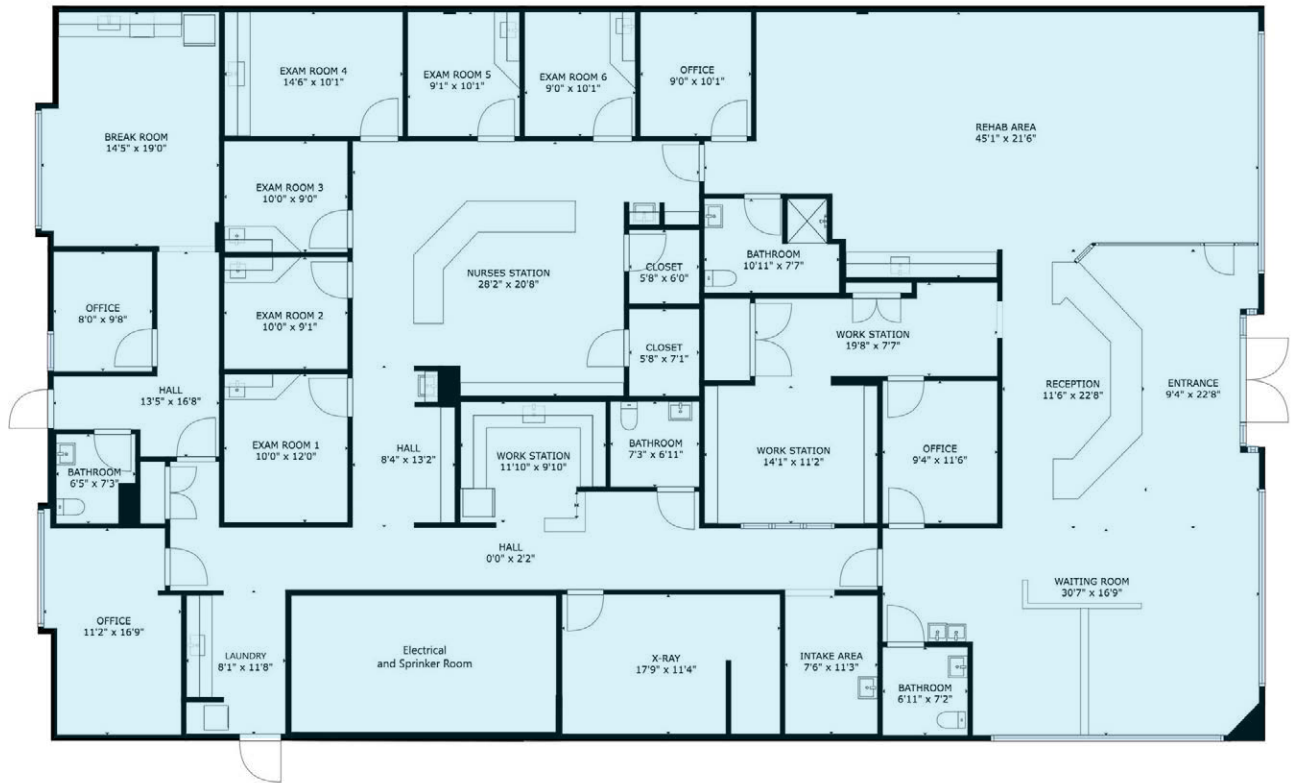

## AERIAL VIEW



Austin Eber  
aeber@klnb.com  
443-574-1414

Chuck Breitenother  
cbreitenother@klnb.com  
443-574-1422



## PHOTOS



LOBBY ENTRANCE



PHYSICAL THERAPY AREA



OFFICE



X-RAY AREA



EXAM ROOM

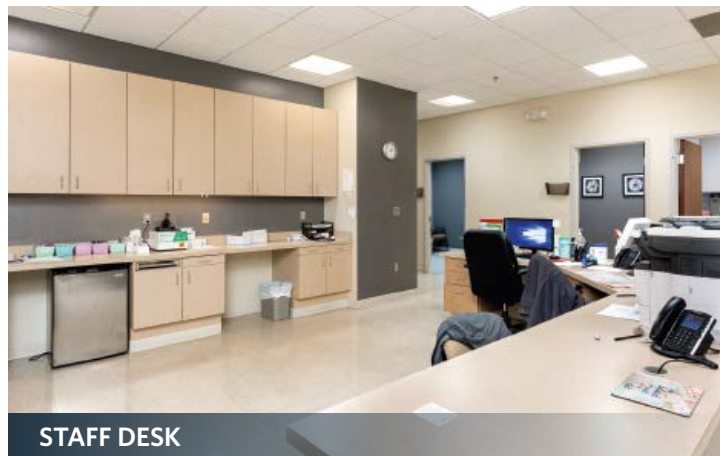

STAFF DESK



# 6785 BUSINESS PKWY

Elkridge, MD 21075 | Howard County

## MARKET AERIAL

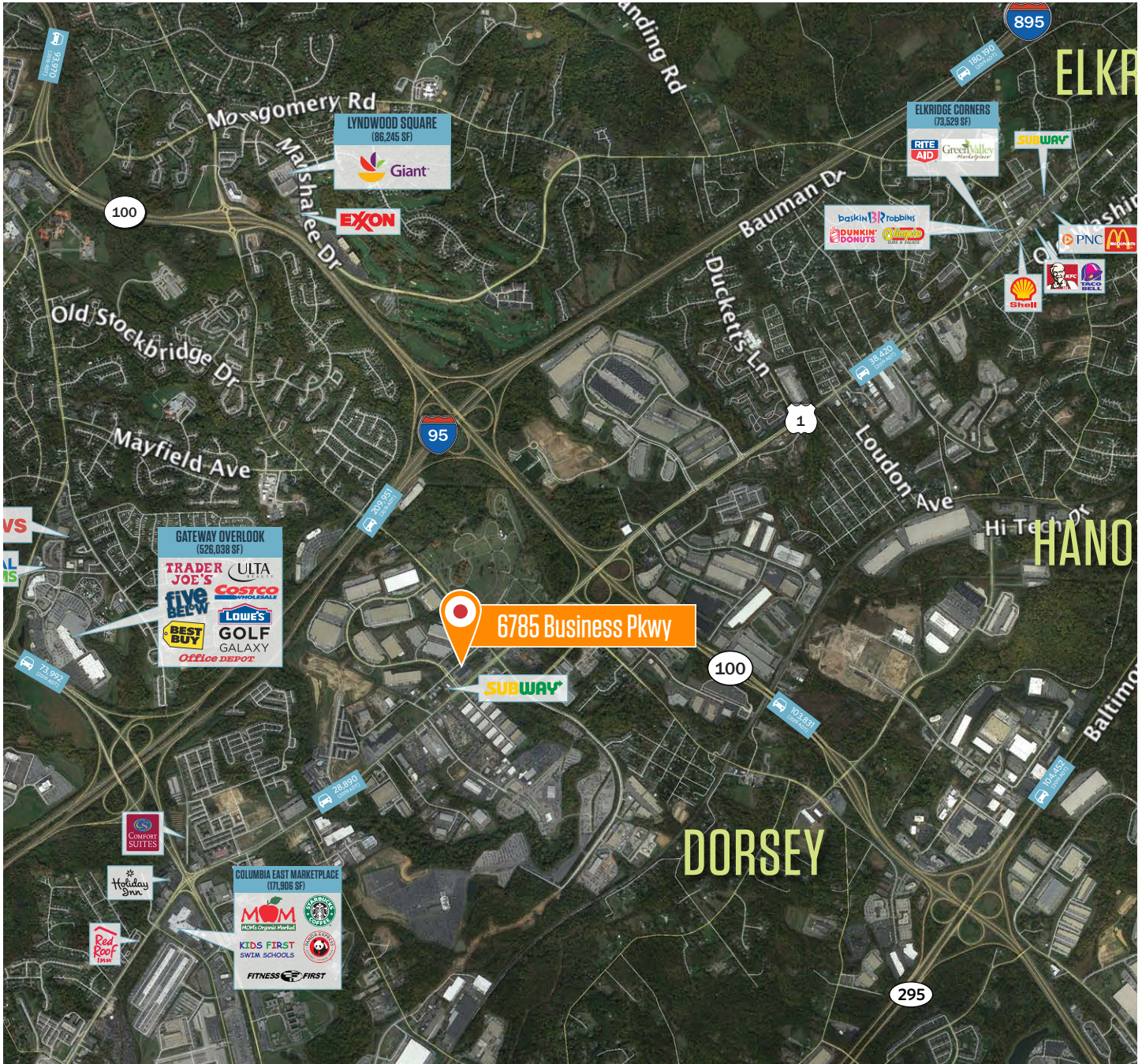

While we have no reason to doubt the accuracy of any of the information supplied, we cannot, and do not, guarantee its accuracy. All information should be independently verified prior to a purchase or lease of the property. We are not responsible for errors, omissions, misuse, or misinterpretation of information contained herein and make no warranty of any kind, express or implied, with respect to the property or any other matters.

Austin Eber  
aeber@klnb.com  
443-574-1414

Chuck Breitenother  
cbreitenother@klnb.com  
443-574-1422