



FOR SUBLEASE

PROPERTY HIGHLIGHTS:

Suite Highlights

- Suite 4300 - 4400:
± 10,774 RSF available
- Rental Rate: Competitive
- Term: Through June, 2030
- Condition: Newly delivered space, never occupied, with furniture included
- Occupancy: April 1, 2023

Building Highlights

- 88-acre park featuring Class A office and retail, located one mile from I-95 with easy access to Route 29 & Route 175
- Parking: Abundant surface parking
- On-site fitness center, shared 32-seat conference room and full-service restaurant in park

Nearby Amenities

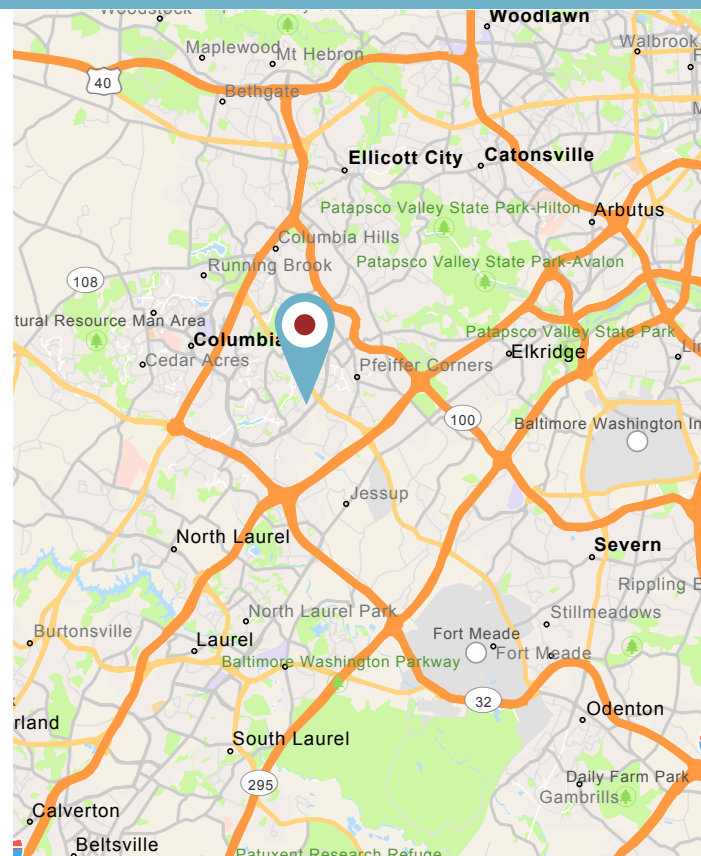

8840 STANFORD BLVD

Columbia, MD 21045 | Howard County

FLOOR PLANS

10,774 SF
SUITE 4300 - 4400

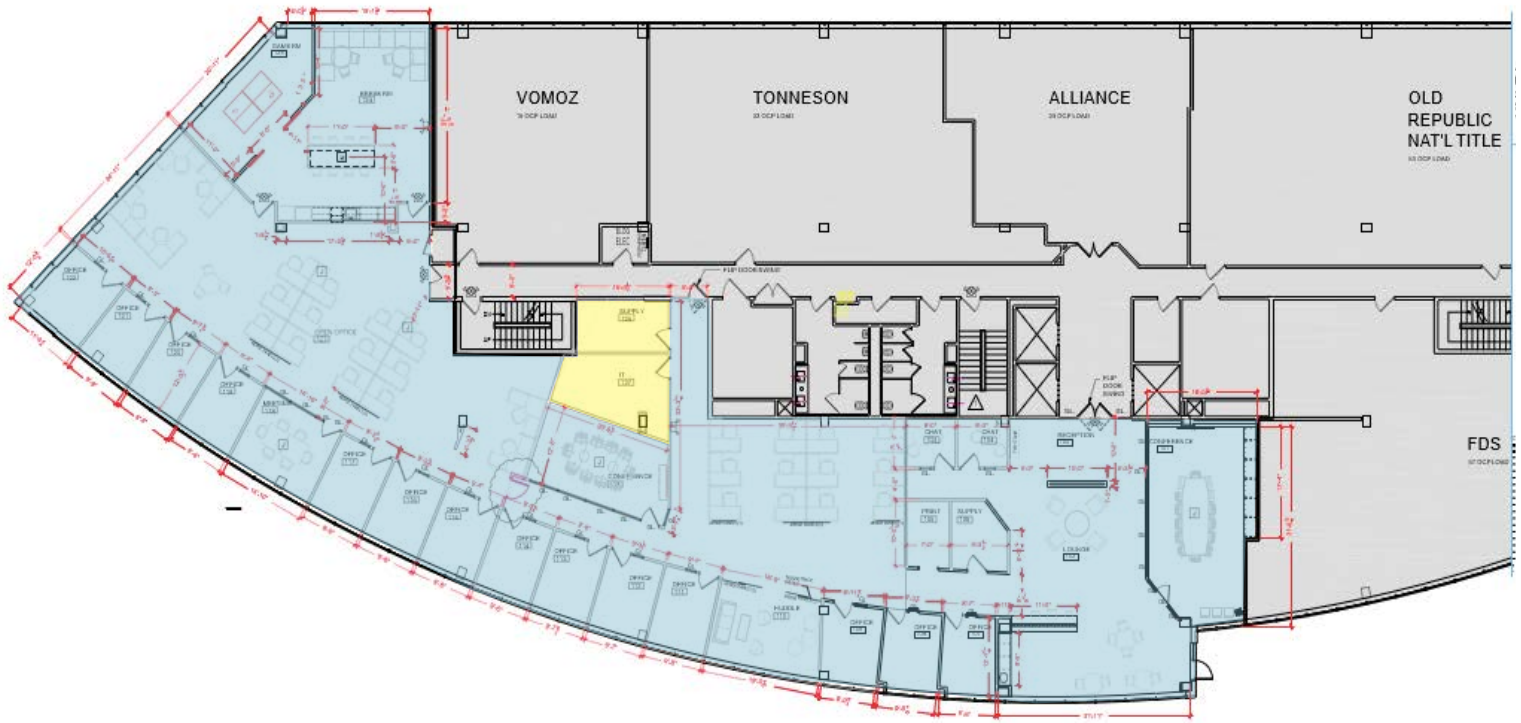

PHOTOS



OFFICE CUBE



OFFICE CUBE



KITCHEN

8840 STANFORD BLVD

Columbia, MD 21045 | Howard County

MARKET AERIAL

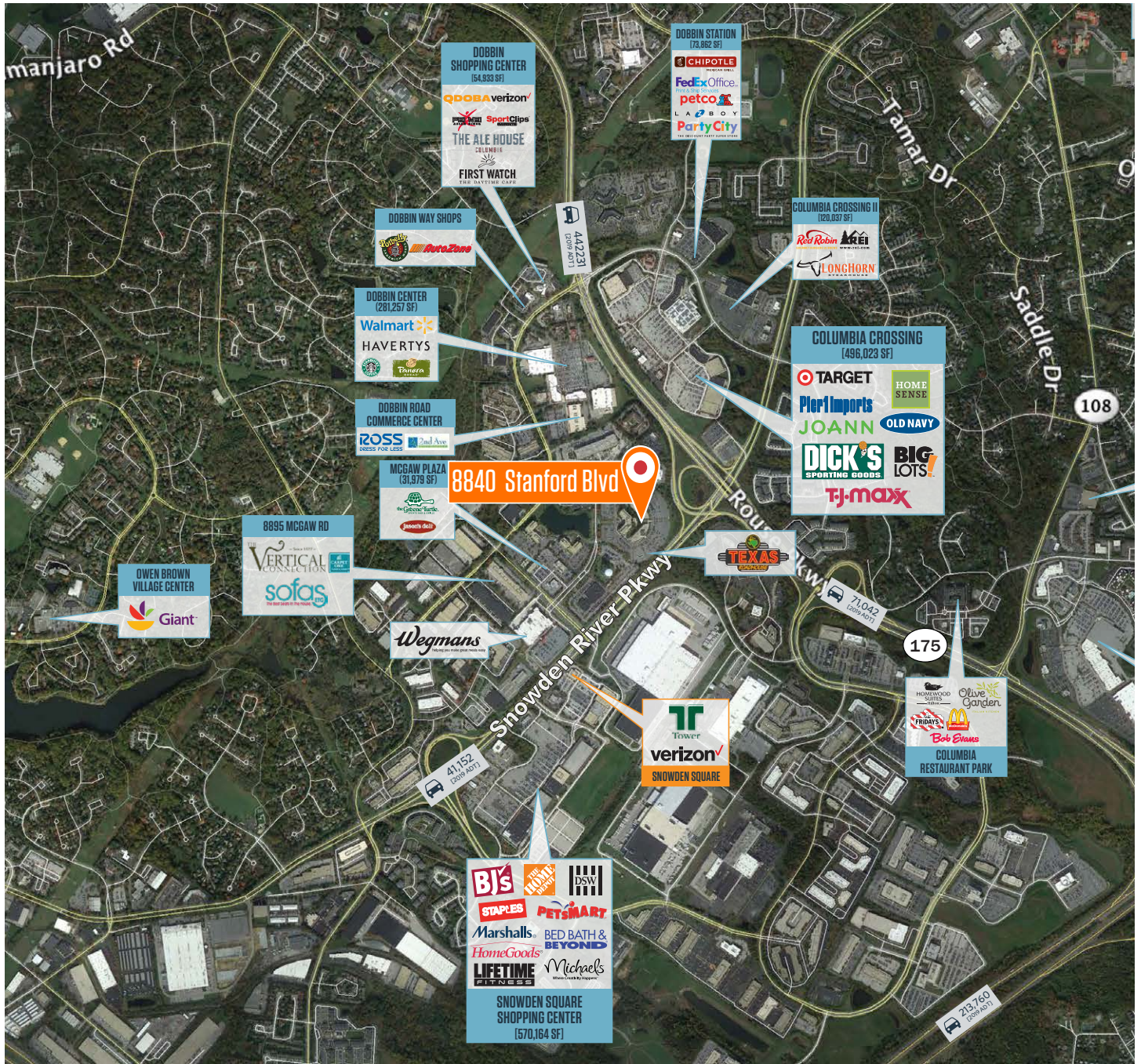

While we have no reason to doubt the accuracy of any of the information supplied, we cannot, and do not, guarantee its accuracy. All information should be independently verified prior to a purchase or lease of the property. We are not responsible for errors, omissions, misuse, or misinterpretation of information contained herein and make no warranty of any kind, express or implied, with respect to the property or any other matters.

Steele Stanwick
sstanwick@klnb.com
443-574-1420

David J. Fritz, CCIM, SIOR
dfritz@klnb.com
443-574-1410