



## FOR SUBLEASE

### PROPERTY HIGHLIGHTS

#### Suite Highlights

- **Suite 100:** 5,000 - 10,648 square feet available
- **Lease Rate:** \$27.00 per square foot, Full Service
- **Term:** Through 10/31/25
- First floor space

#### Building Highlights

- 26-acre park featuring Class A office and mixed use retail, located 3 minutes from I-95 with easy access to Routes 100, 29, and 175
- **Parking:** Abundant surface and garage parking
- On-site fitness center; walkable restaurants

#### Nearby Amenities

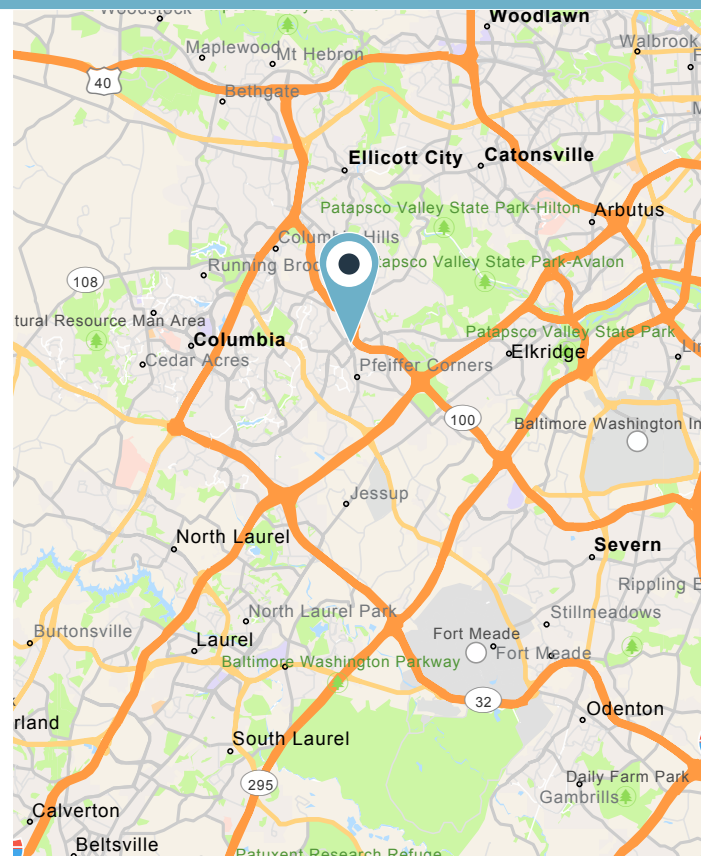

# 6021 UNIVERSITY BLVD

Suite 100, Ellicott City, MD 21043 | Howard County

## FLOOR PLAN | SUITE 100

10,648 SF

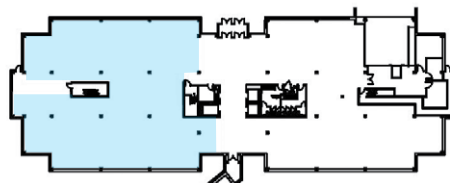
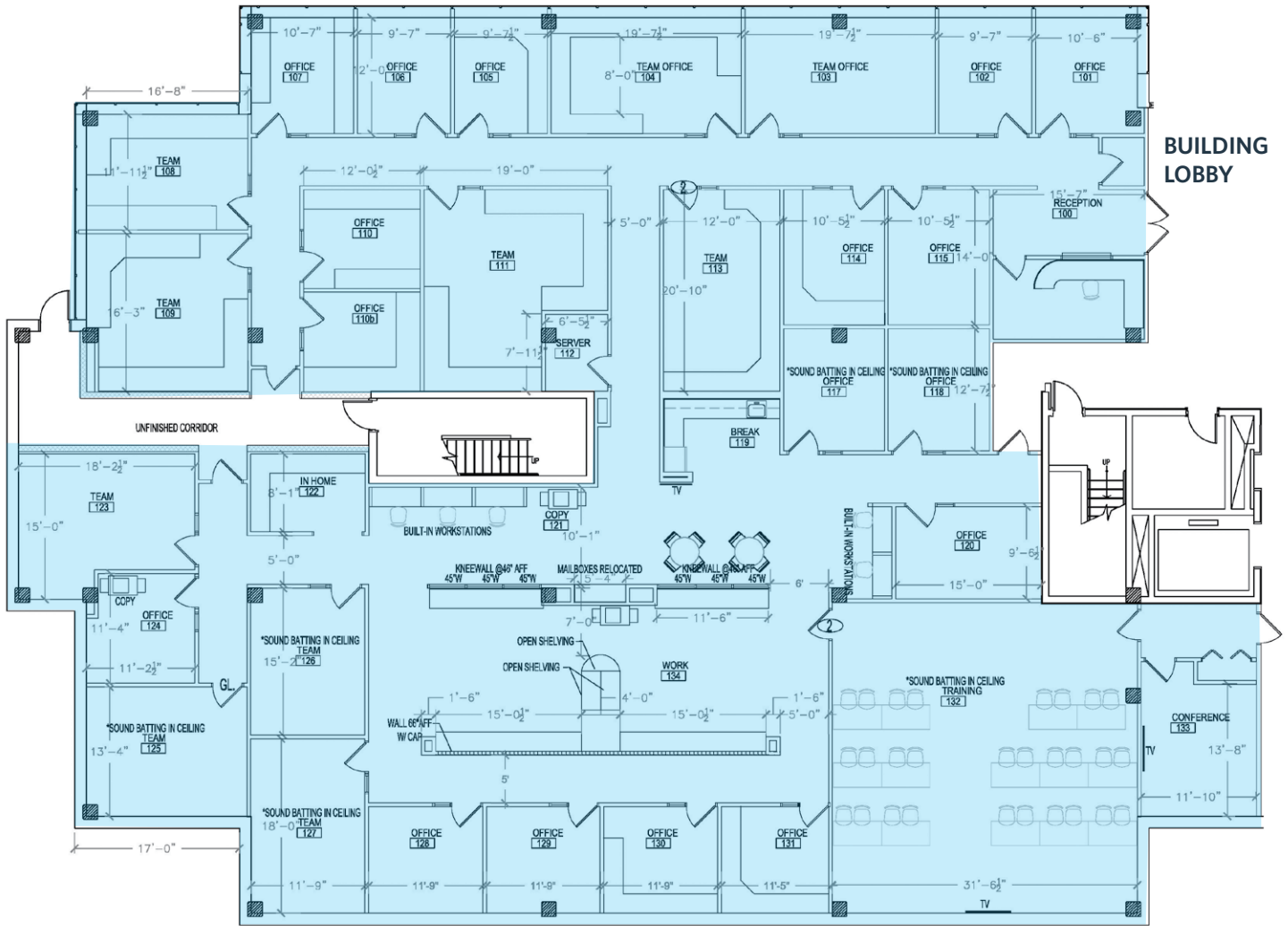

## PHOTOS



EXTERIOR SIDE VIEW



LOBBY



OUTSIDE SEATING WITH FOUNTAIN

# 6021 UNIVERSITY BLVD

Suite 100, Ellicott City, MD 21043 | Howard County

## MARKET AERIAL



While we have no reason to doubt the accuracy of any of the information supplied, we cannot, and do not, guarantee its accuracy. All information should be independently verified prior to a purchase or lease of the property. We are not responsible for errors, omissions, misuse, or misinterpretation of information contained herein and make no warranty of any kind, express or implied, with respect to the property or any other matters.