

LAND FOR SALE OR LEASE

➤ 3.1 Acres

- Located at the intersection of Route 100 & Route 3 (Meadowridge Road)
- Convenient access to I-95, I-695, Routes 29 & 295
- Minutes to Columbia Town Center, BWI, Arundel Mills Mall & Fort Meade

- POR (Planned Office Research) District for a 50,000 SF office building which could include:
 - » Senior Housing
 - » Financial Institutions
 - » Medical Office
 - » Hotels
 - » Professional Office
 - » Nursing Homes
 - » Ambulatory Healthcare Facilities, including Pharmacies
 - » Assisted Living Facilities

LOCATION

THE WEXLEY AT 100

5865 MEADOWRIDGE ROAD, ELLICOTT CITY, MD 21043, HOWARD COUNTY

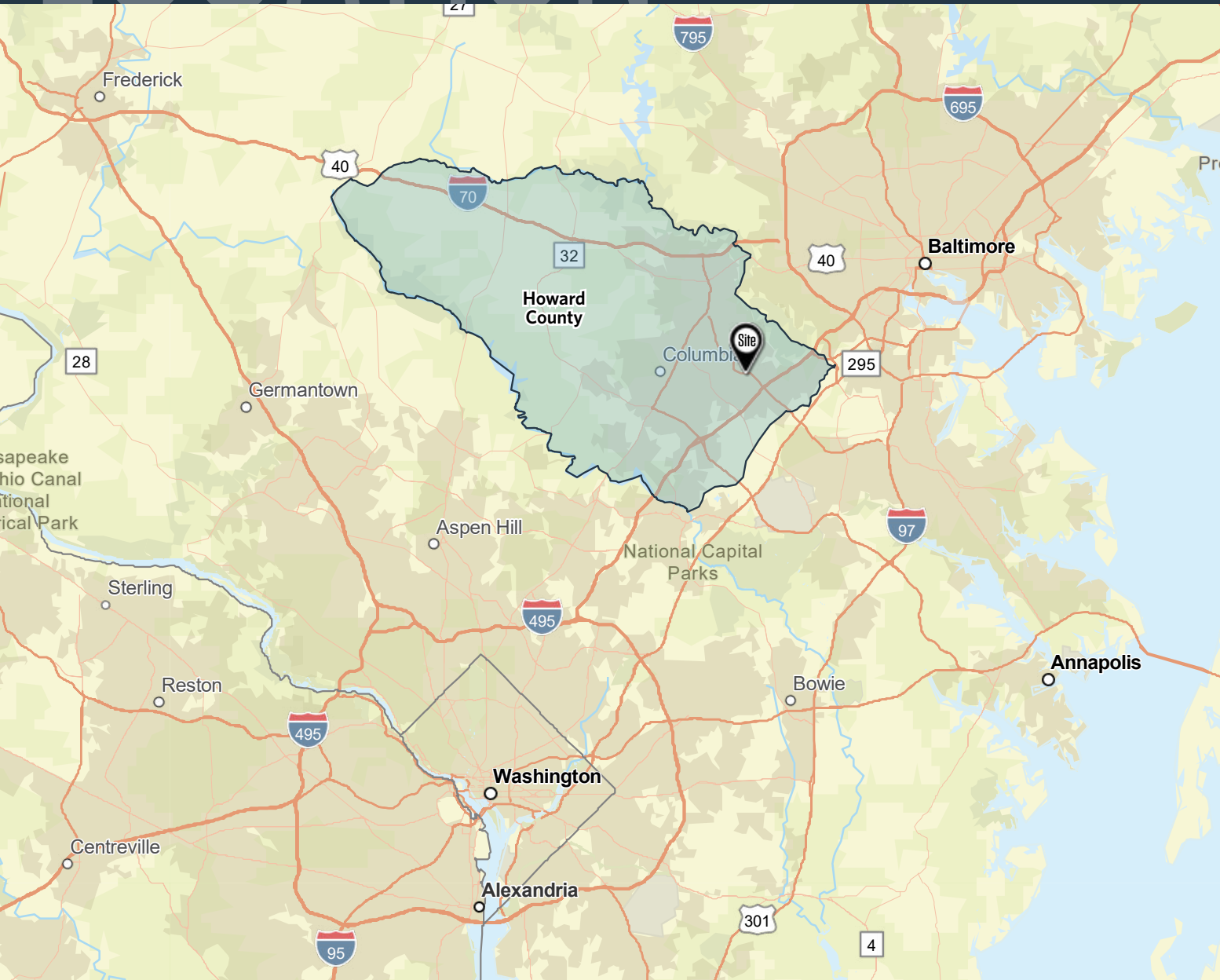

HOWARD COUNTY DEMOGRAPHICS



POPULATION
340,295



HOUSEHOLDS
121,384



MEDIAN
AGE
40.1



MEDIAN
HH INCOME
\$132,483



DISPOSABLE
INCOME
\$102,704



MEDIAN
NET WORTH
\$540,522

ABBY GLASSBERG

aglassberg@klnb.com | 443-574-1433

NAIkl**nb**

SITE PLAN

THE WEXLEY AT 100

5865 MEADOWRIDGE ROAD, ELLICOTT CITY, MD 21043, HOWARD COUNTY

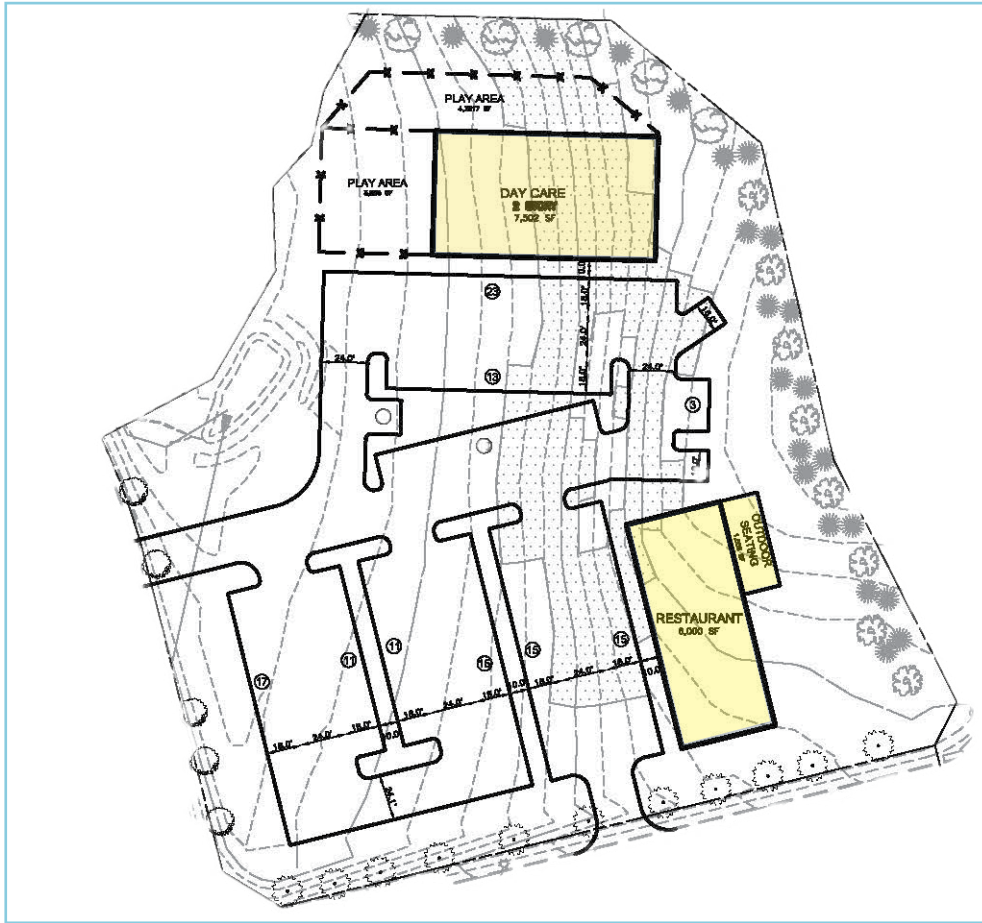

SITE PLAN



POR (PLANNED OFFICE RESEARCH) LAYOUT

ABBY GLASSBERG

aglassberg@klnb.com | 443-574-1433



FOR MORE INFORMATION, PLEASE CONTACT:

ABBY GLASSBERG

aglassberg@klnb.com | 443-574-1433

9881 Broken Land Parkway, Suite 300, Columbia, MD 21046

.....

klnb.com

 facebook.com/KLNB

 [@KLNBLLC](https://twitter.com/KLNBLLC)

 linkedin.com/company/klnb

 instagram.com/klnbllc

[CLICK TO VIEW PROPERTY WEBSITE](#)