



NEARBY RETAILERS



RETAIL LAND FOR LEASE

- Approximately 8.55 acres for Lease.
- Excellent access and visibility off Rt 272
- Regionally located near I-95 & Rt. 40
- Ideal for convenience, automotive, fast food, grocery, or car wash.
- Signalized ingress and egress
- Zoned BG [Business General]

COOPER HENRY

chenry@klnb.com | 443-632-2085

JOE MEKULSKI

jmekulski@klnb.com | 443-632-1343

LOCATION

NORTH EAST RD & NAZARENE CAMP RD

NORTH EAST, MD 21901, CECIL COUNTY

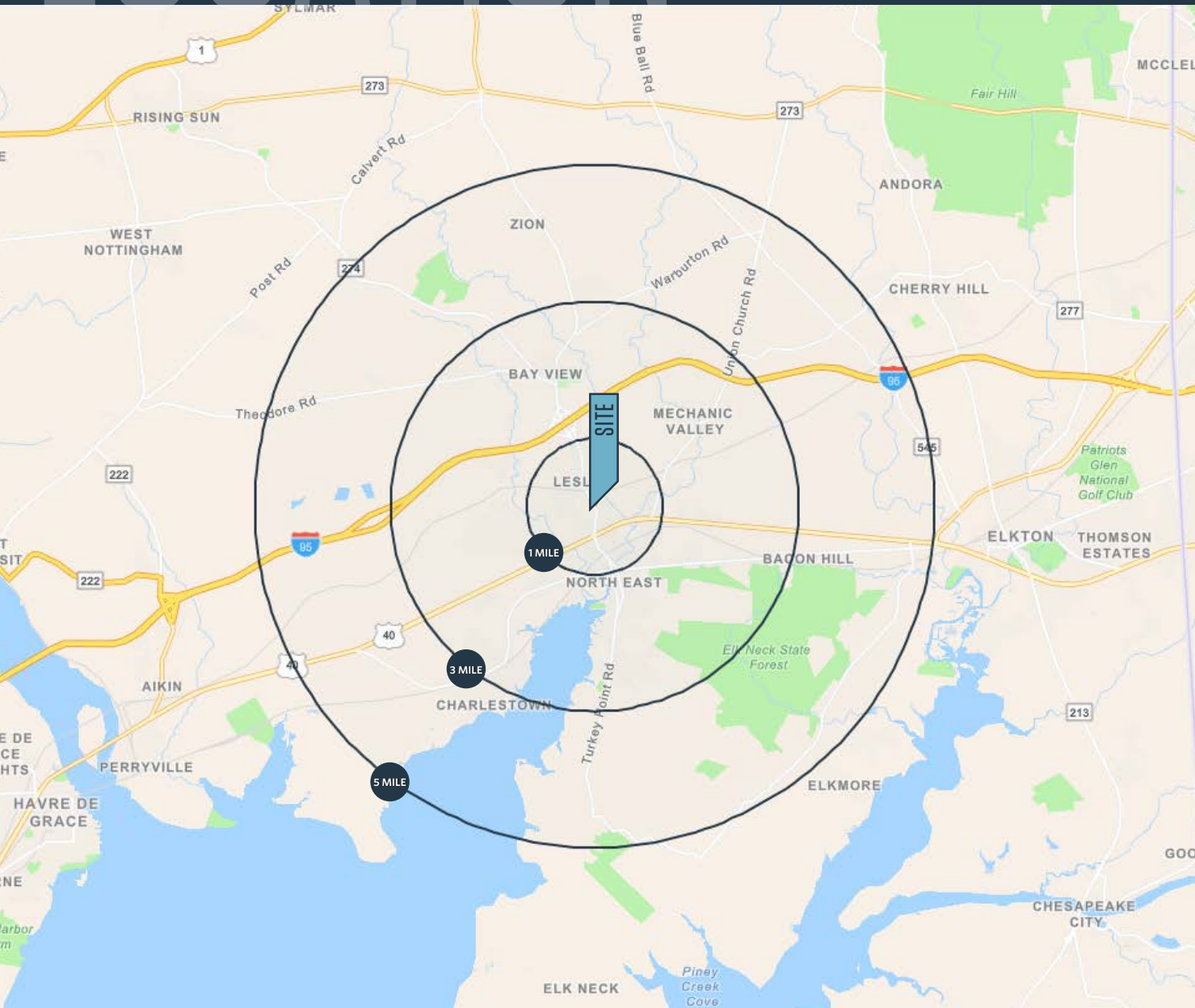

PROPERTY HIGHLIGHTS:

Approxiametly 8.55 Acres Available

DEMOGRAPHICS | 2022:

1-MILE	3-MILE	5-MILE
Population		
4,553	16,941	27,372
Daytime Population		
4,774	14,105	22,373
Households		
1,643	6,580	10,392
Average HH Income		
\$74,817	\$92,184	\$100,471

[CLICK TO DOWNLOAD DEMOGRAPHIC REPORT](#)

TRAFFIC COUNTS | 2021:

MD-272	21,602 ADT
Pulaski Hwy	26,810 ADT

COOPER HENRY

chenry@klnb.com | 443-632-2085

JOE MEKULSKI

jmekulski@klnb.com | 443-632-1343

klnb

MARKET

NORTH EAST RD & NAZARENE CAMP RD

NORTH EAST, MD 21901, CECIL COUNTY



COOPER HENRY

chenry@klnb.com | 443-632-2085

JOE MEKULSKI

jmekulski@klnb.com | 443-632-1343

klnb

CLOSE-UP

NORTH EAST RD & NAZARENE CAMP RD

NORTH EAST, MD 21901, CECIL COUNTY



COOPER HENRY

chenry@klnb.com | 443-632-2085

JOE MEKULSKI

jmekulski@klnb.com | 443-632-1343

klnb

CONCEPTUAL SITE PLAN

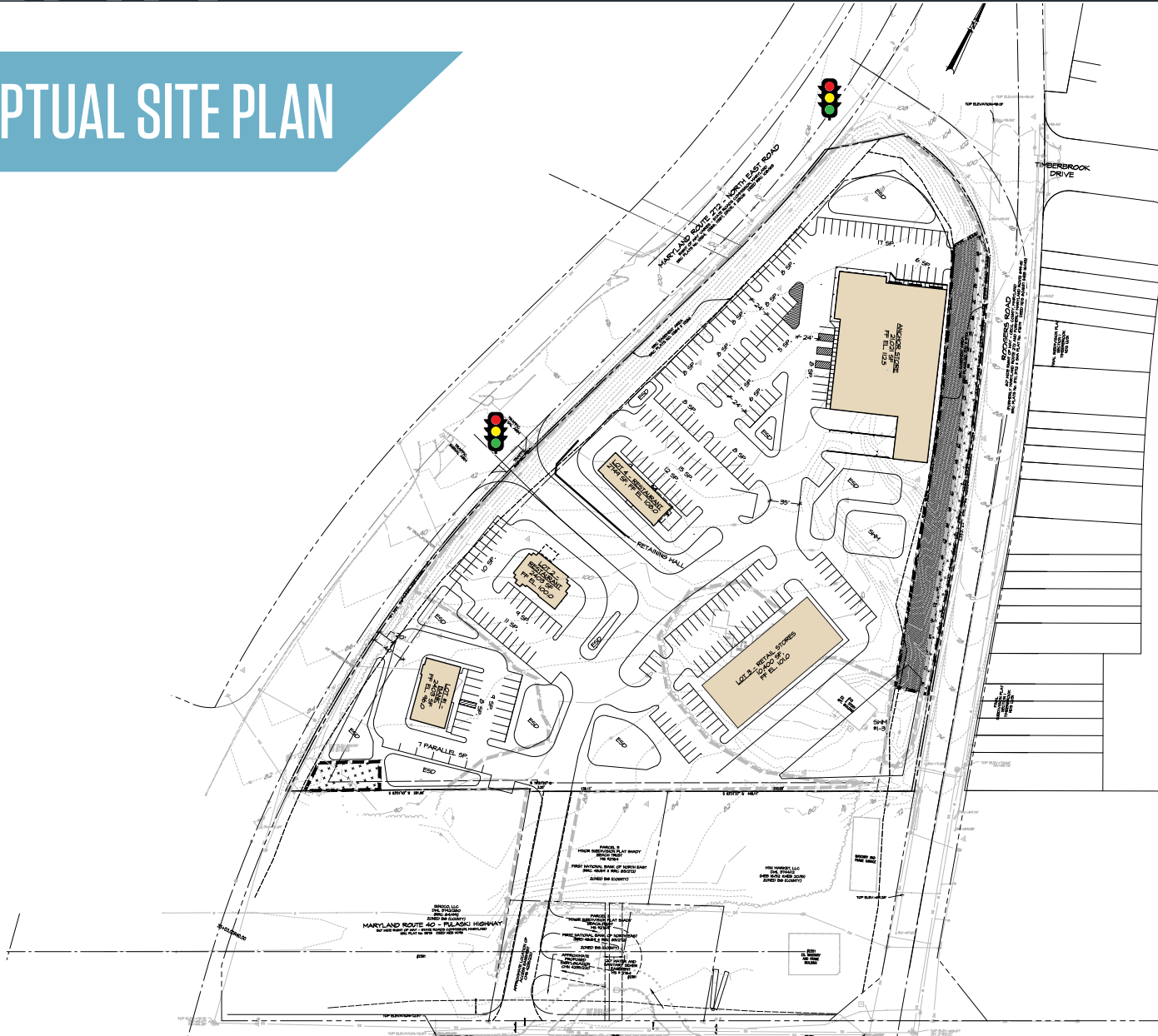



NORTH EAST RD & NAZARENE CAMP RD

NORTH EAST, MD 21901, CECIL COUNTY

FOR MORE INFORMATION, PLEASE CONTACT:

COOPER HENRY

chenry@klnb.com
443-632-2085

JOE MEKULSKI

jmekulski@klnb.com
443-632-1343

100 West Road, Suite 505, Towson, MD 21204

.....

klnb.com



CLICK TO VIEW PROPERTY WEBSITE

While we have no reason to doubt the accuracy of any of the information supplied, we cannot, and do not, guarantee its accuracy. All information should be independently verified prior to a purchase or lease of the property. We are not responsible for errors, omissions, misuse, or misinterpretation of information contained herein and make no warranty of any kind, express or implied, with respect to the property or any other matters.