



UP TO 28,353 RSF AVAILABLE

SPACE HIGHLIGHTS

- Suite M100 - 1,571 RSF
- Suite 200 - 12,827 RSF
 - Not Available until May 2031
 - Rental Rate: Negotiable
- Suite 210C - 2,010 RSF
- Suite 210 - 3,994 RSF
- Suite 300 - 4,544 RSF
- Suite 310 - 3,407 RSF
 - Suite M100, Suite 210C, Suite 210, Suite 300 and Suite 310 Available Now
 - Rental Rate: \$49.50-51.50 per RSF, Full Service

TIVOLI SQUARE

- Located in the Columbia Heights sub-market in the Giant anchored mixed-use project
- Columbia Heights Metro rail is a block away
- Located across from the DC USA retail complex
- Office tenant and retail parking available



MEZZANINE

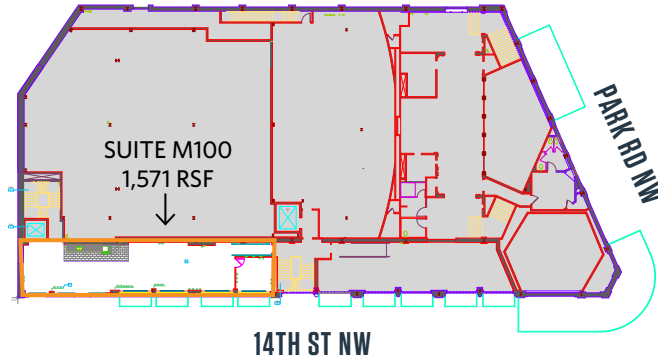

SECOND FLOOR

WHOLE SECOND FLOOR

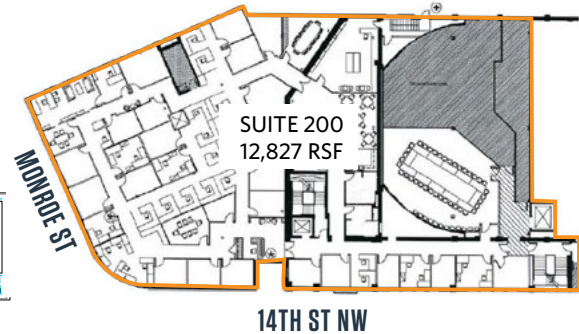
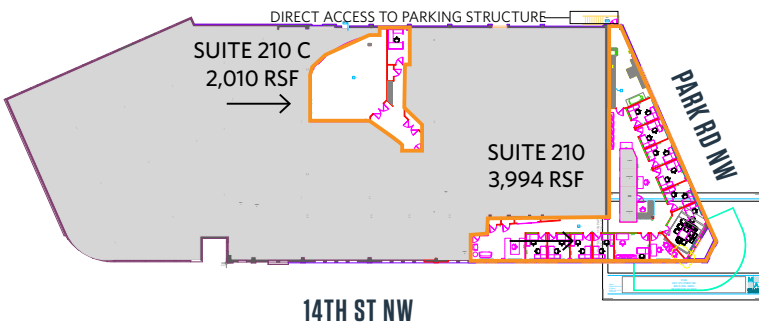

THIRD FLOOR

