



NEARBY ATTRACTIONS



BUILDING FOR SALE/LEASE

- 19,364 square foot two-story building available
 - 10,000 square foot street level
 - 9,364 square foot 2nd level
- 55,728 square foot parcel
- 68 dedicated parking spaces
- Rare corner location in the heart of downtown Kentlands adjacent to Starbucks

MATT SKALET

mkalet@klnb.com | 202-420-7775

KEN FELLOWS

kfellows@klnb.com | 301-222-0210

ROB PUGH

rpugh@klnb.com | 301-222-0211

LOCATION

189 KENTLANDS BLVD

189 KENTLANDS BLVD, GAITHERSBURG, MD 20878, MONTGOMERY COUNTY

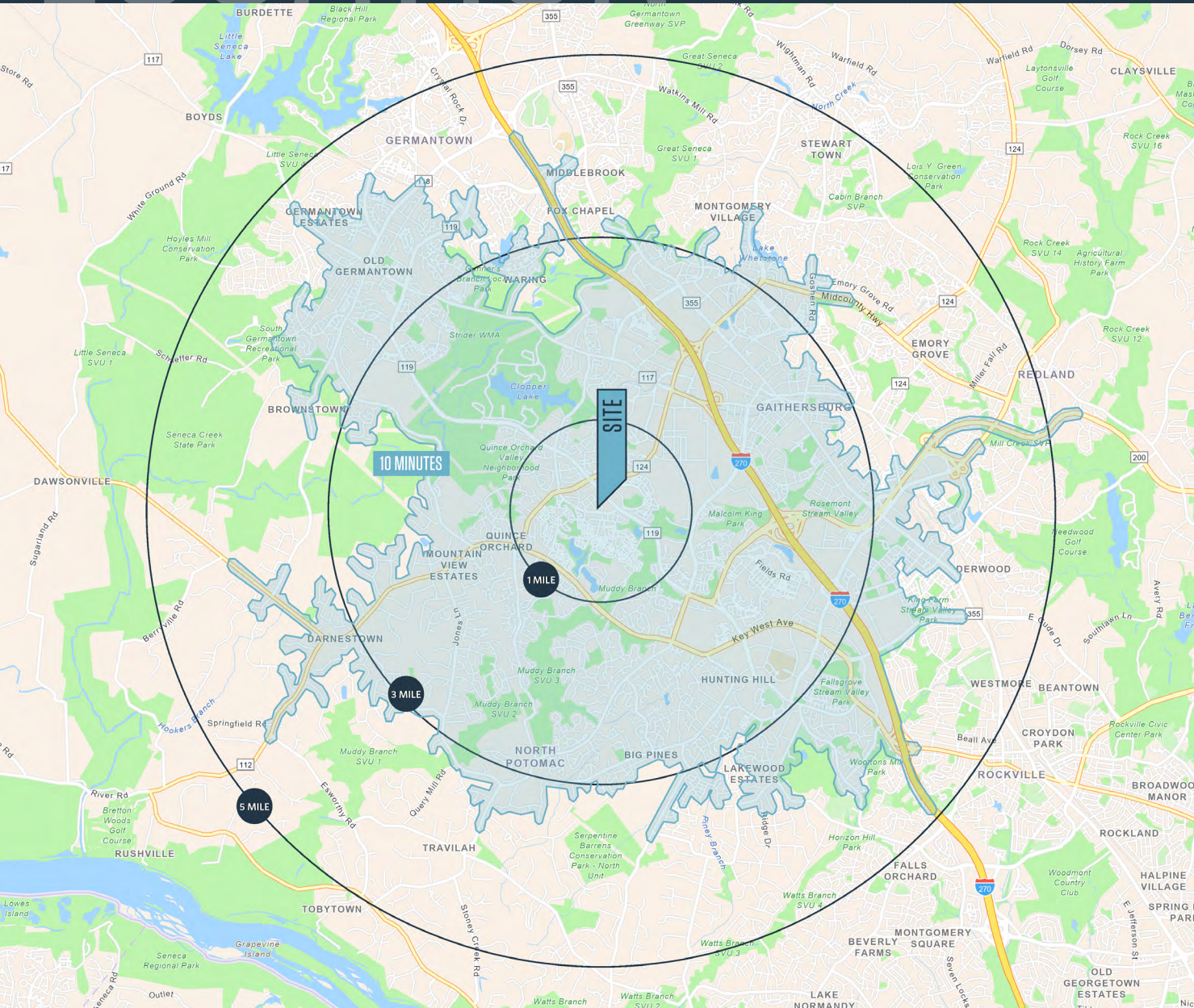

ASKING SALE PRICE:

\$6,100,000

DEMOGRAPHICS | 2023:

	1-MILE	3-MILE	5-MILE	10-MINUTE
Population	16,986	115,865	293,069	151,134
Daytime Population	16,391	130,879	284,924	163,759
Households	6,655	43,656	104,781	56,612
Average HH Income	\$196,204	\$155,983	\$155,155	\$154,536

[CLICK TO DOWNLOAD DEMOGRAPHIC REPORT](#)

TRAFFIC COUNTS | 2022:

Great Seneca Hwy [MD-119]	38,085 ADT
Quince Orchard Rd [MD-124]	16,791 ADT
Eisenhower Memorial Hwy [I-270]	198,411 ADT

MATT SKALET

maskalet@klnb.com | 202-420-7775

KEN FELLOWS

kfellows@klnb.com | 301-222-0210

ROB PUGH

rpugh@klnb.com | 301-222-0211



MARKET

189 KENTLANDS BLVD

189 KENTLANDS BLVD, GAITHERSBURG, MD 20878, MONTGOMERY COUNTY



MATT SKALET

maskalet@klnb.com | 202-420-7775

KEN FELLOWS

kfellows@klnb.com | 301-222-0210

ROB PUGH

rpugh@klnb.com | 301-222-0211



189 KENTLANDS BLVD

189 KENTLANDS BLVD, GAITHERSBURG, MD 20878, MONTGOMERY COUNTY



MATT SKALET

maskalet@klnb.com | 202-420-7775

KEN FELLOWS

kfellows@klnb.com | 301-222-0210

ROB PUGH

rpugh@klnb.com | 301-222-0211

SITE PLAN

189 KENTLANDS BLVD

189 KENTLANDS BLVD, GAITHERSBURG, MD 20878, MONTGOMERY COUNTY

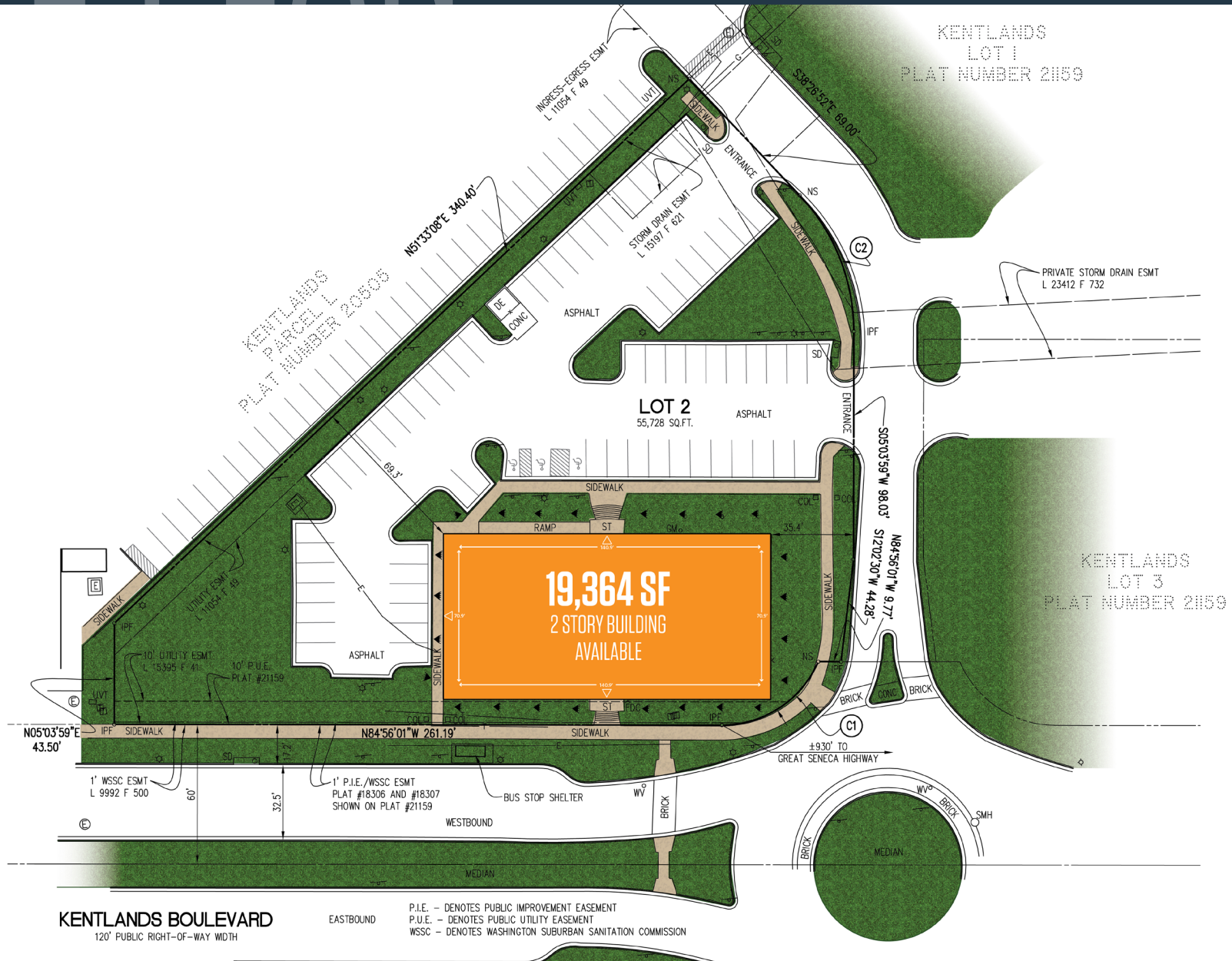

MATT SKALET

maskalet@klnb.com | 202-420-7775

KEN FELLOWS

kfellows@klnb.com | 301-222-0210

ROB PUGH

rpugh@klnb.com | 301-222-0211





189 KENTLANDS BLVD

189 KENTLANDS BLVD, GAITHERSBURG, MD 20878, MONTGOMERY COUNTY

FOR MORE INFORMATION, PLEASE CONTACT:

MATT SKALET

maskalet@klnb.com
202-420-7775

KEN FELLOWS

kfellows@klnb.com
301-222-0210

ROB PUGH

rpugh@klnb.com
301-222-0211

1130 Connecticut Avenue, Suite 600, Washington, DC 20036

.....

klnb.com

 facebook.com/KLNBCRE

 [@KLNBCRE](https://twitter.com/KLNBCRE)

 linkedin.com/company/klnb

 instagram.com/klnbcre

CLICK TO VIEW PROPERTY WEBSITE

While we have no reason to doubt the accuracy of any of the information supplied, we cannot, and do not, guarantee its accuracy. All information should be independently verified prior to a purchase or lease of the property. We are not responsible for errors, omissions, misuse, or misinterpretation of information contained herein and make no warranty of any kind, express or implied, with respect to the property or any other matters.