



## OFFICE SPACE FOR LEASE

The building is conveniently located at the Ryan Road exit of the Dulles Greenway, north of Loudoun County Parkway and 5 minutes from Washington Dulles International Airport. Scheduled to begin operation in early 2022, the Washington Metro Station Silver Line's Ashburn Station is within walking distance of the property. The property offers businesses excellent access in an amenity-rich location.



Type: 3 Star Office  
RBA: 60,000 SF  
Stories: 2  
Class: A

Construction: Masonry  
Year Built: 2007  
Parking: 3.75/1,000 SF  
Walk Score®: Somewhat Walkable (59)

**JESSE D. MARTIN**

[jmartin@klnb.com](mailto:jmartin@klnb.com) | 703-334-5620

**C. TODD MCMANUS**

[tmcmanus@klnb.com](mailto:tmcmanus@klnb.com) | 703-334-5622

# SITE AERIAL

# RYAN PARK OFFICE CENTER

43490 YUKON DRIVE, ASHBURN, VA 20147

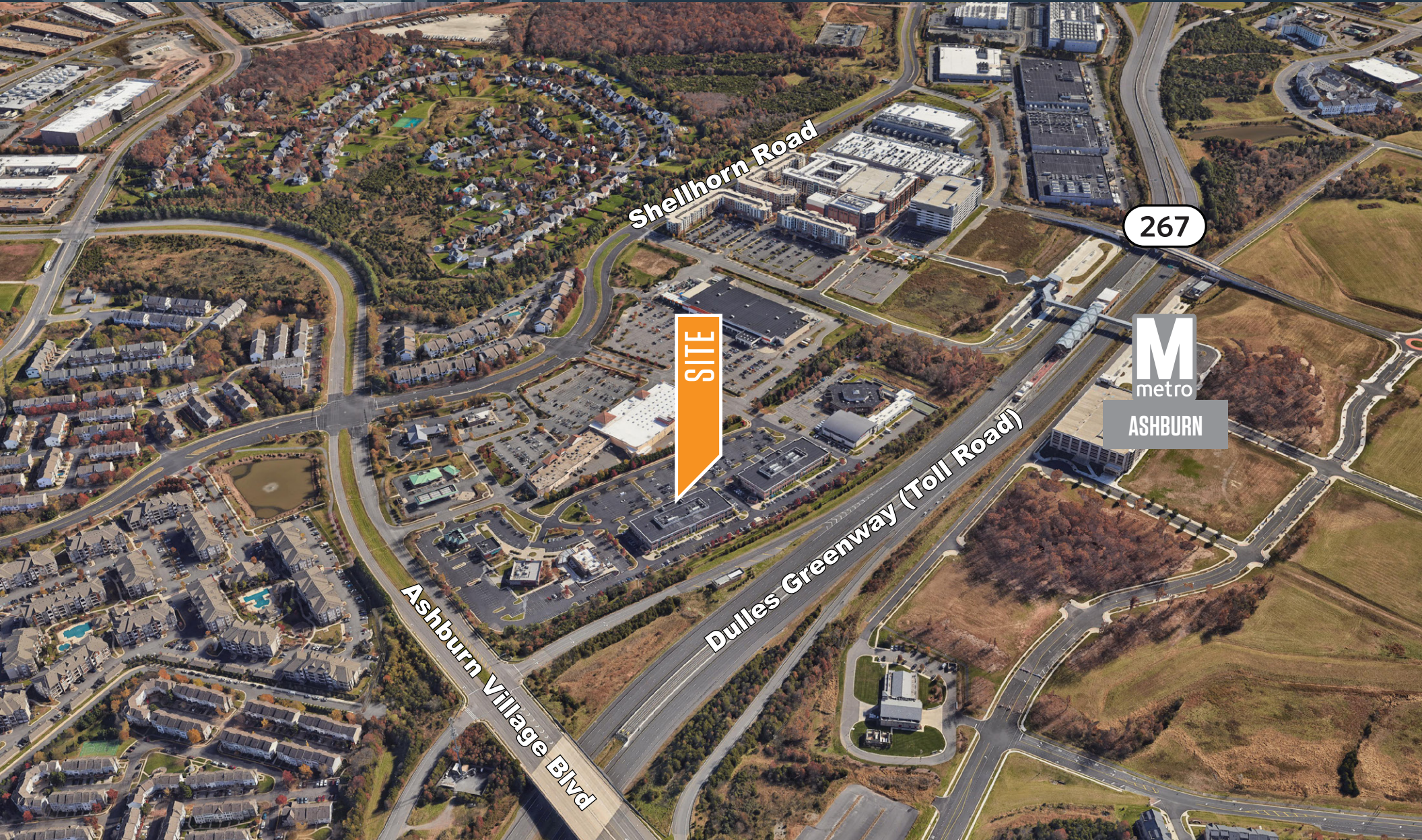

Shellhorn Road

267

SITE

M  
metro

ASHBURN

Ashburn Village Blvd

Dulles Greenway (Toll Road)

JESSE D. MARTIN

[jmartin@klnb.com](mailto:jmartin@klnb.com) | 703-334-5620

C. TODD MCMANUS

[tmcmanus@klnb.com](mailto:tmcmanus@klnb.com) | 703-334-5622



# MARKET

# RYAN PARK OFFICE CENTER

43490 YUKON DRIVE, ASHBURN, VA 20147

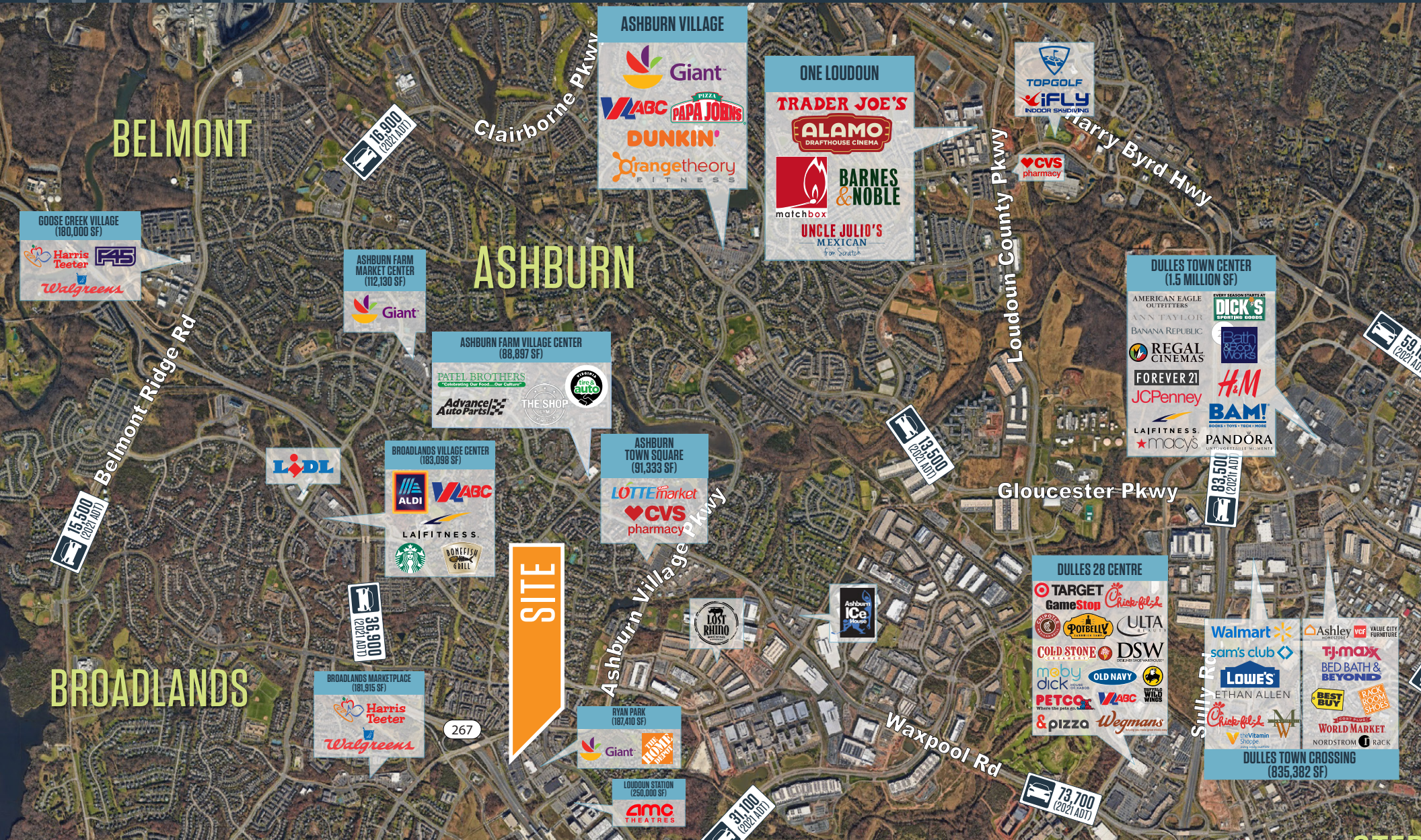

JESSE D. MARTIN  
 jmartin@klnb.com | 703-334-5620

C. TODD MCMANUS  
 tmcmanus@klnb.com | 703-334-5622



# FLOOR PLAN

# RYAN PARK OFFICE CENTER

43490 YUKON DRIVE, ASHBURN, VA 20147

## 2ND FLOOR 4,542 SF – 19,117 SF

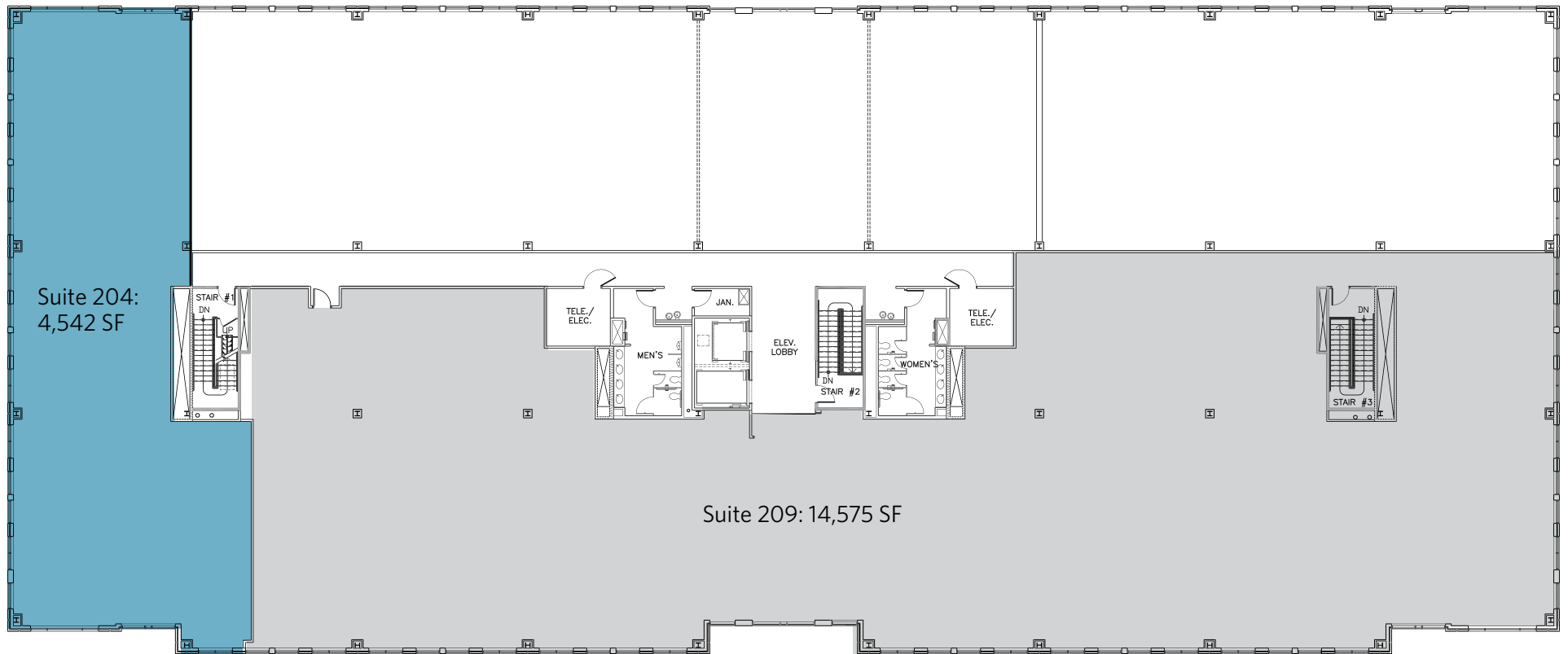

**JESSE D. MARTIN**

[jmartin@klnb.com](mailto:jmartin@klnb.com) | 703-334-5620

**C. TODD MCMANUS**

[tmcmanus@klnb.com](mailto:tmcmanus@klnb.com) | 703-334-5622





# RYAN PARK OFFICE CENTER

43490 YUKON DRIVE, ASHBURN, VA 20147

## FOR MORE INFORMATION, PLEASE CONTACT:

**JESSE D. MARTIN**

[jmartin@klnb.com](mailto:jmartin@klnb.com)

703-334-5620

**C. TODD MCMANUS**

[tmcmanus@klnb.com](mailto:tmcmanus@klnb.com)

703-334-5622

8065 Leesburg Pike, Suite 700, Tysons, VA 22182

.....

**klnb.com**

 [facebook.com/KLNBCRE](https://facebook.com/KLNBCRE)

 [linkedin.com/company/klnb](https://linkedin.com/company/klnb)

 [instagram.com/klnbcre](https://instagram.com/klnbcre)

**CLICK TO VIEW PROPERTY WEBSITE**

While we have no reason to doubt the accuracy of any of the information supplied, we cannot, and do not, guarantee its accuracy. All information should be independently verified prior to a purchase or lease of the property. We are not responsible for errors, omissions, misuse, or misinterpretation of information contained herein and make no warranty of any kind, express or implied, with respect to the property or any other matters.