



FOR SALE OR LEASE

PROPERTY HIGHLIGHTS

- **Lease Rate:** \$10.95 PSF, NNN
- **Sale Price:** Call for price
- **Total Building:** 39,565 SF
- **Available For Lease:** 10,000 - 39,000 SF (available 11/1/2023)
- **Access:** Easy access to I-695, I-70 and Route 26
- **Loading:** Two (2) dock doors with ability to add six (6) more
- 100% office with ability to convert to warehouse

NEARBY

JAE'S

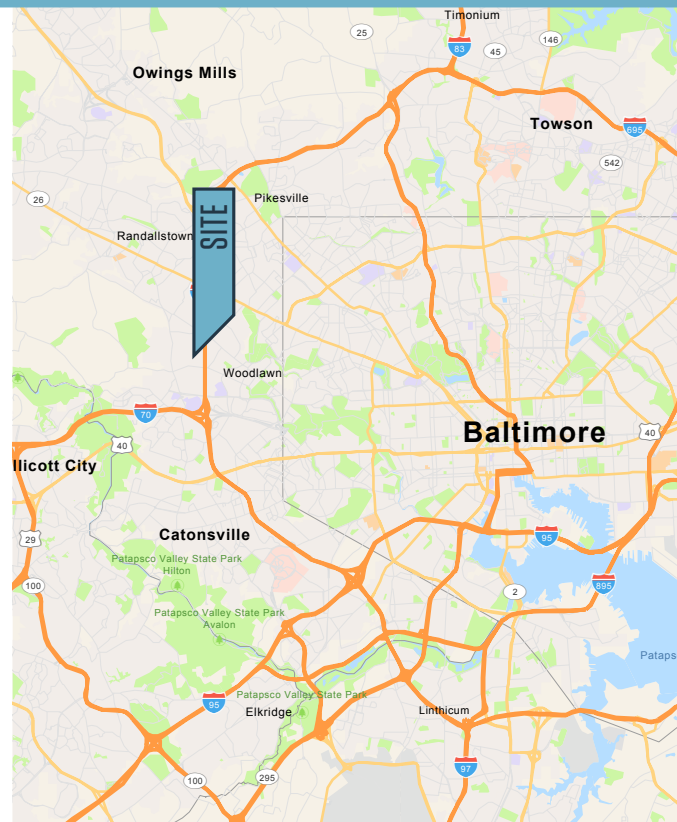

Austin Eber
aeber@klnb.com
443-574-1414

Steele Stanwick
sstanwick@klnb.com
443-574-1420

9881 Broken Land Pkwy, #300
Columbia, MD 21046
klnb.com

7253 AMBASSADOR ROAD

Windsor Mill, MD 21244 | Baltimore County

FLOOR PLAN | LOADING AREA | 39,565 SF

FRONT OF BUILDING

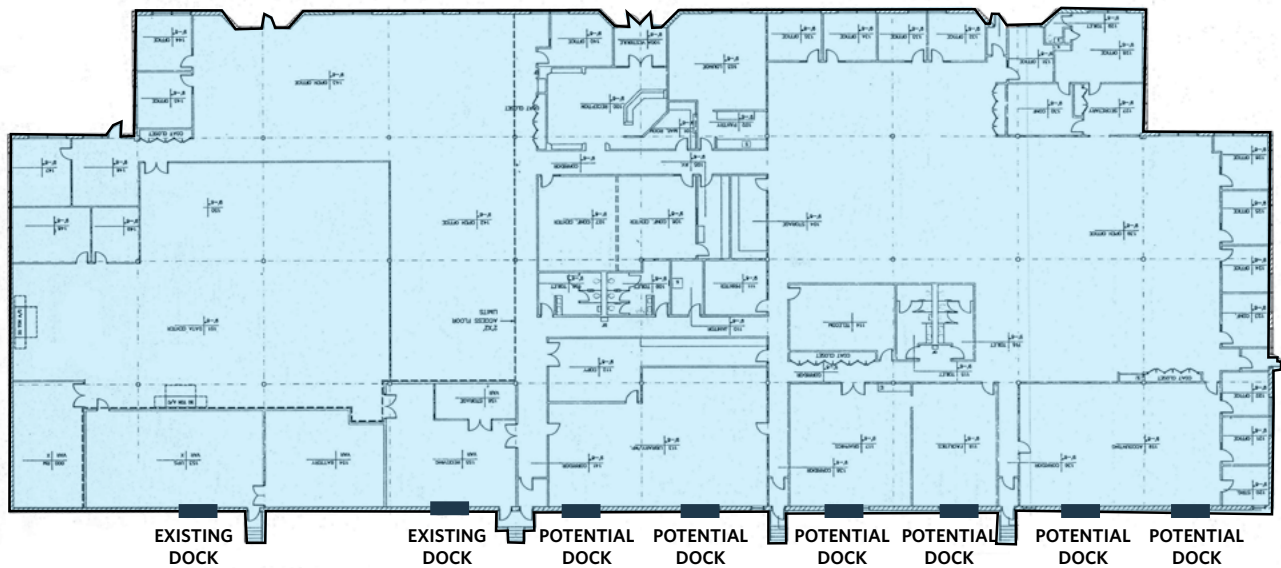

LOADING AREA



DEMOGRAPHICS | 3 MILE



POPULATION
113,989



HOUSEHOLDS
43,968



MEDIAN
HH INCOME
70,576



MEDIAN
AGE
39.3



DISPOSABLE
INCOME
\$56,173

Austin Eber
aeber@klnb.com
443-574-1414

Steele Stanwick
sstanwick@klnb.com
443-574-1420

PHOTOS



7253 AMBASSADOR ROAD

Windsor Mill, MD 21244 | Baltimore County

[CLICK TO VIEW PROPERTY WEBSITE](#)

For More Information, Please Contact:

Austin Eber

aeber@klnb.com
443-574-1414

Steele Stanwick

sstanwick@klnb.com
443-574-1420

9881 Broken Land Parkway, Suite 300
Columbia, MD 21046

klnb.com



[instagram.com/klnbcre](https://www.instagram.com/klnbcre)



[linkedin.com/company/klnb](https://www.linkedin.com/company/klnb)



[facebook.com/KLNBcre](https://www.facebook.com/KLNBcre)

While we have no reason to doubt the accuracy of any of the information supplied, we cannot, and do not, guarantee its accuracy. All information should be independently verified prior to a purchase or lease of the property. We are not responsible for errors, omissions, misuse, or misinterpretation of information contained herein and make no warranty of any kind, express or implied, with respect to the property or any other matters.

