



NEARBY RETAILERS



PAD SITES AVAILABLE FOR GROUND LEASE

- 2.8 Acres with the ability to accommodate multiple pad sites.
- Ideal for Fast Food, Urgent Care, Car Wash, Financial Institutions and more!
- Zoned BL
- Excellent Visibility and Access To Taylor Ave.
- Located Directly Adjacent To The High Traffic Intersection Of Loch Raven Blvd [31,471 ADT] and Taylor Ave [21,244 ADT]

MASON BERNSTEIN

mbernstein@klnb.com | 443-632-2089

RYAN MINNEHAN

rminnehan@klnb.com | 443-632-2088

LOCATION

1045-1055 TAYLOR AVE

TOWSON, MD 21286, BALTIMORE COUNTY

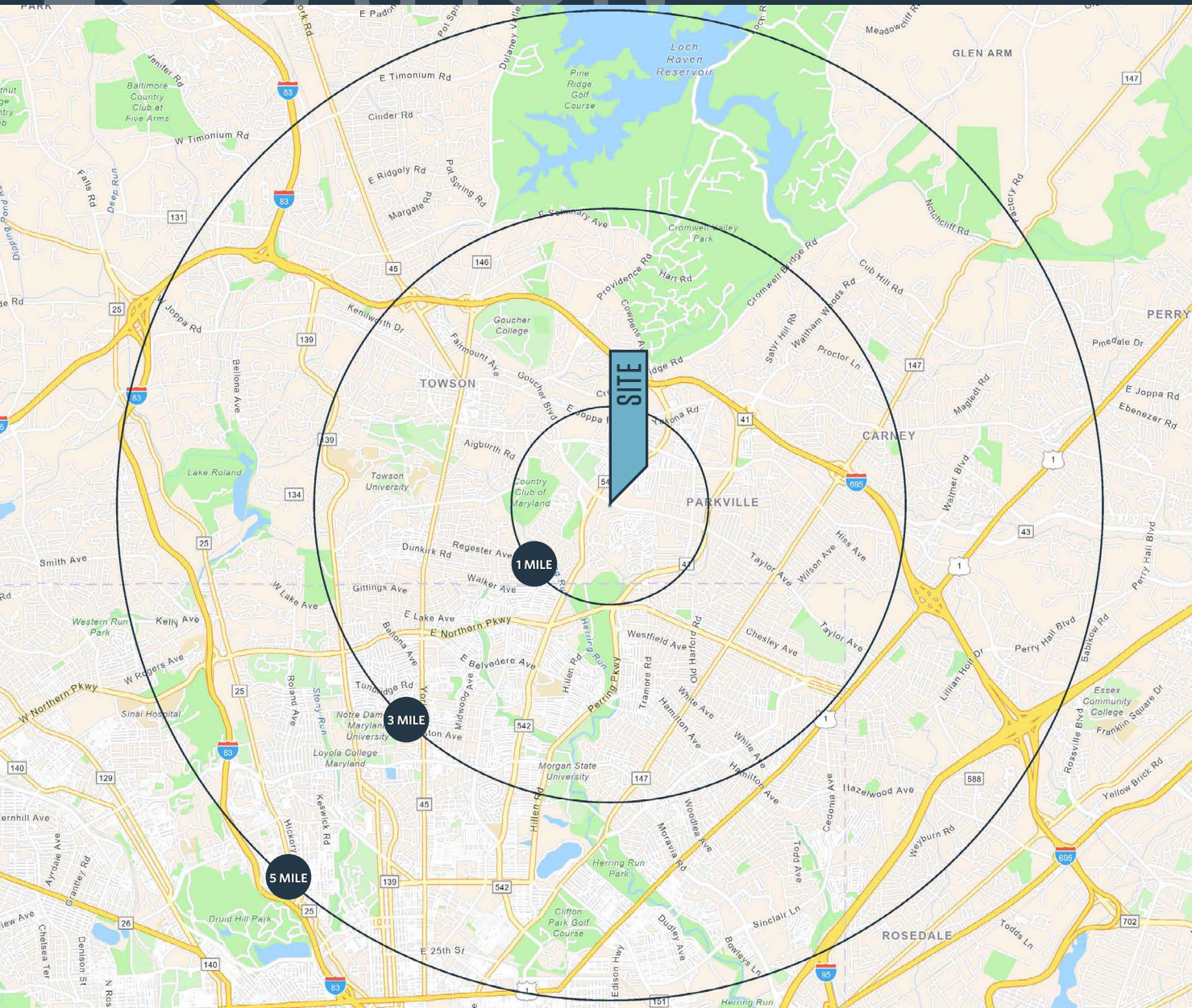

PROPERTY HIGHLIGHTS:

- 2.8 Acres

DEMOGRAPHICS | 2023:

	1-MILE	3-MILE	5-MILE
Population	22,890	170,911	378,068
Daytime Population	17,232	157,297	342,233
Households	9,850	68,232	154,085
Average HH Income	\$93,824	\$108,798	\$110,853

[CLICK TO DOWNLOAD DEMOGRAPHIC REPORT](#)

TRAFFIC COUNTS | 2022:

Loch Raven Blvd	31,471 ADT
Taylor Ave	21,244 ADT

MASON BERNSTEIN

mbernstein@klnb.com | 443-632-2089

RYAN MINNEHAN

rminnehan@klnb.com | 443-632-2088



MARKET

1045-1055 TAYLOR AVE

TOWSON, MD 21286, BALTIMORE COUNTY

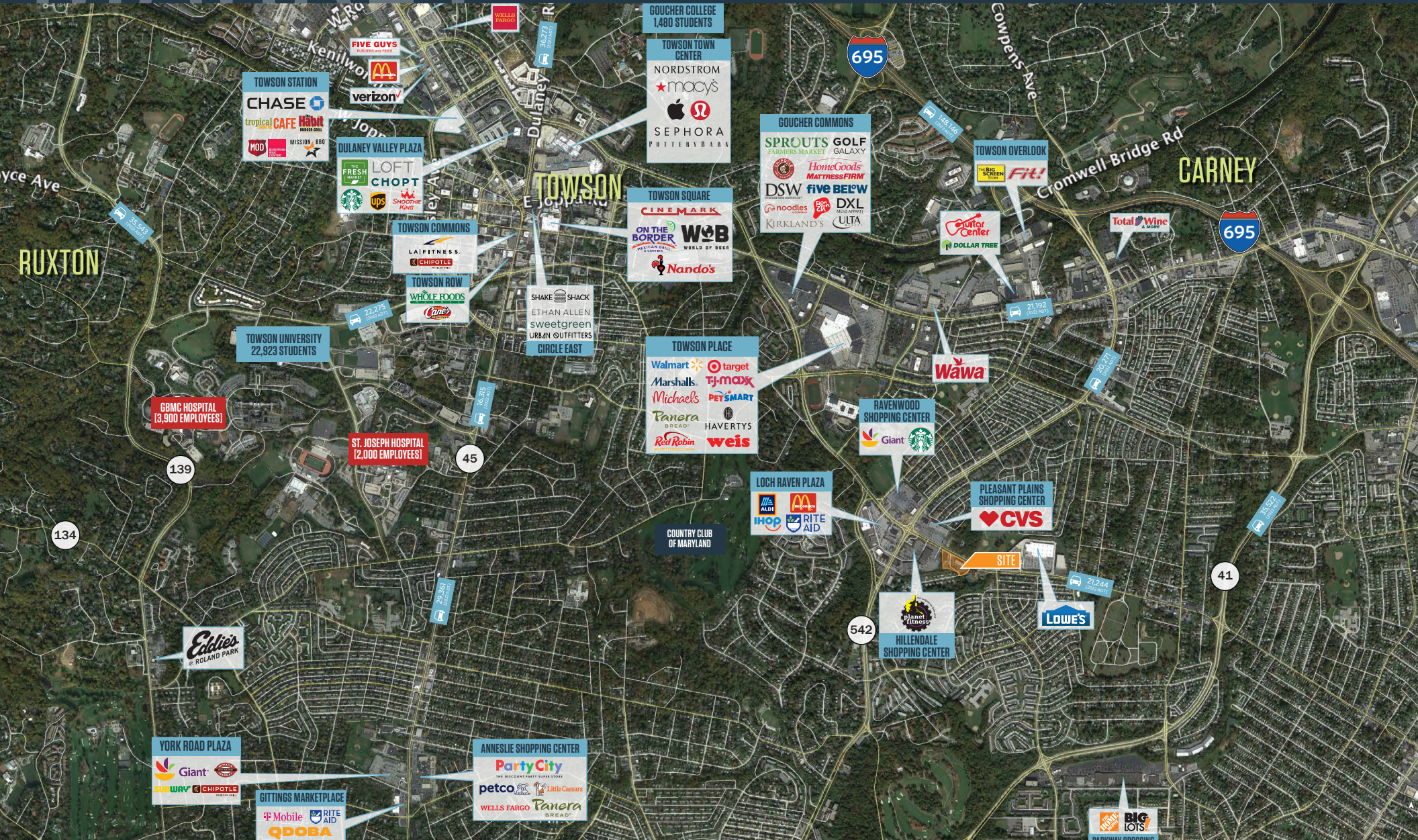

MASON BERNSTEIN
mbernstein@klnb.com | 443-632-2089

RYAN MINNEHAN
rminnehan@klnb.com | 443-632-2088





RAVENWOOD SHOPPING CENTER
Starbucks Giant

LOCH RAVEN PLAZA
ALDI DOLLAR TREE
Lombardi's Pizza
410-321-9288

PLEASANT PLAINS SHOPPING CENTER
CVS 2109

B
BALTIMORE COUNTY PUBLIC LIBRARY

planet fitness metro
HILLENDALE SHOPPING CENTER

1045-1055 TAYLOR AVE

CLOSEUP

1045-1055 TAYLOR AVE

TOWSON, MD 21286, BALTIMORE COUNTY

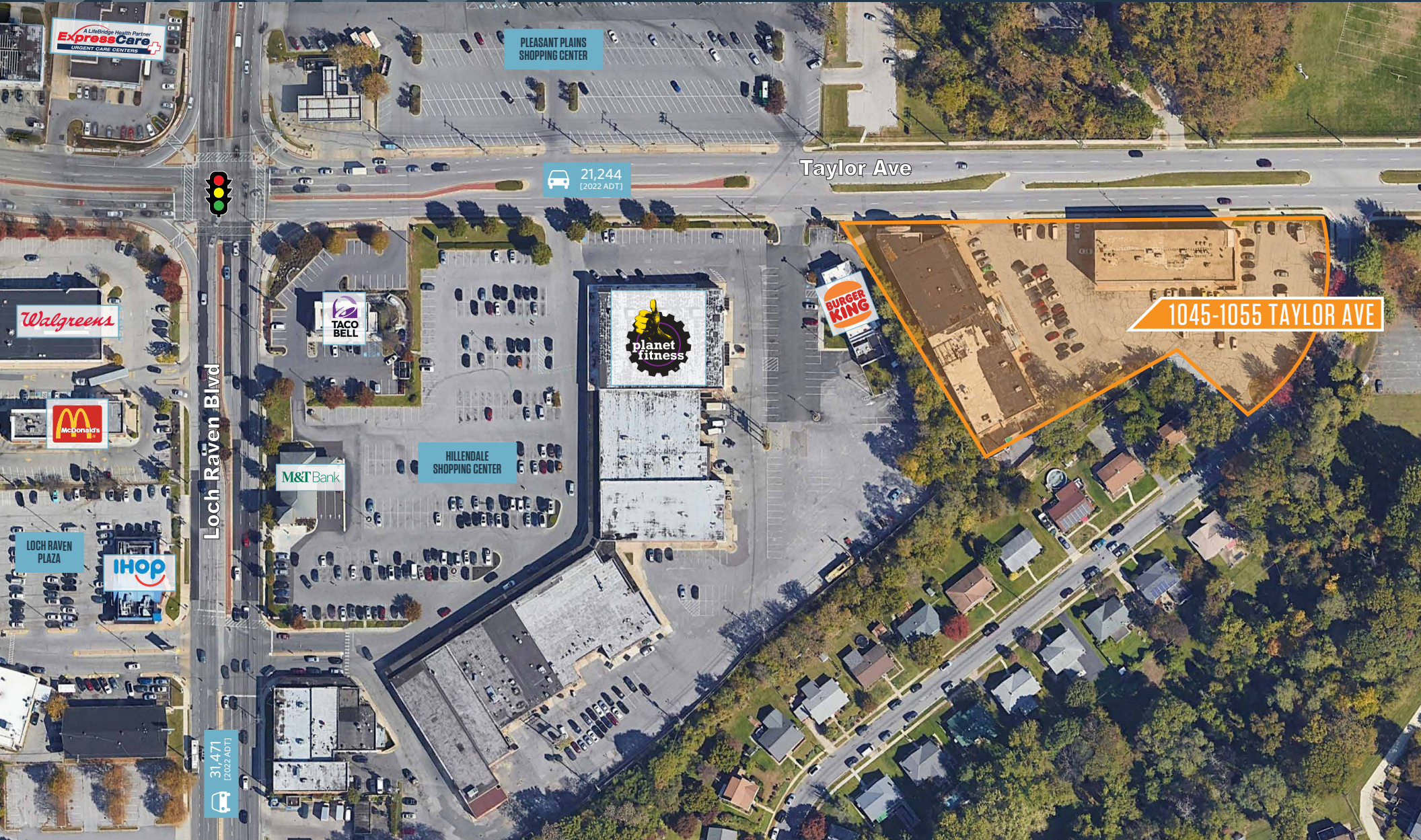

PLEASANT PLAINS SHOPPING CENTER

21,244
[2022 ADT]

Taylor Ave

1045-1055 TAYLOR AVE

Loch Raven Blvd

HILLENDALE SHOPPING CENTER

31,471
[2022 ADT]

MASON BERNSTEIN

mbernstein@klnb.com | 443-632-2089

RYAN MINNEHAN

rminnehan@klnb.com | 443-632-2088



CONCEPT

1045-1055 TAYLOR AVE

TOWSON, MD 21286, BALTIMORE COUNTY

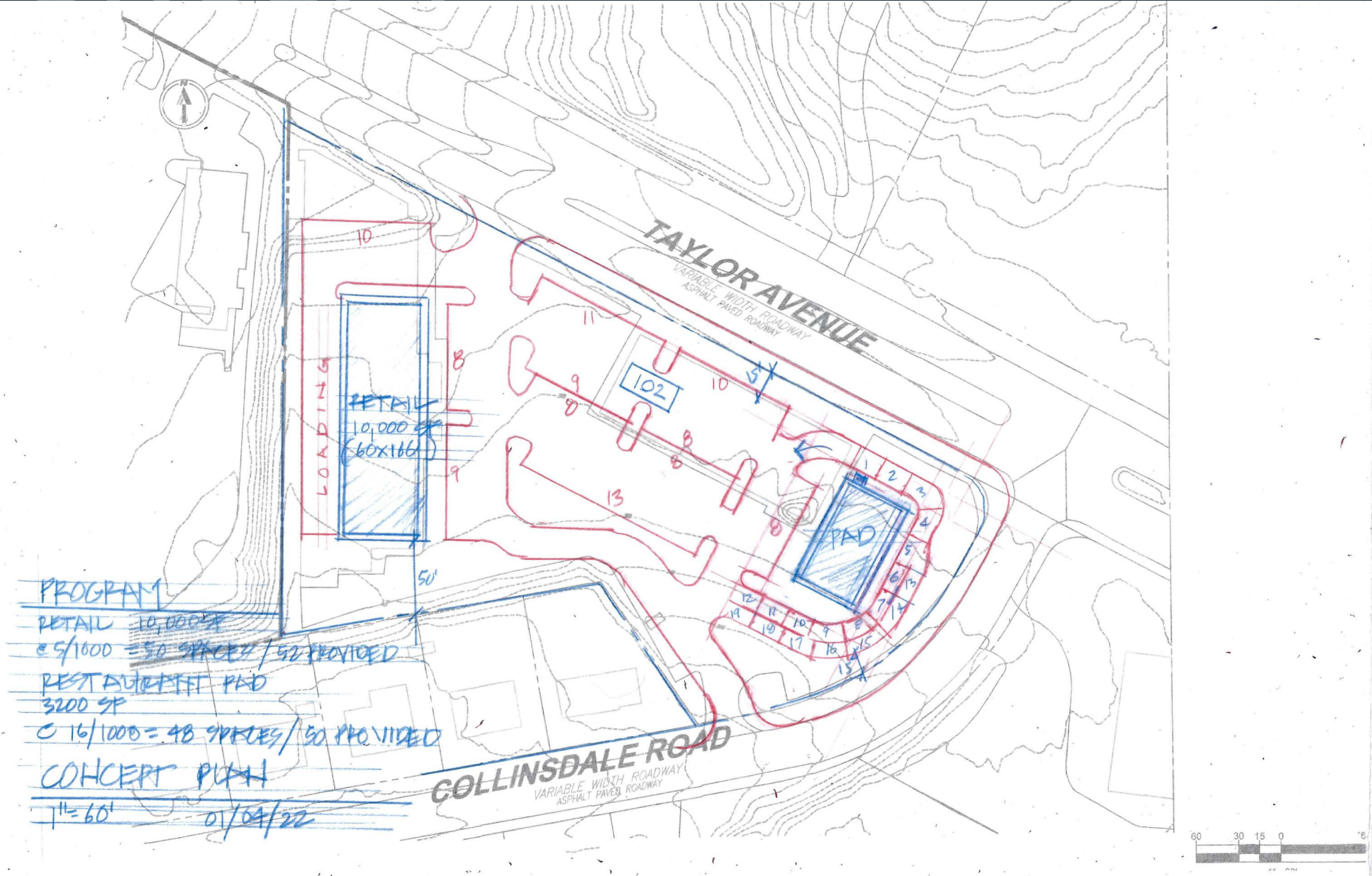

MASON BERNSTEIN

mbernstein@klnb.com | 443-632-2089

RYAN MINNEHAN

rminnehan@klnb.com | 443-632-2088

klnb



1045-1055 TAYLOR AVE

TOWSON, MD 21286, BALTIMORE COUNTY

FOR MORE INFORMATION, PLEASE CONTACT:

MASON BERNSTEIN
mbernstein@klnb.com
443-632-2089

RYAN MINNEHAN
rminnehan@klnb.com
443-632-2088

100 West Road, Suite 505, Towson, MD 21204

.....
klnb.com



[instagram.com/klnbcre](https://www.instagram.com/klnbcre)



[linkedin.com/company/klnb](https://www.linkedin.com/company/klnb)



[facebook.com/KLNBCRE](https://www.facebook.com/KLNBCRE)

CLICK TO VIEW PROPERTY WEBSITE

While we have no reason to doubt the accuracy of any of the information supplied, we cannot, and do not, guarantee its accuracy. All information should be independently verified prior to a purchase or lease of the property. We are not responsible for errors, omissions, misuse, or misinterpretation of information contained herein and make no warranty of any kind, express or implied, with respect to the property or any other matters.