

WALDORF PARK

Waldorf, MD 20601
Charles County



NOW OPEN: **evolve**
MED SPA

OPENING SOON: **marco's**
Pizza

FOR LEASE

JOIN:



CLUB PILATES



AspenDental



crumbl
cookies

- Prime new development in Waldorf, MD with high visibility to Crain Highway
- 2nd Chick-fil-A in Waldorf
- Only Starbucks drive-thru in Waldorf

DEVELOPER:

Republic

Alex Shearer
ashearer@klnb.com
443-632-2081

Ryan Minnehan
rminnehan@klnb.com
443-632-2088

Phil Ruxton
pruxton@klnb.com
202-420-7777

100 West Road, Suite 505
Towson, MD 21204
klnb.com

klnb

WALDORF PARK

Waldorf, MD 20601
Charles County

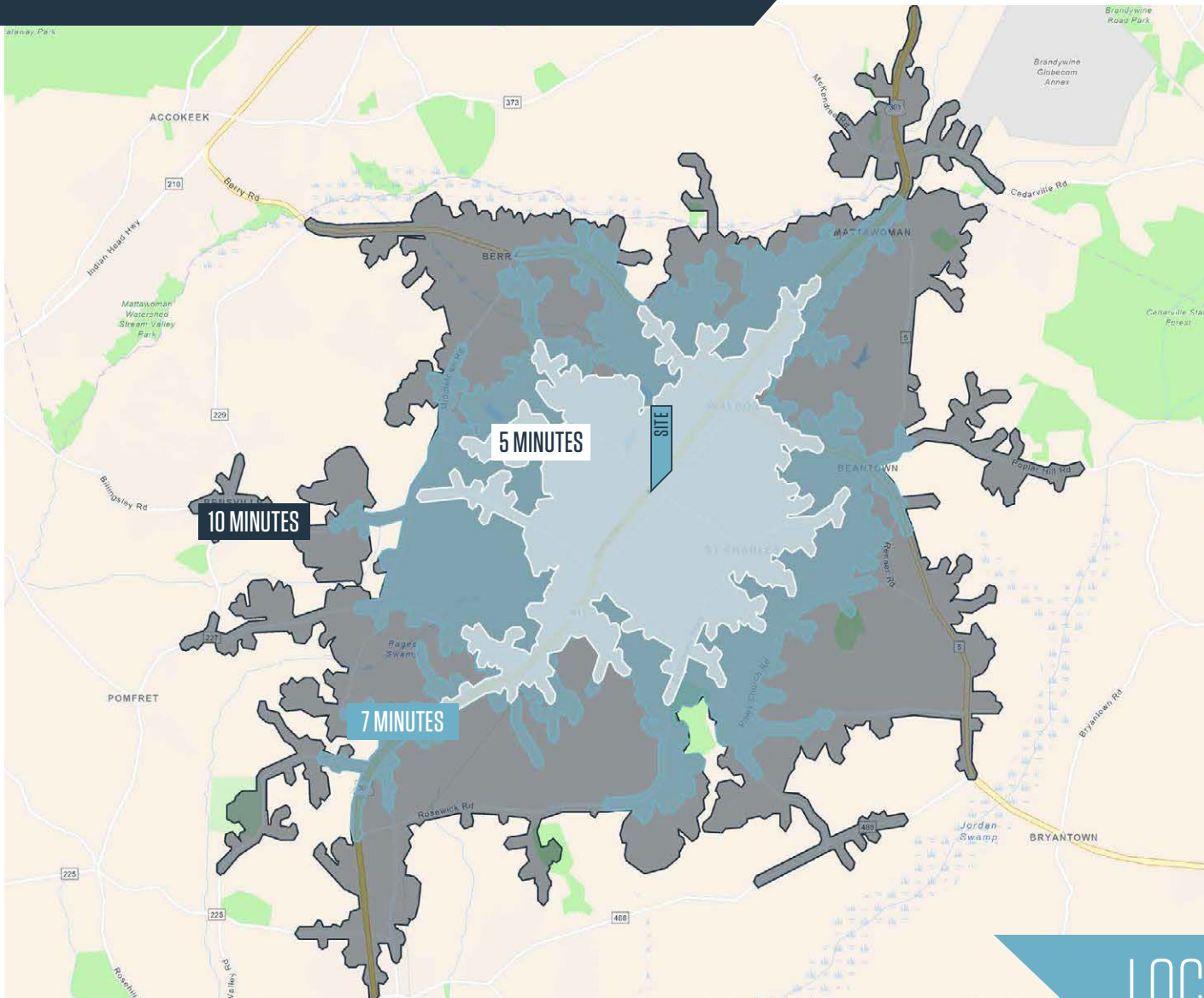

AVAILABLE SPACE

- 1,646 SF
- 2,008 SF
- 1,646 SF
- 4,915 SF [Can Subdivide]

DEMOGRAPHICS | 2024:

5-MINUTE	7-MINUTE	10-MINUTE
Population 17,675	44,118	83,208
Daytime Population 21,301	42,956	67,648
Households 6,624	16,713	28,874
Average HH Income \$122,816	\$132,071	\$135,797

[CLICK TO DOWNLOAD DEMOGRAPHIC REPORT](#)

TRAFFIC COUNTS | 2023:

Crain Hwy	53,875 ADT
Smallwood Rd	13,402 ADT

LOCATION & DEMOGRAPHICS

Alex Shearer
ashearer@klnb.com
443-632-2081

Ryan Minnehan
rminnehan@klnb.com
443-632-2088

Phil Ruxton
pruxton@klnb.com
202-420-7777

100 West Road, Suite 505
Towson, MD 21204
klnb.com

klnb

WALDORF PARK

Waldorf, MD 20601
Charles County

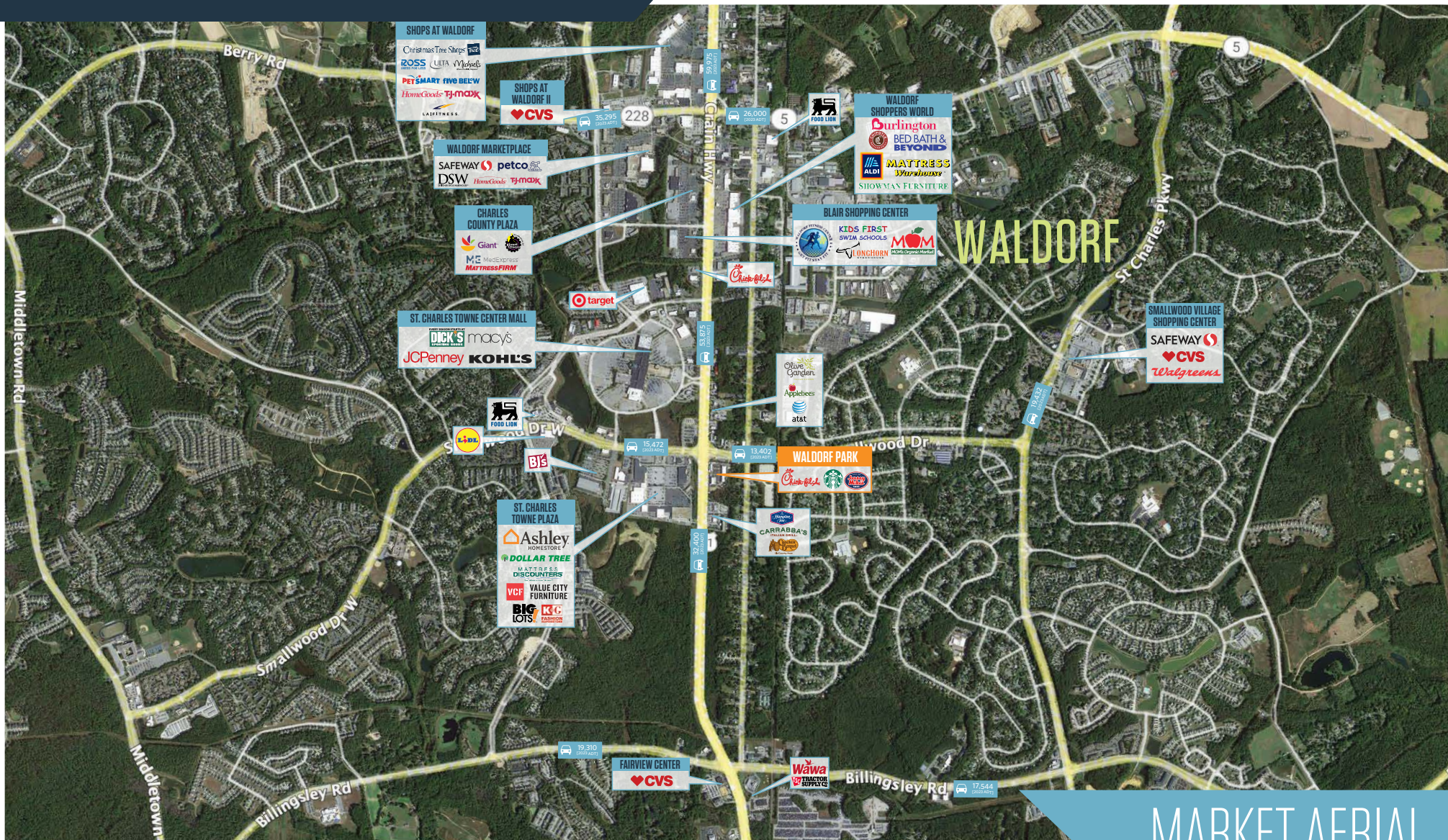

Alex Shearer
ashearer@klnb.com
443-632-2081

Ryan Minnehan
rminnehan@klnb.com
443-632-2088

Phil Ruxton
pruxton@klnb.com
202-420-7777

100 West Road, Suite 505
Towson, MD 21204
klnb.com

klnb

WALDORF PARK

Waldorf, MD 20601
Charles County

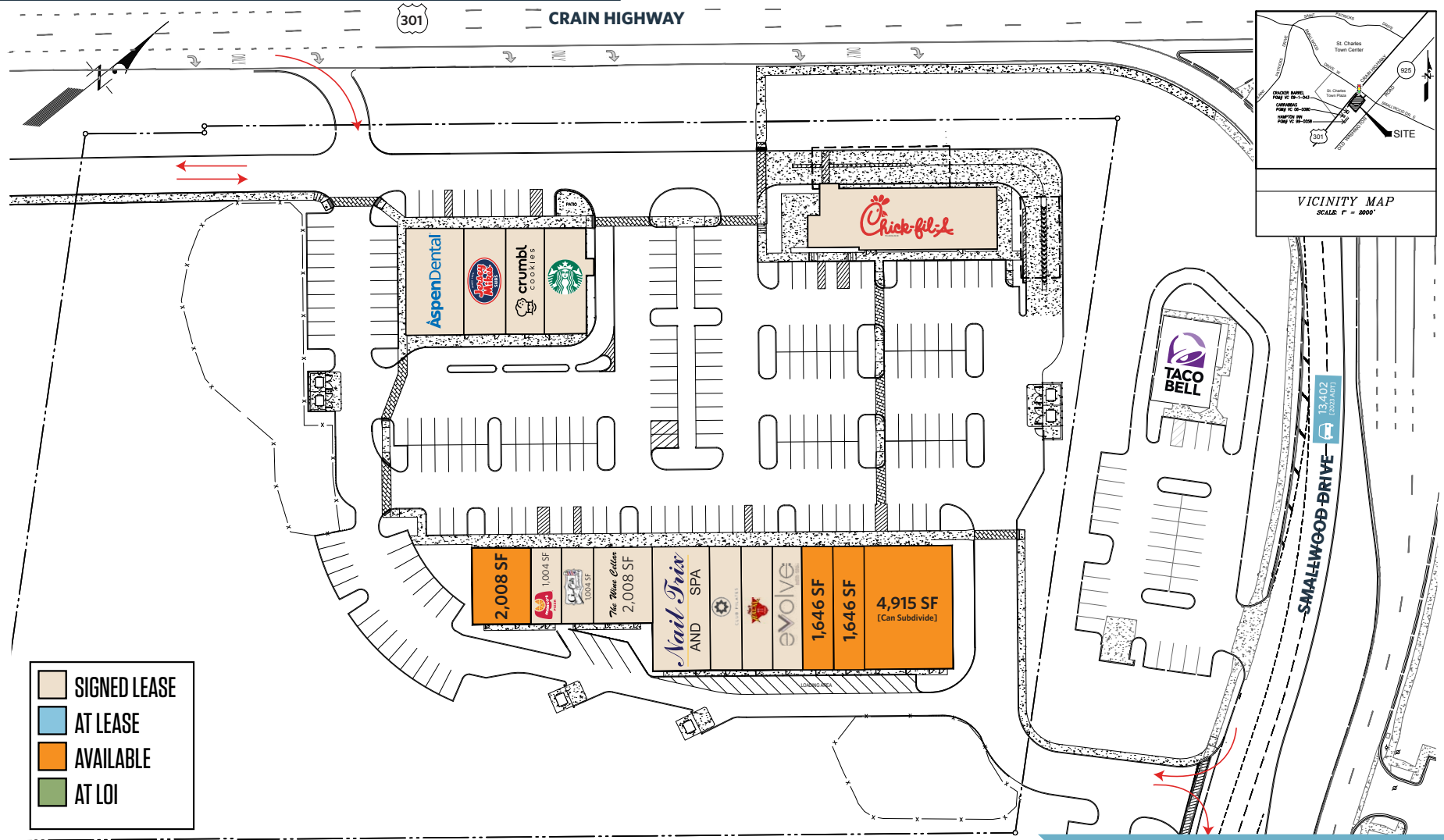

SITE PLAN

Alex Shearer
ashearer@klnb.com
443-632-2081

Ryan Minnehan
rminnehan@klnb.com
443-632-2088

Phil Ruxton
pruxton@klnb.com
202-420-7777

100 West Road, Suite 505
Towson, MD 21204
klnb.com



WALDORF PARK

Waldorf, MD 20601
Charles County

CLICK TO VIEW PROPERTY WEBSITE

For More Information, Please Contact:

Alex Shearer

ashearer@klnb.com
443-632-2081

Ryan Minnehan

rminnehan@klnb.com
443-632-2088

Phil Ruxton

pruxton@klnb.com
202-420-7777

100 West Road, Suite 505
Towson, MD 21204

klnb.com



[instagram.com/klnbcre](https://www.instagram.com/klnbcre)



[linkedin.com/company/klnb](https://www.linkedin.com/company/klnb)



[facebook.com/KLNBCRE](https://www.facebook.com/KLNBCRE)

While we have no reason to doubt the accuracy of any of the information supplied, we cannot, and do not, guarantee its accuracy. All information should be independently verified prior to a purchase or lease of the property. We are not responsible for errors, omissions, misuse, or misinterpretation of information contained herein and make no warranty of any kind, express or implied, with respect to the property or any other matters.

klnb