



## NEARBY RETAILERS

Publix



## RETAIL FOR LEASE

- New retail development located off I-95 and across the street from Market at Embrey Mill which is anchored by Publix.
- Retail pads and multi-tenant opportunities available.
- The Stafford trade area enjoys an average household income of \$140,617 per year within a 5-mile radius.
- Great for gas/convenience store, full-service restaurant, financial institutions, grocer, and more!

VERONICA KAMARA

vkamara@klnb.com | 703-268-2714

DIMITRI GEORGELAKOS

dimitri@klnb.com | 703-268-2710



# MARKET AT AUSTIN RIDGE

962 COURTHOUSE RD., STAFFORD, VA 22554, STAFFORD COUNTY

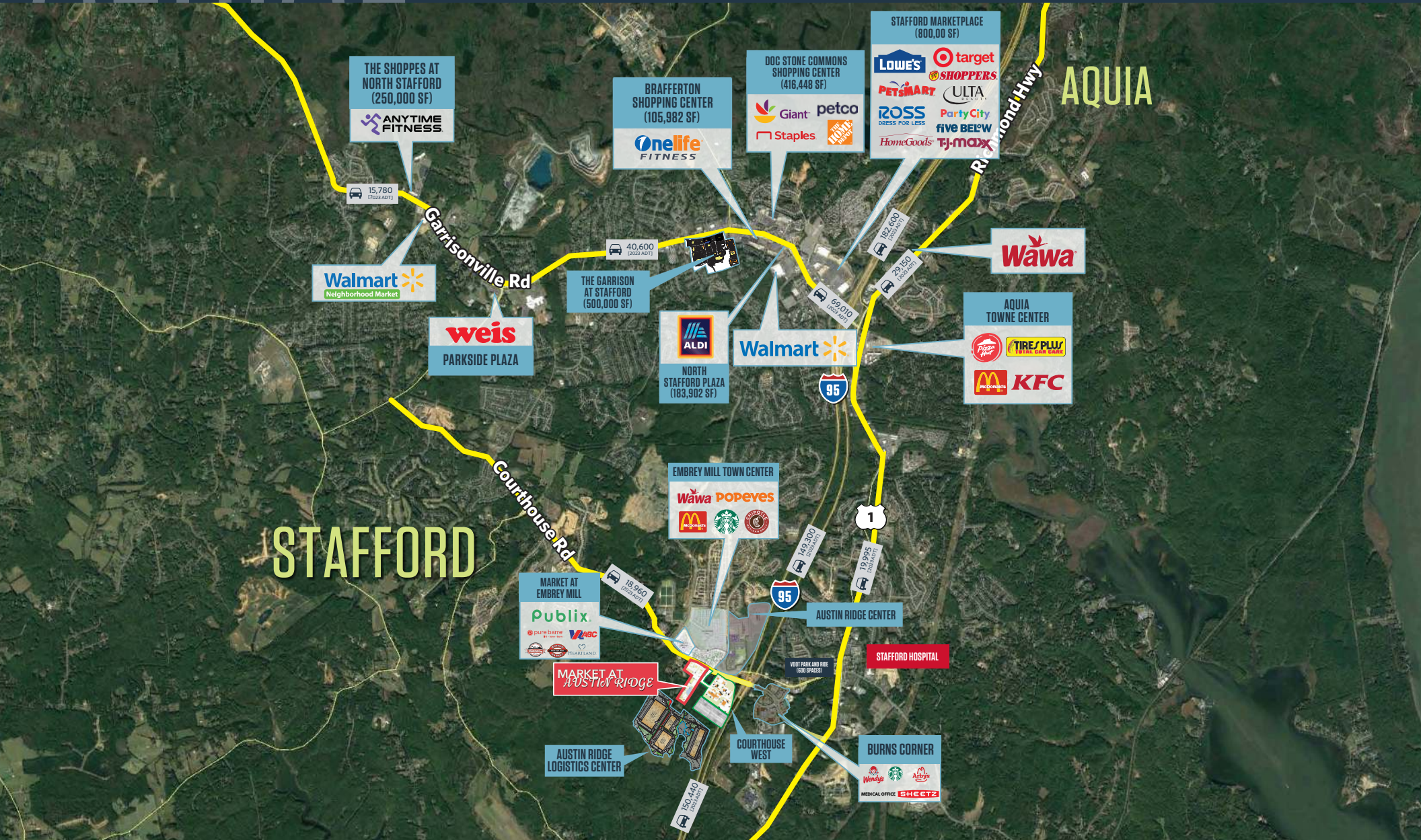



# CLOSE-UP

# MARKET AT AUSTIN RIDGE

962 COURTHOUSE RD., STAFFORD, VA 22554, STAFFORD COUNTY



**VERONICA KAMARA**  
vkamara@klnb.com | 703-268-2714

**DIMITRI GEORGELAKOS**  
dimitri@klnb.com | 703-268-2710





# SITE PLAN

# MARKET AT AUSTIN RIDGE

962 COURTHOUSE RD., STAFFORD, VA 22554, STAFFORD COUNTY

PROPOSED LOT	PROPOSED USE
LOT A (2.39 AC)	Retail/Fuel - 5,049 SF
LOT B (2 AC)	Restaurant - 7,990 SF
LOT C (1.08 AC)	Bank - 3,400 SF
LOT D (2.35 AC)	Grocery - 19,631 SF
LOT E (1.12 AC)	Child Care Center - 11,328 SF
LOT F (1.01 AC)	Retail - 6,912 SF
LOT G (1.33 AC)	Drive-Thru/Restaurant/Retail - 5,049 SF
LOT H (1.95 AC)	Office/Restaurant/Retail - 50,400 SF
LOT I (0.81 AC)	Restaurant/Retail - 4,295 SF
LOT J (0.58 AC)	Restaurant/Retail - 4,295 SF
LOT K (0.62 AC)	Restaurant/Retail - 4,295 SF
LOT L (4.58 AC)	Office/Restaurant/Retail - 62,550 SF
LOT M (1.83 AC)	Hotel - 38,189 SF

KEY
<span style="background-color: yellow; border: 1px solid black; display: inline-block; width: 15px; height: 10px;"></span> AVAILABLE
<span style="background-color: purple; border: 1px solid black; display: inline-block; width: 15px; height: 10px;"></span> AT LEASE
<span style="background-color: tan; border: 1px solid black; display: inline-block; width: 15px; height: 10px;"></span> LEASED

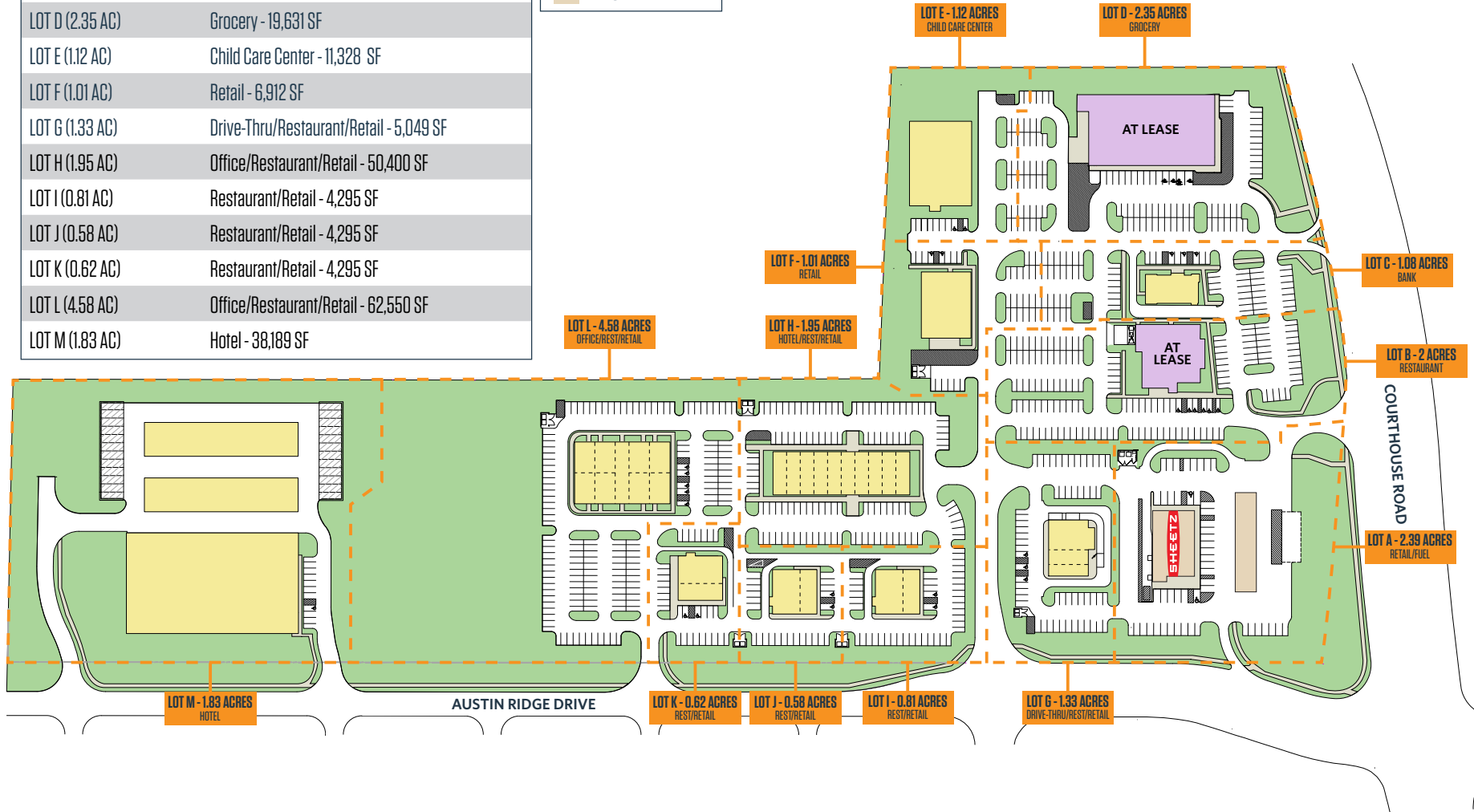

**VERONICA KAMARA**

vkamara@klnb.com | 703-268-2714

**DIMITRI GEORGELAKOS**

dimitri@klnb.com | 703-268-2710





# LOCATION

# MARKET AT AUSTIN RIDGE

962 COURTHOUSE RD., STAFFORD, VA 22554, STAFFORD COUNTY

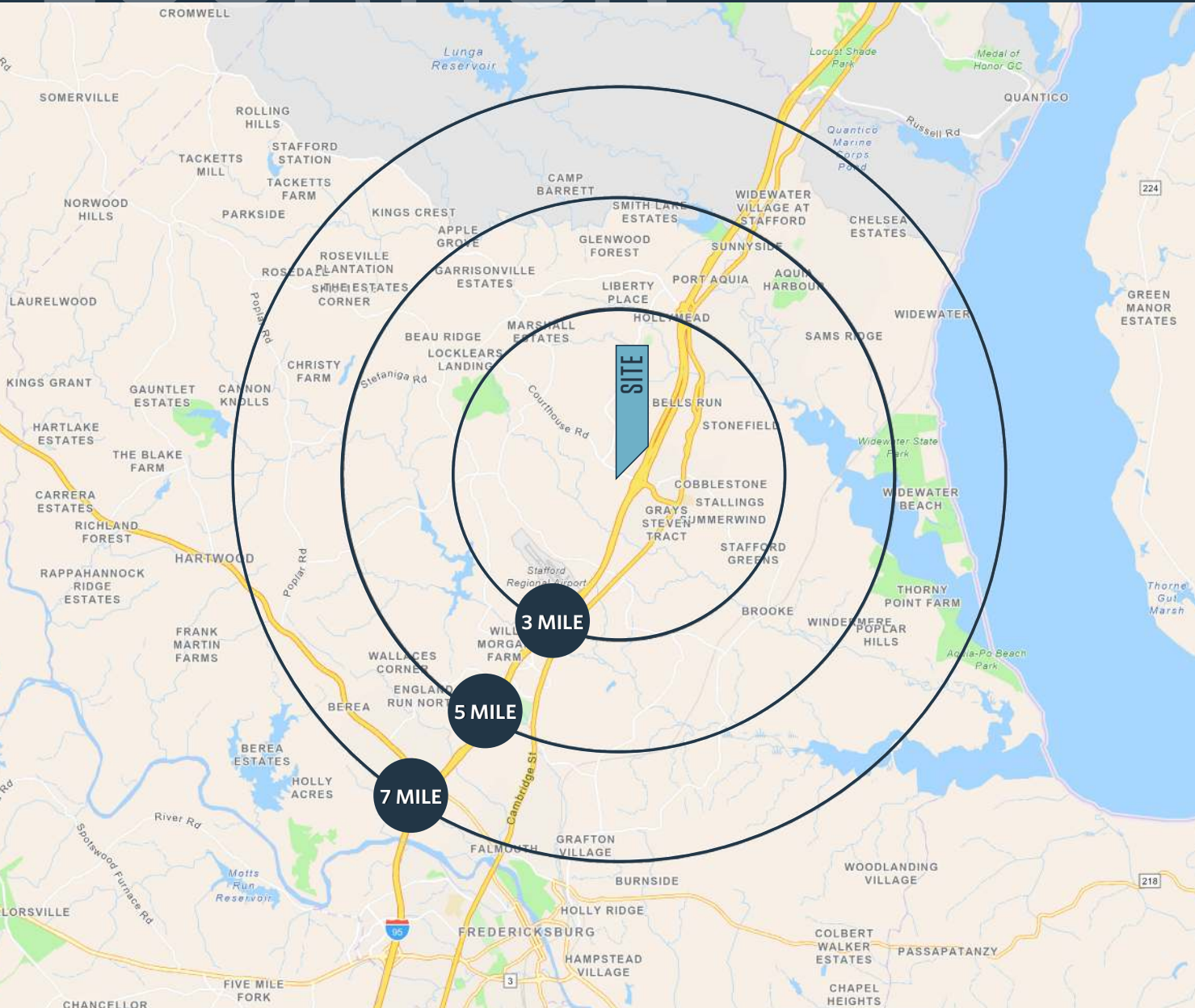

## DEMOGRAPHICS | 2024:

	3-MILE	5-MILE	7-MILE
Population	42,638	84,156	130,053
Daytime Population	16,046	32,796	48,911
Households	12,9920	26,243	41,608
Average HH Income	\$185,184	\$175,578	\$172,845
Median Age	35.7	35.9	36.3

[CLICK TO DOWNLOAD DEMOGRAPHIC REPORT](#)

## TRAFFIC COUNTS | 2023:

I-95	150,440 ADT
Courthouse Rd.	18,690 ADT

**VERONICA KAMARA**

vkamara@klnb.com | 703-268-2714

**DIMITRI GEORGELAKOS**

dimitri@klnb.com | 703-268-2710







# MARKET AT AUSTIN RIDGE

962 COURTHOUSE RD., STAFFORD, VA 22554, STAFFORD COUNTY

## FOR MORE INFORMATION, PLEASE CONTACT:

**VERONICA KAMARA**

[vkamara@klnb.com](mailto:vkamara@klnb.com)

703-268-2714

**DIMITRI GEORGELAKOS**

[dimitri@klnb.com](mailto:dimitri@klnb.com)

703-268-2710

8065 Leesburg Pike, Suite 700, Tysons, VA 22182

**klnb.com**



[instagram.com/klnbcre](https://www.instagram.com/klnbcre)



[linkedin.com/company/klnb](https://www.linkedin.com/company/klnb)



[facebook.com/KLNBCRE](https://www.facebook.com/KLNBCRE)

**CLICK TO VIEW PROPERTY WEBSITE**

While we have no reason to doubt the accuracy of any of the information supplied, we cannot, and do not, guarantee its accuracy. All information should be independently verified prior to a purchase or lease of the property. We are not responsible for errors, omissions, misuse, or misinterpretation of information contained herein and make no warranty of any kind, express or implied, with respect to the property or any other matters.