

4215 CONNECTICUT AVE NW
WASHINGTON, DC 20008

2ND GENERATION RETAIL FOR LEASE

1,471 SF PHARMACY AVAILABLE
WITH EXISTING PRESCRIPTION LIST



VICTOR SALCIDO
victor@klnb.com | 240-755-2704

JOE FLEISCHMANN
joef@klnb.com | 703-268-2708

MIKE PRATT
mpratt@klnb.com | 703-420-7765

klnb.com

OVERVIEW

4215 CONNECTICUT AVE NW

WASHINGTON, DC 20008

2ND GENERATION RETAIL FOR LEASE

- 1,471 SF, currently occupied by Pill Plus Pharmacy, available in Van Ness. New pharmacy user would inherit existing customers and prescription list.
- Visibility along Connecticut Ave NW (32,463 ADT) and in close proximity to Van Ness-UDC Metro Station (3,429 ADR), accessible to the Red line.
- Directly across from UDC Campus (2,810 students) in underserved submarket with average HH income of over \$170,000 within a 10-minute walk.
- Space can be vented for food use.

NEARBY RETAILERS:



GOLD'S GYM



VICTOR SALCIDO
victor@klnb.com | 240-755-2704

JOE FLEISCHMANN
joef@klnb.com | 703-268-2708

MIKE PRATT
mpratt@klnb.com | 703-420-7765



SITE PLAN

4215 CONNECTICUT AVE NW

WASHINGTON, DC 20008

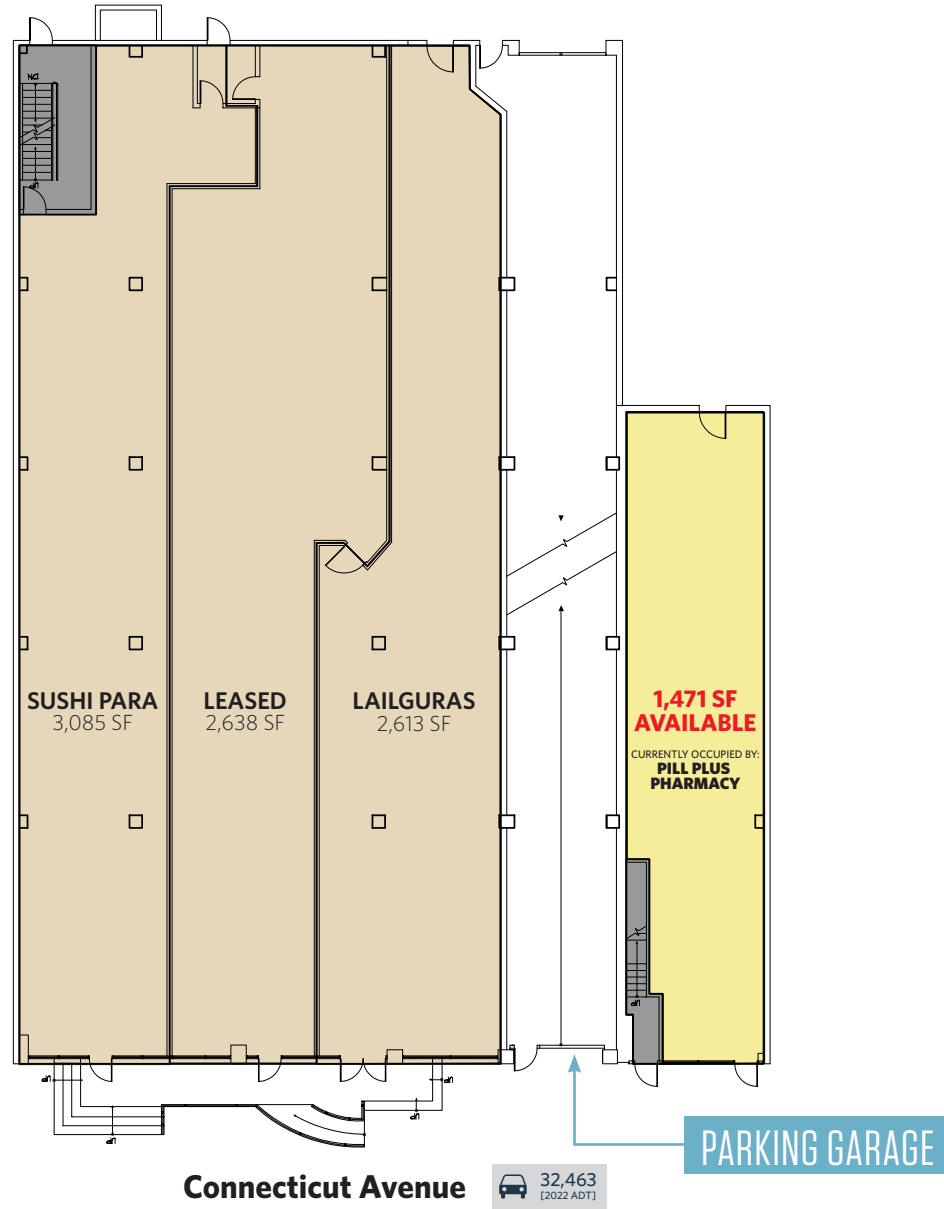

VICTOR SALCIDO
victor@klnb.com | 240-755-2704

JOE FLEISCHMANN
joef@klnb.com | 703-268-2708

MIKE PRATT
mpratt@klnb.com | 703-420-7765



CLOSE UP

4215 CONNECTICUT AVE NW

WASHINGTON, DC 20008



1,471 SF AVAILABLE



CONNECTICUT AVE NW

31,898
[2022 ADT]



VAN NESS NW



VICTOR SALCIDO
victor@klnb.com | 240-755-2704

JOE FLEISCHMANN
joef@klnb.com | 703-268-2708

MIKE PRATT
mpratt@klnb.com | 703-420-7765



Van Ness

Washington, D.C.



While we have no reason to doubt the accuracy of any of the information supplied, we cannot, and do not, guarantee its accuracy.

- SCHOOL
- BANK
- FOOD + BEVERAGE
- GROCERY
- FITNESS
- OTHER SERVICES



LOCATION

4215 CONNECTICUT AVE NW

WASHINGTON, DC 20008

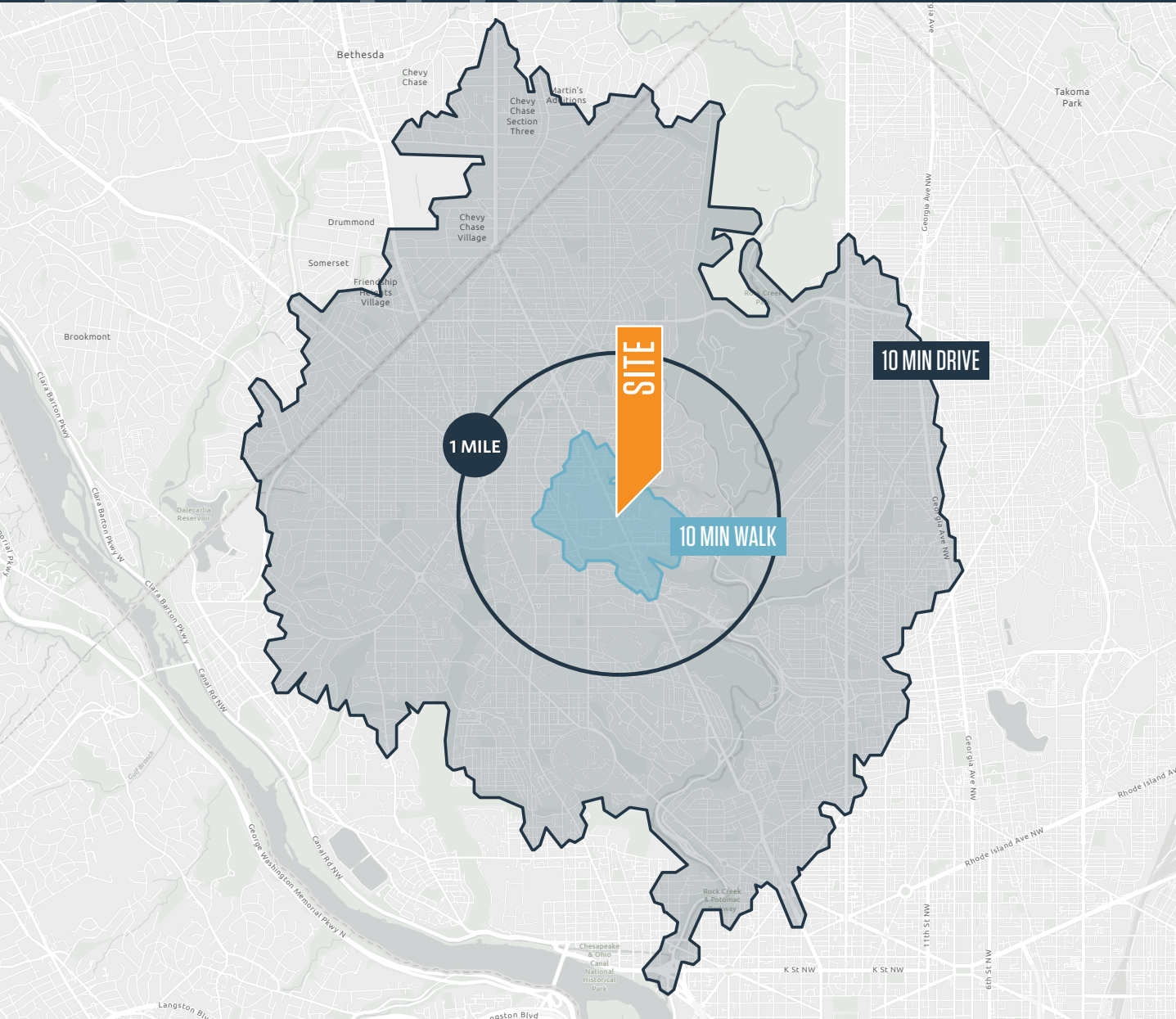

DEMOGRAPHICS | 2023:

1-MILE	10-MIN WALK	10-MIN DRIVE
Population		
26,642	7,626	183,325
Daytime Population		
18,468	5,993	117,316
Households		
14,528	4,654	88,062
Average HH Income		
\$197,946	\$177,556	\$201,188
Median Age		
38.4	38.4	37.7

[CLICK FOR 1 MILE DEMOGRAPHICS](#)

[CLICK FOR 10 MIN DRIVE DEMOGRAPHICS](#)

[CLICK FOR 10 MIN WALK DEMOGRAPHICS](#)

TRAFFIC COUNTS | 2022:

Connecticut Ave NW 31,898 ADT

VICTOR SALCIDO
victor@klnb.com | 240-755-2704

JOE FLEISCHMANN
joef@klnb.com | 703-268-2708

MIKE PRATT
mpratt@klnb.com | 703-420-7765



PHOTOS

4215 CONNECTICUT AVE NW

WASHINGTON, DC 20008



VICTOR SALCIDO
victor@klnb.com | 240-755-2704

JOE FLEISCHMANN
joef@klnb.com | 703-268-2708

MIKE PRATT
mpratt@klnb.com | 703-420-7765

klnb



4215 CONNECTICUT AVE NW

WASHINGTON, DC 20003

FOR MORE INFORMATION, PLEASE CONTACT:

VICTOR SALCIDO

victor@klnb.com

240-755-2704

JOE FLEISCHMANN

joef@klnb.com

703-268-2708

MIKE PRATT

mpratt@klnb.com

703-420-7765

1130 Connecticut Avenue, Suite 600, Washington, DC 20036

.....

klnb.com

 facebook.com/KLNBCRE

 linkedin.com/company/klnb

 instagram.com/klnbcre

CLICK TO VIEW PROPERTY WEBSITE

While we have no reason to doubt the accuracy of any of the information supplied, we cannot, and do not, guarantee its accuracy. All information should be independently verified prior to a purchase or lease of the property. We are not responsible for errors, omissions, misuse, or misinterpretation of information contained herein and make no warranty of any kind, express or implied, with respect to the property or any other matters.