



AVAILABILITY

- Suite: 400
- 1,000 - 14,207 SF
- Rental Rate: Negotiable
- Shared Office Space
- Term Ends: June 1, 2030

OFFICE FOR SUBLEASE

- Type: Class B | 3 Star Office
- RBA: 185,000 SF
- Stories: 6
- Parking: Surface
- Year Built: 2004

AMENITIES

- Bicycle Storage
- Food Service
- Bus Line
- Metro/Subway
- Car Charging Station
- Fitness Center
- Property Manager on Site
- Conferencing Facility
- Restaurant
- Energy Star Labeled
- Secure Storage

RASHIDA AKHTER

rakhter@klnb.com | 301-222-0019

SCOTT MENDELSON

smendelson@klnb.com | 703-334-5611

MARC BALAMACI

mbalamaci@klnb.com | 703-334-5603

AERIAL

5635 FISHERS LN

ROCKVILLE, MD 20852, MONTGOMERY COUNTY



Rockville
Montgomery County | Maryland

klnb

- Google Earth Pro -
2018 Aerial Photograph

While we have no reason to doubt the accuracy of any of the information supplied, we cannot, and do not, guarantee its accuracy.



RASHIDA AKHTER

rakhter@klnb.com | 301-222-0019

SCOTT MENDELSON

smendelson@klnb.com | 703-334-5611

MARC BALAMACI

mbalamaci@klnb.com | 703-334-5603



FLOOR PLAN

5635 FISHERS LN

ROCKVILLE, MD 20852, MONTGOMERY COUNTY

SUITE 400
1,000 - 14,207 SF

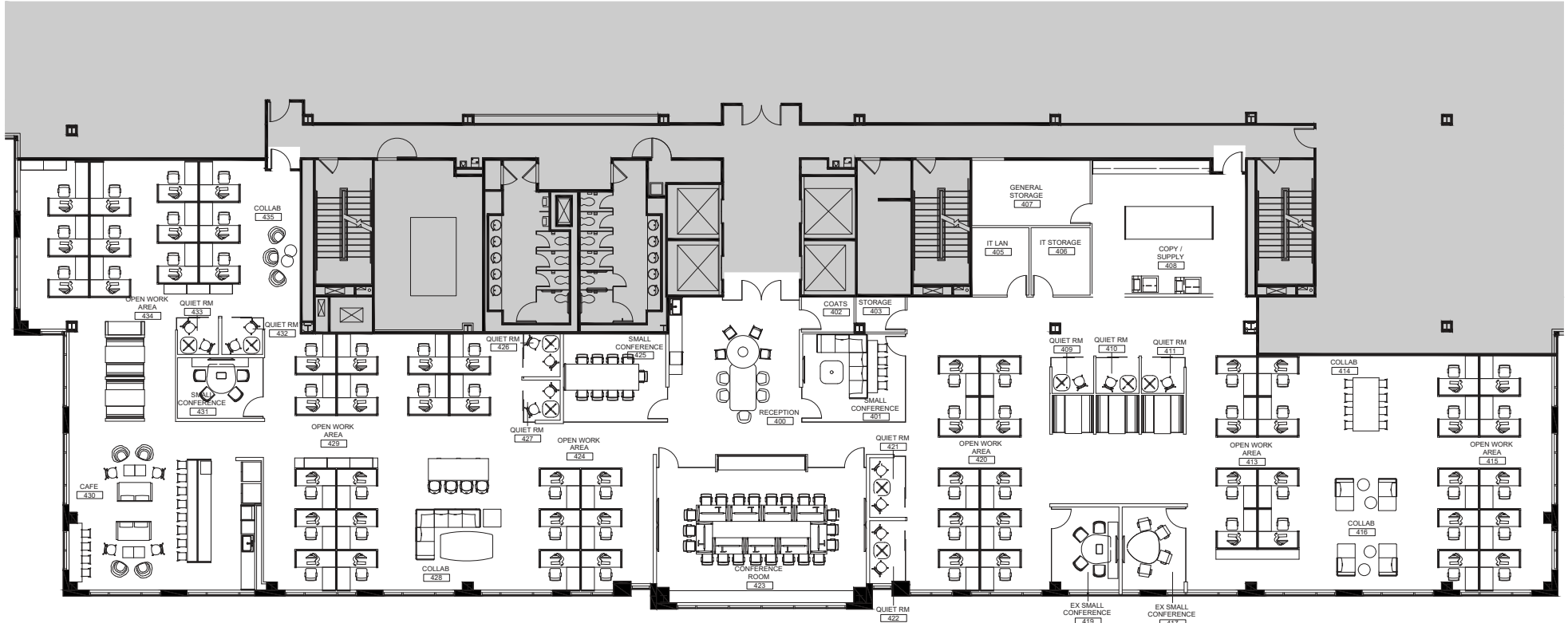

RASHIDA AKHTER

rakhter@klnb.com | 301-222-0019

SCOTT MENDELSON

smendelson@klnb.com | 703-334-5611

MARC BALAMACI

mbalamaci@klnb.com | 703-334-5603



PHOTOS

5635 FISHERS LN

ROCKVILLE, MD 20852, MONTGOMERY COUNTY

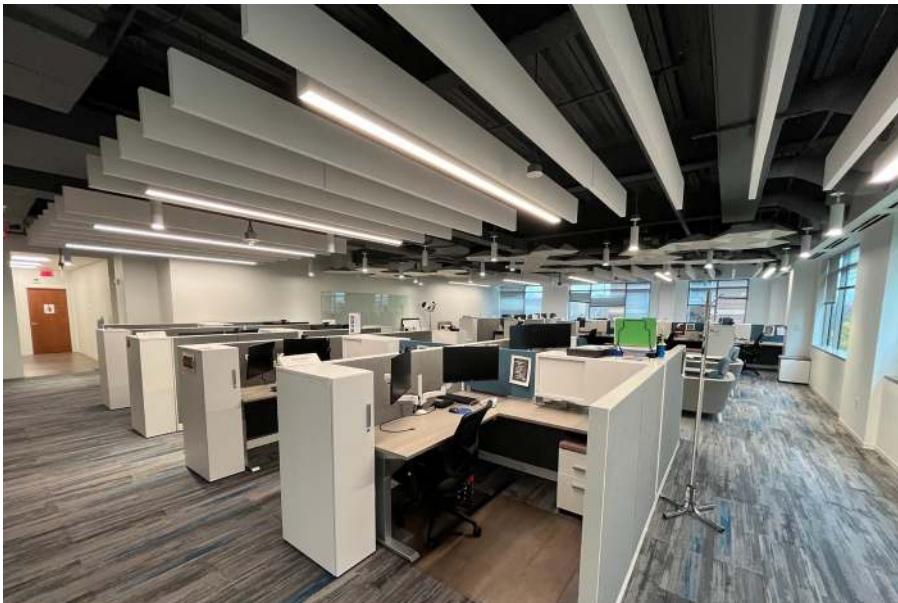

RASHIDA AKHTER

rakhter@klnb.com | 301-222-0019

SCOTT MENDELSON

smendelson@klnb.com | 703-334-5611

MARC BALAMACI

mbalamaci@klnb.com | 703-334-5603

klnb

PHOTOS

5635 FISHERS LN

ROCKVILLE, MD 20852, MONTGOMERY COUNTY



RASHIDA AKHTER

rakhter@klnb.com | 301-222-0019

SCOTT MENDELSON

smendelson@klnb.com | 703-334-5611

MARC BALAMACI

mbalamaci@klnb.com | 703-334-5603

klnb



5635 FISHERS LN

ROCKVILLE, MD 20852, MONTGOMERY COUNTY

FOR MORE INFORMATION, PLEASE CONTACT:

RASHIDA AKHTER

rakhter@klnb.com

301-222-0019

SCOTT MENDELSON

smendelson@klnb.com

703-334-5611

MARC BALAMACI

mbalamaci@klnb.com

703-334-5603

2273 Research Blvd, Suite 150, Rockville, MD 20850

.....

klnb.com



instagram.com/klnbcre



linkedin.com/company/klnb



facebook.com/KLNBCRE

CLICK TO VIEW VIRTUAL TOUR

CLICK TO VIEW PROPERTY WEBSITE

While we have no reason to doubt the accuracy of any of the information supplied, we cannot, and do not, guarantee its accuracy. All information should be independently verified prior to a purchase or lease of the property. We are not responsible for errors, omissions, misuse, or misinterpretation of information contained herein and make no warranty of any kind, express or implied, with respect to the property or any other matters.