



JOIN THESE RETAILERS

SAFEGWAY  UNITED BANK 

SKIN  SPIRIT 

drybar  citibank 

RETAIL FOR LEASE

- 1,025 SF available
- 19' Ceiling heights
- Prime retail space located on Wisconsin Avenue in front of the redeveloped Safeway Grocery store that anchors the retail shopping district in the heart of Georgetown/Glover Park
- Strong residential, office, restaurant and tourist area serving Glover park, Georgetown and the surrounding neighborhoods
- On-site parking available

STEVE COMBS

scombs@klnb.com | 202-420-7776

PHIL RUXTON

pruxton@klnb.com | 202-420-7777



# LOCATION

# 1855 WISCONSIN AVE NW

WASHINGTON, DC 20007

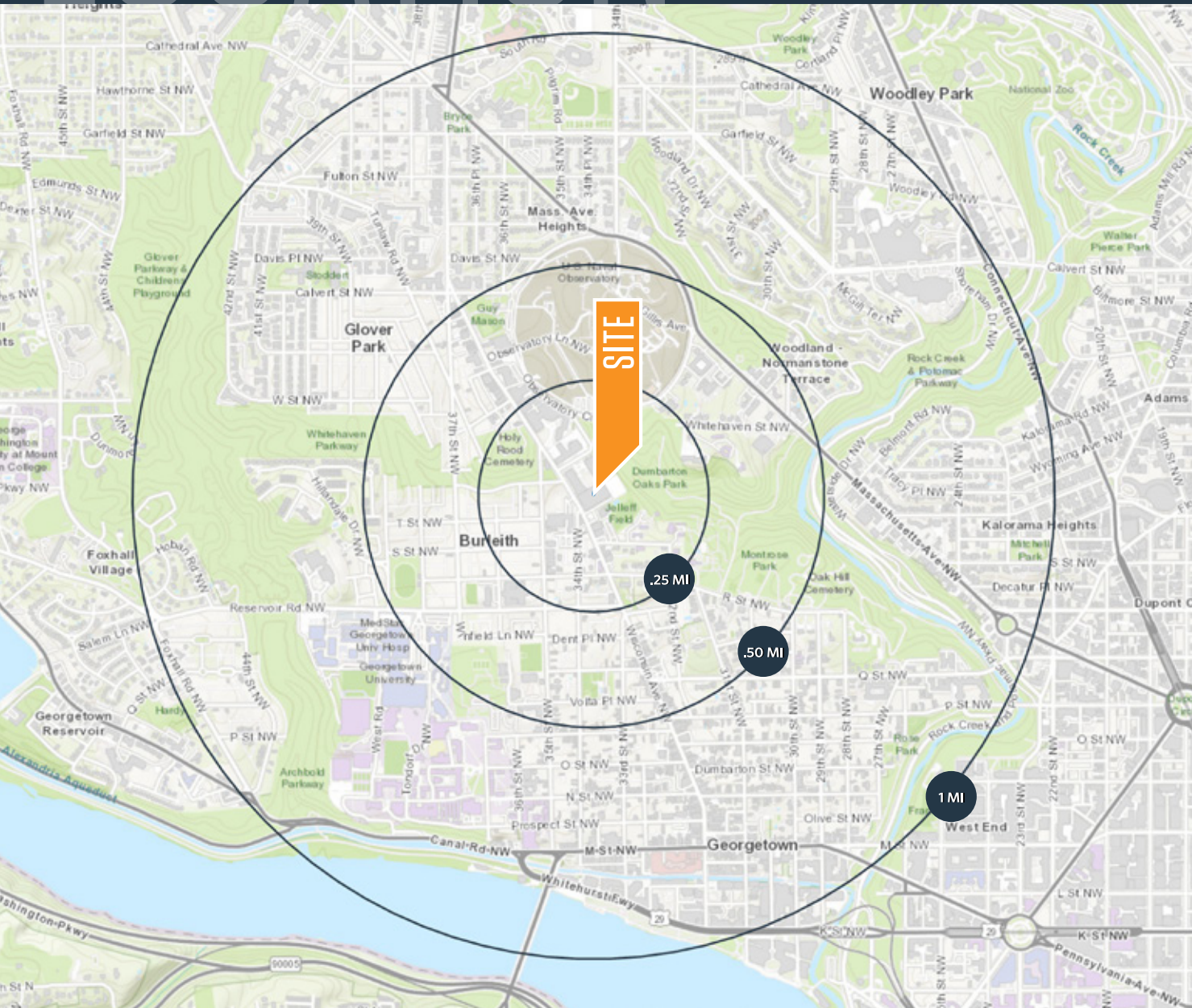

## AVAILABLE SPACE

SIZE	RATE	CONDITION	DELIVERY
1,0251 SF	\$75.00 PSF*	Built Out	Vacant

\*NNN \$17.33 PSF

## DEMOGRAPHICS | 2022:

	.25-MILE	.5-MILE	1-MILE
Population	2,063	6,217	32,519
Daytime Population	3,737	9,078	48,347
Households	1,004	2,746	13,770
Average HH Income	\$264,174	\$286,120	\$242,849

## TRAFFIC COUNTS | 2021

Wisconsin Ave NW	17,736 ADT
------------------	------------

**STEVE COMBS**

scombs@klnb.com | 202-420-7776

**PHIL RUXTON**

pruxton@klnb.com | 202-420-7777



# SITE PLAN

# 1855 WISCONSIN AVE NW

WASHINGTON, DC 20007



**STEVE COMBS**

scombs@klnb.com | 202-420-7776

**PHIL RUXTON**

pruxton@klnb.com | 202-420-7777



# SITE PLAN

## 1855 WISCONSIN AVE NW

WASHINGTON, DC 20007

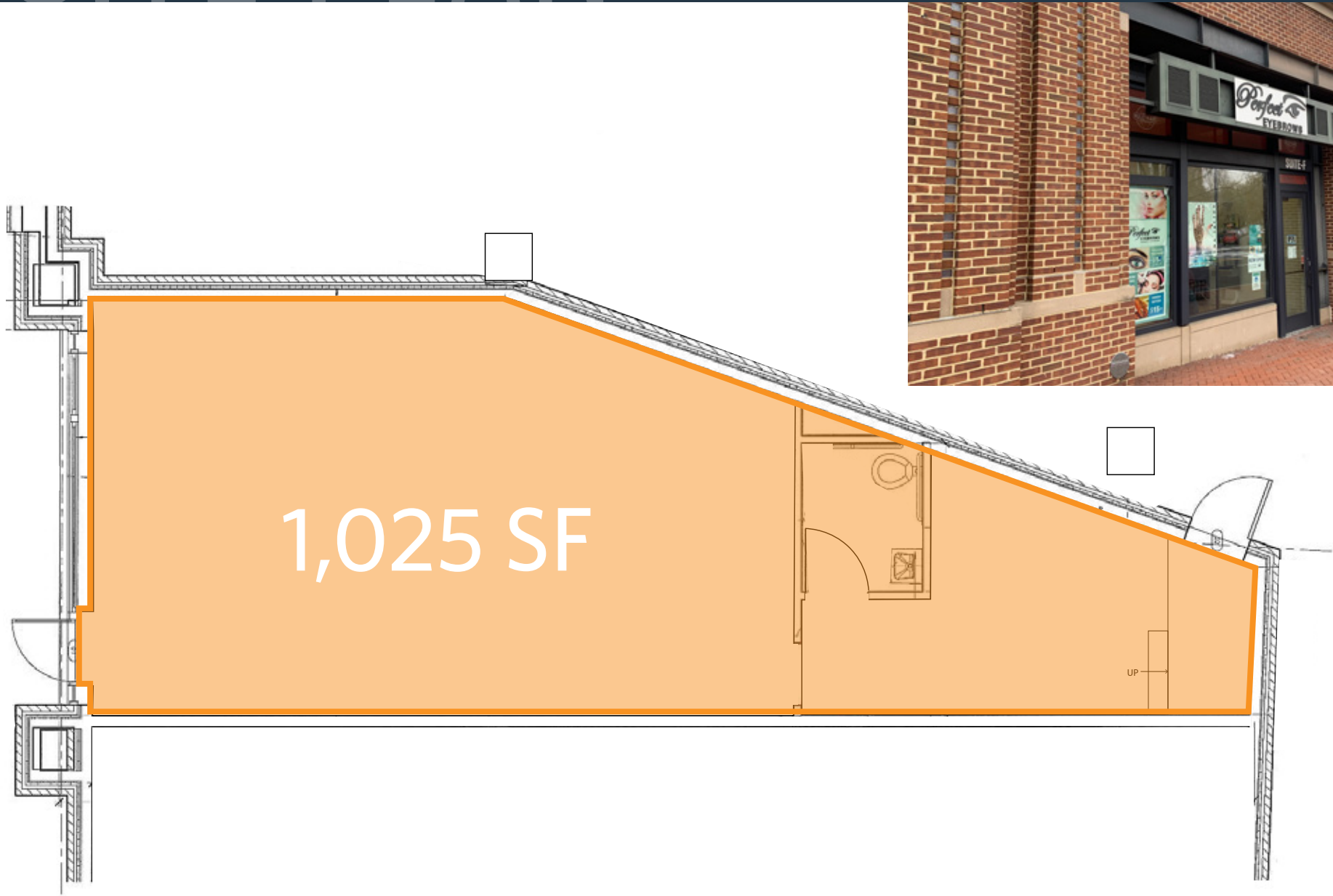

**STEVE COMBS**

scombs@klnb.com | 202-420-7776

**PHIL RUXTON**

pruxton@klnb.com | 202-420-7777

**klnb**



# AERIAL

# 1855 WISCONSIN AVE NW

WASHINGTON, DC 20007

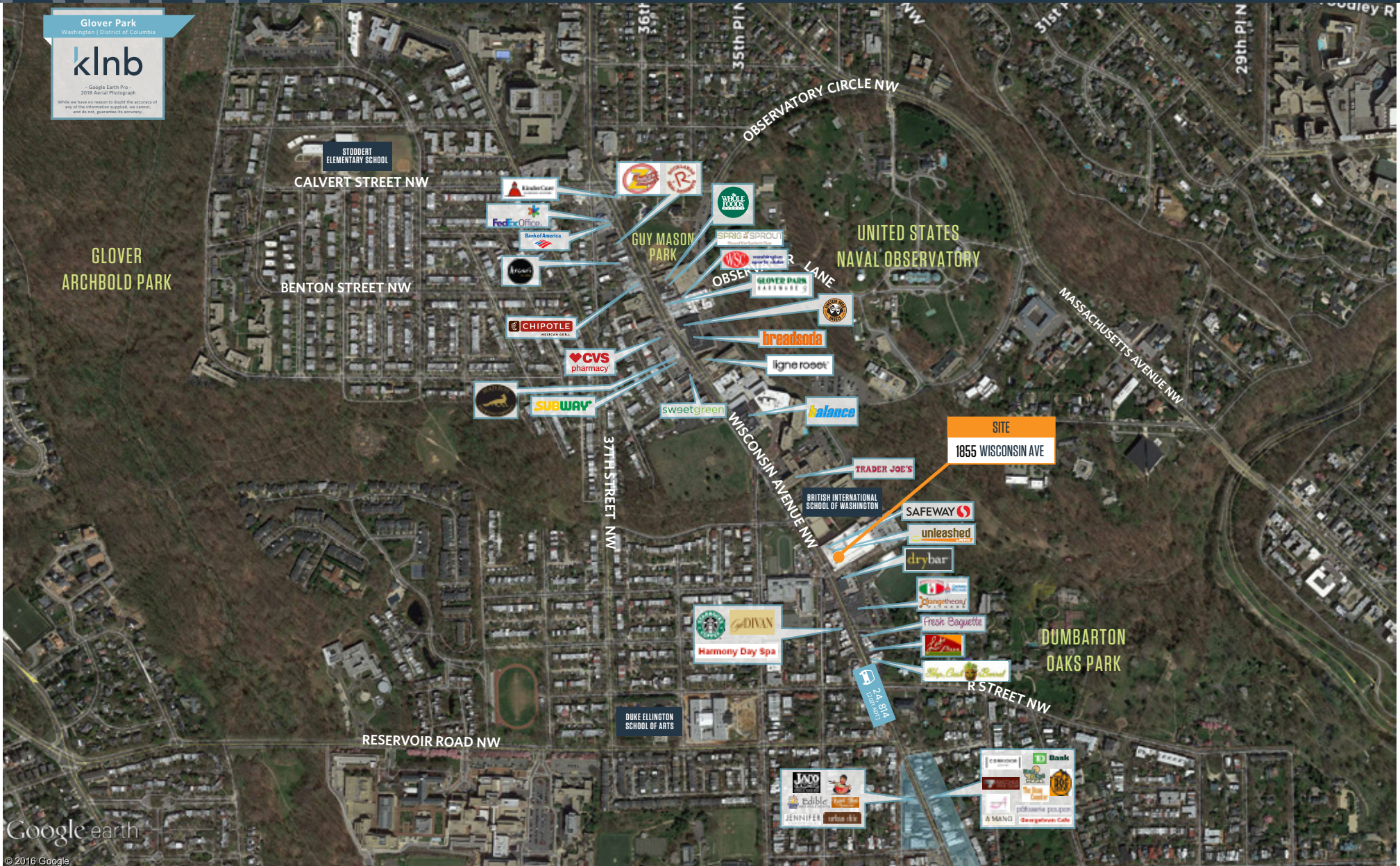

Glover Park  
Washington | District of Columbia

**klnb**

Google Earth Pro  
2018 Aerial Photograph

While we have no reason to doubt the accuracy of any of the information supplied, we cannot, and do not, guarantee its accuracy.

**STEVE COMBS**  
scombs@klnb.com | 202-420-7776

**PHIL RUXTON**  
pruxton@klnb.com | 202-420-7777

**klnb**





# 1855 WISCONSIN AVE NW

WASHINGTON, DC 20007

## FOR MORE INFORMATION, PLEASE CONTACT:

### STEVE COMBS

scombs@klnb.com

202-420-7776

### PHIL RUXTON

pruxton@klnb.com

202-420-7777

12435 Park Potomac Ave, Suite 250, Rockville, MD, 20854

.....

## klnb.com



[instagram.com/klnbcre](https://www.instagram.com/klnbcre)



[linkedin.com/company/klnb](https://www.linkedin.com/company/klnb)



[facebook.com/KLNBCRE](https://www.facebook.com/KLNBCRE)

**CLICK TO VIEW PROPERTY WEBSITE**

While we have no reason to doubt the accuracy of any of the information supplied, we cannot, and do not, guarantee its accuracy. All information should be independently verified prior to a purchase or lease of the property. We are not responsible for errors, omissions, misuse, or misinterpretation of information contained herein and make no warranty of any kind, express or implied, with respect to the property or any other matters.