



## AVAILABILITY

Unit B: 6,222 SF

## PROPERTY HIGHLIGHTS

- Located right off I-95 / ICC on Route 1
- Immediate access to I-95, I-495 and ICC (Route 200)
- Close proximity to Muirkirk Commuter Rail (Camden Line)
- Abundant shopping/dining options within 3 miles

**KENNETH FELLOWS**

kfellows@klnb.com | 301-222-0210

**ROBERT PUGH**

rpugh@klnb.com | 301-222-0211

**KEIRY MARTINEZ**

kmartinez@klnb.com | 703-334-5629

# FLOOR PLAN

## 12200 BALTIMORE AVE

**Unit B**  
**6,222 SF**

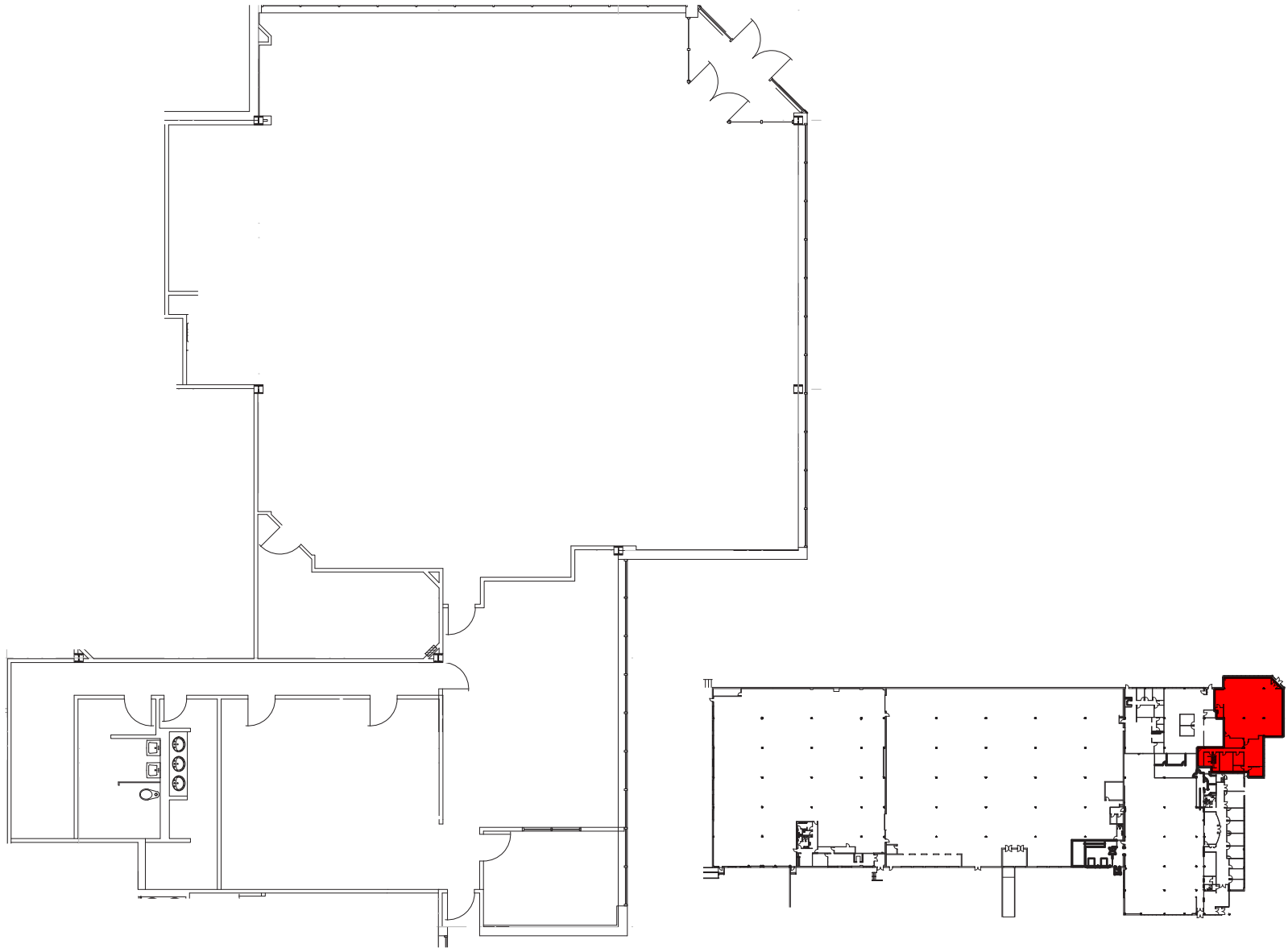

**KENNETH FELLOWS**

kfellows@klnb.com | 301-222-0210

**ROBERT PUGH**

rpugh@klnb.com | 301-222-0211

**KEIRY MARTINEZ**

kmartinez@klnb.com | 703-334-5629



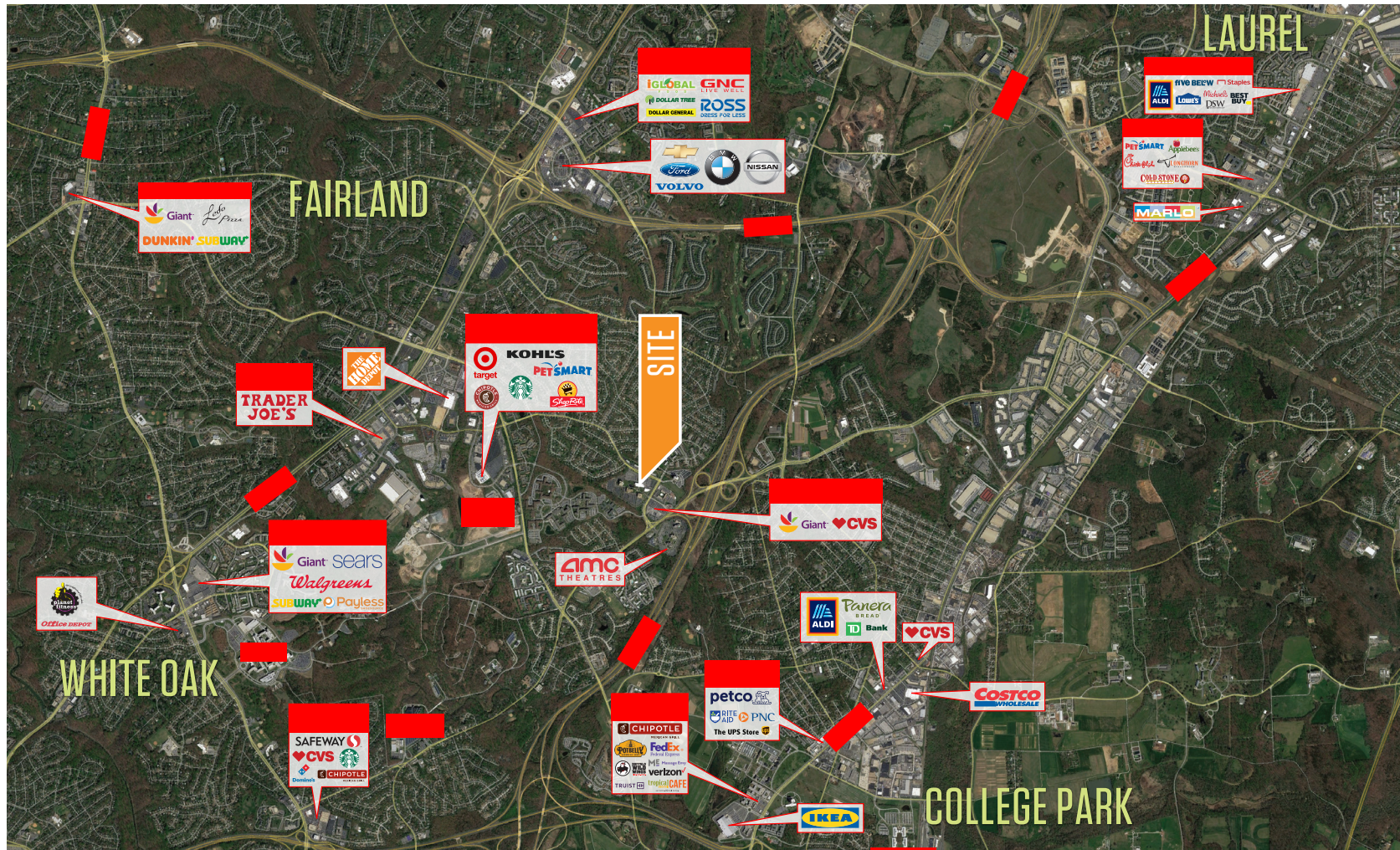

## Transportation

Thoroughfare	
MARC Station	0.5 miles
Route 200	0.8 miles

Airport	
Baltimore/Washington International	22.6 miles
Ronald Reagan Washington	21.9 miles



# 12200 BALTIMORE AVE

**FOR MORE INFORMATION, PLEASE CONTACT:**

**klnb.com**



[instagram.com/klnbcre](https://www.instagram.com/klnbcre)



[linkedin.com/company/klnb](https://www.linkedin.com/company/klnb)



[facebook.com/KLNBCRE](https://www.facebook.com/KLNBCRE)

**CLICK TO VIEW PROPERTY WEBSITE**

While we have no reason to doubt the accuracy of any of the information supplied, we cannot, and do not, guarantee its accuracy. All information should be independently verified prior to a purchase or lease of the property. We are not responsible for errors, omissions, misuse, or misinterpretation of information contained herein and make no warranty of any kind, express or implied, with respect to the property or any other matters.