



3,340 SF AVAILABLE
(2ND GEN RESTAURANT)
THIS TENANT IS OPEN AND OPERATING.
PLEASE DO NOT DISTURB.

JUST SIGNED!
BAWARCHI
INDIAN
RESTAURANT

JOIN THESE RESTAURANTS

Santini's
NEW YORK STYLE DELI

FIVE GUYS
BURGERS and FRIES



RETAIL FOR LEASE

- Restaurant plaza with an abundant parking ratio of 15.3/1,000 SF.
- Multiple points in ingress/egress including a signalized intersection offering easy access to the property.
- Heavily traveled Waxpool Road where over 40,000 vehicles pass the park daily.

ALEX WILLNER

awillner@klnb.com | 703-268-2718

DALLON L. CHENEY

dcheney@klnb.com | 703-268-2703

LOCATION

ASHBURN EATS

44640 WAXPOOL ROAD, ASHBURN, VA 20147, LOUDOUN COUNTY

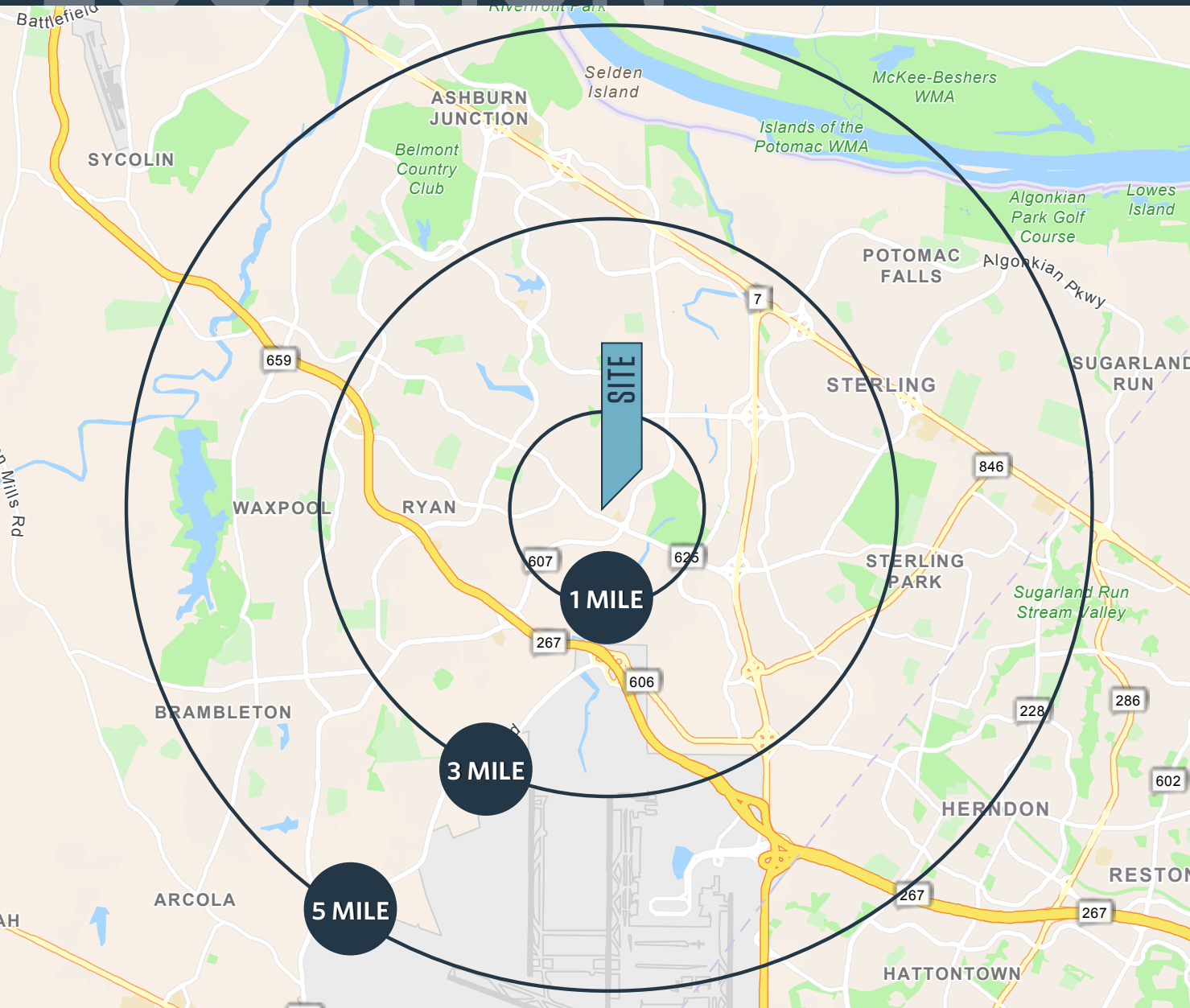

DEMOGRAPHICS | 2023:

	1-MILE	3-MILE	5-MILE
Population	1,650	78,719	238,518
Daytime Population	4,613	56,512	132,335
Households	429	28,525	81,526
Average HH Income	\$214,402	\$172,397	\$184,324
Median HH Income	\$172,664	\$130,968	\$145,765
Median Age	33.7	36.7	36.1

[CLICK TO DOWNLOAD DEMOGRAPHIC REPORT](#)

TRAFFIC COUNTS | 2023:

Waxpool Road	40,382 ADT
Sully Road (Route 28)	100,495 ADT

ALEX WILLNER

awillner@klnb.com | 703-268-2718

DALLON L. CHENEY

dcheney@klnb.com | 703-268-2703



SITE PLAN

ASHBURN EATS

44640 WAXPOOL ROAD, ASHBURN, VA 20147, LOUDOUN COUNTY

AVAILABLE SPACE

SIZE	RATE	DELIVERY CONDITION	TIMING OF AVAILABILITY
3,340 SF	\$38.00 PSF NNN*	2 ND GEN RESTAURANT	WITHIN 90 DAYS OF EXECUTED LEASE
*Est. NNN: \$15.37 PSF			

 [CLICK HERE FOR PHOTOS](#)



- AVAILABLE
- NEGOTIATING LEASE
- EXECUTED LEASE

Significant outdoor seating areas adjacent to all restaurants.

Significant outdoor seating areas adjacent to all restaurants.

Pylon signage

Waxpool Road

 40,382 [2023 ADT]

ALEX WILLNER

awillner@klnb.com | 703-268-2718

DALLON L. CHENEY

dcheney@klnb.com | 703-268-2703



SPACE PLAN | ASHBURN EATS

44640 WAXPOOL ROAD, ASHBURN, VA 20147, LOUDOUN COUNTY

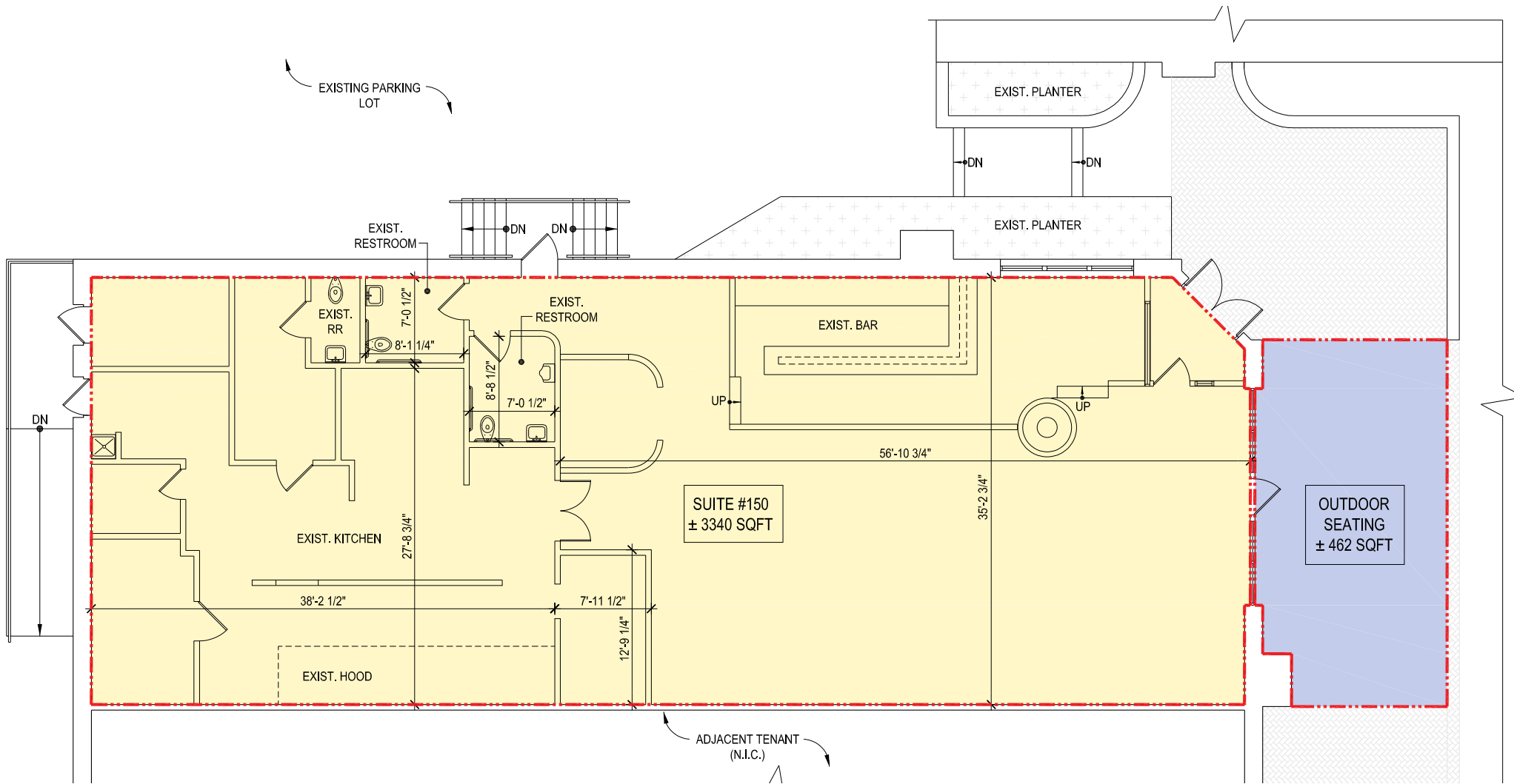



 [CLICK HERE FOR PHOTOS](#)

ALEX WILLNER
awillner@klnb.com | 703-268-2718

DALLON L. CHENEY
dcheney@klnb.com | 703-268-2703

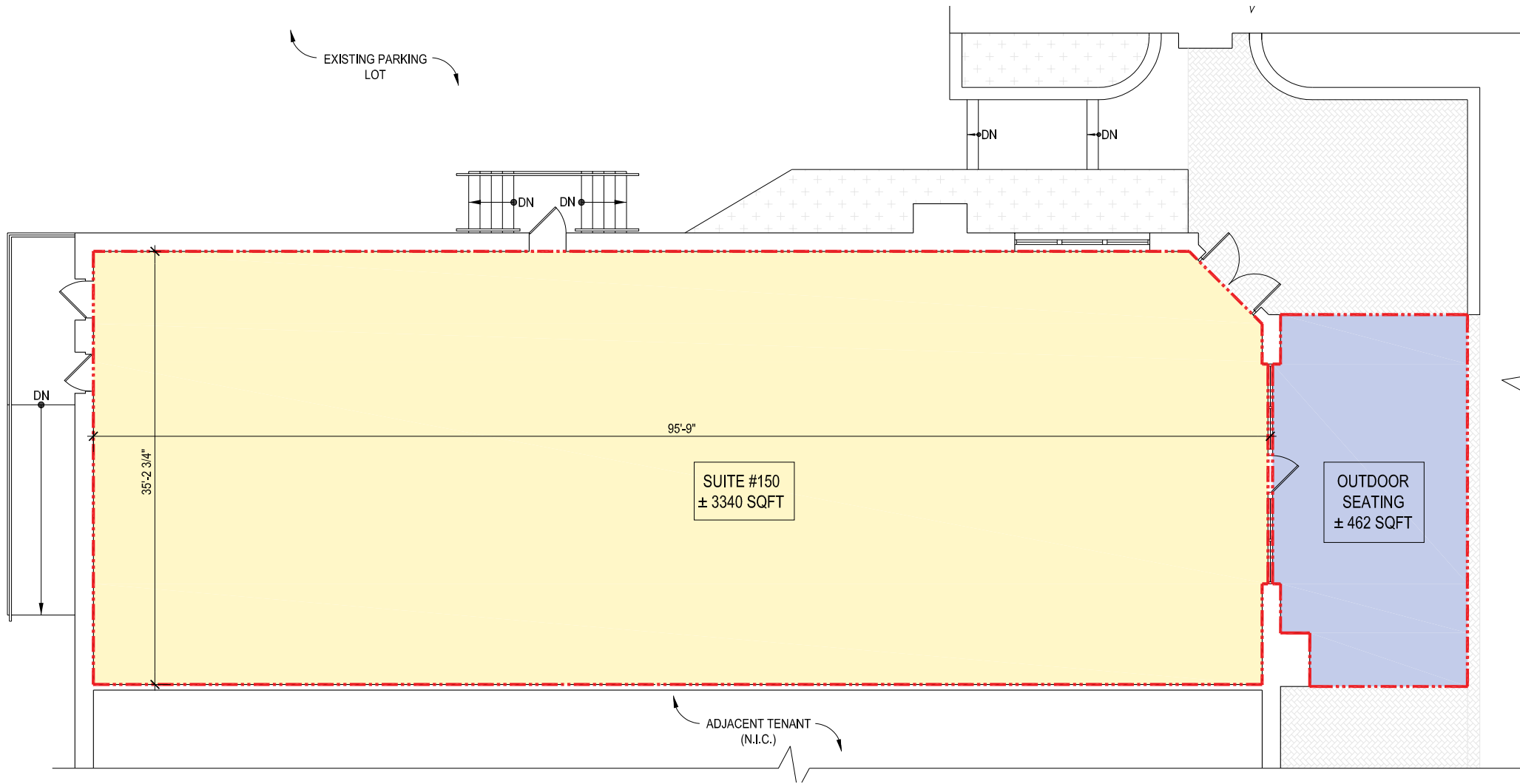



 [CLICK HERE FOR PHOTOS](#)



EVENING TRADE AREA DEMOS (2024):	
POPULATION:	216,623
TRADE AREA SIZE:	49.55 SQ MILES
POPULATION DENSITY:	4.32 PER SQ MILES
MEDIAN HH INCOME:	\$184,098
COLLEGE 4YR+:	71.4%

DAYTIME TRADE AREA DEMOS (2024):	
POPULATION:	104,004
TRADE AREA SIZE:	31.16 SQ MILES
MEDIAN HH INCOME:	\$174,942
COLLEGE 4YR+:	71.1%
DAYTIME POPULATION:	105,035
EXISTING OFFICE SF:	2.8M SF
EXISTING FLEX/ INDUSTRIAL SF:	1.7M SF
POPULATION DENSITY:	3.32 PER SQ. MILE

ALEX WILLNER

awillner@klnb.com | 703-268-2718

DALLON L. CHENEY

dcheney@klnb.com | 703-268-2703

PHOTOS

ASHBURN EATS

44640 WAXPOOL ROAD, ASHBURN, VA 20147, LOUDOUN COUNTY



ALEX WILLNER

awillner@klnb.com | 703-268-2718

DALLON L. CHENEY

dcheney@klnb.com | 703-268-2703

klnb

PHOTOS

ASHBURN EATS

44640 WAXPOOL ROAD, ASHBURN, VA 20147, LOUDOUN COUNTY



ALEX WILLNER

awillner@klnb.com | 703-268-2718

DALLON L. CHENEY

dcheney@klnb.com | 703-268-2703

klnb



ASHBURN EATS

44640 WAXPOOL ROAD, ASHBURN, VA 20147, LOUDOUN COUNTY

FOR MORE INFORMATION, PLEASE CONTACT:

ALEX WILLNER

awillner@klnb.com

703-268-2718

DALLON L. CHENEY

dcheney@klnb.com

703-268-2703

8065 Leesburg Pike, Suite 700, Tysons, VA 22182

.....

klnb.com



CLICK TO VIEW PROPERTY WEBSITE

While we have no reason to doubt the accuracy of any of the information supplied, we cannot, and do not, guarantee its accuracy. All information should be independently verified prior to a purchase or lease of the property. We are not responsible for errors, omissions, misuse, or misinterpretation of information contained herein and make no warranty of any kind, express or implied, with respect to the property or any other matters.