

FLEX SPACE AVAILABLE

9700 Martin Luther King Jr. Highway, Lanham, MD 20706
Prince George's County

80% Warehouse End Cap;
2 Docks and Ramped Drive-In



FOR SUBLEASE

AVAILABLE FOR SUBLEASE

► **8,642 SF End-Cap**

- **Loading:** Three (3) docks (one ramped)
- **Ceiling Height:** 16'9" clear throughout
- **Column Spacing:** 40' x 40'

- **Sublease Term:** Through 4/30/2027;
(Additional term can be requested)
- **Pricing:** Call for Competitive Sublease Pricing

OWNED & MANAGED BY:
 **LONGPOINT**
BUILT FOR MOVEMENT

Spence Daw
sdaw@klnb.com
443-574-1429

9881 Broken Land Parkway, #300
Columbia, MD 21046
klnb.com

NAIklnb

FLEX SPACE AVAILABLE

9700 Martin Luther King Jr. Highway, Lanham, MD 20706
Prince George's County

8,642 SF
AVAILABLE

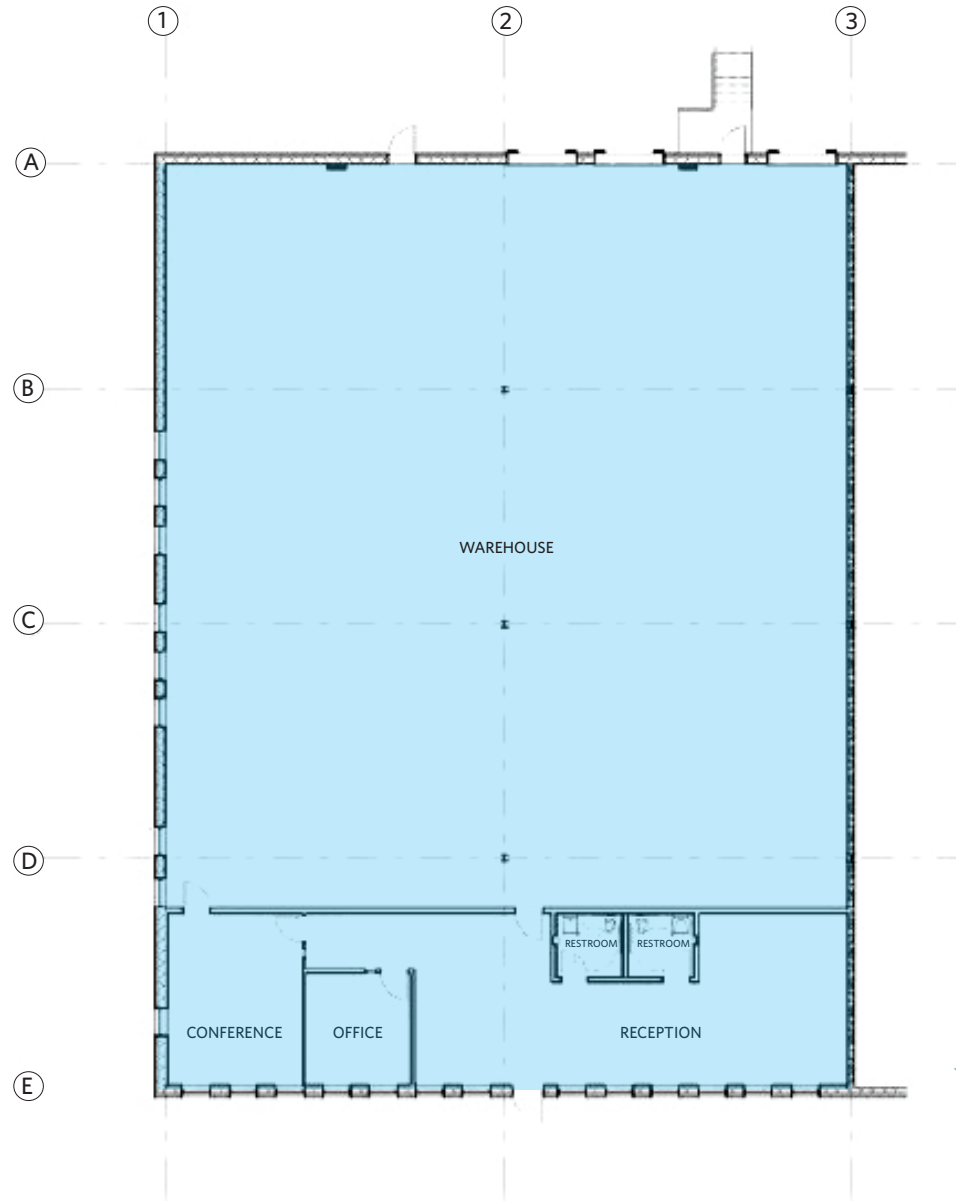

FLOOR PLAN

Spence Daw
sdaw@klnb.com
443-574-1429

9881 Broken Land Parkway, #300
Columbia, MD 21046
klnb.com



FLEX SPACE AVAILABLE

9700 Martin Luther King Jr. Highway, Lanham, MD 20706
Prince George's County

TRUCK COURT

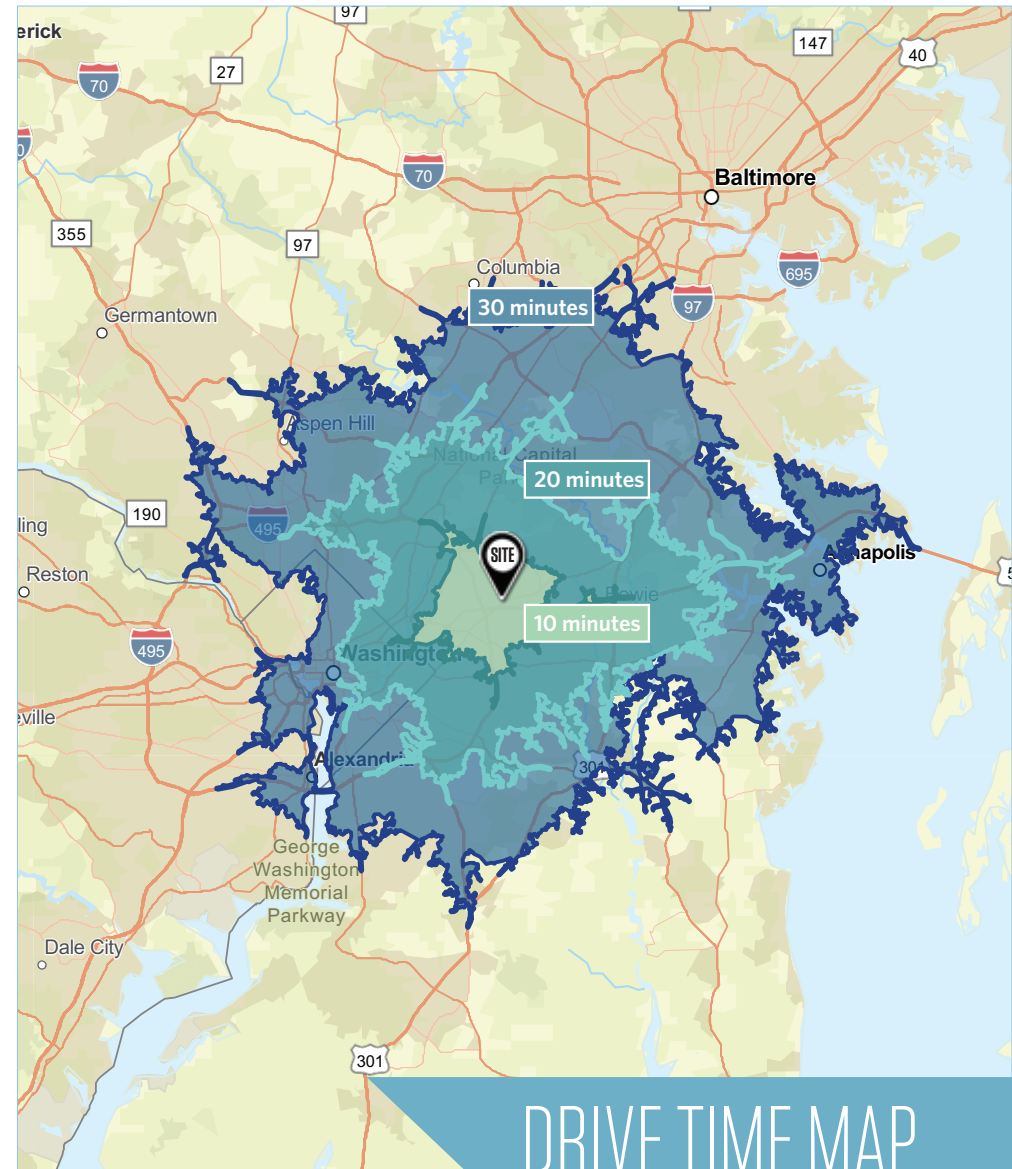

DRIVE TIME MAP

Contact
Information:

Spence Daw
sdaw@klnb.com
443-574-1429

9881 Broken Land Parkway, #300
Columbia, MD 21046
klnb.com

NAklnb