



## AVAILABILITY

- Suite: 400
- 1,000 - 14,207 SF
- Rental Rate: Negotiable
- Shared Office Space
- Term Ends: June 1, 2030

## OFFICE FOR SUBLEASE

- Type: Class B | 3 Star Office
- RBA: 185,000 SF
- Stories: 6
- Parking: Surface
- Year Built: 2004

## AMENITIES

- Bicycle Storage
- Food Service
- Bus Line
- Metro/Subway
- Car Charging Station
- Fitness Center
- Property Manager on Site
- Conferencing Facility
- Restaurant
- Energy Star Labeled
- Secure Storage

**RASHIDA AKHTER**

rakhter@klnb.com | 301-222-0019

**SCOTT MENDELSON**

smendelson@klnb.com | 703-334-5611

**MARC BALAMACI**

mbalamaci@klnb.com | 703-334-5603

# AERIAL

# 5635 FISHERS LN

ROCKVILLE, MD 20852, MONTGOMERY COUNTY



Rockville  
Montgomery County | Maryland

## klnb

- Google Earth Pro -  
2018 Aerial Photograph

While we have no reason to doubt the accuracy of any of the information supplied, we cannot, and do not, guarantee its accuracy.

SCALE  
0 1/2 Mile 1 Mile

**RASHIDA AKHTER**  
rakhter@klnb.com | 301-222-0019

**SCOTT MENDELSON**  
smendelson@klnb.com | 703-334-5611

**MARC BALAMACI**  
mbalamaci@klnb.com | 703-334-5603



# FLOOR PLAN

## 5635 FISHERS LN

ROCKVILLE, MD 20852, MONTGOMERY COUNTY

**SUITE 400**  
**1,000 - 14,207 SF**

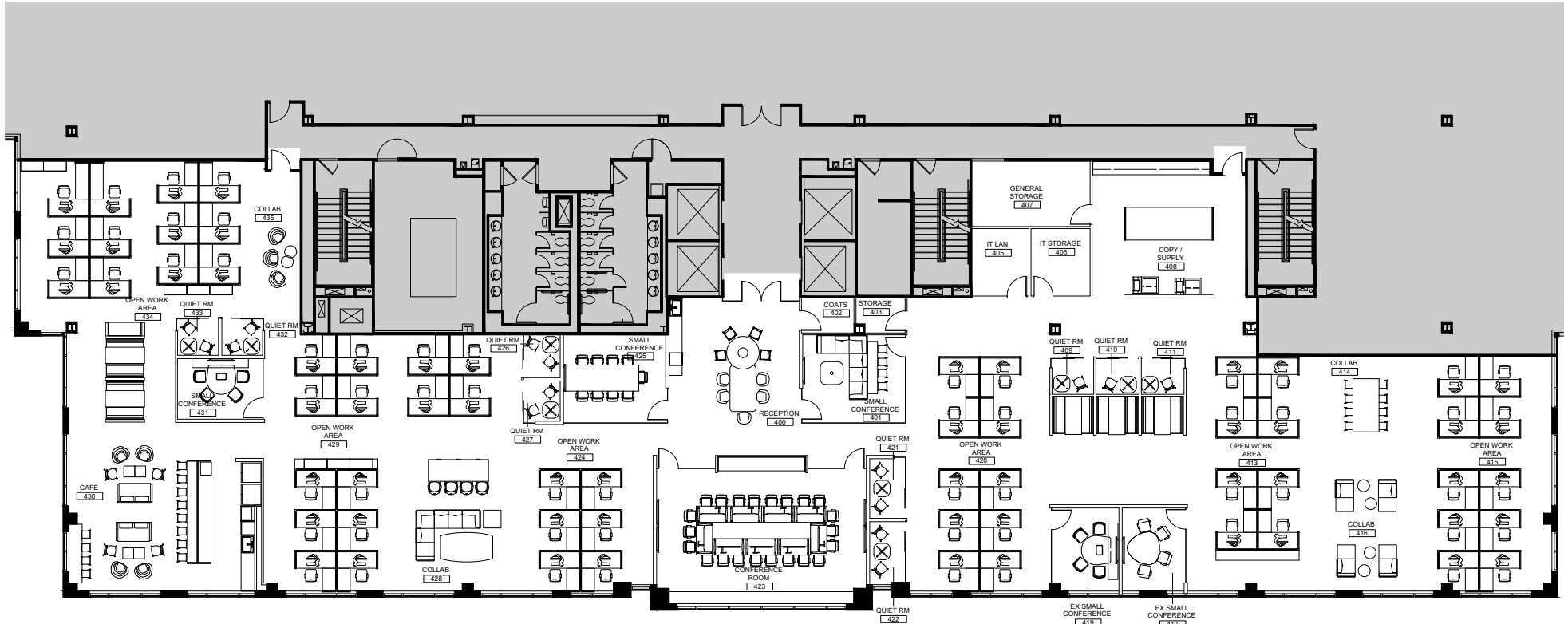

**RASHIDA AKHTER**

rakhter@klnb.com | 301-222-0019

**SCOTT MENDELSON**

smendelson@klnb.com | 703-334-5611

**MARC BALAMACI**

mbalamaci@klnb.com | 703-334-5603



# PHOTOS

## 5635 FISHERS LN

ROCKVILLE, MD 20852, MONTGOMERY COUNTY

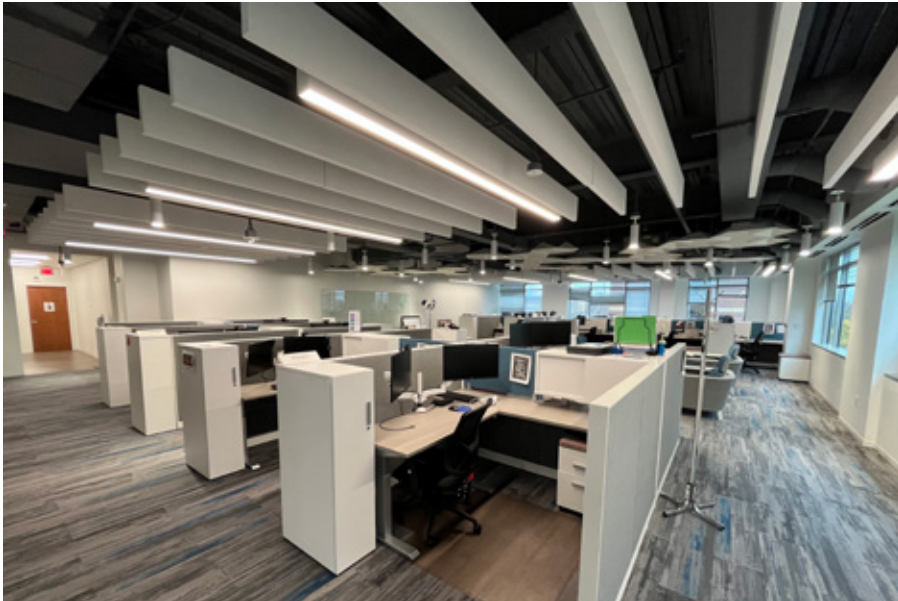

**RASHIDA AKHTER**

rakhter@klnb.com | 301-222-0019

**SCOTT MENDELSON**

smendelson@klnb.com | 703-334-5611

**MARC BALAMACI**

mbalamaci@klnb.com | 703-334-5603

**klnb**

# PHOTOS

## 5635 FISHERS LN

ROCKVILLE, MD 20852, MONTGOMERY COUNTY



**RASHIDA AKHTER**

rakhter@klnb.com | 301-222-0019

**SCOTT MENDELSON**

smendelson@klnb.com | 703-334-5611

**MARC BALAMACI**

mbalamaci@klnb.com | 703-334-5603

**klnb**



# 5635 FISHERS LN

ROCKVILLE, MD 20852, MONTGOMERY COUNTY

## FOR MORE INFORMATION, PLEASE CONTACT:

### RASHIDA AKHTER

rakhter@klnb.com

301-222-0019

### SCOTT MENDELSON

smendelson@klnb.com

703-334-5611

### MARC BALAMACI

mbalamaci@klnb.com

703-334-5603

12435 Park Potomac Ave, Suite 250, Rockville, MD, 20854

.....

## klnb.com



instagram.com/klnbcre



linkedin.com/company/klnb



facebook.com/KLNBCRE

**CLICK TO VIEW PROPERTY WEBSITE**

While we have no reason to doubt the accuracy of any of the information supplied, we cannot, and do not, guarantee its accuracy. All information should be independently verified prior to a purchase or lease of the property. We are not responsible for errors, omissions, misuse, or misinterpretation of information contained herein and make no warranty of any kind, express or implied, with respect to the property or any other matters.