



WAREHOUSE FOR LEASE

Available October 1, 2024

- Three Docks
- 14' Clear
- Small Office Area
- \$15 NNN

PROPERTY OVERVIEW

- Stories: 2
- Docks: 4 ext
- Drive Ins: 4 tot./ 10'w x 12'h
- Building Height: 35'
- Year Built: 1981
- Parking: 25 Free Surface Spaces Ratio of 1.25/ 1,000 SF
- Construction: Reinforced Concrete

KENNETH FELLOWS

kfellows@klnb.com | 301-222-0210

ROBERT PUGH

rpugh@klnb.com | 301-222-0211

KEIRY MARTINEZ

kmartinez@klnb.com | 703-334-5629

MARKET

12300 CARROLL AVE

ROCKVILLE, MD, 20852, MONTGOMERY COUNTY

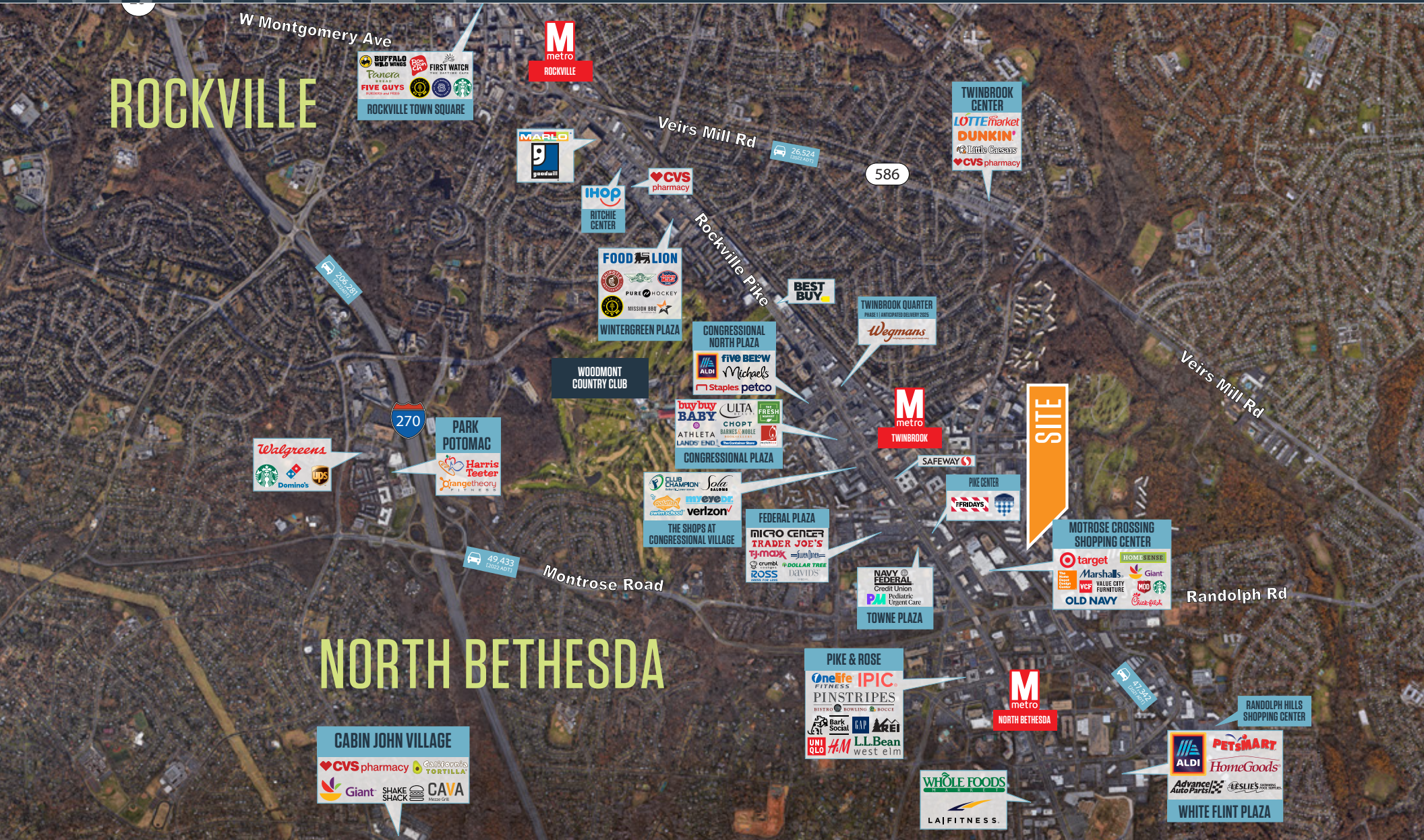

KENNETH FELLOWS

kfellows@klnb.com | 301-222-0210

ROBERT PUGH

rpugh@klnb.com | 301-222-0211

KEIRY MARTINEZ

kmartinez@klnb.com | 703-334-5629



FLOOR PLAN

12300 CARROLL AVE

ROCKVILLE, MD, 20852, MONTGOMERY COUNTY

BAY 4
2,750 SF

BAY 3
2,750 SF

BAY 2
2,750 SF

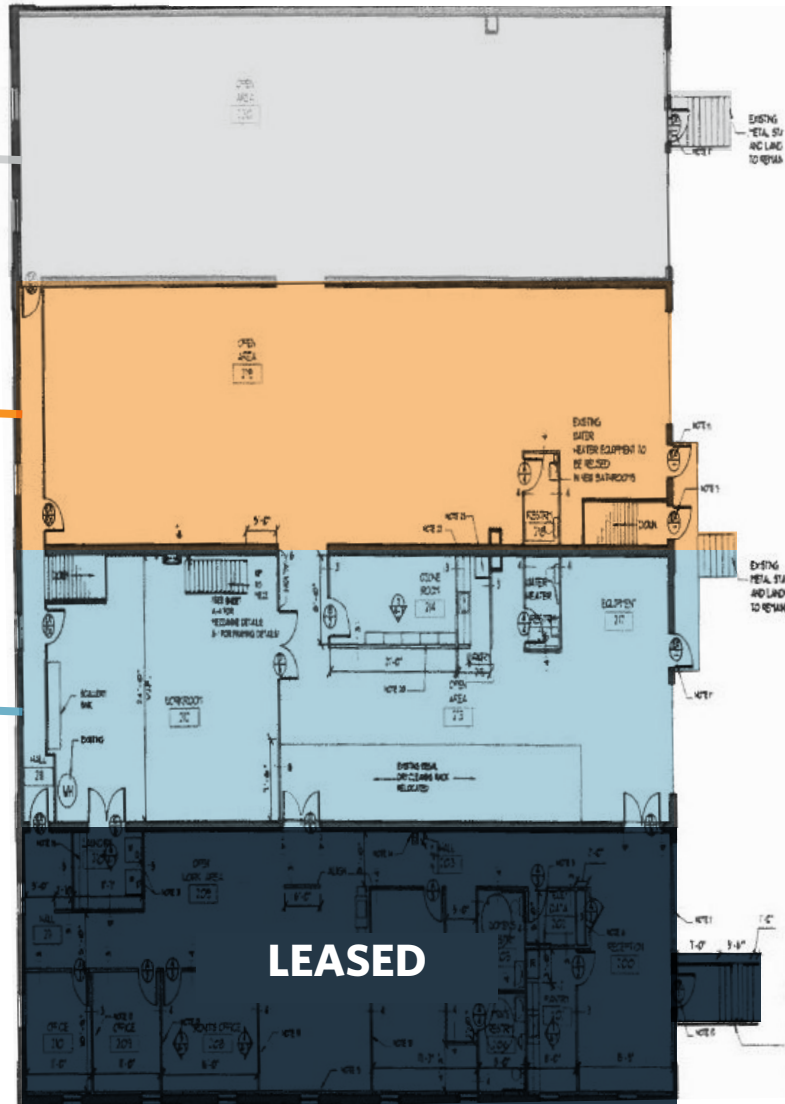

KENNETH FELLOWS

kfellows@klnb.com | 301-222-0210

ROBERT PUGH

rpugh@klnb.com | 301-222-0211

KEIRY MARTINEZ

kmartinez@klnb.com | 703-334-5629





12300 CARROLL AVE

ROCKVILLE, MD, 20852, MONTGOMERY COUNTY

FOR MORE INFORMATION, PLEASE CONTACT:

KENNETH FELLOWS

kfellows@klnb.com

301-222-0210

ROBERT PUGH

rpugh@klnb.com

301-222-0211

KEIRY MARTINEZ

kmartinez@klnb.com

703-334-5629

12435 Park Potomac Ave, Suite 250, Rockville, MD, 20854

klnb.com

 facebook.com/KLNBCRE

 [@KLNBCRE](https://twitter.com/KLNBCRE)

 linkedin.com/company/klnb

 instagram.com/klnbcre

CLICK TO VIEW PROPERTY WEBSITE

While we have no reason to doubt the accuracy of any of the information supplied, we cannot, and do not, guarantee its accuracy. All information should be independently verified prior to a purchase or lease of the property. We are not responsible for errors, omissions, misuse, or misinterpretation of information contained herein and make no warranty of any kind, express or implied, with respect to the property or any other matters.