

# CRANBERRY BUSINESS PARK

1003 - 1015 Old Philadelphia Road, Aberdeen, MD 21001  
Harford County



FOR LEASE

## PROPERTY HIGHLIGHTS:

- **Total SF Available:** 9,000 - 130,250 SF
- **Max Contiguous:** 48,000 SF
- **Clear Height:** 19' - 26'
- **Loading:** Dock and drive-In loading
- **Sprinkler:** Wet
- **Lighting:** LED
- **Zoning:** M2 - Heavy Industrial
- **Access:** Easy access to all points via Route 40 and I-95
- **Rental Rate:** \$7.50 - \$10.00/SF NNN
- **Operating Expenses:** \$1.65/SF - 2025 estimate

**Peter Dudley**  
pdudley@klnb.com  
443-632-2064

**Christopher Wright**  
cwright@klnb.com  
443-914-2600

**Ryan Paszkiewicz**  
rpaszkiewicz@klnb.com  
443-632-2062

100 West Road, Suite 505  
Baltimore, MD 21204  
**klnb.com**

**NAI klnb**

# CRANBERRY BUSINESS PARK

1003 - 1015 Old Philadelphia Road, Aberdeen, MD 21001  
Harford County

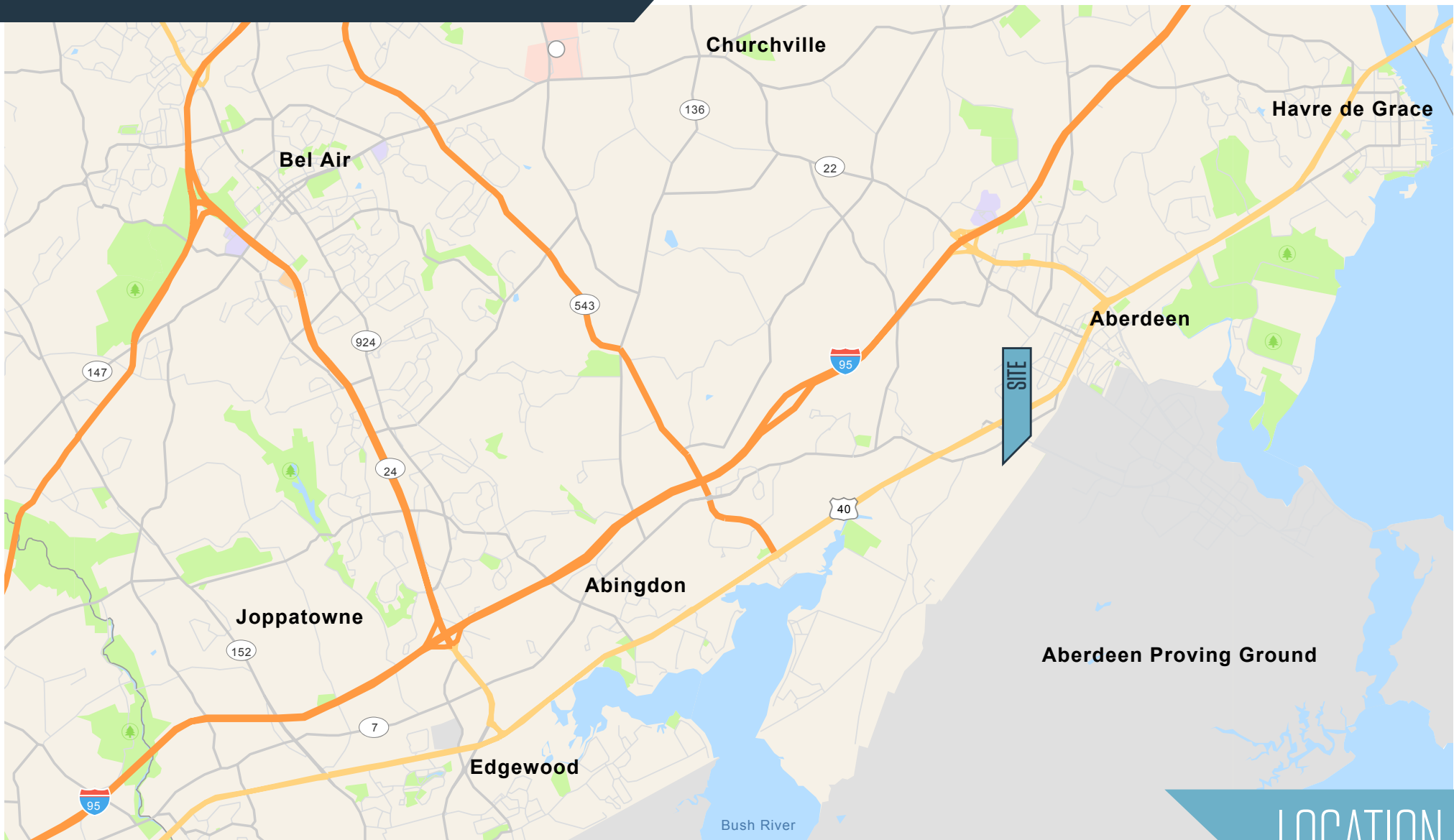

LOCATION

**Peter Dudley**  
pdudley@klnb.com  
443-632-2064

**Christopher Wright**  
cwright@klnb.com  
443-914-2600

**Ryan Paszkiewicz**  
rpaszkiwicz@klnb.com  
443-632-2062

100 West Road, Suite 505  
Baltimore, MD 21204  
**klnb.com**



# CRANBERRY BUSINESS PARK

1003 - 1015 Old Philadelphia Road, Aberdeen, MD 21001  
Harford County

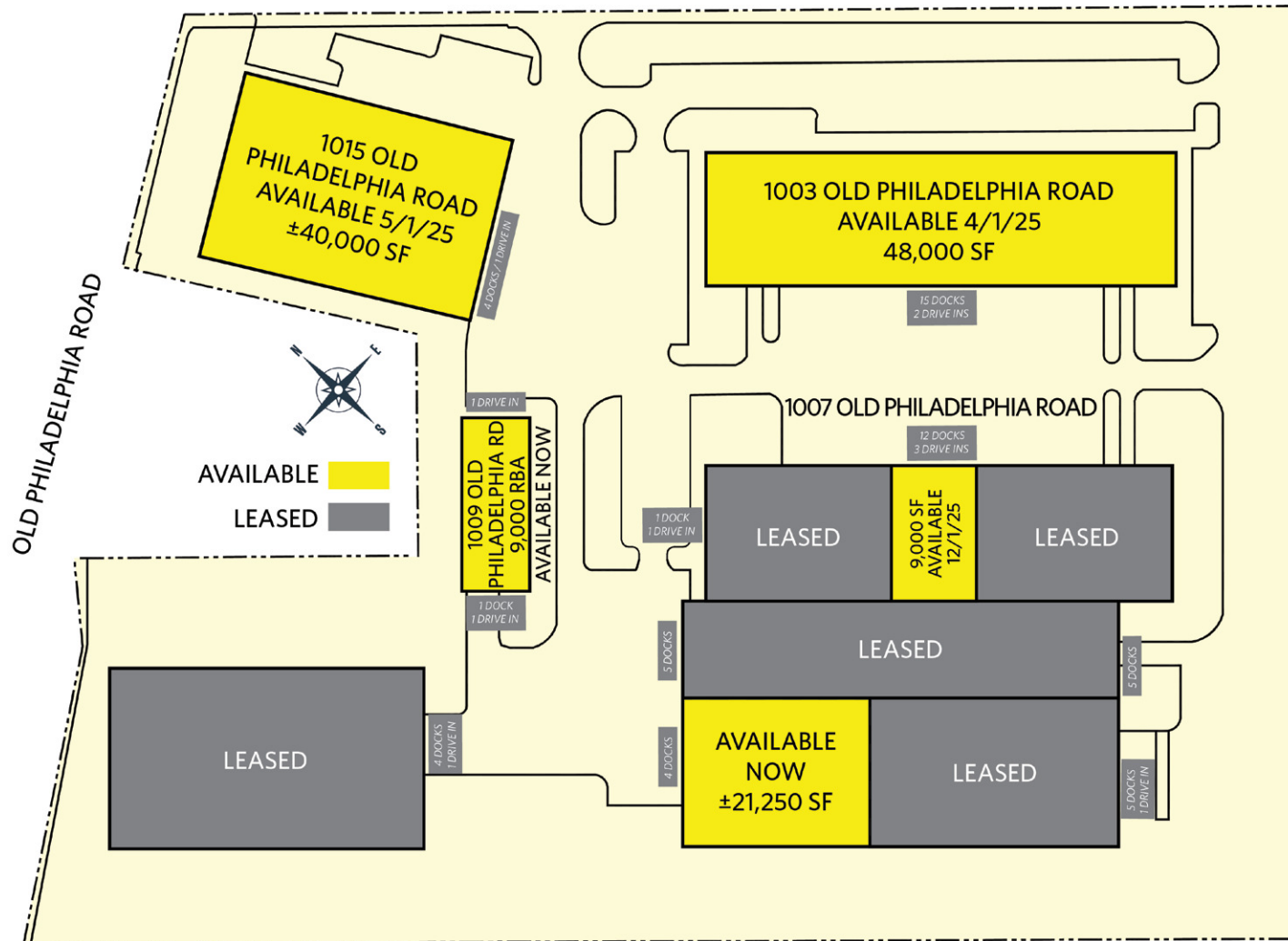

## 1009 FLOOR PLAN

**Peter Dudley**  
pdudley@klnb.com  
443-632-2064

**Christopher Wright**  
cwright@klnb.com  
443-914-2600

**Ryan Paszkiewicz**  
rpaszkiewicz@klnb.com  
443-632-2062

100 West Road, Suite 505  
Baltimore, MD 21204  
[klnb.com](http://klnb.com)



# CRANBERRY BUSINESS PARK

1003 - 1015 Old Philadelphia Road, Aberdeen, MD 21001  
Harford County

WATER CHEM

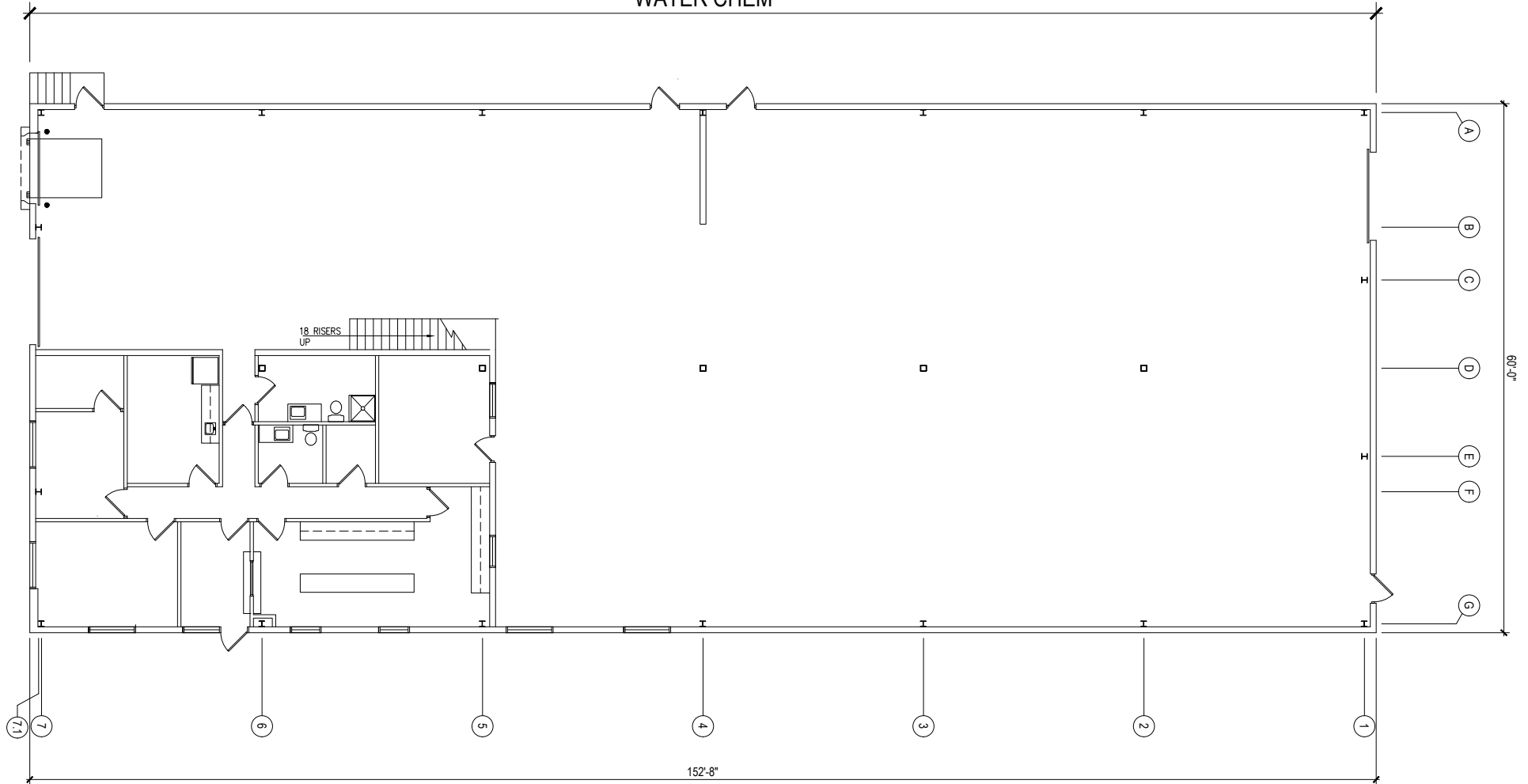

1009 FLOOR PLAN

**Peter Dudley**  
pdudley@klnb.com  
443-632-2064

**Christopher Wright**  
cwright@klnb.com  
443-914-2600

**Ryan Paszkiewicz**  
rpaszkiewicz@klnb.com  
443-632-2062

100 West Road, Suite 505  
Baltimore, MD 21204  
[klnb.com](http://klnb.com)



# CRANBERRY BUSINESS PARK

1003 - 1015 Old Philadelphia Road, Aberdeen, MD 21001  
Harford County

[CLICK TO VIEW PROPERTY WEBSITE](#)

For More Information, Please Contact:

**Peter Dudley**

[pdudley@klnb.com](mailto:pdudley@klnb.com)  
443-632-2064

**Christopher Wright**

[cwright@klnb.com](mailto:cwright@klnb.com)  
443-914-2600

**Ryan Paszkiewicz**

[rpaszkiewicz@klnb.com](mailto:rpaszkiewicz@klnb.com)  
443-632-2062

100 West Road, Suite 505  
Baltimore, MD 21204

[klnb.com](http://klnb.com)



[instagram.com/klnbcre](https://www.instagram.com/klnbcre)



[linkedin.com/company/klnb](https://www.linkedin.com/company/klnb)



[facebook.com/KLNBCRE](https://www.facebook.com/KLNBCRE)

While we have no reason to doubt the accuracy of any of the information supplied, we cannot, and do not, guarantee its accuracy. All information should be independently verified prior to a purchase or lease of the property. We are not responsible for errors, omissions, misuse, or misinterpretation of information contained herein and make no warranty of any kind, express or implied, with respect to the property or any other matters.

