

8825 CENTRE PARK DRIVE

8825 Centre Park Drive, Columbia, MD 21045
Howard County



JOIN:



- Available: 3,600 SF
- Located on Centre Park Drive conveniently accessed off of Rt. 100
- Excellent mix of office and residential population in the immediate trade area
- Adjacent to successful Giant Food anchored shopping center

Ryan Minnehan
rminnehan@klnb.com
443-632-2088

Mason Bernstein
mbernstein@klnb.com
443-632-2089

Alex Shearer
ashearer@klnb.com
443-632-2081

100 West Road, Suite 505
Towson, MD 21204
klnb.com

klnb

8825 CENTRE PARK DRIVE

8825 Centre Park Drive, Columbia, MD 21045
Howard County

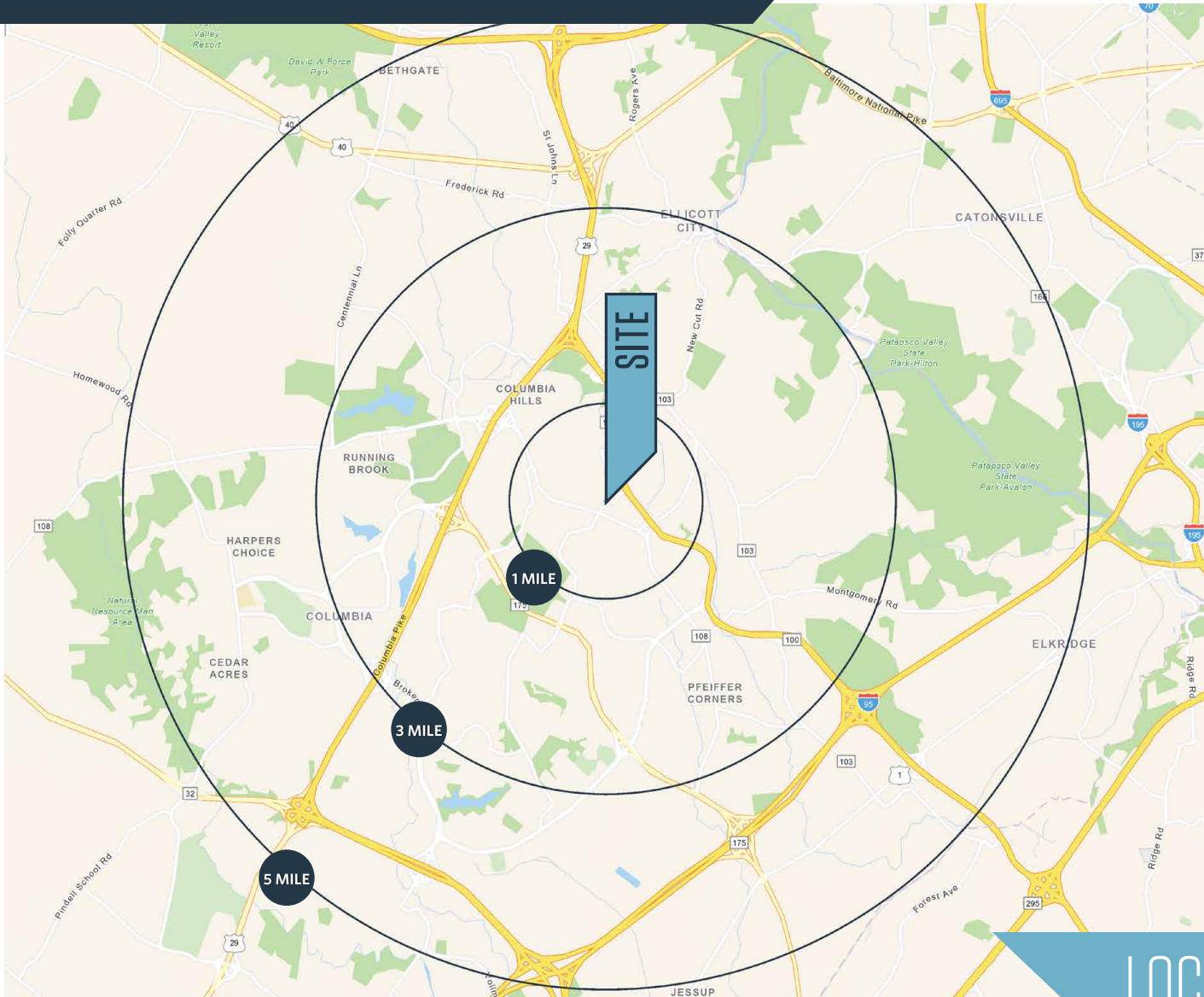

AVAILABLE SPACE

3,600 SF

DEMOGRAPHICS | 2024:

1-MILE	3-MILE	5-MILE
Population		
12,887	93,269	223,504
Daytime Population		
12,750	81,955	236,425
Households		
4,784	35,457	84,028
Average HH Income		
\$197,037	\$183,347	\$175,029

[CLICK TO DOWNLOAD DEMOGRAPHIC REPORT](#)

TRAFFIC COUNTS | 2023:

Centre Park Drive	21,945 ADT
Route 108	24,155 ADT
Route 100	80,090 ADT

LOCATION & DEMOGRAPHICS

Ryan Minnehan
rminnehan@klnb.com
443-632-2088

Mason Bernstein
mbernstein@klnb.com
443-632-2089

Alex Shearer
ashearer@klnb.com
443-632-2081

100 West Road, Suite 505
Towson, MD 21204
klnb.com



8825 CENTRE PARK DRIVE

8825 Centre Park Drive, Columbia, MD 21045
Howard County

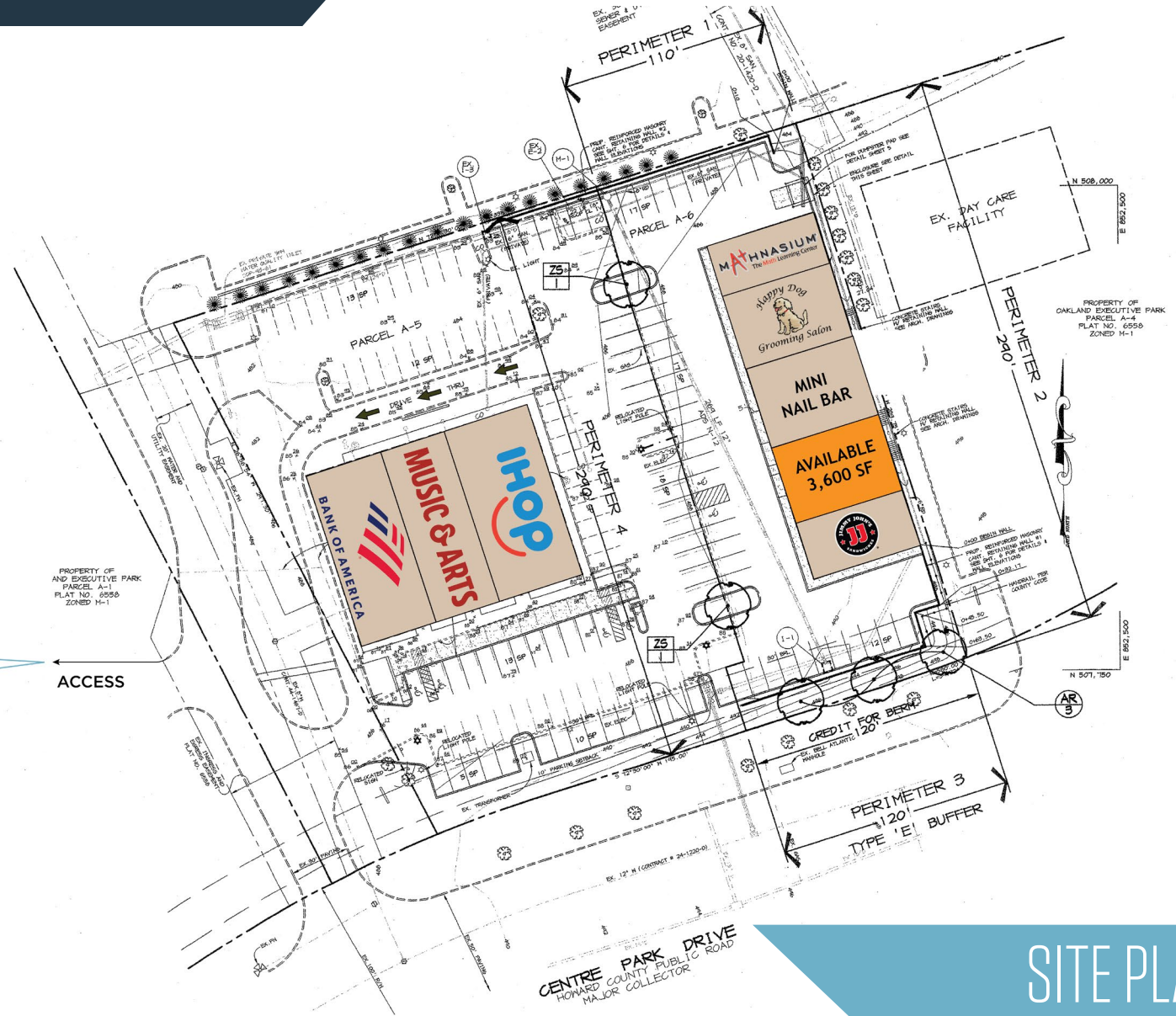

COLUMBIA PALACE PLAZA

Logos for Giant, Dunkin', Subway, Hair cuttery, and GameStop are displayed in a vertical list.

SITE PLAN

Ryan Minnehan
rminnehan@klnb.com
443-632-2088

Mason Bernstein
mbernstein@klnb.com
443-632-2089

Alex Shearer
ashearer@klnb.com
443-632-2081

100 West Road, Suite 505
Towson, MD 21204
klnb.com

8825 CENTRE PARK DRIVE

8825 Centre Park Drive, Columbia, MD 21045
Howard County



MARKET AERIAL

Ryan Minnehan
rminnehan@klnb.com
443-632-2088

Mason Bernstein
mbernstein@klnb.com
443-632-2089

Alex Shearer
ashearer@klnb.com
443-632-2081

100 West Road, Suite 505
Towson, MD 21204
klnb.com

8825 CENTRE PARK DRIVE

8825 Centre Park Drive, Columbia, MD 21045
Howard County

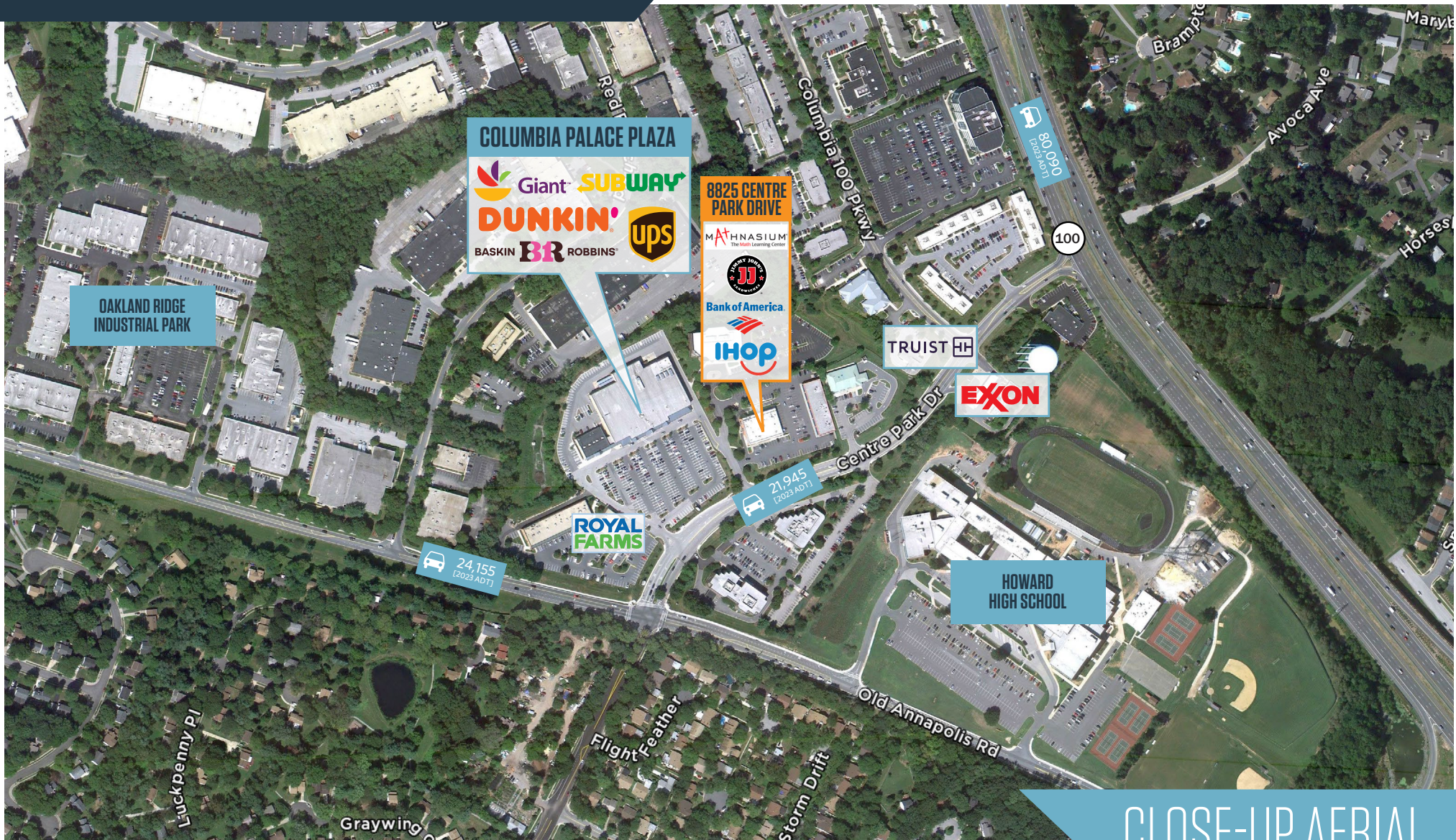

CLOSE-UP AERIAL

Ryan Minnehan
rminnehan@klnb.com
443-632-2088

Mason Bernstein
mbernstein@klnb.com
443-632-2089

Alex Shearer
ashearer@klnb.com
443-632-2081

100 West Road, Suite 505
Towson, MD 21204
klnb.com

klnb

8825 CENTRE PARK DRIVE

8825 Centre Park Drive, Columbia, MD 21045
Howard County

CLICK TO VIEW PROPERTY WEBSITE

For More Information, Please Contact:

Ryan Minnehan

rminnehan@klNb.com

443-632-2088

Mason Bernstein

mbernstein@klNb.com

443-632-2089

Alex Shearer

ashearer@klNb.com

443-632-2081

100 West Road, Suite 505
Towson, MD 21204

klNb.com



[instagram.com/klNbcre](https://www.instagram.com/klNbcre)



[linkedin.com/company/klNb](https://www.linkedin.com/company/klNb)



[facebook.com/KLNBCRE](https://www.facebook.com/KLNBCRE)

While we have no reason to doubt the accuracy of any of the information supplied, we cannot, and do not, guarantee its accuracy. All information should be independently verified prior to a purchase or lease of the property. We are not responsible for errors, omissions, misuse, or misinterpretation of information contained herein and make no warranty of any kind, express or implied, with respect to the property or any other matters.