

AVAILABILITY

- Warehousing
 - Suite 7380 - Available 5/1/25
 - 37,500 SF
 - \$17.00/Sf NNN
 - Clear Height: 24-32 FT
 - Dock and Drive-In loading available
- Outdoor Storage
 - Lot 1 - 54,895 SF
 - Lot 2 - 62,618 SF

} \$4.00 PSF NNN

PROPERTY HIGHLIGHTS

- Zoned M-1 - Heavy Industrial
- Great location off I-66, on the corner of Route 50 and Route 29
- Uses include but not limited to:
 - Warehousing
 - Assembly and Production
 - Distribution
 - Research and Development
 - Manufacturing

RYAN GOELLER
 rgoeller@klnb.com
 703-268-2731

TYLER CUMBERLAND
 tcumberland@klnb.com
 703-268-2720

CHASE STEWART
 cstewart@klnb.com
 703-268-2732

JEFF TARAE
 jtarae@klnb.com
 703-268-2741

SITE PLAN

GAINESVILLE BUSINESS PARK

14235 JOHN MARSHALL HWY, GAINESVILLE, VA 20155, PRINCE WILLIAM COUNTY

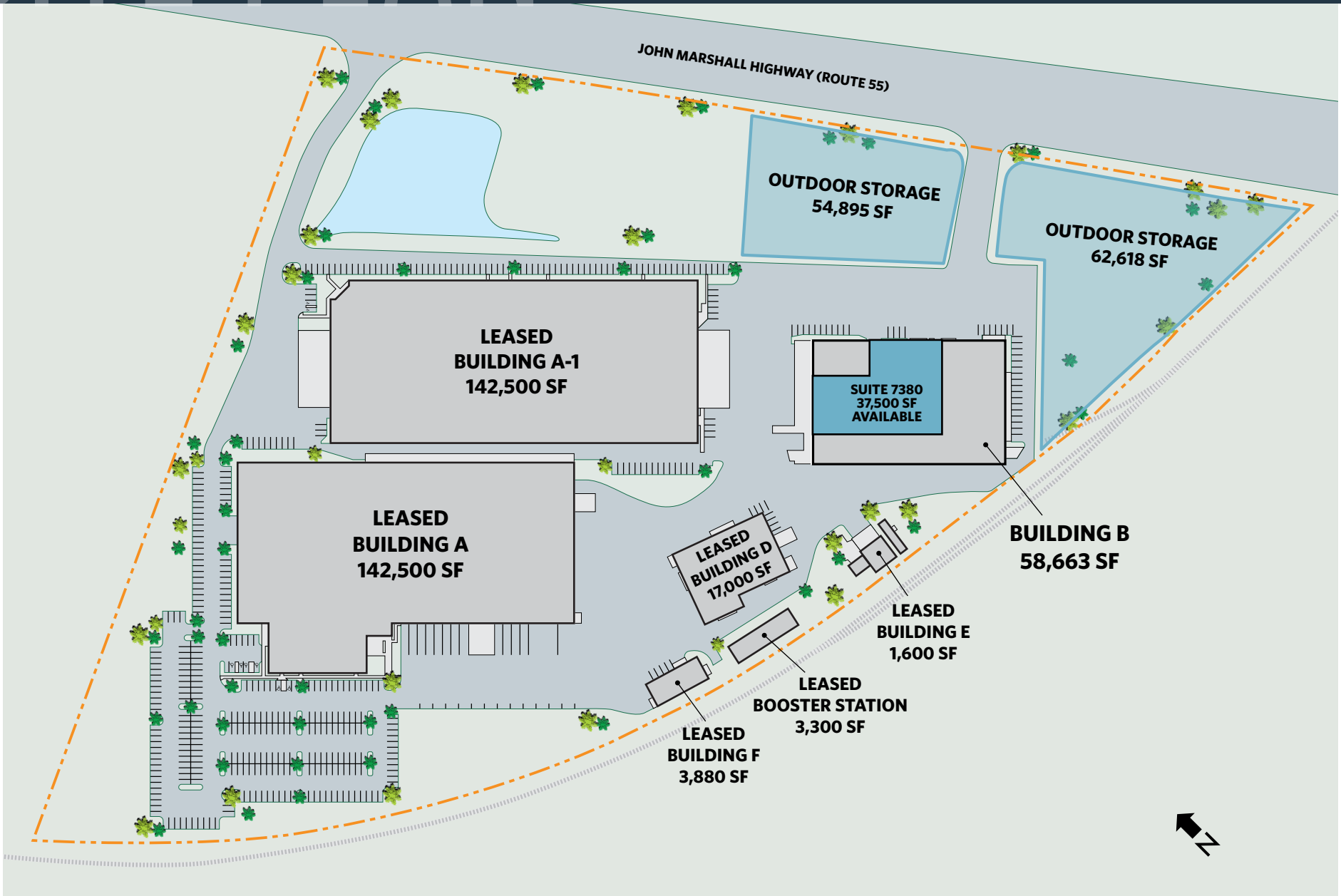

RYAN GOELLER
rgoeller@klnb.com
703-268-2731

TYLER CUMBERLAND
tcumberland@klnb.com
703-268-2720

CHASE STEWART
cstewart@klnb.com
703-268-2732

JEFF TARAE
jtarae@klnb.com
703-268-2741



AERIAL

GAINESVILLE BUSINESS PARK

14235 JOHN MARSHALL HWY, GAINESVILLE, VA 20155, PRINCE WILLIAM COUNTY



RYAN GOELLER
rgoeller@klnb.com
703-268-2731

TYLER CUMBERLAND
tcumberland@klnb.com
703-268-2720

CHASE STEWART
cstewart@klnb.com
703-268-2732

JEFF TARAE
jtarae@klnb.com
703-268-2741



FOR MORE INFORMATION, PLEASE CONTACT:

RYAN GOELLER

rgoeller@klnb.com
703-268-2731

TYLER CUMBERLAND

tcumberland@klnb.com
703-268-2720

CHASE STEWART

cstewart@klnb.com
703-268-2732

JEFF TARAE

jtarae@klnb.com
703-268-2741

8065 Leesburg Pike, Suite 700, Tysons, VA 22182

.....
klnb.com



[instagram.com/klnbcre](https://www.instagram.com/klnbcre)



[linkedin.com/company/klnb](https://www.linkedin.com/company/klnb)



[facebook.com/KLNBCRE](https://www.facebook.com/KLNBCRE)

CLICK TO VIEW PROPERTY WEBSITE