



HILL EAST WATERFRONT - PARK KENNEDY

1900 MASSACHUSETTS AVENUE, SE | AKA 1901 C STREET, SE, WASHINGTON, DC 20003

2 BLOCKS FROM
NEW RFK STADIUM
DEVELOPMENT

DUFFY'S IRISH PUB

SALA THAI

LAST SPACE AVAILABLE
3,072 SF

266 NEW
RESIDENTIAL UNITS

PARKKENNEDY.COM

Alpha-Bet-A



STADIUM-ARMORY
1,760 PPD



19TH STREET - 5,100 ADT

MASSACHUSETTS AVE - 5,300 ADT

MATT SKALET

mkalet@klnb.com | 202-420-7775

STEVE COMBS

scombs@klnb.com | 202-420-7776

klnb.com



DEMOGRAPHICS | 2025:

10 MIN WALK	0.25-MILE	0.5-MILE	1-MILE
Population			
5,236	3,259	6,843	34,522
Daytime Population			
2,347	988	3,410	25,759
Average HH Income			
\$210,711	\$227,681	\$211,323	\$175,072
Median HH Income			
\$150,090	\$165,526	\$146,967	\$114,870

METRO RIDERSHIP | 2025:



RETAIL SPACE AVAILABLE

- Hill East Waterfront is a 60 plus acre multi-phased mixed use development.
- Park Kennedy is 266 unit apartment building which is over 95% occupied.
- Last Retail space available is 3,072 SF on Prime Corner.
- Can be vented for restaurant use and has huge outdoor seating area.
- Adjacent to Stadium/Armory Metro with approximately 1,760 riders per day.
- Easily accessible from I-295, Independence Avenue and East Capitol Street.

SITE PLAN

HILL EAST WATERFRONT - PARK KENNEDY

1900 MASSACHUSETTS AVENUE, SE | AKA 1901 C STREET, SE, WASHINGTON, DC 20003

PHASE 1
NOW AVAILABLE

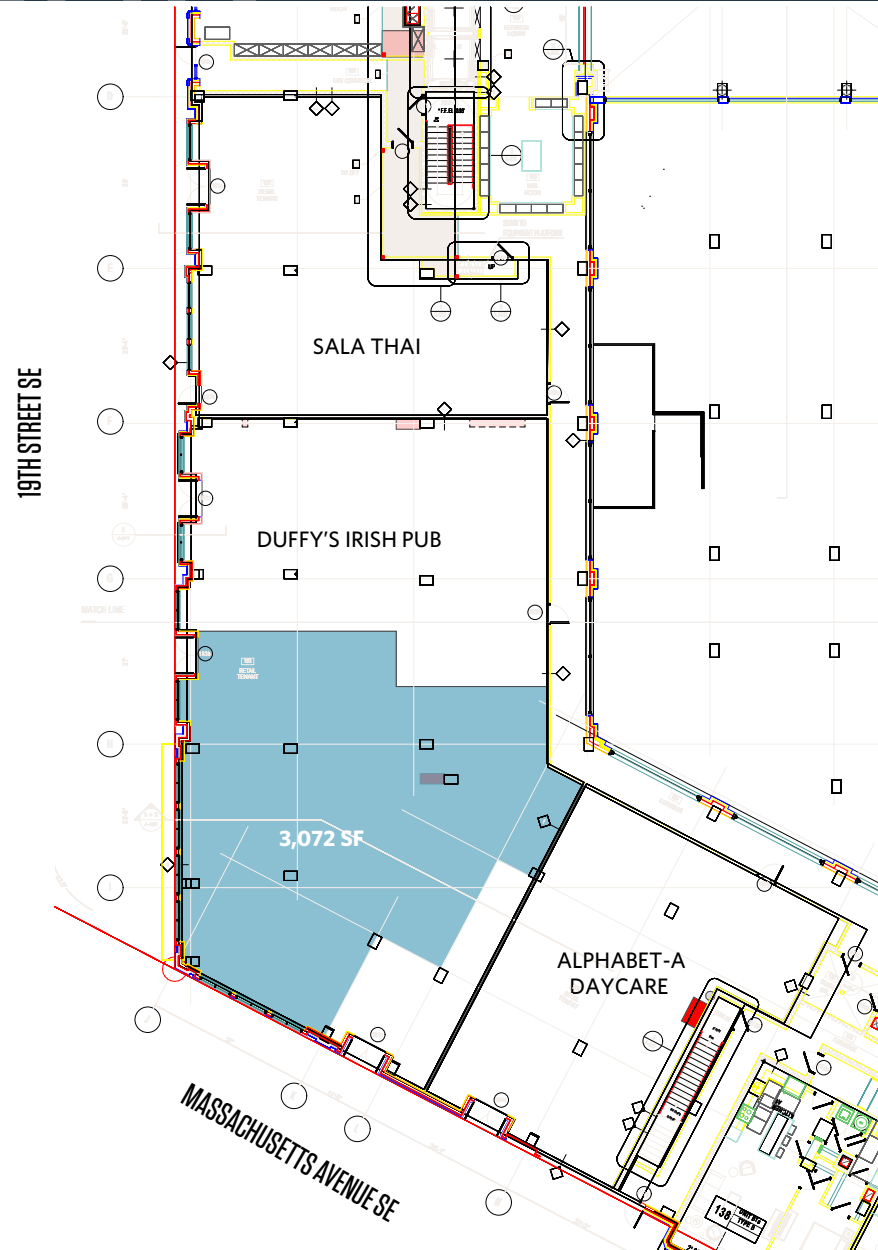

STADIUM-ARMORY
1,760 PPD

MATT SKALET

m skalet@klnb.com | 202-420-7775

STEVE COMBS

scombs@klnb.com | 202-420-7776

klnb

AERIAL

HILL EAST WATERFRONT - PARK KENNEDY

1900 MASSACHUSETTS AVENUE, SE | AKA 1901 C STREET, SE, WASHINGTON, DC 20003

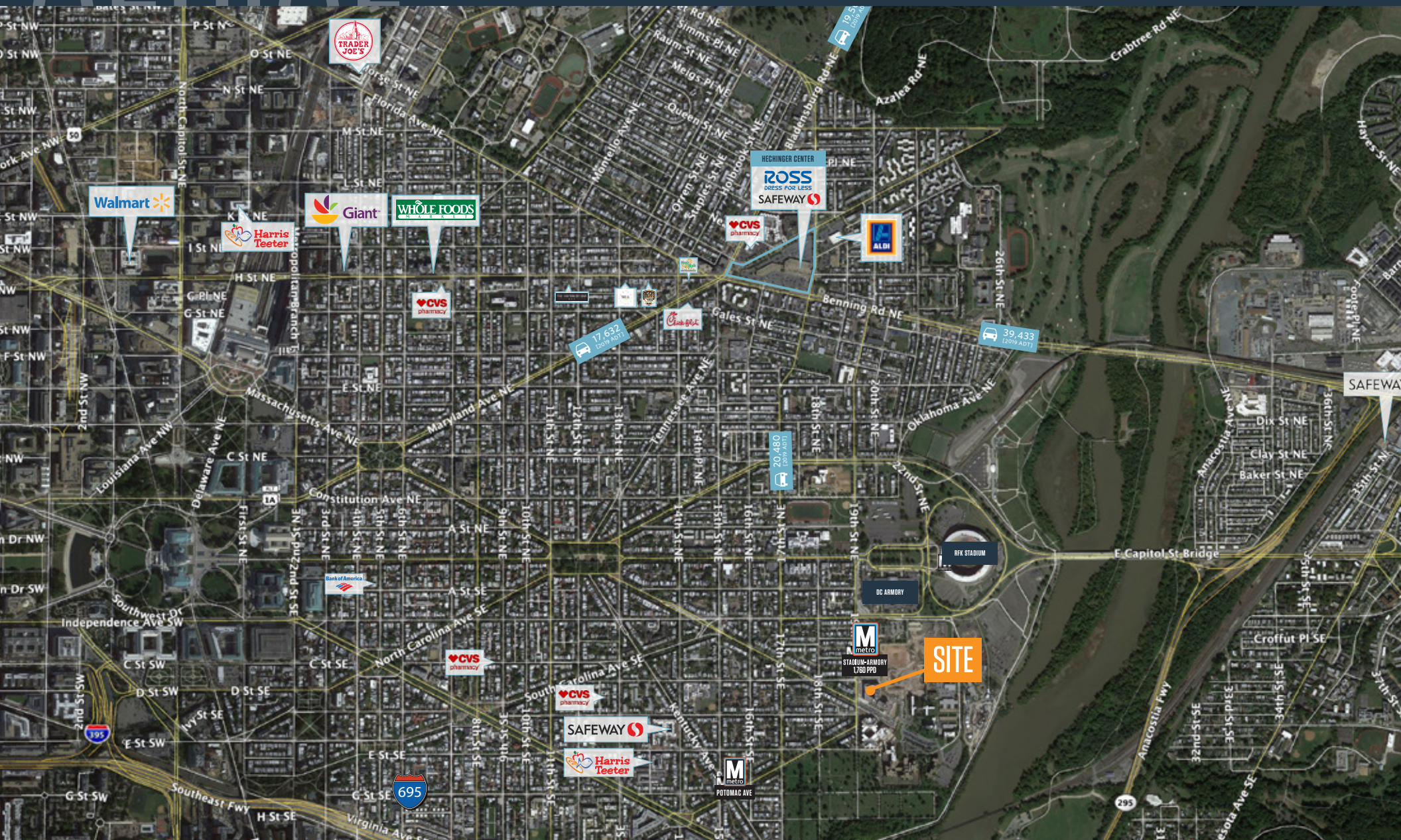

MATT SKALET

mkalet@klnb.com | 202-420-7775

STEVE COMBS

scombs@klnb.com | 202-420-7776

klnb

AERIAL

HILL EAST WATERFRONT - PARK KENNEDY

1900 MASSACHUSETTS AVENUE, SE | AKA 1901 C STREET, SE, WASHINGTON, DC 20003



MATT SKALET
mskalet@klnb.com | 202-420-7775

STEVE COMBS
scombs@klnb.com | 202-420-7776



DEVELOPMENT PLAN

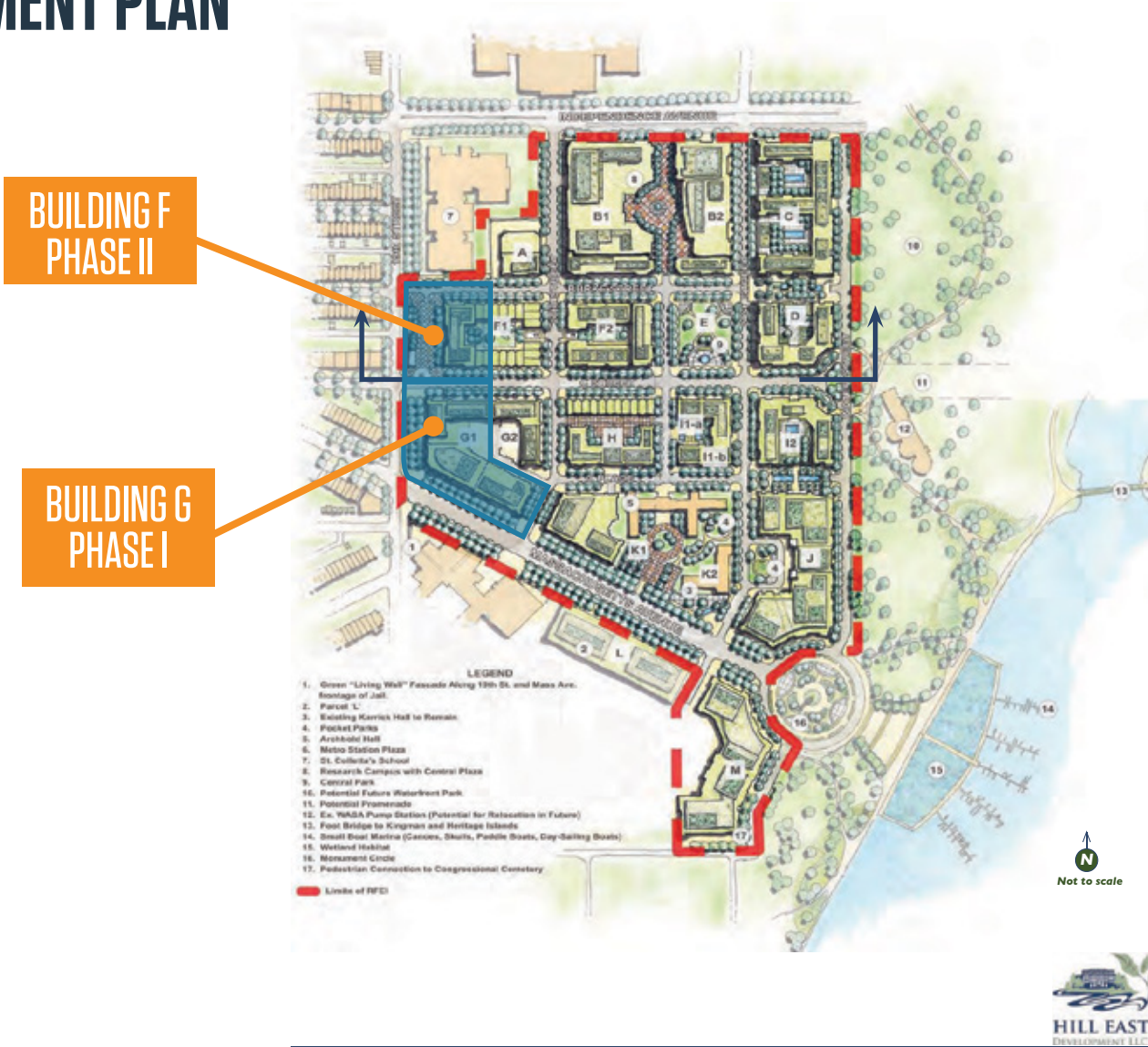

HillEast Waterfront Redevelopment

RENDERINGS

HILL EAST WATERFRONT - PARK KENNEDY

1900 MASSACHUSETTS AVENUE, SE | AKA 1901 C STREET, SE, WASHINGTON, DC 20003



MATT SKALET
mskalet@klnb.com | 202-420-7775

STEVE COMBS
scombs@klnb.com | 202-420-7776



RENDERINGS

HILL EAST WATERFRONT - PARK KENNEDY

1900 MASSACHUSETTS AVENUE, SE | AKA 1901 C STREET, SE, WASHINGTON, DC 20003



MATT SKALET

mkalet@klnb.com | 202-420-7775

STEVE COMBS

scombs@klnb.com | 202-420-7776





HILL EAST WATERFRONT - PARK KENNEDY

1900 MASSACHUSETTS AVENUE, SE | AKA 1901 C STREET, SE , WASHINGTON, DC 20003

FOR MORE INFORMATION, PLEASE CONTACT:

MATT SKALET

mksalet@klnb.com | 202-420-7775

STEVE COMBS

scombs@klnb.com | 202-420-7776

1130 Connecticut Ave, NW, Suite 600, Washington, DC 20036

.....

klnb.com



[CLICK TO VIEW PROPERTY WEBSITE](#)

While we have no reason to doubt the accuracy of any of the information supplied, we cannot, and do not, guarantee its accuracy. All information should be independently verified prior to a purchase or lease of the property. We are not responsible for errors, omissions, misuse, or misinterpretation of information contained herein and make no warranty of any kind, express or implied, with respect to the property or any other matters.