

NOW OPEN!

Goodwill
Greater Washington

1,170 SF
2ND GEN RESTAURANT
LEASED

1,171 SF
2ND GEN SALON

HECHT

1401

IDEAL FOR:

- NAIL SALON, HAIR SALON, BARBER
- SMALL RESTAURANT OR CAFÉ-OUTDOOR SEATING AVAILABLE
- SERVICE USER

JOIN:



target planet fitness petco MOM's Organic Market
BEAT THE BOMB

**600+ PARKING SPACES
DEDICATED FOR RETAIL**

VICTOR SALCIDO
vsalcido@klnb.com | 240-755-2704

JOE FLEISCHMANN
joef@klnb.com | 703-268-2708

MICHAEL PRATT
mpratt@klnb.com | 202-420-7765

PHOTOS

2ND GEN OPPORTUNITIES AT IVY CITY

2004 HECHT AVE NE, WASHINGTON, DC 20002

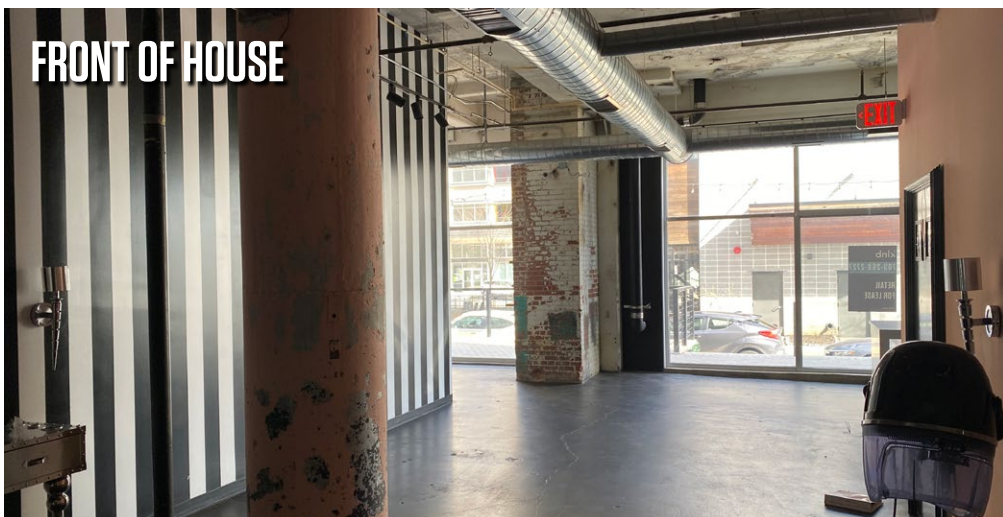

VICTOR SALCIDO

vsalcido@klnb.com | 240-755-2704

JOE FLEISCHMANN

joef@klnb.com | 703-268-2708

MICHAEL PRATT

mpratt@klnb.com | 202-420-7765

klnb

SITE PLAN

2ND GEN OPPORTUNITIES AT IVY CITY

2004 HECHT AVE NE, WASHINGTON, DC 20002

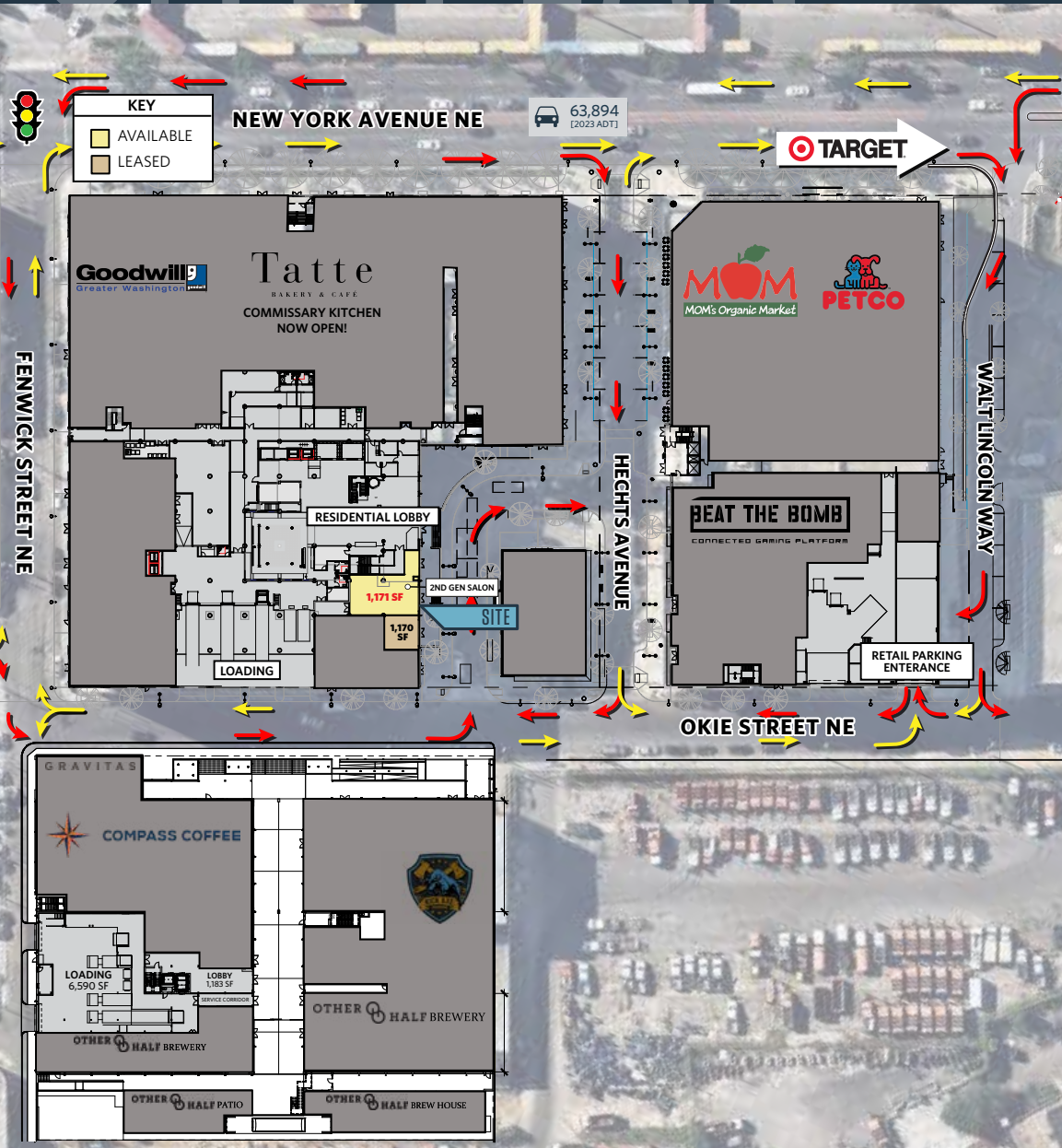

630 DEDICATED RETAIL PARKING SPACES (LEVELS P1-P4)

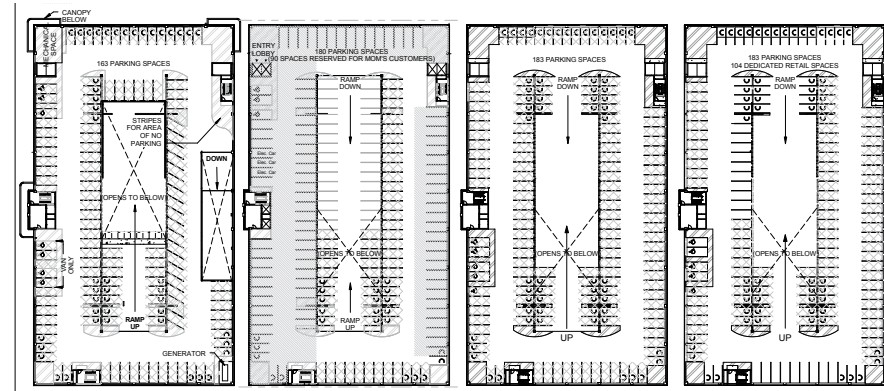

P-1: SECOND FLOOR PLAN

P-2: THIRD FLOOR PLAN

P-3: FOURTH FLOOR PLAN

P-4: FIFTH FLOOR PLAN

RESIDENTIAL UNITS



VICTOR SALCIDO

vsalcido@klnb.com | 240-755-2704

JOE FLEISCHMANN

joef@klnb.com | 703-268-2708

MICHAEL PRATT

mpratt@klnb.com | 202-420-7765



LOCATION

2ND GEN OPPORTUNITIES AT IVY CITY

2004 HECHT AVE NE, WASHINGTON, DC 20002

10 MINUTE DRIVE TIME TAPESTRY



LAPTOPS & LATTES

HOUSEHOLDS: 22,852 (21.1%)
MEDIAN AGE: 37.4



METRO RENTERS





HOUSEHOLDS: 20,323 (18.7%)
MEDIAN AGE: 32.5



TRENDSETTERS

HOUSEHOLDS: 13,391 (12.3%)
MEDIAN AGE: 36.3

10 MIN DRIVE 10 MIN WALK

	10 MIN DRIVE	10 MIN WALK
 POPULATION	157,142	2,919
 DAYTIME POPULATION	114,114	2,098
 AVG HH INCOME	\$157,031	\$98,240
 EDUCATION	36.6%	31.3%
 HOUSEHOLDS	72,951	1,291

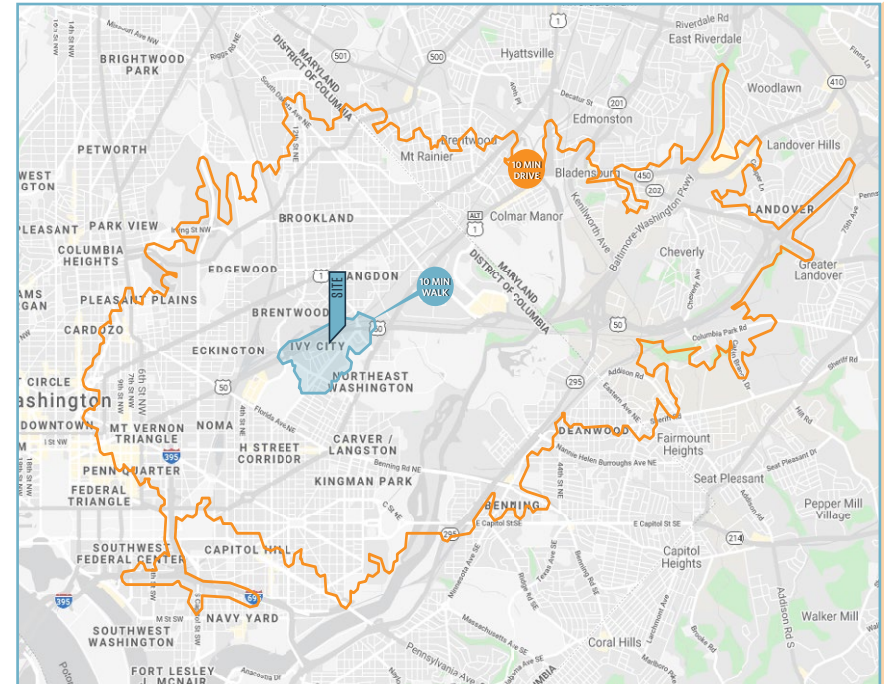

TRAFFIC COUNTS

NEW YORK AVE.....63,894 ADT

VICTOR SALCIDO

vsalcido@klnb.com | 240-755-2704

JOE FLEISCHMANN

joef@klnb.com | 703-268-2708

MICHAEL PRATT

mpratt@klnb.com | 202-420-7765





2ND GEN OPPORTUNITIES AT IVY CITY

2004 HECHT AVE NE, WASHINGTON, DC 20002



FOR MORE INFORMATION, PLEASE CONTACT:

VICTOR SALCIDO	JOE FLEISCHMANN	MICHAEL PRATT
vsalcido@klnb.com	joef@klnb.com	mpratt@klnb.com
240-755-2704	703-268-2708	202-420-7765

[CLICK TO VIEW PROPERTY WEBSITE](#)

While we have no reason to doubt the accuracy of any of the information supplied, we cannot, and do not, guarantee its accuracy. All information should be independently verified prior to a purchase or lease of the property. We are not responsible for errors, omissions, misuse, or misinterpretation of information contained herein and make no warranty of any kind, express or implied, with respect to the property or any other matters.