



RETAIL FOR LEASE

- Pad B-1.03 AC for lease off Annapolis Rd in Jessup, MD
- Located just a few hundred feet from on-ramp/off-ramp of MD-295
- Zoning: C-4
- Ideal for fast food, automotive, bank, and convenience oriented retailer

JOE MEKULSKI
 jmekulski@klnb.com | 443-632-1343

PATRICK MILLER
 pmiller@klnb.com | 443-632-2042

LOCATION

2760 ANNAPOLIS ROAD

JESSUP, MD 20794, HOWARD COUNTY

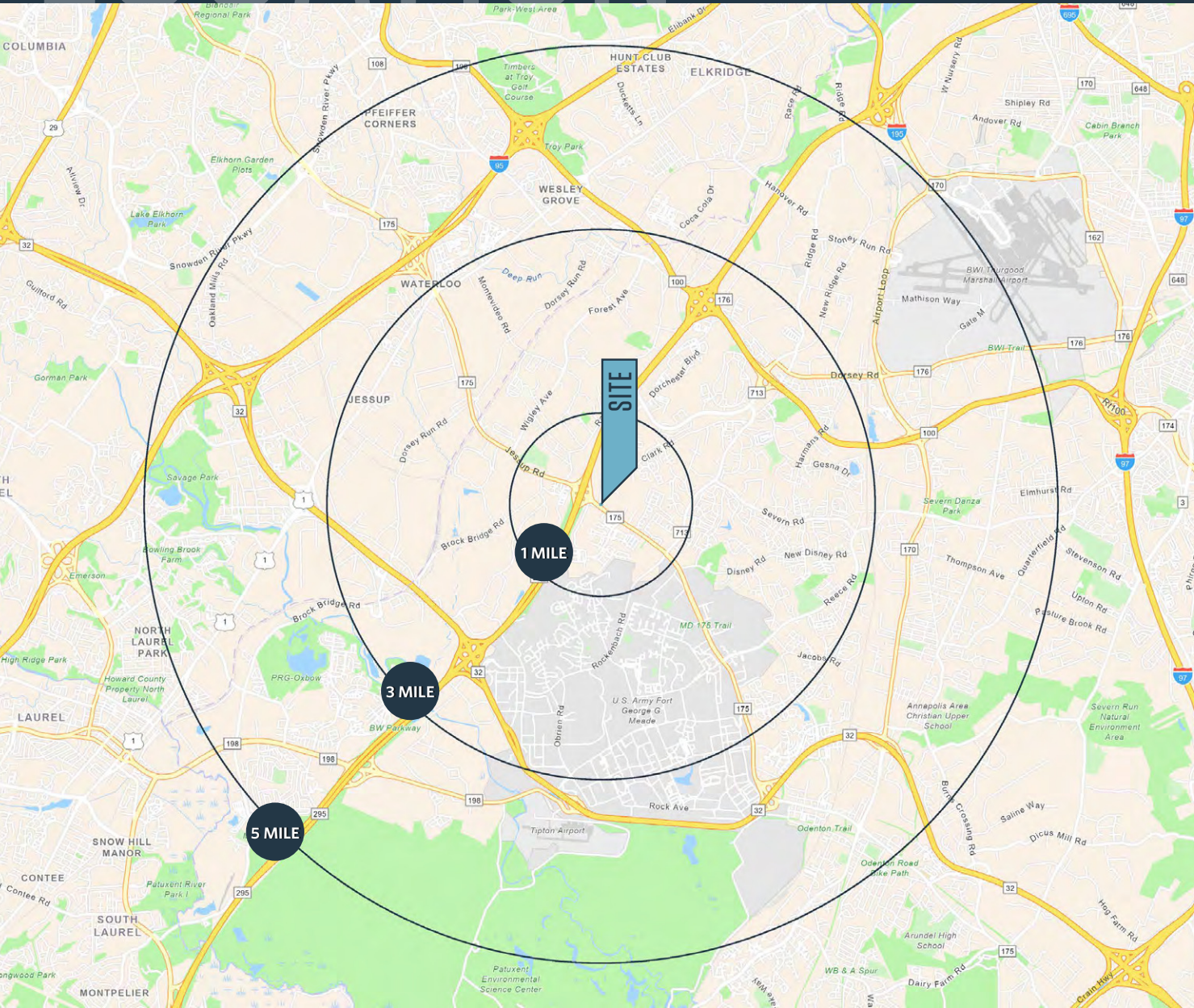

DEMOGRAPHICS | 2025:

1-MILE	3-MILE	5-MILE
Population		
9,561	61,859	176,501
Daytime Population		
6,350	83,849	207,187
Households		
3,874	20,947	63,580
Average HH Income		
\$164,556	\$148,450	\$148,819

[CLICK TO DOWNLOAD DEMOGRAPHIC REPORT](#)

TRAFFIC COUNTS | 2024:

Baltimore-Washington Pkwy	96,500 ADT
Annapolis Road	36,725 ADT

JOE MEKULSKI

jmekulski@klnb.com | 443-632-1343

PATRICK MILLER

pmiller@klnb.com | 443-632-2042



MARKET

2760 ANNAPOLIS ROAD

JESSUP, MD 20794, HOWARD COUNTY

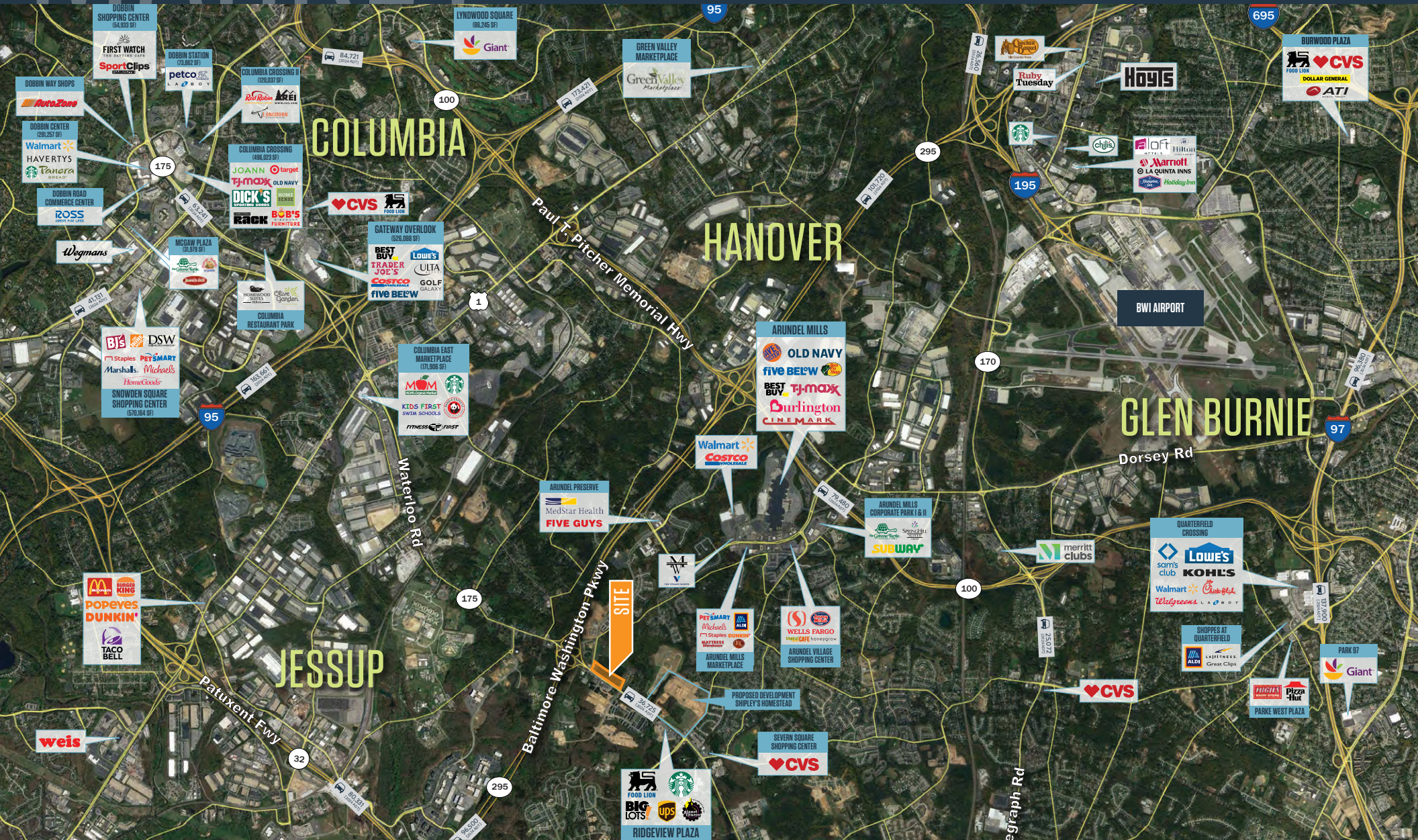

JOE MEKULSKI
jmekulski@klnb.com | 443-632-1343

PATRICK MILLER
pmiller@klnb.com | 443-632-2042



MIDVIEW

2760 ANNAPOLIS ROAD

JESSUP, MD 20794, HOWARD COUNTY

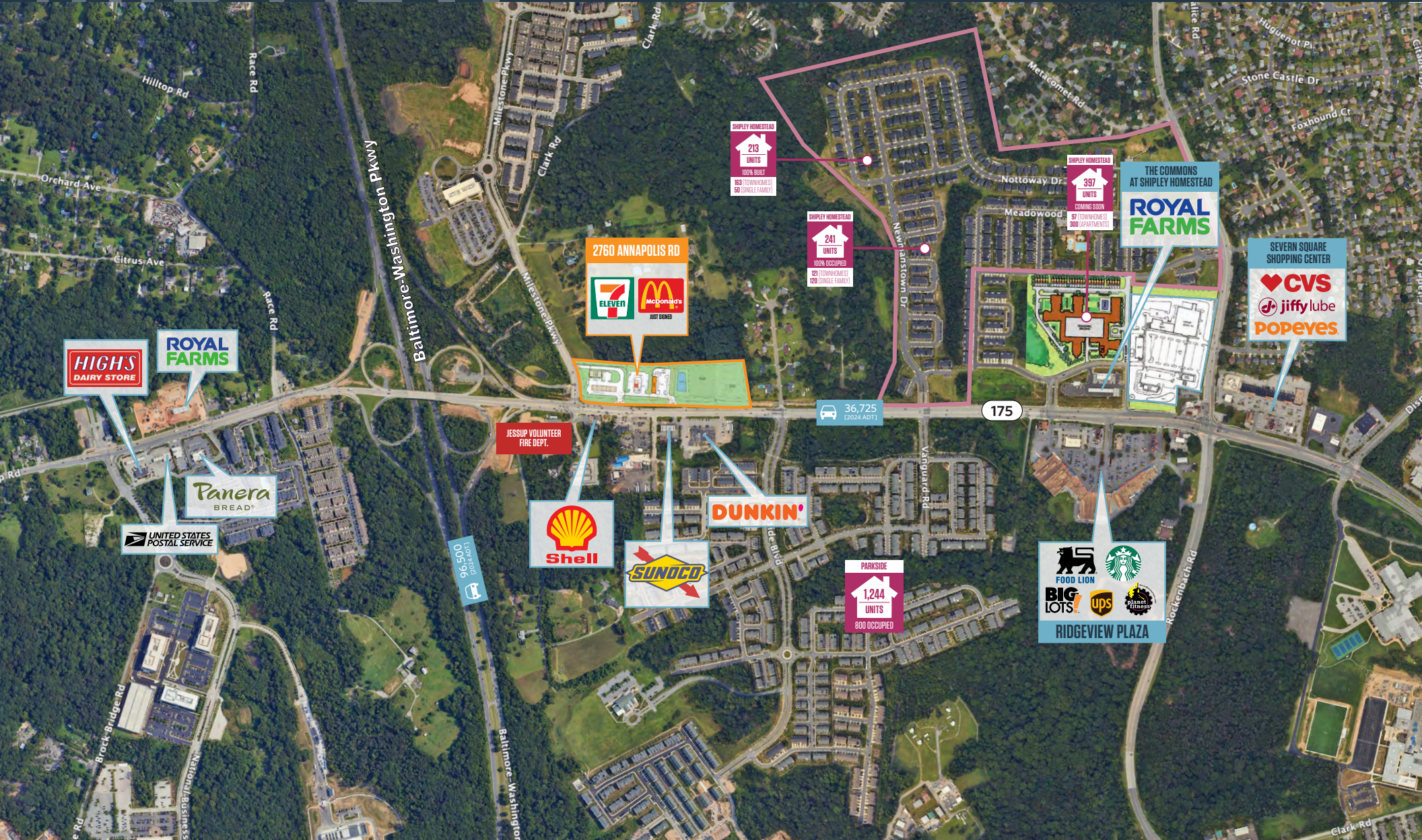

JOE MEKULSKI

jmekulski@klnb.com | 443-632-1343

PATRICK MILLER

pmiller@klnb.com | 443-632-2042



CLOSE-UP

2760 ANNAPOLIS ROAD

JESSUP, MD 20794, HOWARD COUNTY



JOE MEKULSKI

jmekulski@klnb.com | 443-632-1343

PATRICK MILLER

pmiller@klnb.com | 443-632-2042



SITE PLAN

2760 ANNAPOLIS ROAD

JESSUP, MD 20794, HOWARD COUNTY

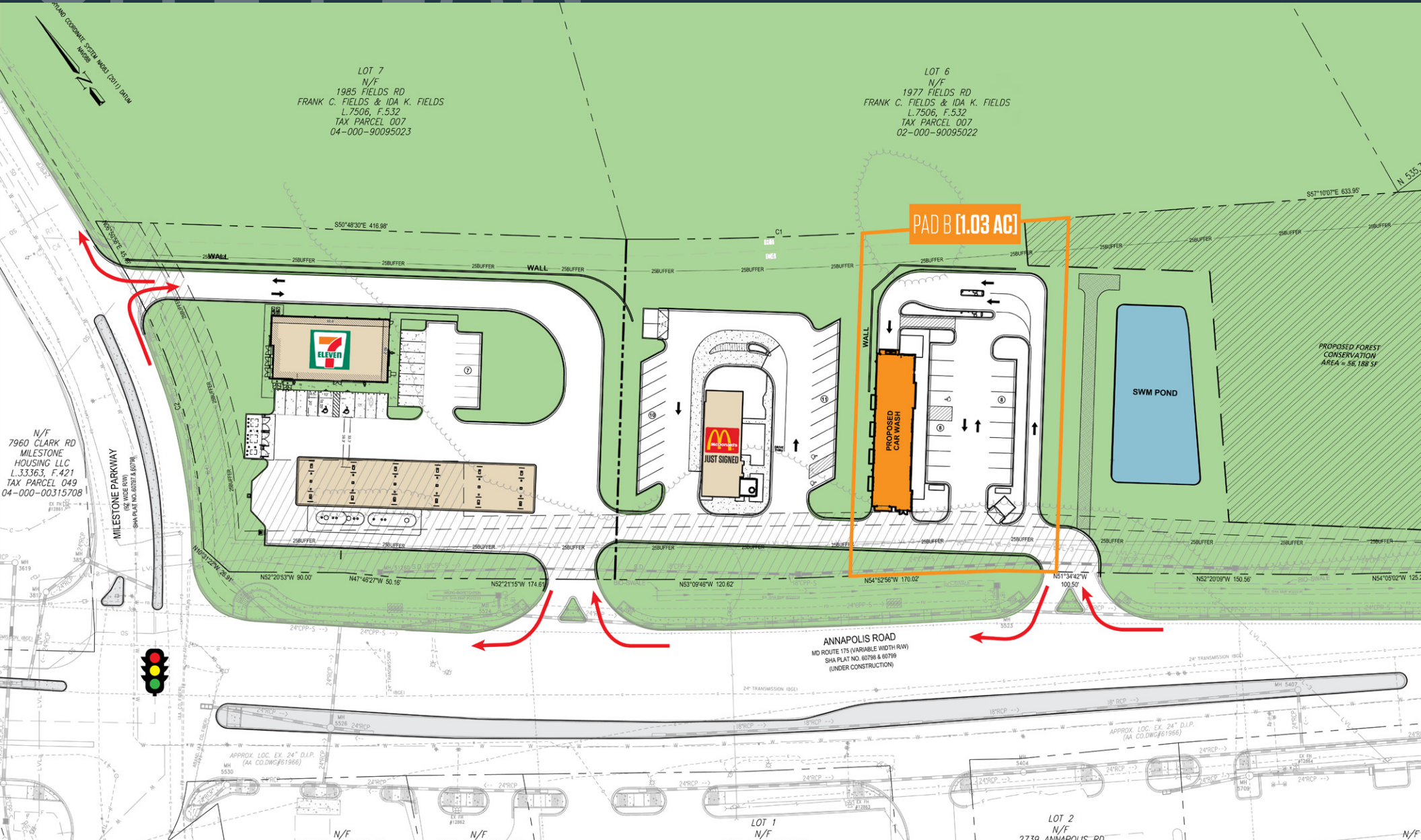

LOT 7
N/F
1985 FIELDS RD
FRANK C. FIELDS & IDA K. FIELDS
L.7506, F.532
TAX PARCEL 007
04-000-90095023

LOT 6
N/F
1977 FIELDS RD
FRANK C. FIELDS & IDA K. FIELDS
L.7506, F.532
TAX PARCEL 007
02-000-90095022

N/F
7960 CLARK RD
MILESTONE HOUSING LLC
L.33363, F.421
TAX PARCEL 049
04-000-00315708

JOE MEKULSKI
jmekulski@klnb.com | 443-632-1343

PATRICK MILLER
pmiller@klnb.com | 443-632-2042





2760 ANNAPOLIS ROAD

JESSUP, MD 20794, HOWARD COUNTY

FOR MORE INFORMATION, PLEASE CONTACT:

JOE MEKULSKI

jmekulski@klnb.com

443-632-1343

PATRICK MILLER

pmiller@klnb.com

443-632-2042

100 West Road, Suite 505, Towson, MD 21204

.....

klnb.com



[instagram.com/klnbcre](https://www.instagram.com/klnbcre)



[linkedin.com/company/klnb](https://www.linkedin.com/company/klnb)



[facebook.com/KLNBCRE](https://www.facebook.com/KLNBCRE)

[CLICK TO VIEW PROPERTY WEBSITE](#)

While we have no reason to doubt the accuracy of any of the information supplied, we cannot, and do not, guarantee its accuracy. All information should be independently verified prior to a purchase or lease of the property. We are not responsible for errors, omissions, misuse, or misinterpretation of information contained herein and make no warranty of any kind, express or implied, with respect to the property or any other matters.