

10939 PHILADELPHIA RD

10939 Philadelphia Road, White Marsh, MD 21162
Baltimore County



PROPERTY HIGHLIGHTS:

- **Unit 102:** 5,372 SF
- **Zoning:** ML
- **Sprinkler:** Wet
- **Heat:** Gas
- **Clear Height:** 20'
- **Construction:** Metal block and steel
- **Column Spacing:** Clear span

Christopher Wright
cwright@klnb.com
443-914-2600

Peter Dudley
pdudley@klnb.com
443-632-2064

100 West Road, Suite 505
Towson, MD 21204
klnb.com



10939 PHILADELPHIA RD

10939 Philadelphia Road, White Marsh, MD 21162
Baltimore County

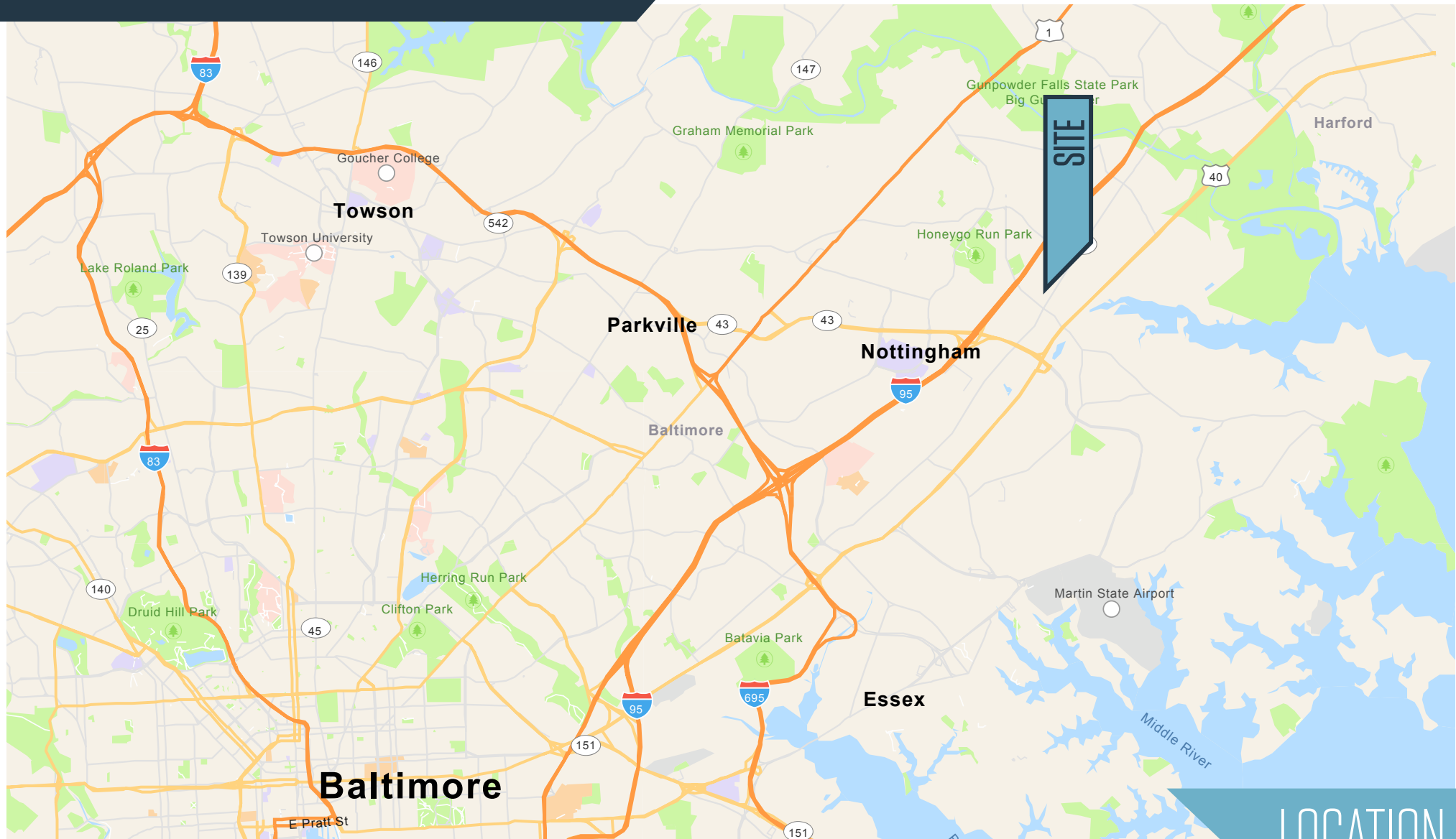

LOCATION

Christopher Wright
cwright@klnb.com
443-914-2600

Peter Dudley
pdudley@klnb.com
443-632-2064

100 West Road, Suite 505
Towson, MD 21204
klnb.com



10939 PHILADELPHIA RD

10939 Philadelphia Road, White Marsh, MD 21162
Baltimore County

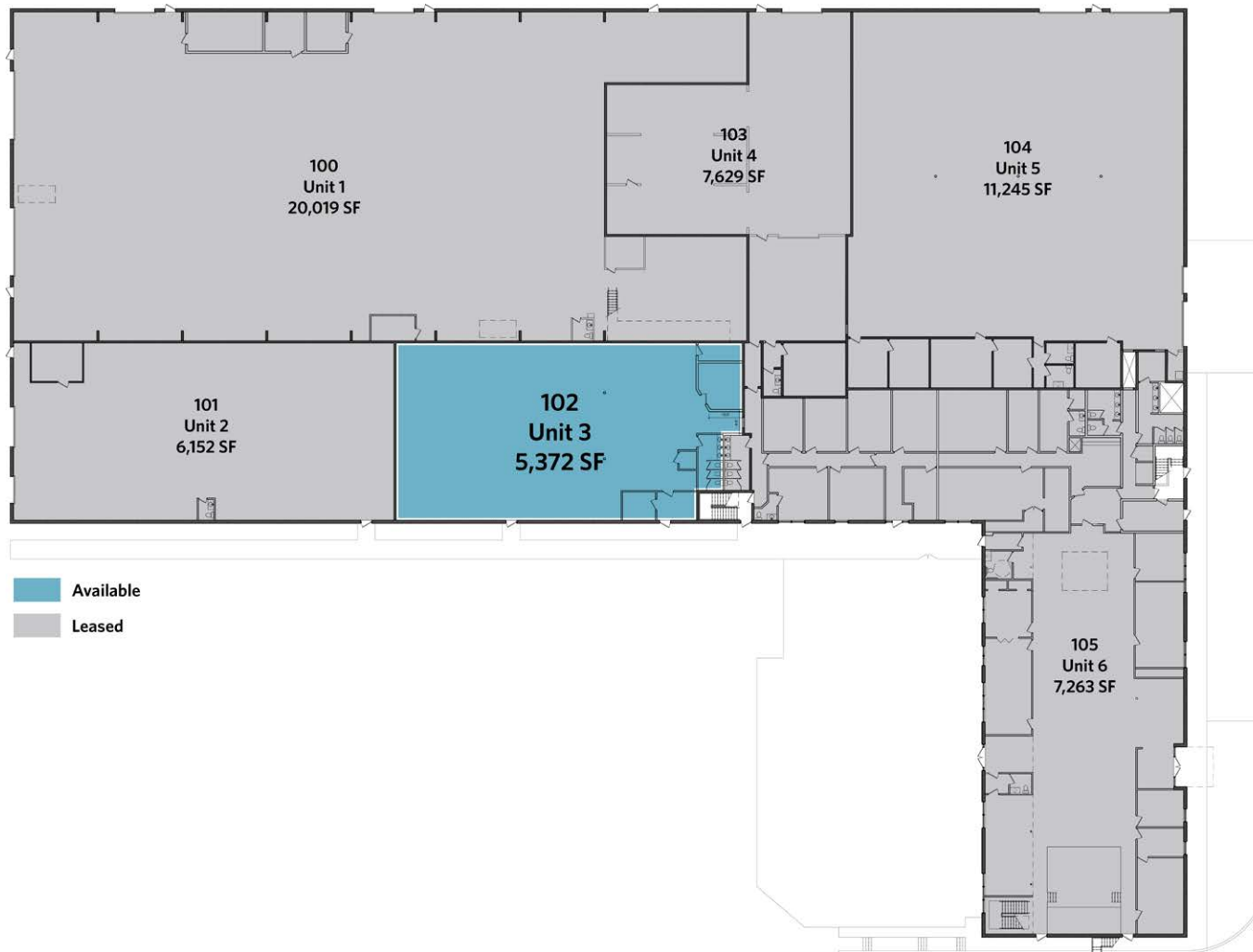

SPACE AVAILABLE

Christopher Wright
cwright@klnb.com
443-914-2600

Peter Dudley
pdudley@klnb.com
443-632-2064

100 West Road, Suite 505
Towson, MD 21204
klnb.com



10939 PHILADELPHIA RD

10939 Philadelphia Road, White Marsh, MD 21162
Baltimore County

CLICK TO VIEW PROPERTY WEBSITE

For More Information, Please Contact:

Christopher Wright

cwright@klnb.com

443-914-2600

Peter Dudley

pdudley@klnb.com

443-632-2064

100 West Road, Suite 505
Baltimore, MD 21204

klnb.com



facebook.com/KLNBCRE



linkedin.com/company/klnbcre



instagram.com/klnbcre

While we have no reason to doubt the accuracy of any of the information supplied, we cannot, and do not, guarantee its accuracy. All information should be independently verified prior to a purchase or lease of the property. We are not responsible for errors, omissions, misuse, or misinterpretation of information contained herein and make no warranty of any kind, express or implied, with respect to the property or any other matters.

NAI klnb