

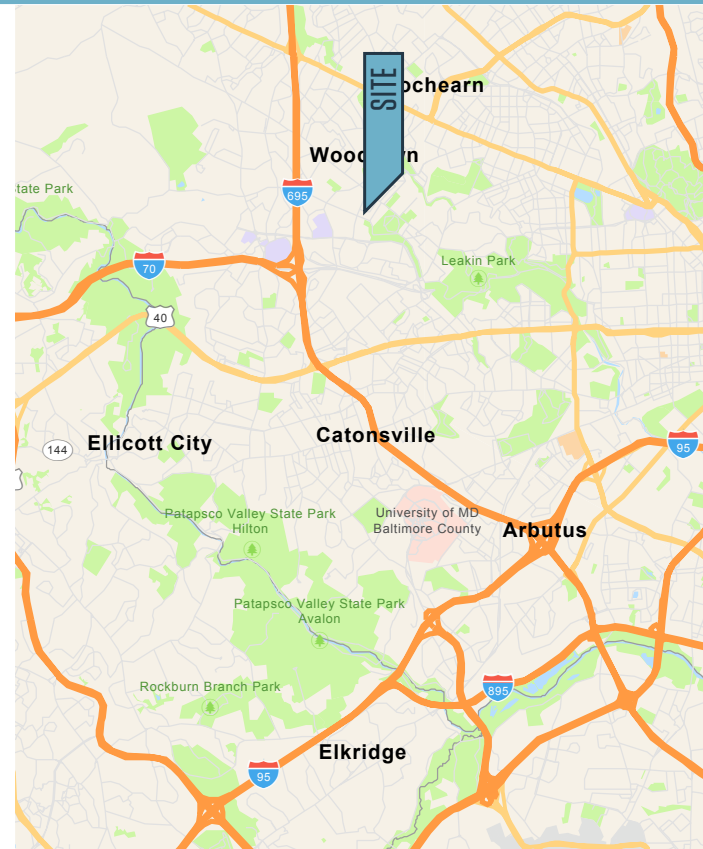

FOR LEASE

PROPERTY HIGHLIGHTS:

- Fully renovated, 41,746 SF two-story office building
- Rental Rate: \$11.95 PSF, NNN
- 5,578 SF available for lease
- Ample parking - 174 parking spaces
- Flexible ML zoning permits a wide variety of office, medical, and clinical uses
- Located near I-70 and I-695
- Close to food, shopping, banking, lodging & other amenities



1849 GWYNN OAK AVENUE

Woodlawn, MD 21207 | Baltimore County



PROPOSED PLAN: TOTAL VACANCY = 5,578 SF

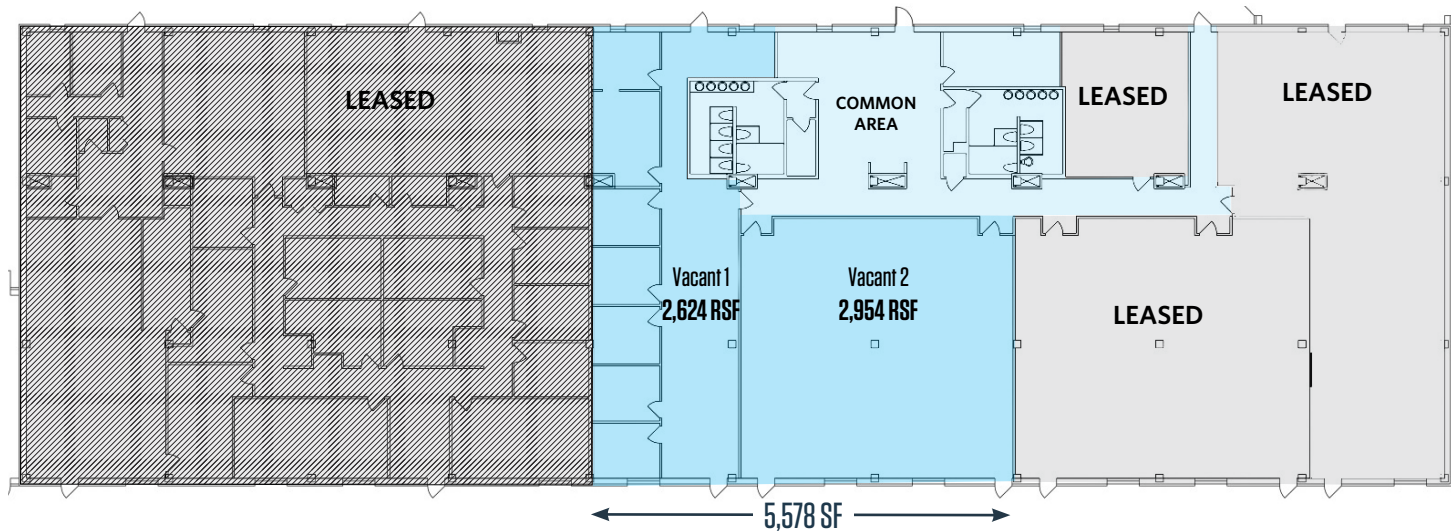

AERIAL VIEW



Austin Eber
aeber@klb.com
443-791-8280

While we have no reason to doubt the accuracy of any of the information supplied, we cannot, and do not, guarantee its accuracy. All information should be independently verified prior to a purchase or lease of the property. We are not responsible for errors, omissions, misuse, or misinterpretation of information contained herein and make no warranty of any kind, express or implied, with respect to the property or any other matters.