



**A WORLD-CLASS  
FACILITY** SERVING THE  
**PORT OF VIRGINIA**

**+** 2925 PRUDEN BOULEVARD, SUFFOLK, VA 23434



**RETAIL PADS  
AVAILABLE FOR LEASE**





# + RETAIL PADS FOR LEASE

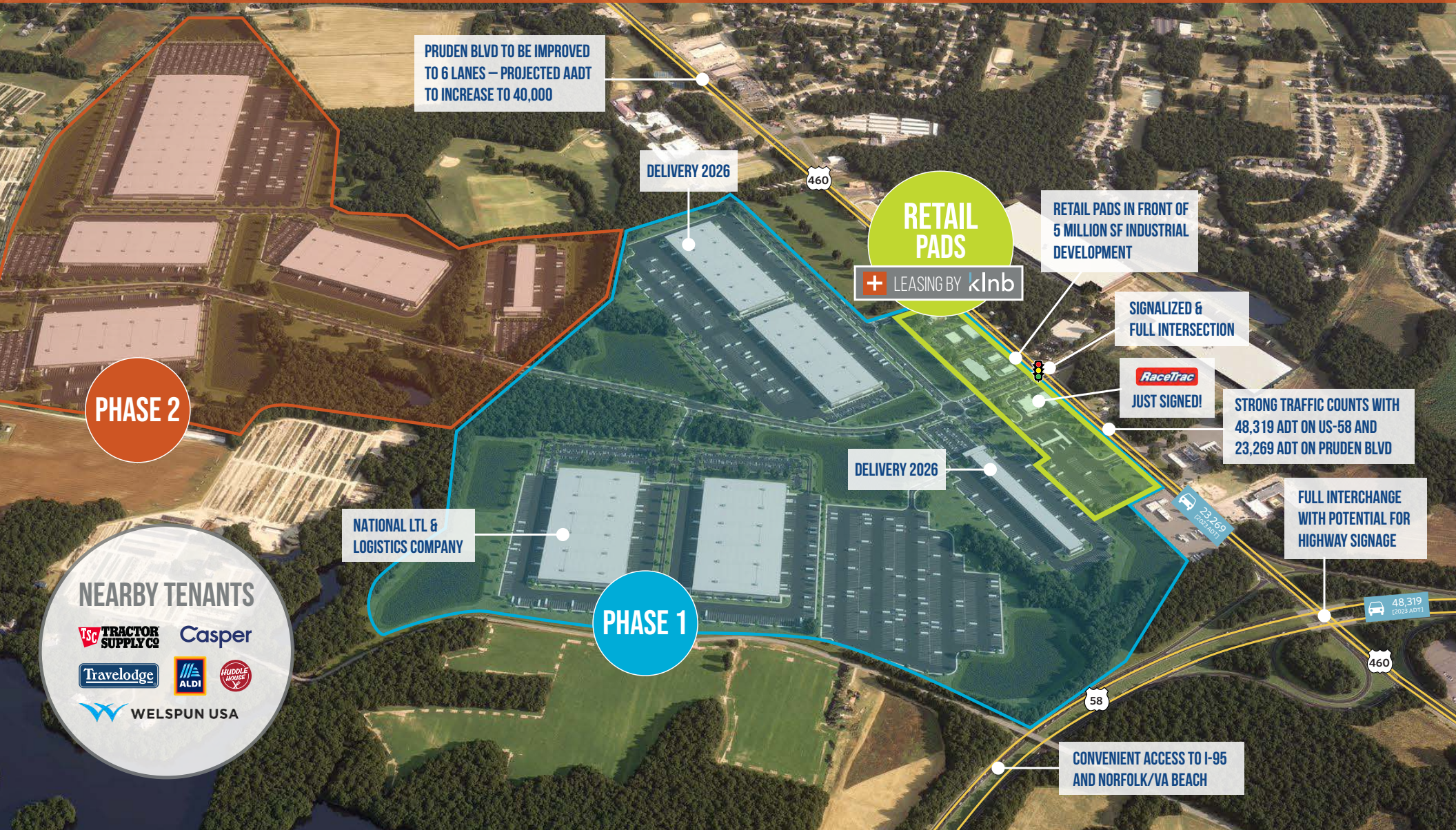

JOHN MEYER

BOB BROWNING

jmeyer@klnb.com + 443.632.2052

bbrowning@klnb.com + 703.268.2717





## CONNECTED TO THE MARKET



### TOTAL POPULATION

1-MILE	3-MILES	5-MILES
1,443	20,981	48,175



### DAYTIME POPULATION

1-MILE	3-MILES	5-MILES
1,509	22,165	45,870



### TOTAL HOUSEHOLDS

1-MILE	3-MILES	5-MILES
517	7,776	18,165



### AVERAGE HH INCOME

1-MILE	3-MILES	5-MILES
\$137,815	\$120,916	\$97,894

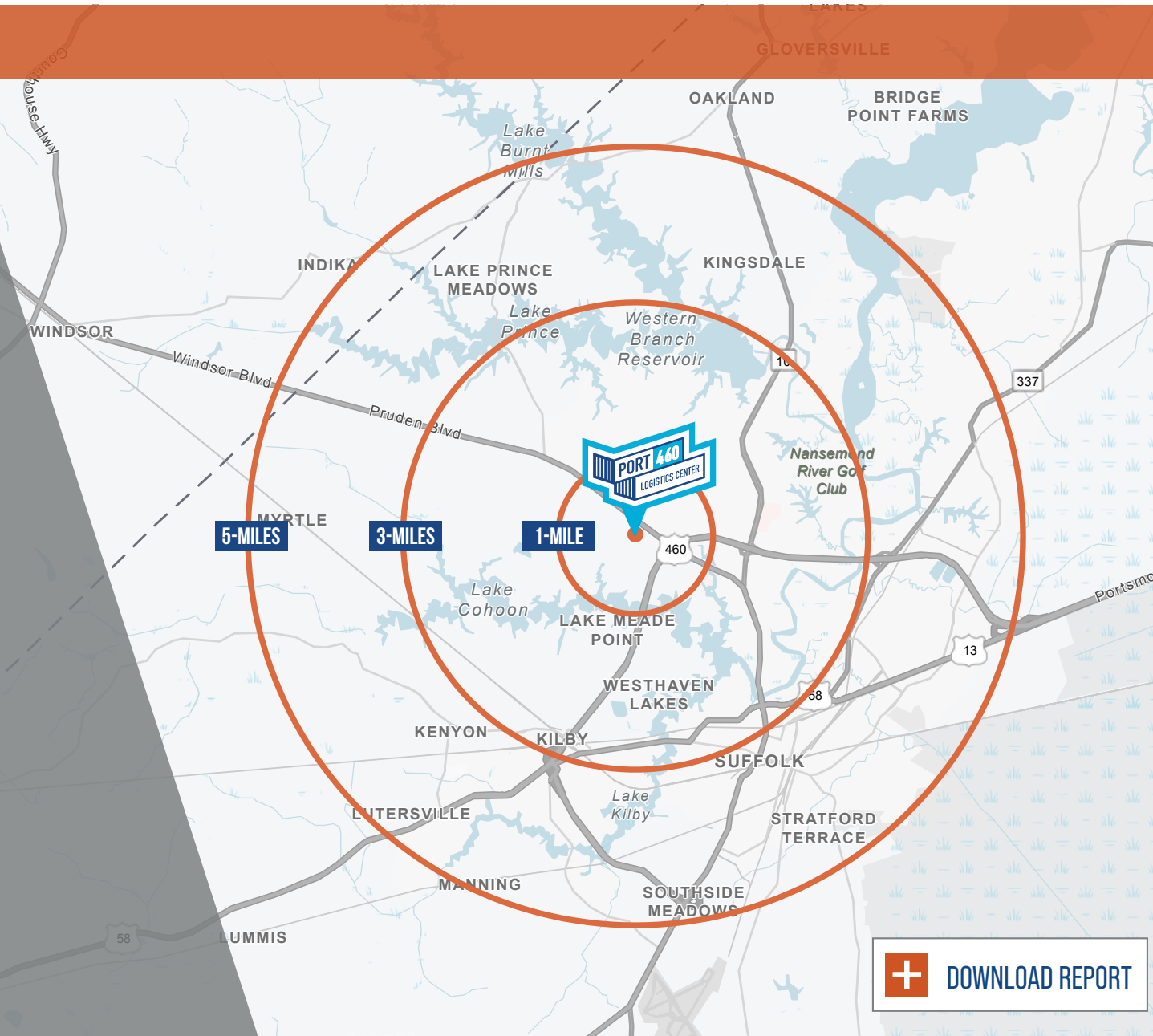

[+ DOWNLOAD REPORT](#)



# + PROPOSED RETAIL PLAN 1

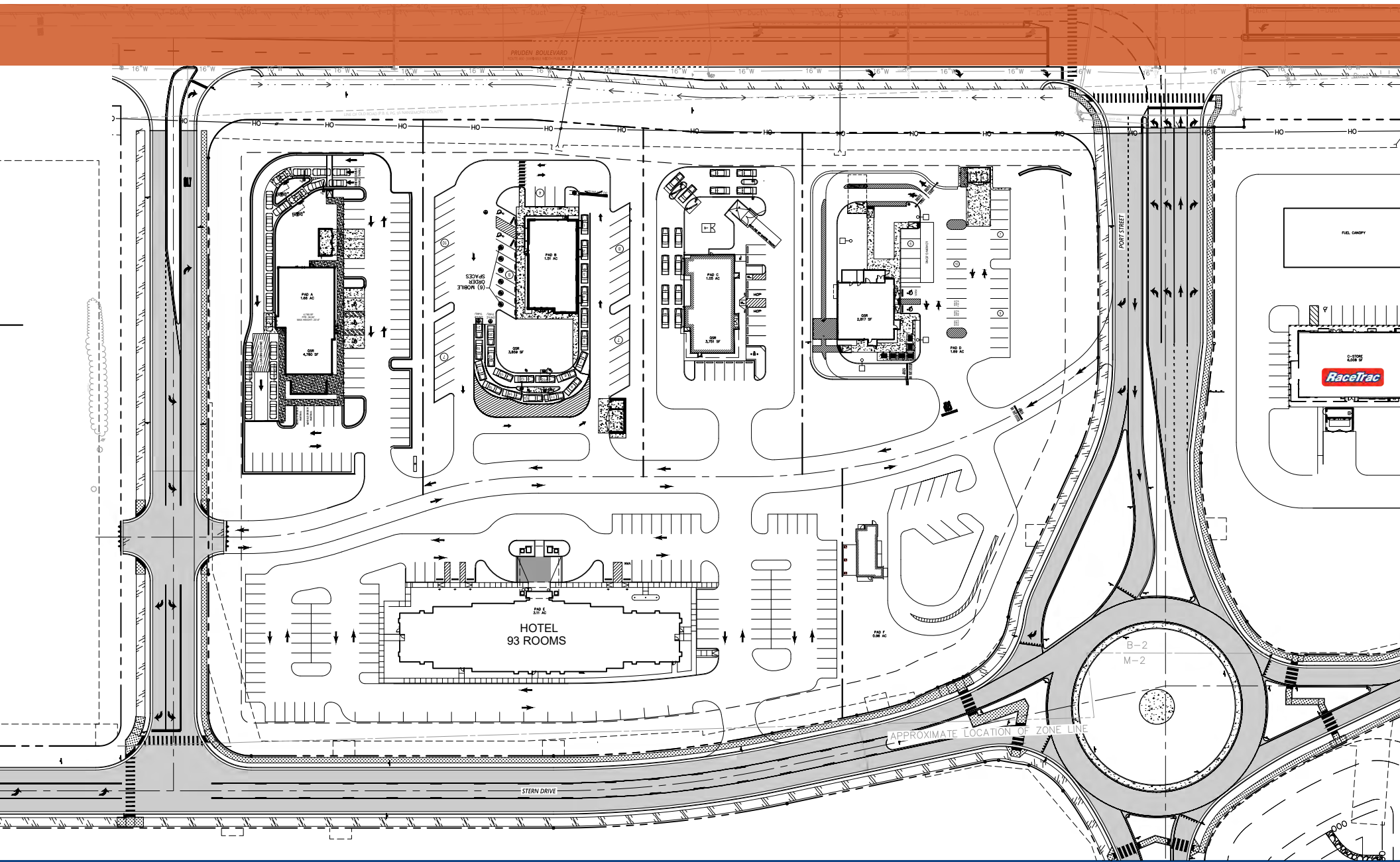



# + PROPOSED RETAIL PLAN 2

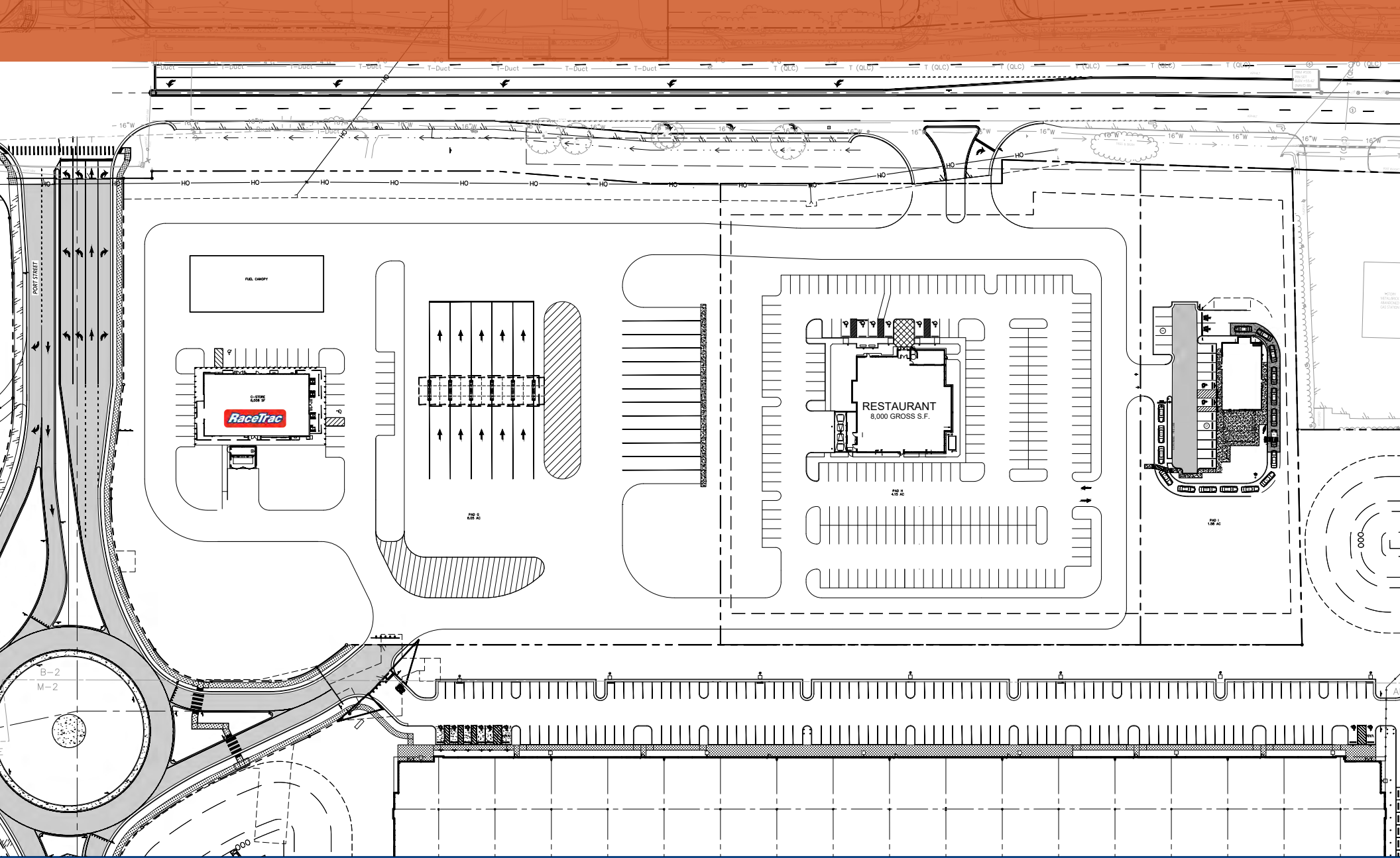

JOHN MEYER

[jmeyer@klhb.com](mailto:jmeyer@klhb.com) + 443.632.2052

BOB BROWNING

[bbrowning@klhb.com](mailto:bbrowning@klhb.com) + 703.268.2717







RETAIL		
PAD	SIZE	LEASING
A	4,780 SF	AVAILABLE
B	3,859 SF	AVAILABLE
C	3,751 SF	AVAILABLE
D	2,817 SF	AVAILABLE
G	6,006 SF	RACE TRAC
H	8,000 SF	AVAILABLE
I	1.5 AC	AVAILABLE





+ CLICK TO VIEW CONSTRUCTION UPDATE

JOHN MEYER

[jmeyer@klhb.com](mailto:jmeyer@klhb.com) + 443.632.2052

BOB BROWNING

[bbrowning@klhb.com](mailto:bbrowning@klhb.com) + 703.268.2717

klhb





PHASE 1		
Building	SF	Delivery Date
1	339,660	Q4 2025
2	246,490	Q4 2025
3	1,048,711	Q3 2026
4	394,270	Q3 2027
5	464,020	Q3 2027
2,493,151		
Phase 1A		Phase 1B

PHASE 2		
Building	SF	Delivery Date
6	520,000	January 2026
7	564,000	March 2026
8	430,500	July 2026
9	1,101,700	May 2026
10	170,000	December 2026
2,786,200		

**JOHN MEYER**

jmeyer@klnb.com + 443.632.2052

**BOB BROWNING**

bbrowning@klnb.com + 703.268.2717





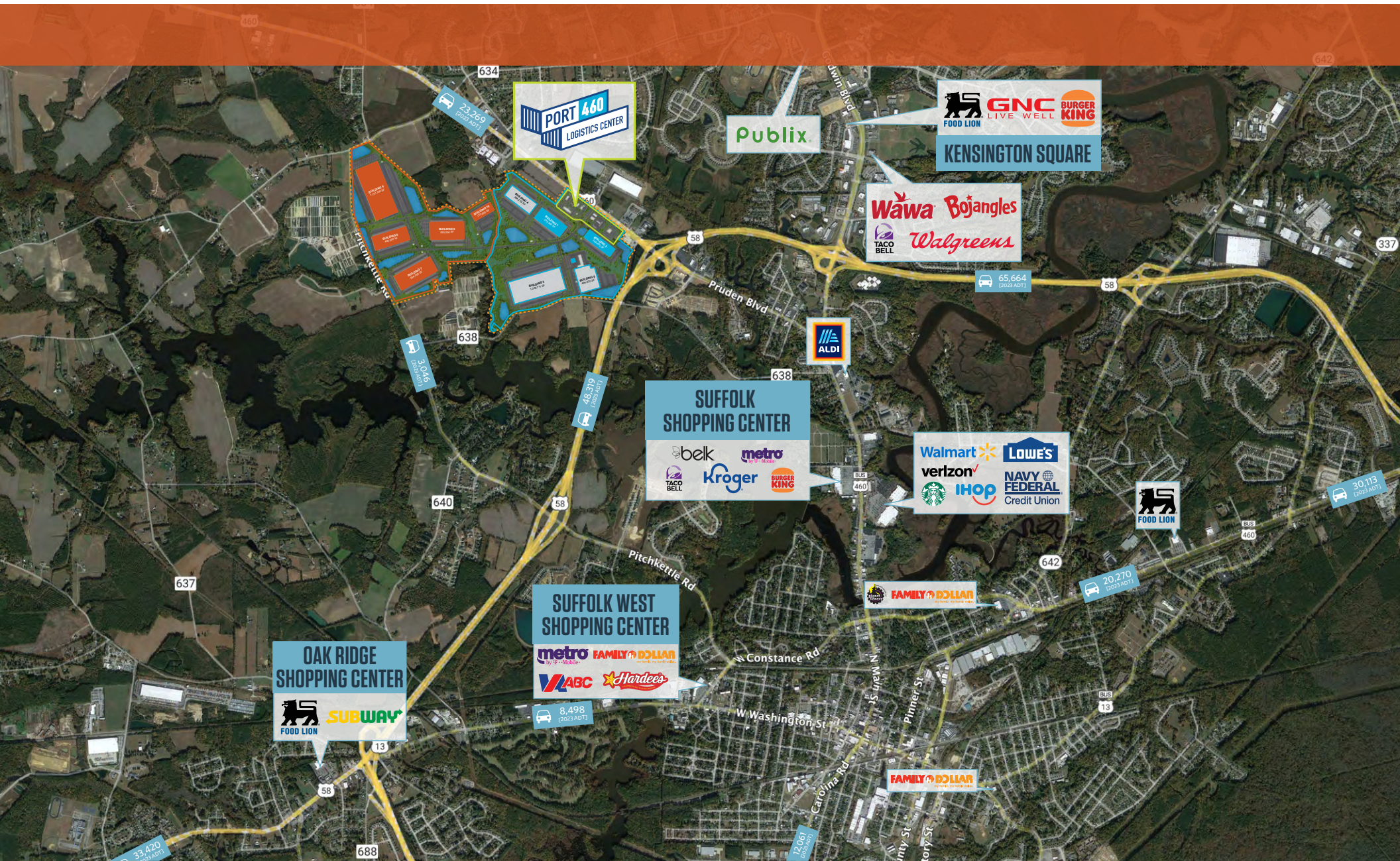



# CONNECTED TO THE MID-ATLANTIC

Situated directly on US-460, Port 460 has seamless access to the entire Norfolk region as well as I-85 and I-95, offering extensive connectivity to the major metropolitan areas of the Eastern Seaboard.

Be at the epicenter of the Hampton Roads economy— featuring rail-served port terminals that employ over 400,000 people and function collectively as the leading East Coast gateway for global shipping and commerce.

**+ CLICK TO VIEW PROJECT WEBSITE**

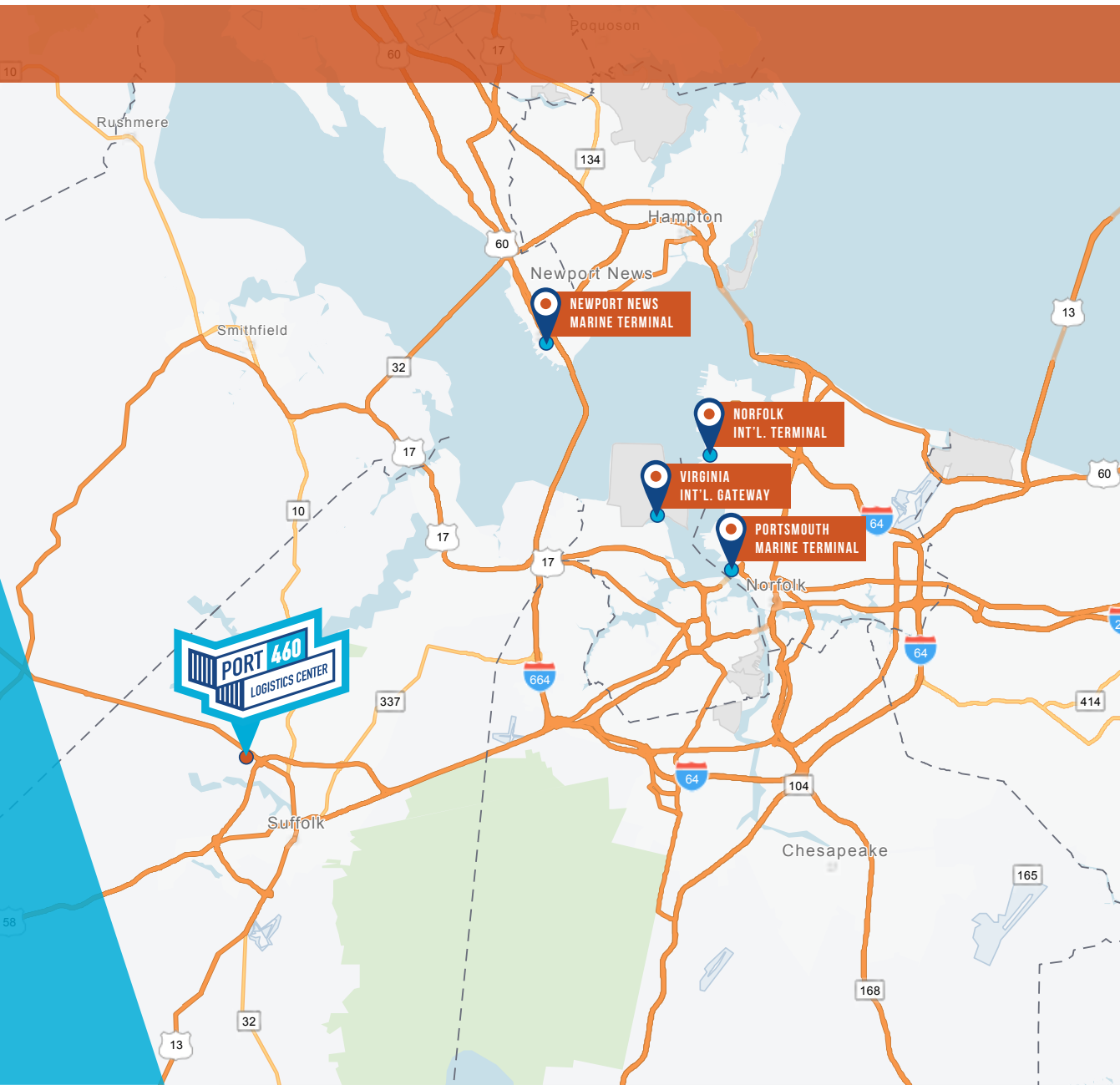





FOR MORE INFORMATION, PLEASE CONTACT:

**JOHN MEYER**

[jmeyer@klnb.com](mailto:jmeyer@klnb.com) + 443.632.2052

**BOB BROWNING**

[bbrowning@klnb.com](mailto:bbrowning@klnb.com) + 703.268.2717

 VISIT PROPERTY WEBSITE

100 West Road, Suite 505  
Towson, MD 21204

[klnb.com](http://klnb.com)



While we have no reason to doubt the accuracy of any of the information supplied, we cannot, and do not, guarantee its accuracy. All information should be independently verified prior to a purchase or lease of the property. We are not responsible for errors, omissions, misuse, or misinterpretation of information contained herein and make no warranty of any kind, express or implied, with respect to the property or any other matters.