



## JOIN THESE RETAILERS



## INLINE SPACE AND PAD SITE FOR LEASE

- 384,000 SF power center.
- Located just north of Valley Mall, anchored by Macy's, JCPenney and Sears.
- Known as "Hub City" and "Maryland's Gateway to the West," Hagerstown is a commerce and transit center, located at the intersection of I-81, I-70 and multiple railroads.
- With a population of 269,140, the Greater Hagerstown area was ranked as the fastest growing metropolitan area in the state of Maryland and among the fastest growing in the United States.

## AVAILABLE SPACE

SIZE	RATE	DELIVERY CONDITION	TIMING OF AVAILABILITY
±1 Acre	"MARKET"	"AS-IS"	IMMEDIATE
3,000 SF	"MARKET"	"AS-IS" (FORMER AAA)	IMMEDIATE
3,550 SF	"MARKET"	"AS-IS" (2 <sup>ND</sup> GEN RESTAURANT)	WITHIN 60 DAYS OF EXECUTED LEASE
5,200 SF	"MARKET"	"AS-IS" (2 <sup>ND</sup> GEN RESTAURANT)	IMMEDIATE
8,450 SF	"MARKET"	"AS-IS" (FORMER CVS)	IMMEDIATE

\*EST. NNN: \$4.93 PSF

OWNED BY: MOSAIC REALTY PARTNERS

FORREST H. MORRILL

fmorrill@klnb.com | 703-268-2707

DALLON L. CHENEY

dcheney@klnb.com | 703-268-2703

# LOCATION

# VALLEY PARK COMMONS

1520 WESEL BLVD., HAGERSTOWN, MD 21740, WASHINGTON COUNTY

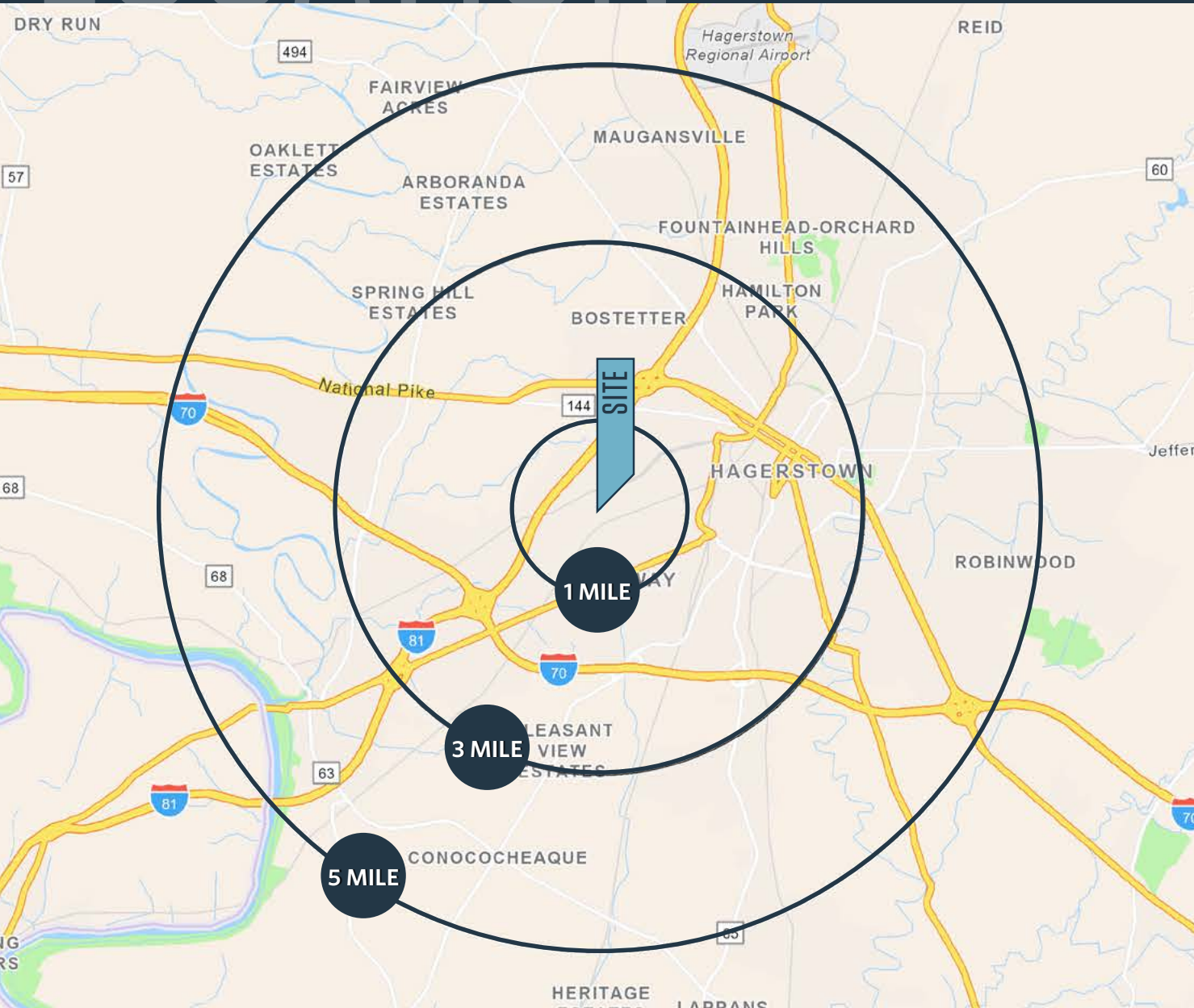

## DEMOGRAPHICS | 2024:

	1-MILE	3-MILE	5-MILE
Population	3,801	50,637	96,420
Daytime Population	8,440	59,989	112,352
Median HH Income	\$51,941	\$52,379	\$60,378

[CLICK TO DOWNLOAD DEMOGRAPHIC REPORT](#)

## TRAFFIC COUNTS | 2023:

I-81	76,041 ADT
Wesel Blvd	13,751 ADT

**FORREST H. MORRILL**

fmorrill@klnb.com | 703-268-2707

**DALLON L. CHENEY**

dcheney@klnb.com | 703-268-2703





# SITE PLAN

# VALLEY PARK COMMONS

1520 WESEL BLVD., HAGERSTOWN, MD 21740, WASHINGTON COUNTY

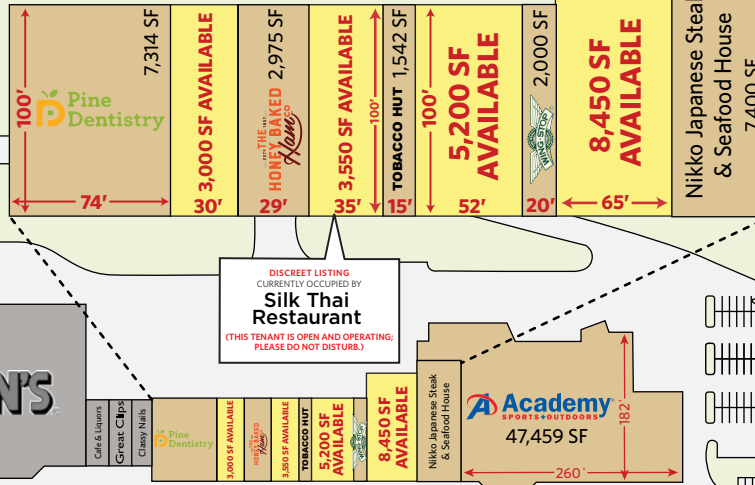
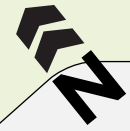

## AVAILABLE SPACE

SIZE	RATE	DELIVERY CONDITION	TIMING OF AVAILABILITY
±1 Acre	"MARKET"	"AS-IS"	IMMEDIATE
3,000 SF	"MARKET"	"AS-IS" (FORMER AAA)	IMMEDIATE
3,550 SF	"MARKET"	"AS-IS" (2 <sup>ND</sup> GEN RESTAURANT)	WITHIN 60 DAYS OF EXECUTED LEASE
5,200 SF	"MARKET"	"AS-IS" (2 <sup>ND</sup> GEN RESTAURANT)	IMMEDIATE
8,450 SF	"MARKET"	"AS-IS" (FORMER CVS)	IMMEDIATE

\*EST. NNN: \$4.93 PSF

- AVAILABLE
- LEASED
- NOT A PART



**WESEL BLVD.**

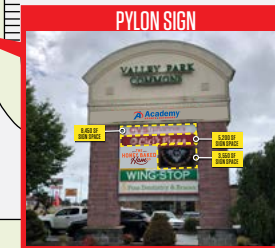

**FORREST H. MORRILL**  
fmorrill@klnb.com | 703-268-2707

**DALLON L. CHENEY**  
dcheney@klnb.com | 703-268-2703



# VALLEY PARK COMMONS

1520 WESEL BLVD., HAGERSTOWN, MD 21740, WASHINGTON COUNTY

3,000 SF AVAILABLE



CLICK FOR ADA INFORMATION



CLICK FOR LOD

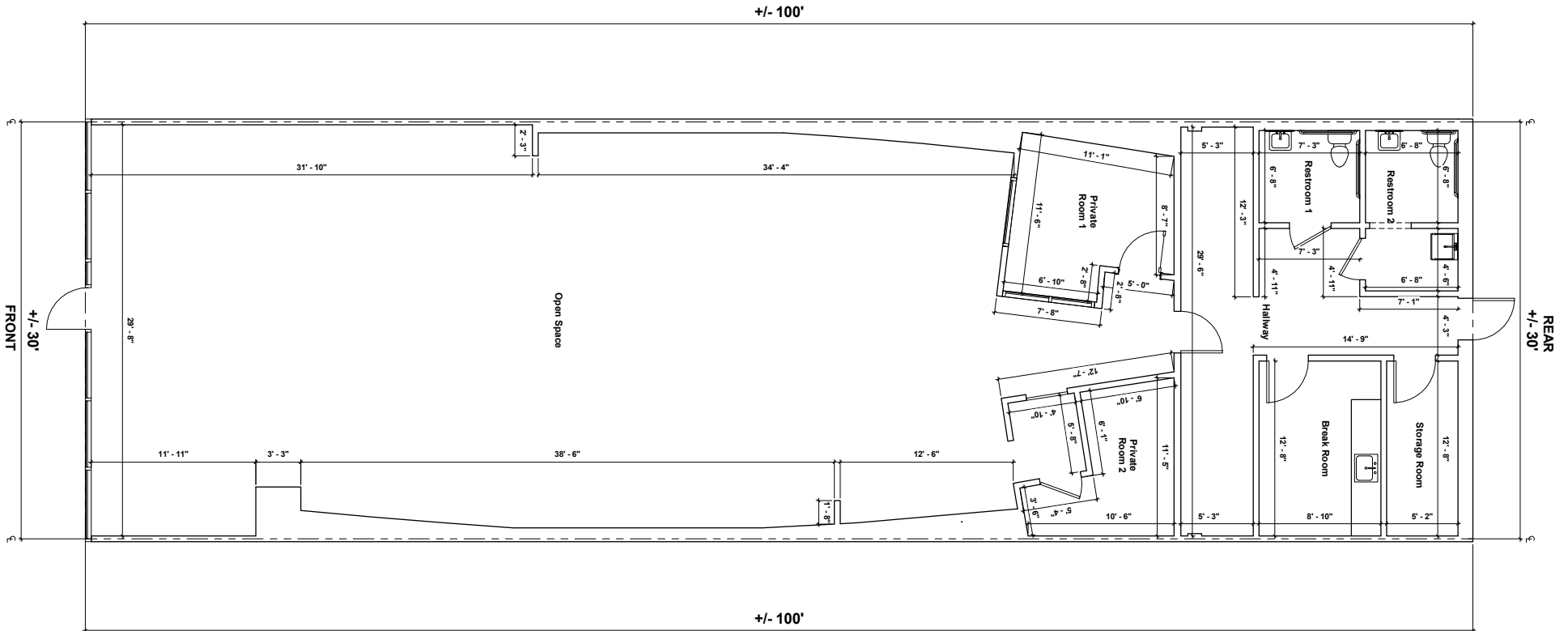

FORREST H. MORRILL

fmorrill@klnb.com | 703-268-2707

DALLON L. CHENEY

dcheney@klnb.com | 703-268-2703







# PHOTOS

# VALLEY PARK COMMONS

1520 WESEL BLVD., HAGERSTOWN, MD 21740, WASHINGTON COUNTY



**FORREST H. MORRILL**  
fmorrill@klnb.com | 703-268-2707

**DALLON L. CHENEY**  
dcheney@klnb.com | 703-268-2703

**klnb**



# VALLEY PARK COMMONS

1520 WESEL BLVD., HAGERSTOWN, MD 21740, WASHINGTON COUNTY

## FOR MORE INFORMATION, PLEASE CONTACT:

### FORREST H. MORRILL

fmorrill@klnb.com | 703-268-2707

### DALLON L. CHENEY

dcheney@klnb.com | 703-268-2703

8065 Leesburg Pike, Suite 700, Tysons, VA 22182

.....

## klnb.com



instagram.com/klnbcre



linkedin.com/company/klnb



facebook.com/KLNBCRE

**CLICK TO VIEW PROPERTY WEBSITE**

While we have no reason to doubt the accuracy of any of the information supplied, we cannot, and do not, guarantee its accuracy. All information should be independently verified prior to a purchase or lease of the property. We are not responsible for errors, omissions, misuse, or misinterpretation of information contained herein and make no warranty of any kind, express or implied, with respect to the property or any other matters.