

LAUREL TOWN CENTER

13200 Laurel Bowie Road, Laurel, MD 20708
Prince George's County



JOIN:



- Repositioning shopping center and upgrading tenant mix.
- Approximately 72,000 SF shopping center well located at the signalized intersection of Contee Road and Laurel Bowie Road in Laurel, MD.
- Easy access via traffic lights and cross easements to the adjacent grocery store.

OWNED BY:  CARROLLTON ENTERPRISES

SIZE	RATE	DELIVERY CONDITION	TIMING OF AVAILABILITY
MARKET - CALL TO DISCUSS			
*Est. NNN: \$7.83 PSF			

Matt Copeland
mcpeland@klnb.com
443-632-2051

Michael Ginsburg
mginsburg@klnb.com
443-632-2041

100 West Road, Suite 505
Baltimore, MD 21204
klnb.com



LAUREL TOWN CENTER

13200 Laurel Bowie Road, Laurel, MD 20708
Prince George's County

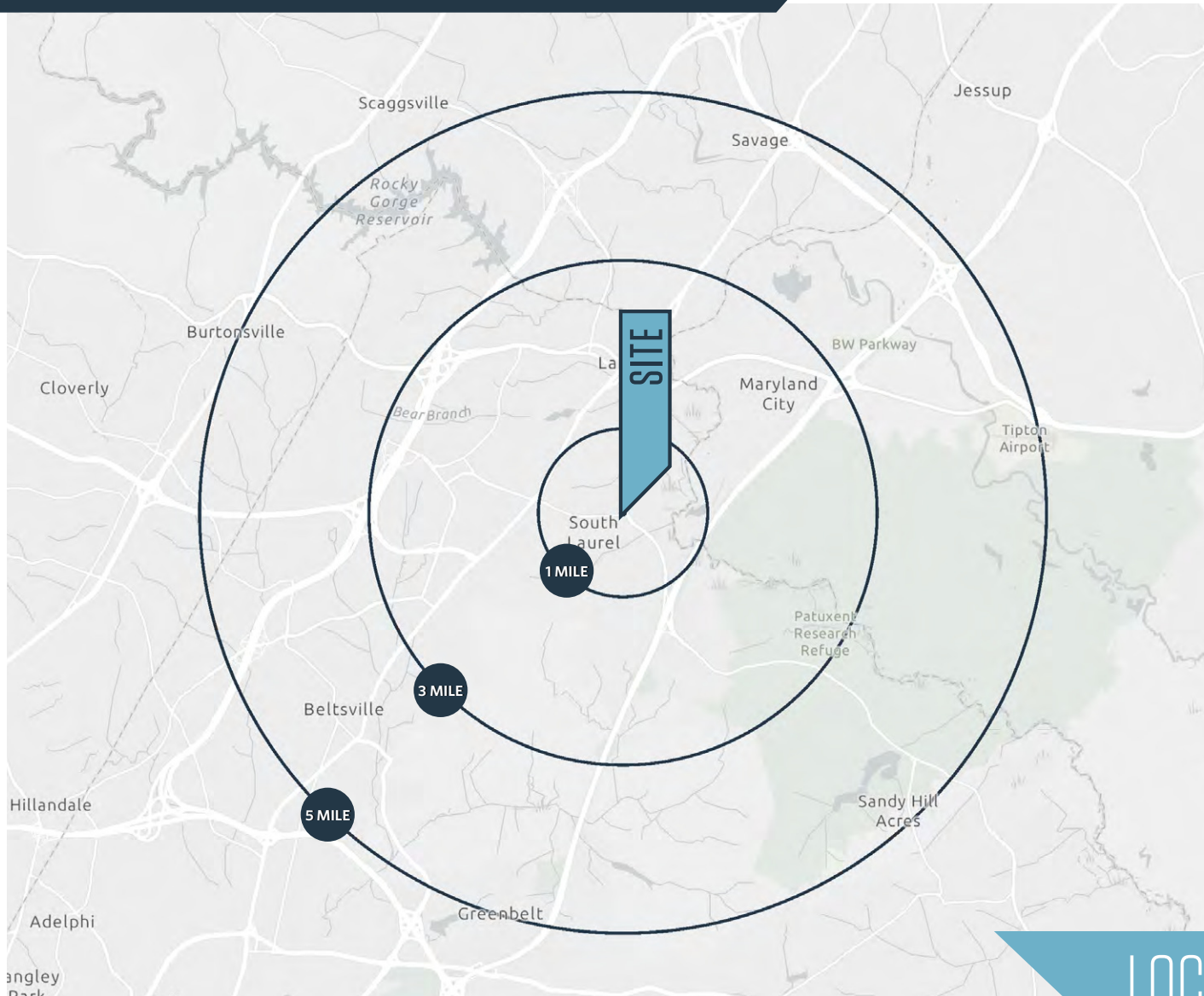

DEMOGRAPHICS | 2025:

1-MILE	3-MILE	5-MILE
Population		
17,417	83,427	161,146
Daytime Population		
12,870	80,211	163,099
Households		
6,454	31,703	59,422
Average HH Income		
\$96,819	\$117,800	\$131,657

[CLICK TO DOWNLOAD DEMOGRAPHIC REPORT](#)

TRAFFIC COUNTS | 2024:

Laurel Bowie Road	33,055 ADT
Contee Road	21,710 ADT

LOCATION & DEMOGRAPHICS

Matt Copeland
mcpeland@klnb.com
443-632-2051

Michael Ginsburg
mginsburg@klnb.com
443-632-2041

100 West Road, Suite 505
Baltimore, MD 21204
klnb.com



LAUREL TOWN CENTER

13200 Laurel Bowie Road, Laurel, MD 20708
Prince George's County



MARKET AERIAL

Matt Copeland
mcopeland@klnb.com
443-632-2051

Michael Ginsburg
mginsburg@klnb.com
443-632-2041

100 West Road, Suite 505
Baltimore, MD 21204
klnb.com



LAUREL TOWN CENTER

13200 Laurel Bowie Road, Laurel, MD 20708
Prince George's County



Matt Copeland
mcpeland@klnb.com
443-632-2051

Michael Ginsburg
mginsburg@klnb.com
443-632-2041

100 West Road, Suite 505
Baltimore, MD 21204
klnb.com

klnb

13200 Laurel Bowie Road, Laurel, MD 20708
Prince George's County

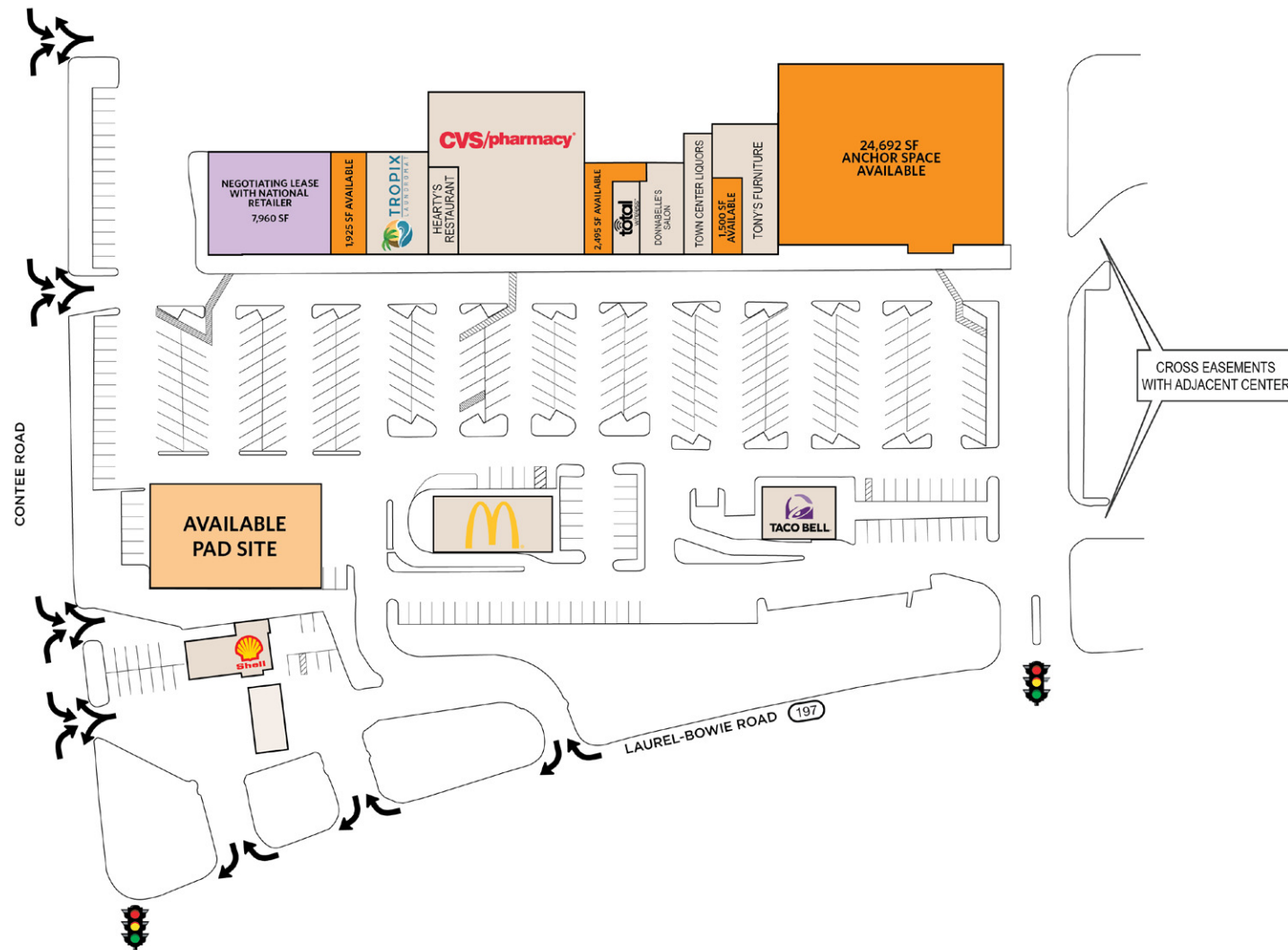

TENANT	SQ. FT.
NEGOTIATING LEASE	7,960
AVAILABLE (FORMER METRO PCS)	1,925
 TROPIC SUNSHINE	3,600
HEARTY'S RESTAURANT	2,640
CVS/pharmacy	12,340
AVAILABLE (FORMER DRY CLEANERS)	2,495
TOTAL WIRELESS	920
DONNABELLE'S SALON	1,829
TOWN CENTER LIQUORS	2,300
AVAILABLE (FORMER BEAUTY SUPPLY STORE)	1,500
TONY'S FURNITURE	3,500
AVAILABLE (FORMER PEP BOYS STORE)	24,692
 Shell	1,470
	3,838
 TACO BELL	2,080

- AVAILABLE
- NEGOTIATING LEASE
- EXECUTED LEASE

SIZE	RATE	DELIVERY CONDITION	TIMING OF AVAILABILITY
MARKET - CALL TO DISCUSS			
*Est. NNN: \$7.83 PSF			

Matt Copeland
mcopeland@klnb.com
443-632-2051

Michael Ginsburg
mginsburg@klnb.com
443-632-2041

100 West Road, Suite 505
Baltimore, MD 21204
klnb.com

SITE PLAN



LAUREL TOWN CENTER

13200 Laurel Bowie Road, Laurel, MD 20708
Prince George's County



Matt Copeland
mcopeland@klnb.com
443-632-2051

Michael Ginsburg
mginsburg@klnb.com
443-632-2041

100 West Road, Suite 505
Baltimore, MD 21204
klnb.com



LAUREL TOWN CENTER

13200 Laurel Bowie Road, Laurel, MD 20708
Prince George's County

CLICK TO VIEW PROPERTY WEBSITE

For More Information, Please Contact:

Matt Copeland
mcopeland@klnb.com
443-632-2051

Michael Ginsburg
mginsburg@klnb.com
443-632-2041

100 West Road, Suite 505
Baltimore, MD 21204

klnb.com



[instagram.com/klnbcre](https://www.instagram.com/klnbcre)



[linkedin.com/company/klnb](https://www.linkedin.com/company/klnb)



[facebook.com/KLNBCRE](https://www.facebook.com/KLNBCRE)

While we have no reason to doubt the accuracy of any of the information supplied, we cannot, and do not, guarantee its accuracy. All information should be independently verified prior to a purchase or lease of the property. We are not responsible for errors, omissions, misuse, or misinterpretation of information contained herein and make no warranty of any kind, express or implied, with respect to the property or any other matters.

klnb