

# FLEX SPACE AVAILABLE

9700 Martin Luther King Jr. Highway, Lanham, MD 20706  
Prince George's County

**80% Warehouse End Cap;  
2 Docks and Ramped Drive-In**



## AVAILABLE FOR SUBLEASE

### ► 8,642 SF End-Cap

- **Loading:** Three (3) docks (one ramped)
- **Ceiling Height:** 16'9" clear throughout
- **Column Spacing:** 40' x 40'

- **Sublease Term:** Through 4/30/2027;  
(Additional term can be requested)
- **Rate:** \$13.00 PSF, NNN

OWNED & MANAGED BY:  
 **LONGPOINT**  
BUILT FOR MOVEMENT

Spence Daw  
sdaw@klnb.com  
443-574-1429

9881 Broken Land Parkway, #300  
Columbia, MD 21046  
klnb.com

**NAI**klnb

# FOR SUBLEASE

# FLEX SPACE AVAILABLE

9700 Martin Luther King Jr. Highway, Lanham, MD 20706  
Prince George's County

**8,642 SF**  
AVAILABLE

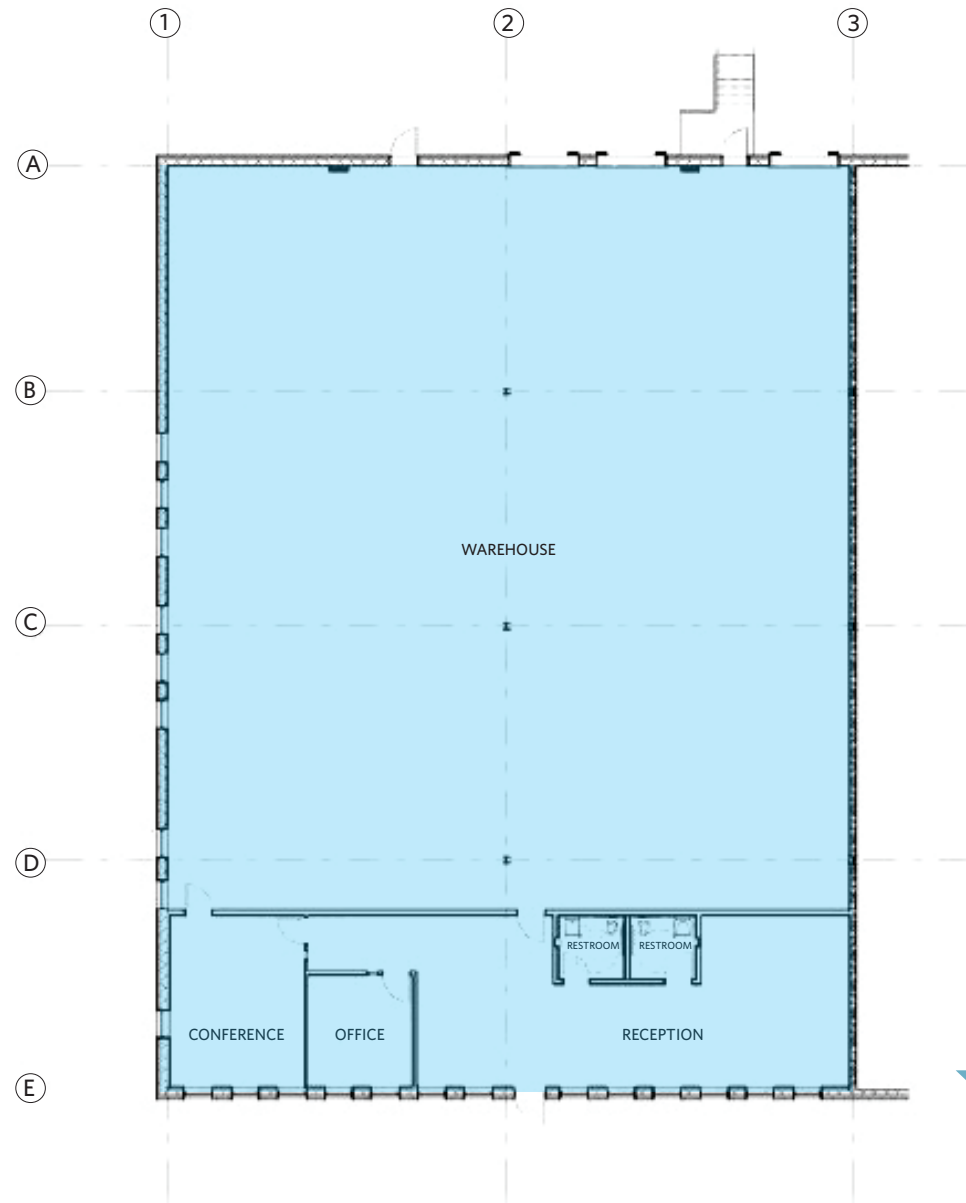

FLOOR PLAN

**Spence Daw**  
sdaw@klnb.com  
443-574-1429

9881 Broken Land Parkway, #300  
Columbia, MD 21046  
**klnb.com**





# FLEX SPACE AVAILABLE

9700 Martin Luther King Jr. Highway, Lanham, MD 20706  
Prince George's County

## TRUCK COURT

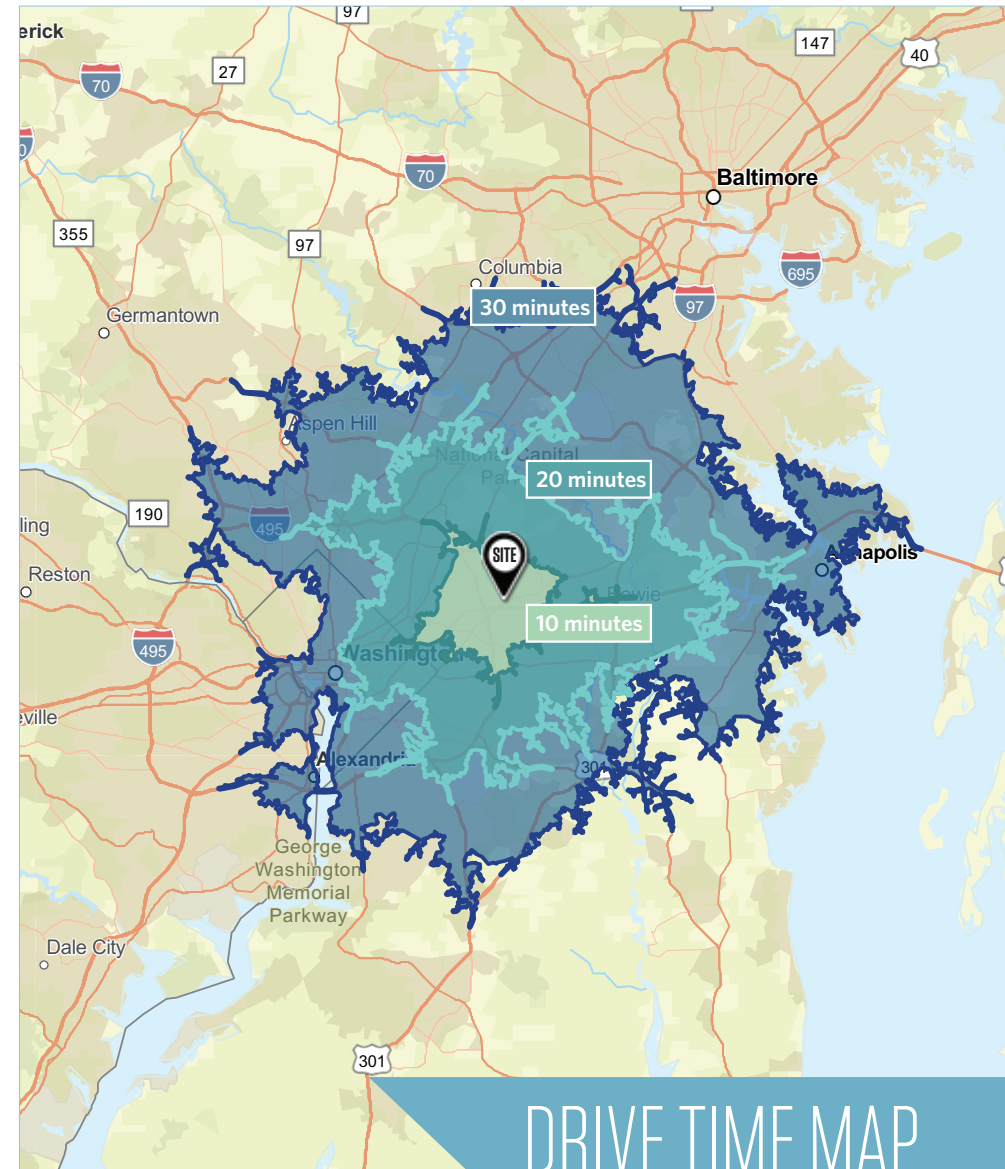

## DRIVE TIME MAP

Contact  
Information:

**Spence Daw**  
sdaw@klnb.com  
443-574-1429

9881 Broken Land Parkway, #300  
Columbia, MD 21046  
klnb.com

**NAI**klnb