

MUIRKIRK BUSINESS CENTER I & II

6850 - 6872 Distribution Drive & 12201 - 12211 Distribution Way
Beltsville, MD 20705 | Prince George's County



Recently Updated Façade



Large Truck Court

FLEX / INDUSTRIAL FOR LEASE

PROPERTY FEATURES

- Muirkirk I: 6850-6872 Distribution Drive; 58,444 SF
- Muirkirk II: 12201-12211 Distribution Way; 62,763 SF
 - » Versatile dock/drive-in loading with 165' truck court
 - » 22' clear and fully sprinklered
 - » Ample parking and easy access to I-95 & Route 1

CURRENT SPACE AVAILABILITY

- 12211 Distribution Way:
 - » 9,913 square feet available
 - » Two (2) docks, one (1) at-grade drive-in
 - » High-end office / showroom area

Spence Daw, SIOR
sdaw@klnb.com
443-574-1429

Aaron Carroll
acarroll@klnb.com
202-652-2333

Newly Owned & Managed By:
 **BERKELEY**
PARTNERS

9881 Broken Land Pkwy, #300
Columbia, MD 21046
klnb.com



MUIRKIRK BUSINESS CENTER I & II

6850 - 6872 Distribution Drive & 12201 - 12211 Distribution Way
Beltsville, MD 20705 | Prince George's County

12201 - 12211

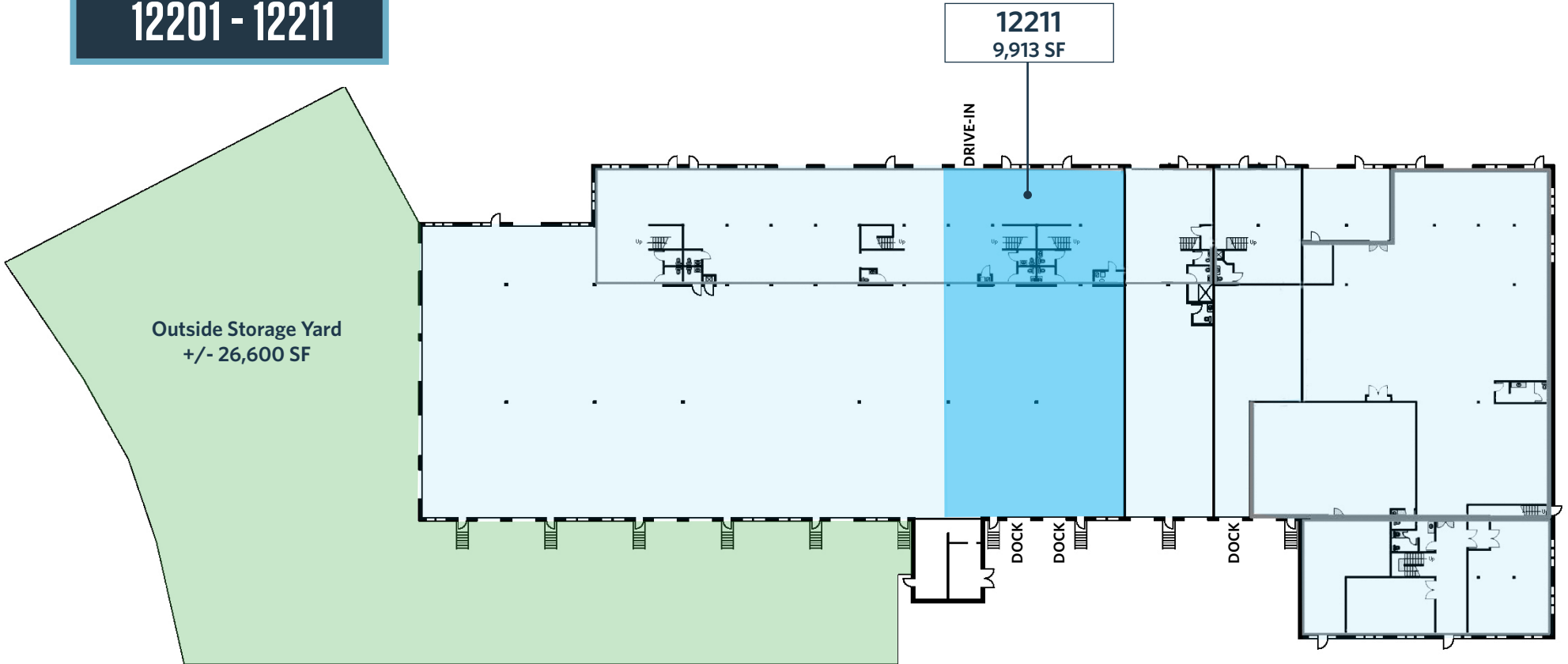

NEWLY OWNED & MANAGED BY:



FLOOR PLAN

Spence Daw, SIOR
sdaw@klnb.com
443-574-1429

Aaron Carroll
acarroll@klnb.com
202-652-2333

Newly Owned & Managed By:

BERKELEY
PARTNERS

9881 Broken Land Pkwy, #300
Columbia, MD 21046
klnb.com



MUIRKIRK BUSINESS CENTER I & II

6850 - 6872 Distribution Drive & 12201 - 12211 Distribution Way
Beltsville, MD 20705 | Prince George's County

12211

9,913 SF

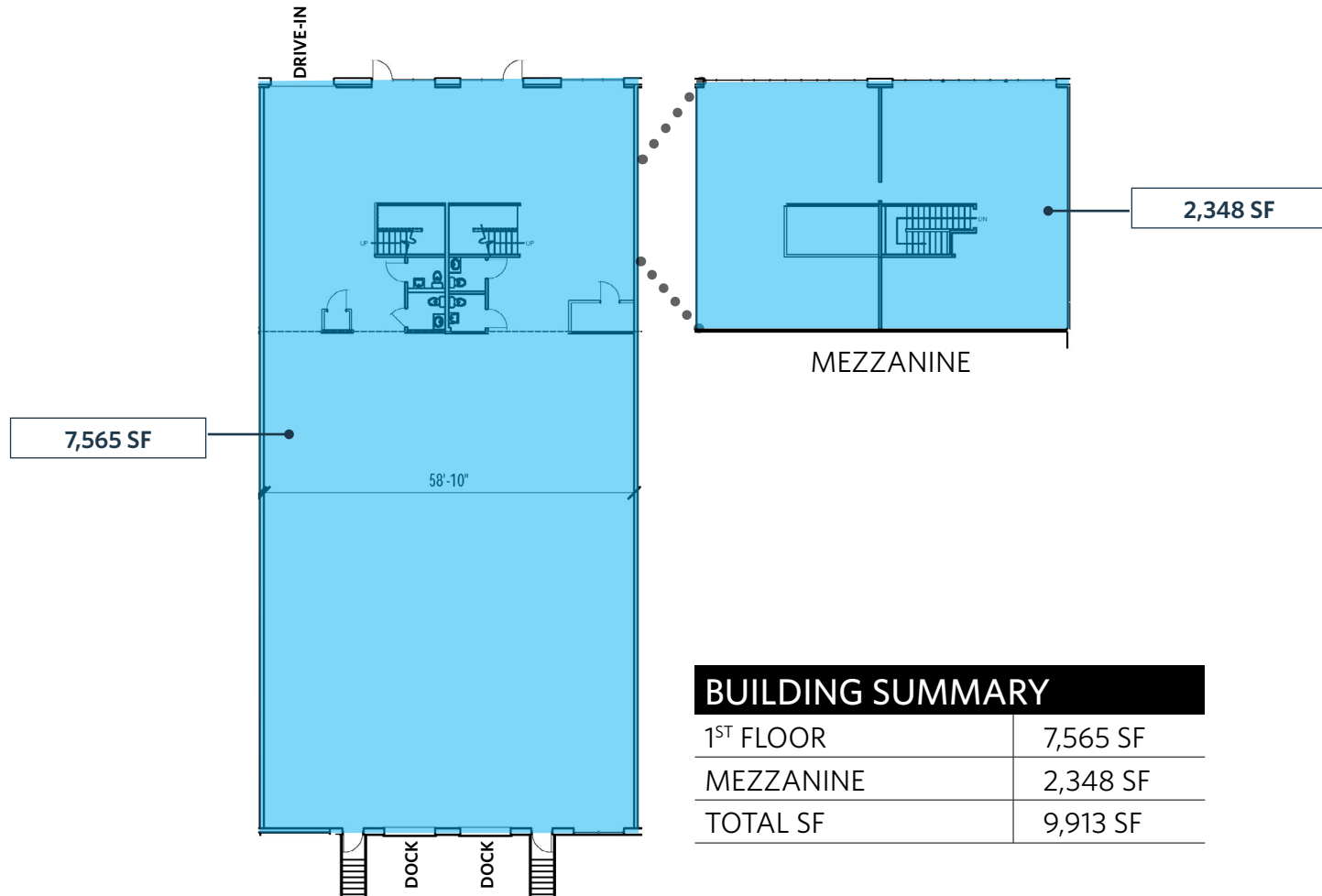

BUILDING SUMMARY

1 ST FLOOR	7,565 SF
MEZZANINE	2,348 SF
TOTAL SF	9,913 SF

NEWLY OWNED & MANAGED BY:



FLOOR PLAN

Spence Daw, SIOR
sdaw@klnb.com
443-574-1429

Aaron Carroll
acarroll@klnb.com
202-652-2333

Newly Owned & Managed By:



9881 Broken Land Pkwy, #300
Columbia, MD 21046
klnb.com



MUIRKIRK BUSINESS CENTER I & II

6850 - 6872 Distribution Drive & 12201 - 12211 Distribution Way
 Beltsville, MD 20705 | Prince George's County

DRIVE TIME MAP

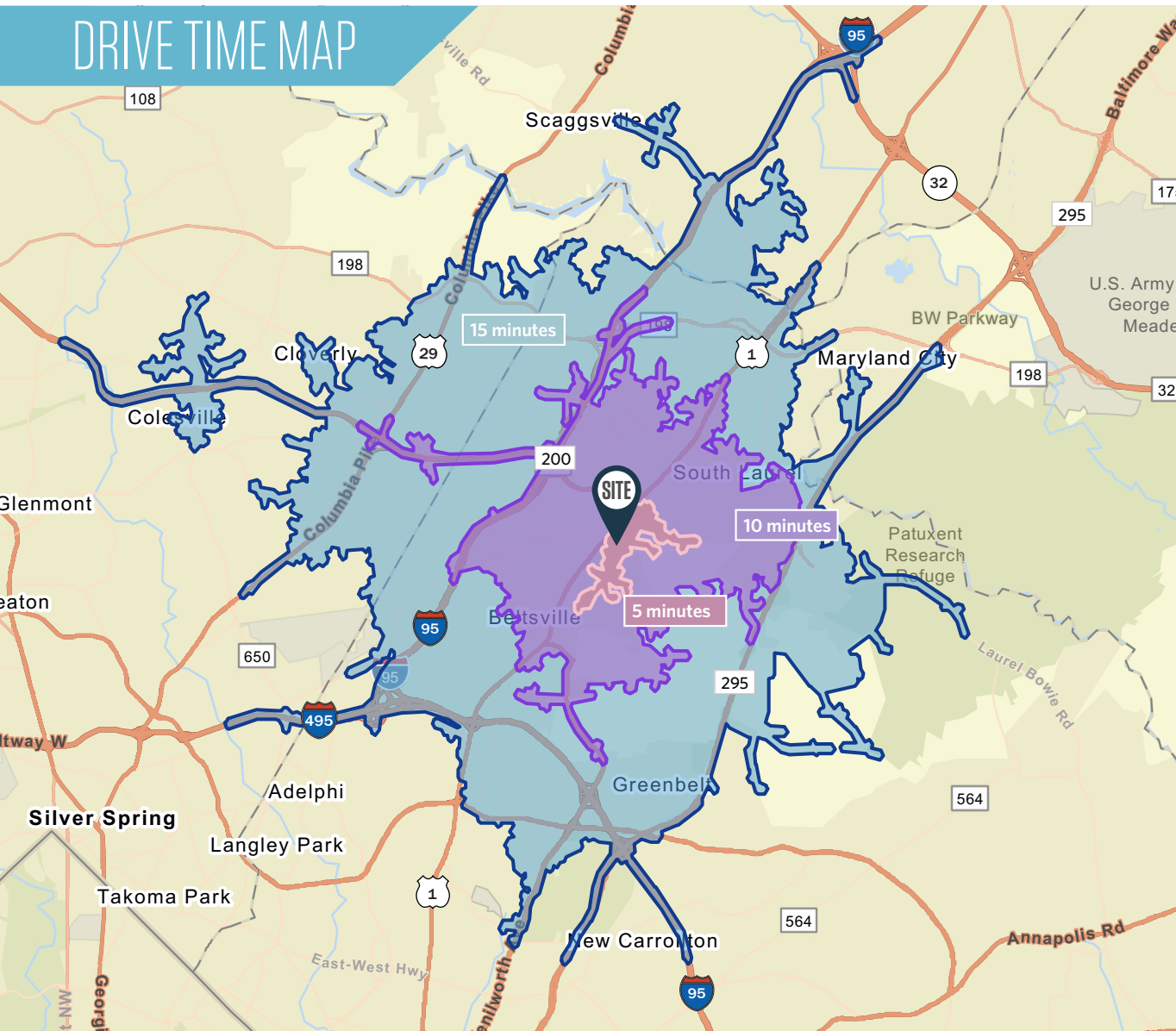

DEMOGRAPHICS | 3 MILES



POPULATION
35,569



HOUSEHOLDS
11,860



MEDIAN HH INCOME
\$94,109



MEDIAN AGE
37.5



DISPOSABLE INCOME
\$74,134



MEDIUM NETWORTH
\$185,424

Spence Daw, SIOR
sdaw@klnb.com
443-574-1429

Aaron Carroll
acarroll@klnb.com
202-652-2333

Newly Owned & Managed By:
 **BERKELEY**
PARTNERS

9881 Broken Land Pkwy, #300
 Columbia, MD 21046
klnb.com

NA klnb

MUIRKIRK BUSINESS CENTER I & II

6850 - 6872 Distribution Drive & 12201 - 12211 Distribution Way
Beltsville, MD 20705 | Prince George's County



UPDATED EXTERIOR

Spence Daw, SIOR
sdaw@klnb.com
443-574-1429

Aaron Carroll
acarroll@klnb.com
202-652-2333

Newly Owned & Managed By:
 **BERKELEY**
PARTNERS

9881 Broken Land Pkwy, #300
Columbia, MD 21046
klnb.com

 **NA klnb**

MUIRKIRK BUSINESS CENTER I & II

6850 - 6872 Distribution Drive & 12201 - 12211 Distribution Way
Beltsville, MD 20705 | Prince George's County

CLICK TO VIEW PROPERTY WEBSITE

For More Information, Please Contact:

Spence Daw, SIOR

sdaw@klnb.com

443-574-1429

Aaron Carroll

acarroll@klnb.com

202-652-2333

9881 Broken Land Parkway, Suite 300
Columbia, MD 21046

klnb.com



[instagram.com/klnbcre](https://www.instagram.com/klnbcre)



[linkedin.com/company/klnb](https://www.linkedin.com/company/klnb)



[facebook.com/KLNBCRE](https://www.facebook.com/KLNBCRE)

While we have no reason to doubt the accuracy of any of the information supplied, we cannot, and do not, guarantee its accuracy. All information should be independently verified prior to a purchase or lease of the property. We are not responsible for errors, omissions, misuse, or misinterpretation of information contained herein and make no warranty of any kind, express or implied, with respect to the property or any other matters.

NEWLY OWNED & MANAGED BY:

