

JOIN THESE RETAILERS



RETAIL FOR LEASE

- This retail project is sandwiched between Amazon's HQ2 and Virginia Tech's Innovation Hub.
- Located at the gateway to National Landing, a mixed-use development of 5,000 housing units, 3 million SF of office, retail and hotels.
- Market Square development includes: The Eclipse, 464 luxury condos & apartments between \$200,000 - \$1 million, located directly above the retail space.
- Transit stop located at site and nearby Metro stop.
- Easy and abundant indoor parking.
- Signage on Route 1 & South Glebe Road.

AVAILABLE SPACE

SIZE	RATE	DELIVERY CONDITION	TIMING OF AVAILABILITY
2,349 SF	"MARKET"	"AS-IS" (existing medical space)	WITHIN 60 DAYS OF EXECUTED LEASE
7,505 SF	"MARKET"	"AS-IS" (former medical space)	IMMEDIATE
48,198 SF	"MARKET"	"AS-IS" (former Harris Teeter)	IMMEDIATE
OR IF DEMISED:			
±19,358 SF	"MARKET"	NEGOTIABLE	TBD
±22,840 SF	"MARKET"	NEGOTIABLE	TBD

*Est. NNN = \$11.44 PSF

FORREST H. MORRILL

fmmorrill@klnb.com | 703-268-2707

DALLON L. CHENEY

dcheney@klnb.com | 703-268-2703

LOCATION

MARKET SQUARE - NATIONAL LANDING

ROUTE 1 & SOUTH GLEBE ROAD, ARLINGTON, VIRGINIA 22202, ARLINGTON COUNTY

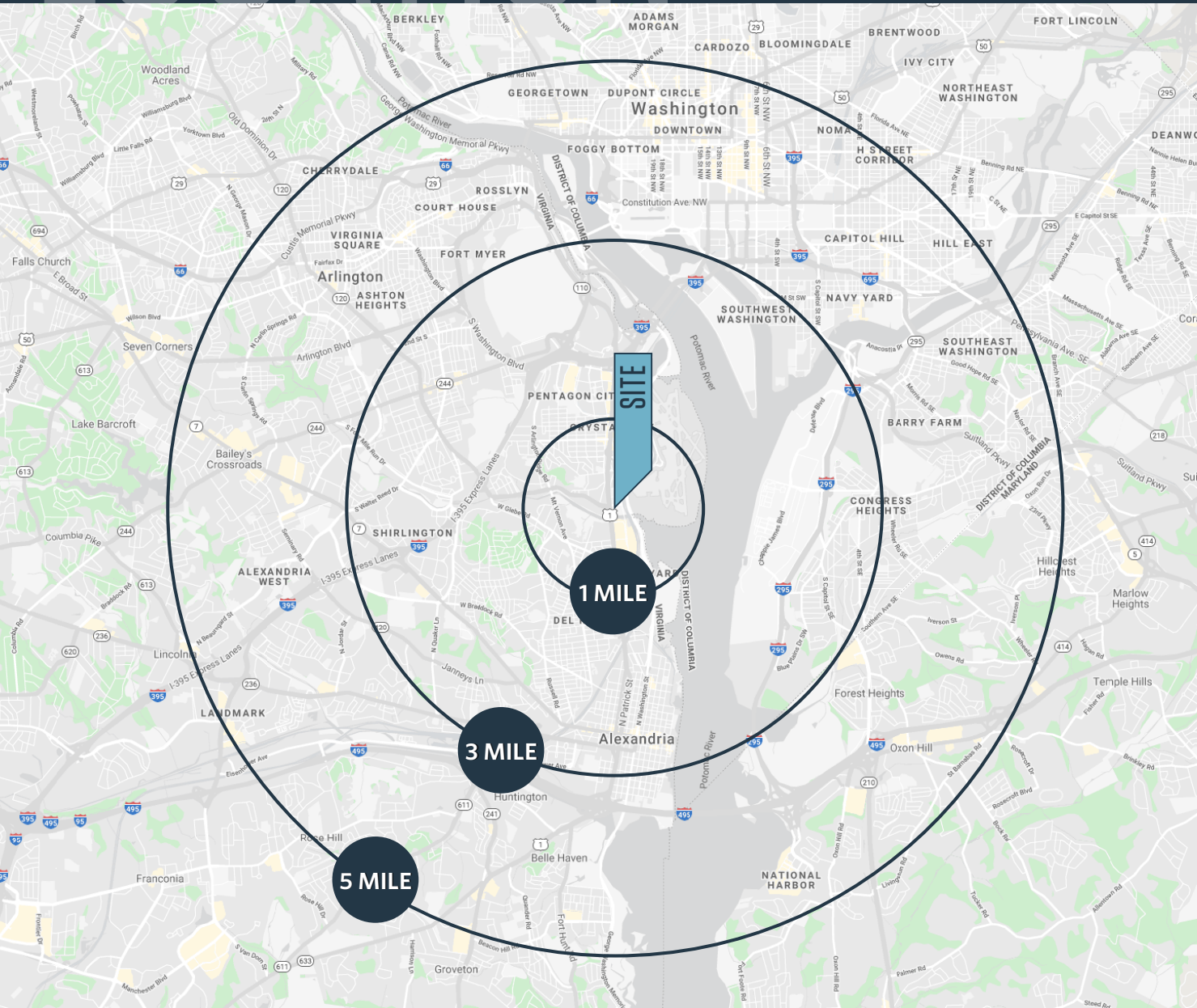

DEMOGRAPHICS | 2025:

1-MILE	3-MILE	5-MILE
Population		
27,316	202,499	722,985
Daytime Population		
40,559	249,079	1,178,162
Households		
12,283	97,197	344,954
Average HH Income		
\$166,760	\$169,286	\$163,327

[CLICK TO DOWNLOAD DEMOGRAPHIC REPORT](#)

TRAFFIC COUNTS | 2023:

Route 1	37,212 ADT
S Glebe Road	21,988 ADT

FORREST H. MORRILL
fmorrill@klnb.com | 703-268-2707

DALLON L. CHENEY
dcheney@klnb.com | 703-268-2703



SITE PLAN

MARKET SQUARE - NATIONAL LANDING

ROUTE 1 & SOUTH GLEBE ROAD, ARLINGTON, VIRGINIA 22202, ARLINGTON COUNTY

SIZE	RATE	DELIVERY CONDITION	TIMING OF AVAILABILITY
2,349 SF	"MARKET"	"AS-IS" (existing medical space)	WITHIN 60 DAYS OF EXECUTED LEASE
7,505 SF	"MARKET"	"AS-IS" (former medical space)	IMMEDIATE
48,198 SF	"MARKET"	"AS-IS" (former Harris Teeter)	IMMEDIATE
OR IF DEMISED:			
±19,358 SF	"MARKET"	NEGOTIABLE	TBD
±22,840 SF	"MARKET"	NEGOTIABLE	TBD

*Est. NNN = \$11.44 PSF

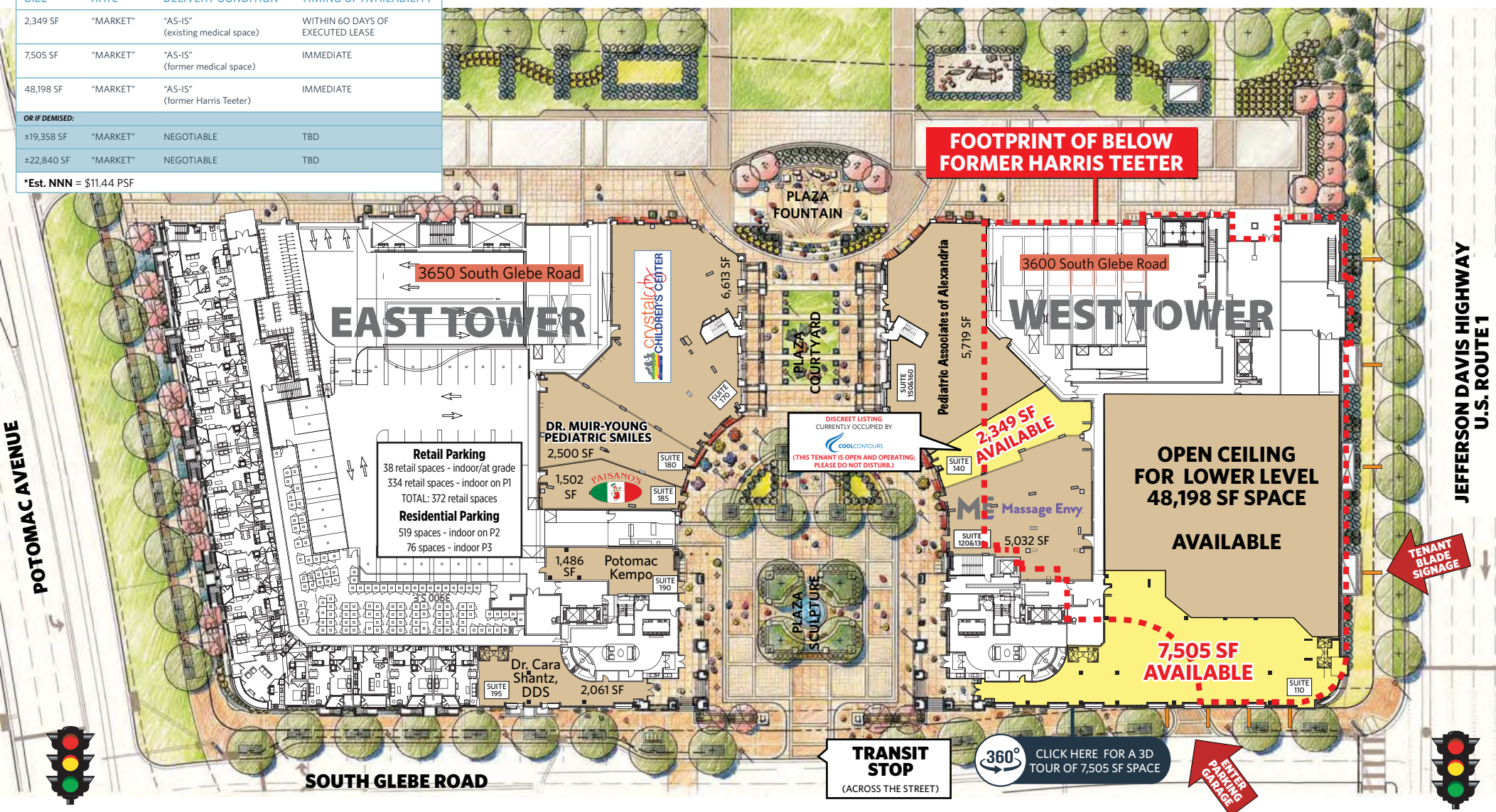

FORREST H. MORRILL

fmmorrill@klnb.com | 703-268-2707

DALLON L. CHENEY

dcheney@klnb.com | 703-268-2703

klnb

GARAGE P-1
ELEV. 16'

POTENTIAL FLOOR PLAN (DEMISING OPTION)

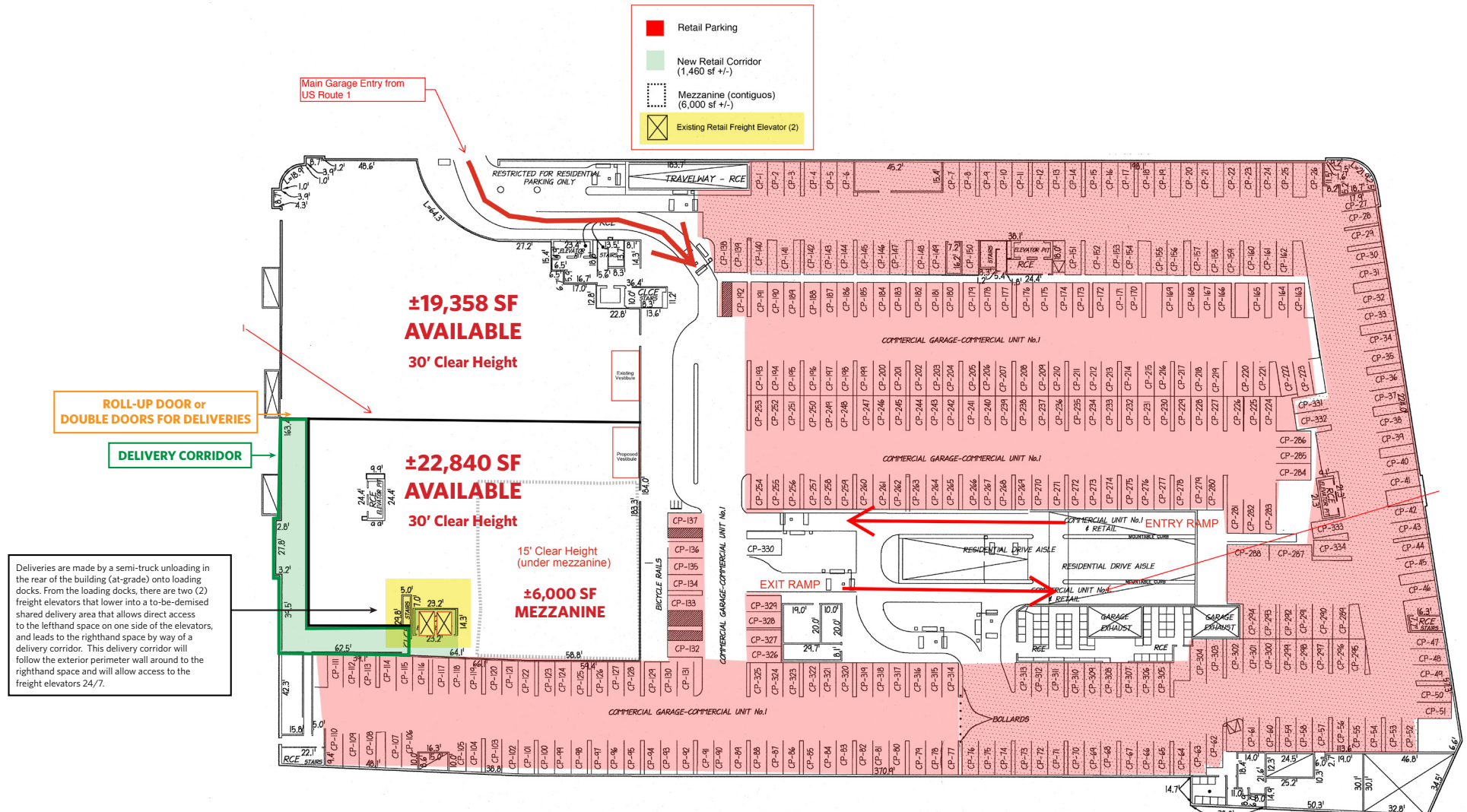

FORREST H. MORRILL

fmoorrill@klnb.com | 703-268-2707

DALLON L. CHENEY

dcheney@klnb.com | 703-268-2703



AERIAL

MARKET SQUARE - NATIONAL LANDING

ROUTE 1 & SOUTH GLEBE ROAD, ARLINGTON, VIRGINIA 22202, ARLINGTON COUNTY



MID-VIEW

MARKET SQUARE - NATIONAL LANDING

ROUTE 1 & SOUTH GLEBE ROAD, ARLINGTON, VIRGINIA 22202, ARLINGTON COUNTY



FORREST H. MORRILL

fmmorrill@klnb.com | 703-268-2707

DALLON L. CHENEY

dcheney@klnb.com | 703-268-2703

klnb

OVERVIEW

MARKET SQUARE - NATIONAL LANDING

ROUTE 1 & SOUTH GLEBE ROAD, ARLINGTON, VIRGINIA 22202, ARLINGTON COUNTY



FORREST H. MORRILL

fmmorrill@klnb.com | 703-268-2707

DALLON L. CHENEY

dcheney@klnb.com | 703-268-2703



PHOTOS

MARKET SQUARE - NATIONAL LANDING

ROUTE 1 & SOUTH GLEBE ROAD, ARLINGTON, VIRGINIA 22202, ARLINGTON COUNTY



FORREST H. MORRILL

fморрил@klnb.com | 703-268-2707

DALLON L. CHENEY

dcheney@klnb.com | 703-268-2703

klnb



MARKET SQUARE - NATIONAL LANDING

ROUTE 1 & SOUTH GLEBE ROAD, ARLINGTON, VIRGINIA 22202, ARLINGTON COUNTY

FOR MORE INFORMATION, PLEASE CONTACT:

FORREST H. MORRILL

fmorrill@klnb.com | 703-268-2707

DALLON L. CHENEY

dcheney@klnb.com | 703-268-2703

8065 Leesburg Pike, Suite 700, Tysons, VA 22182

.....

klnb.com



instagram.com/klnbcre



linkedin.com/company/klnb



facebook.com/KLNBCRE

CLICK TO VIEW PROPERTY WEBSITE

While we have no reason to doubt the accuracy of any of the information supplied, we cannot, and do not, guarantee its accuracy. All information should be independently verified prior to a purchase or lease of the property. We are not responsible for errors, omissions, misuse, or misinterpretation of information contained herein and make no warranty of any kind, express or implied, with respect to the property or any other matters.