



# LENOX PARK - SILVER SPRING

1400 EAST WEST HIGHWAY SILVER SPRING, MARYLAND 20910

**RETAIL OPPORTUNITIES AVAILABLE**  
**407 RESIDENTIAL UNITS**  
**LOCATED AT THE INTERSECTION OF EAST-WEST HIGHWAY**  
**& COLESVILLE ROAD IN THE HEART OF SILVER SPRING**

**1,200 SF AVAILABLE**

**2,000 SF AVAILABLE**

**1,461 SF AVAILABLE**

**ACCESS TO PARKING ON SITE**

**COLESVILLE RD**  
**9,970 ADT**

**EAST WEST HWY**  
**21,301 ADT**

**MATT SKALET**  
mskalet@klnb.com | 202-420-7775

**KELLY ATKINSON**  
katkinson@klnb.com | 202-420-7762

**klnb.com**

# LOCATION

# LENOX PARK - SILVER SPRING

1400 EAST WEST HIGHWAY SILVER SPRING, MARYLAND 20910

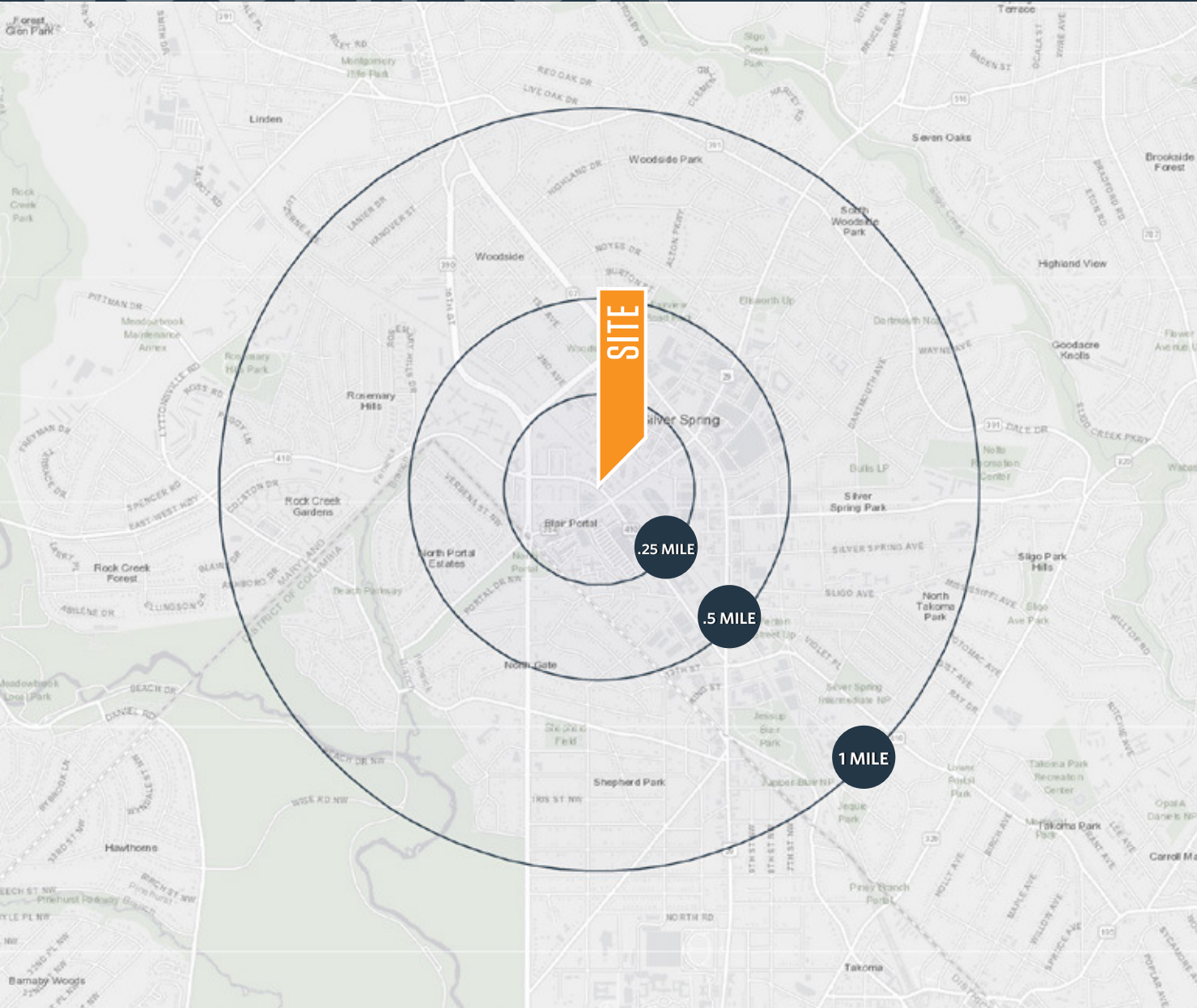

## AVAILABLE SPACE

2,000 SF Available Immediately

- Wide open shell condition

1,200 SF Available Immediately

- Wide open shell condition

1,461 SF Available Immediately

- Former massage therapist office

## DEMOGRAPHICS | 2025:

### WALK TIME

	5 MIN	10 MIN	0.25-MILE	0.5-MILE	1-MILE
Population	5,346	17,625	6,624	18,963	39,089
Daytime Population	6,465	24,526	7,785	26,026	43,156
Households	3,209	10,381	4,038	11,033	19,599
Average HH Income	\$108,894	\$117,460	\$103,142	\$121,132	\$141,381

## TRAFFIC COUNTS | 2024:

Colesville Road	9,970 ADT
East-West Hwy	21,301 ADT
Georgia Ave	26,360 ADT



4,536 ADR

**MATT SKALET**

mkalet@klnb.com | 202-420-7775

**KELLY ATKINSON**

katkinson@klnb.com | 202-420-7762



# SITE PLAN

# LENOX PARK - SILVER SPRING

1400 EAST WEST HIGHWAY SILVER SPRING, MARYLAND 20910

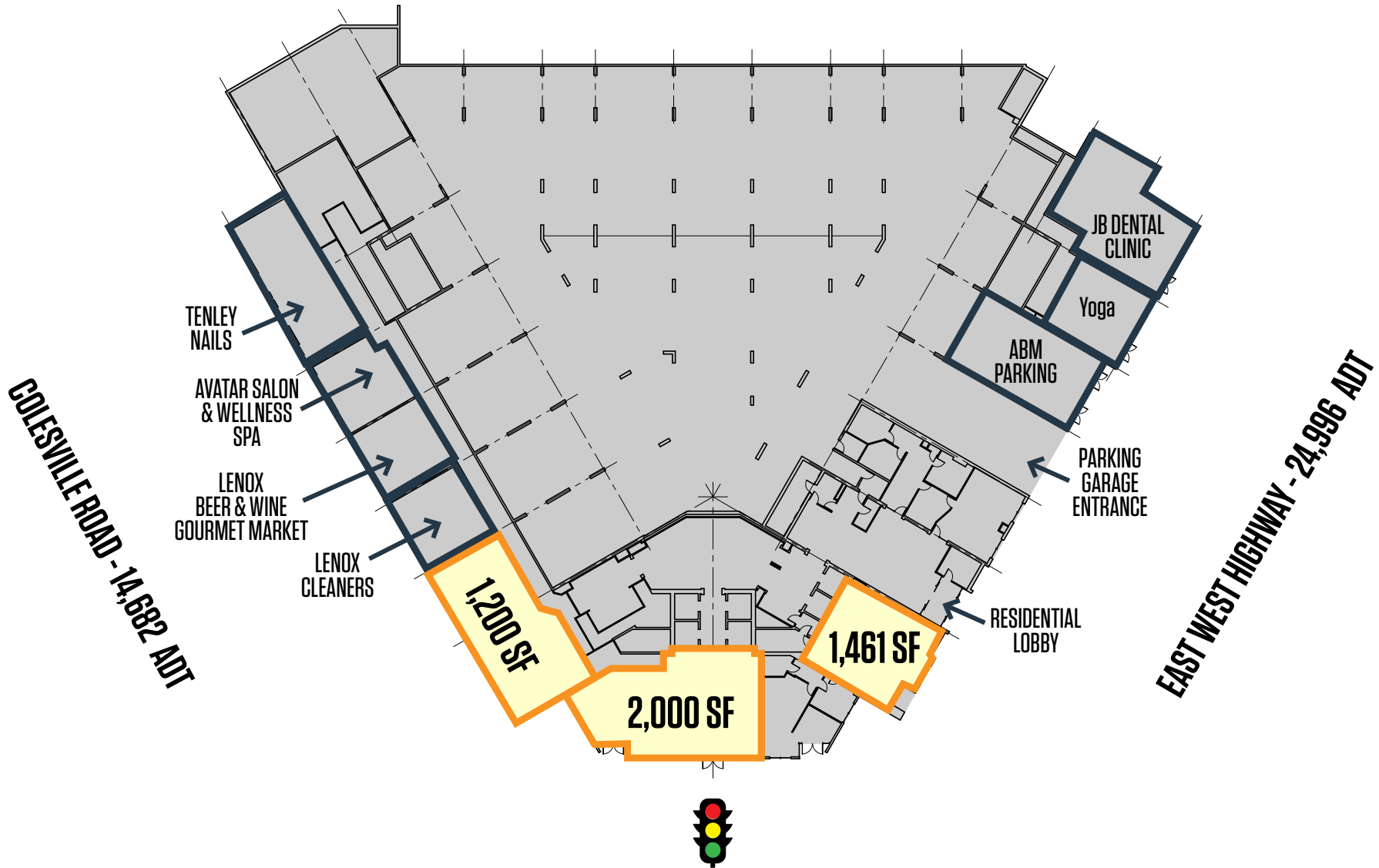

**MATT SKALET**

maskalet@klnb.com | 202-420-7775

**KELLY ATKINSON**

katkinson@klnb.com | 202-420-7762



# PHOTOS

## LENOX PARK - SILVER SPRING

1400 EAST WEST HIGHWAY SILVER SPRING, MARYLAND 20910

2,000 SF AVAILABLE

RETAIL FOR LEASE 202-375-7500



# LENOX PARK APARTMENTS

**MATT SKALET**

maskalet@klnb.com | 202-420-7775

**KELLY ATKINSON**

katkinson@klnb.com | 202-420-7762



# PHOTOS

## LENOX PARK - SILVER SPRING

1400 EAST WEST HIGHWAY SILVER SPRING, MARYLAND 20910



**MATT SKALET**

maskalet@klnb.com | 202-420-7775

**KELLY ATKINSON**

katkinson@klnb.com | 202-420-7762

**klnb**







# LENOX PARK - SILVER SPRING

1400 EAST WEST HIGHWAY SILVER SPRING, MARYLAND 20910

## FOR MORE INFORMATION, PLEASE CONTACT:

### MATT SKALET

mkalet@klnb.com  
202-420-7775

### KELLY ATKINSON

katkinson@klnb.com  
202-420-7762

1130 Connecticut Avenue, Suite 600, Washington, DC 20036

.....

**klnb.com**



[instagram.com/klnbllc](https://www.instagram.com/klnbllc)



[linkedin.com/company/klnb](https://www.linkedin.com/company/klnb)



[facebook.com/KLNB](https://www.facebook.com/KLNB)

**CLICK TO VIEW PROPERTY WEBSITE**

While we have no reason to doubt the accuracy of any of the information supplied, we cannot, and do not, guarantee its accuracy. All information should be independently verified prior to a purchase or lease of the property. We are not responsible for errors, omissions, misuse, or misinterpretation of information contained herein and make no warranty of any kind, express or implied, with respect to the property or any other matters.