



# HILL EAST WATERFRONT - PARK KENNEDY

1900 MASSACHUSETTS AVENUE, SE | AKA 1901 C STREET, SE, WASHINGTON, DC 20003

2 BLOCKS FROM  
NEW RFK STADIUM  
DEVELOPMENT

JUST SIGNED -  
CAPITAL BAR & GRILL

SALA THAI

LAST SPACE AVAILABLE  
3,072 SF

266 NEW  
RESIDENTIAL UNITS

Alpha-Bet-A



STADIUM-ARMORY  
1,760 PPD

19TH STREET - 5,100 ADT

MASSACHUSETTS AVE - 5,300 ADT

MATT SKALET

maskalet@klnb.com | 202-420-7775

STEVE COMBS

scombs@klnb.com | 202-420-7776

klnb.com



## DEMOGRAPHICS | 2025:

10 MIN WALK	0.25-MILE	0.5-MILE	1-MILE
Population			
5,236	3,259	6,843	34,522
Daytime Population			
2,347	988	3,410	25,759
Average HH Income			
\$210,711	\$227,681	\$211,323	\$175,072
Median HH Income			
\$150,090	\$165,526	\$146,967	\$114,870

## METRO RIDERSHIP | 2025:



## RETAIL SPACE AVAILABLE

- Hill East Waterfront is a 60 plus acre multi-phased mixed use development.
- Park Kennedy is 266 unit apartment building which is over 95% occupied.
- Last Retail space available is 3,072 SF on Prime Corner.
- Can be vented for restaurant use and has huge outdoor seating area.
- Adjacent to Stadium/Armory Metro with approximately 1,760 riders per day.
- Easily accessible from I-295, Independence Avenue and East Capitol Street.

# SITE PLAN

# HILL EAST WATERFRONT - PARK KENNEDY

1900 MASSACHUSETTS AVENUE, SE | AKA 1901 C STREET, SE, WASHINGTON, DC 20003

PHASE 1  
NOW AVAILABLE

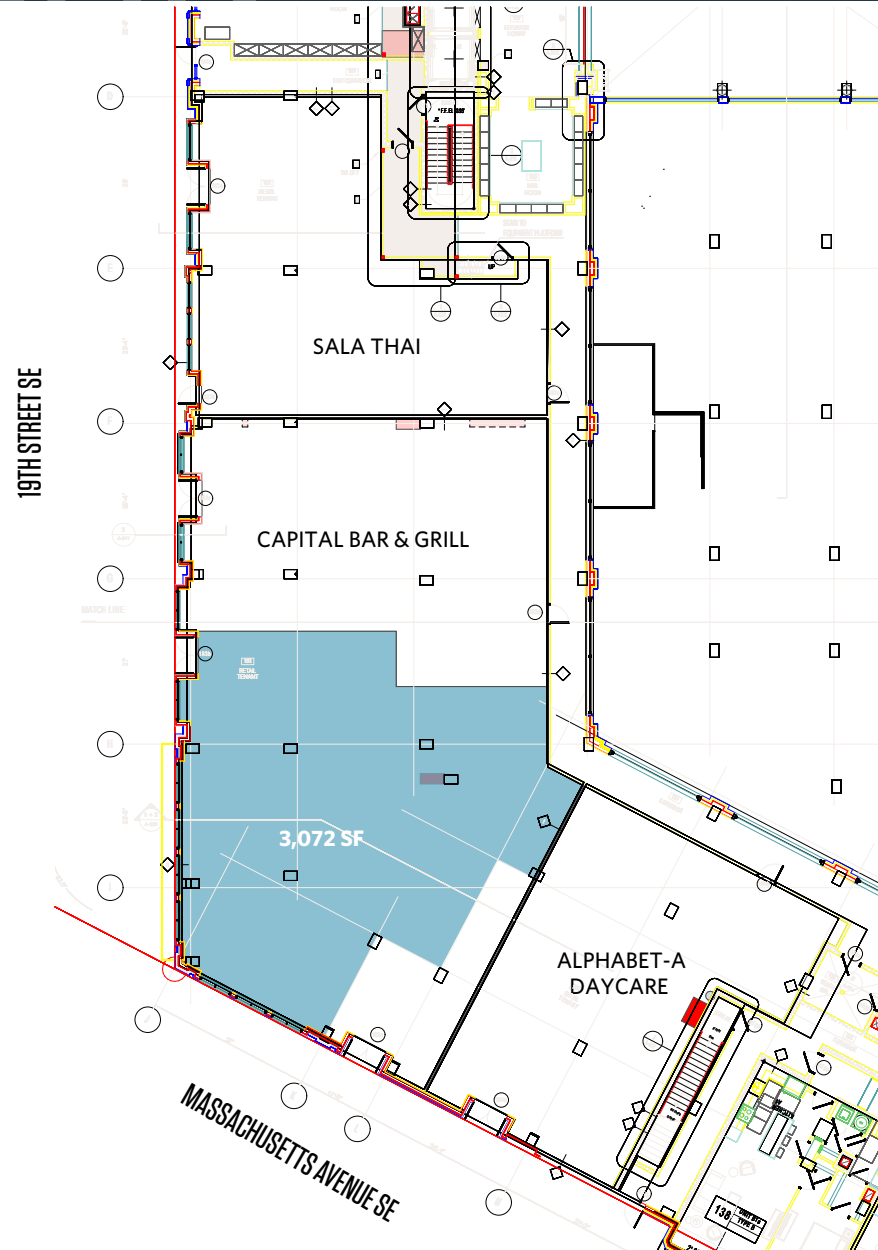

STADIUM-ARMORY  
1,760 PPD

MATT SKALET  
mskalet@klnb.com | 202-420-7775

STEVE COMBS  
scombs@klnb.com | 202-420-7776



# AERIAL

## HILL EAST WATERFRONT - PARK KENNEDY

1900 MASSACHUSETTS AVENUE, SE | AKA 1901 C STREET, SE, WASHINGTON, DC 20003

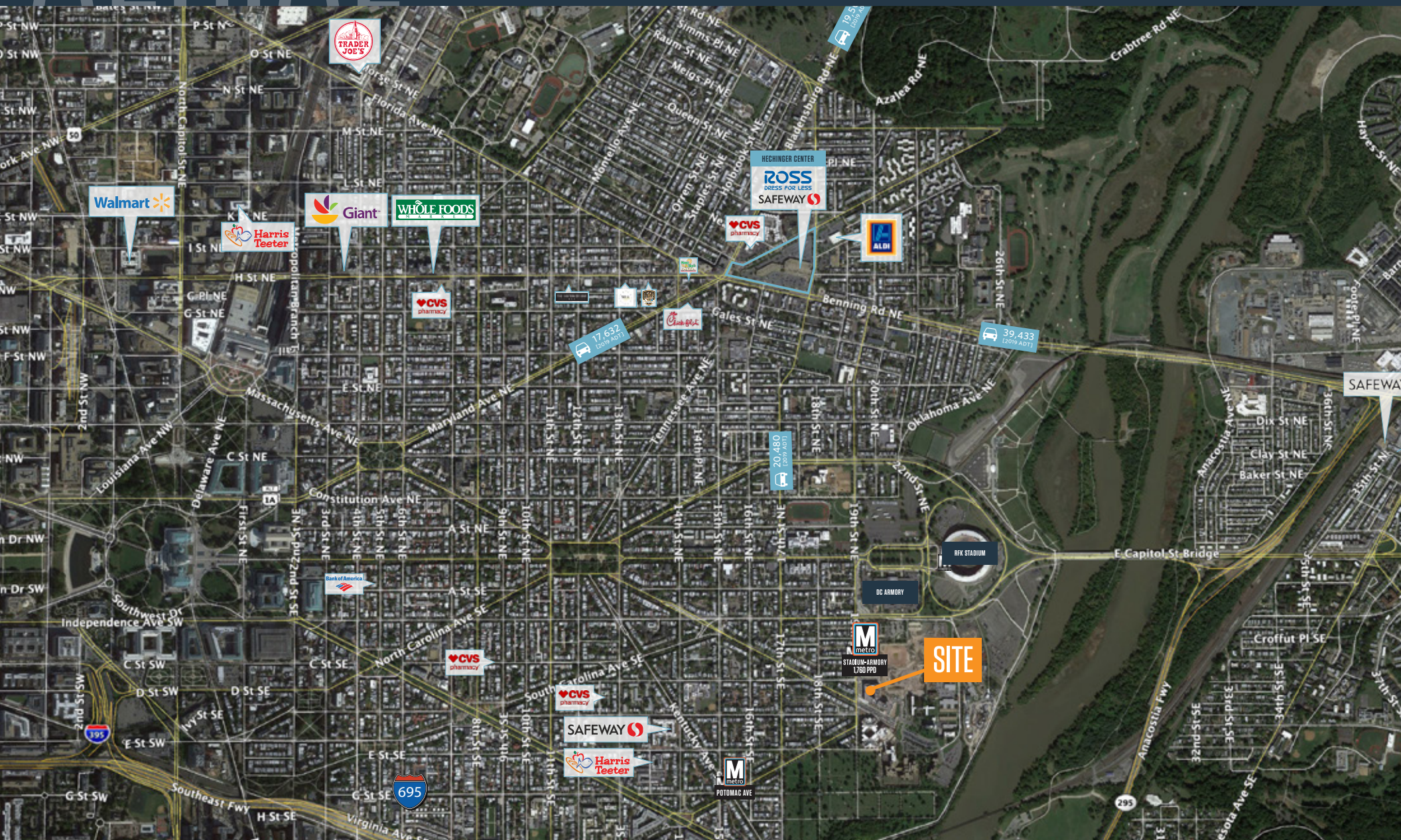

**MATT SKALET**

mkalet@klnb.com | 202-420-7775

**STEVE COMBS**

scombs@klnb.com | 202-420-7776

**klnb**

# AERIAL

## HILL EAST WATERFRONT - PARK KENNEDY

1900 MASSACHUSETTS AVENUE, SE | AKA 1901 C STREET, SE, WASHINGTON, DC 20003



**MATT SKALET**  
mskalet@klnb.com | 202-420-7775

**STEVE COMBS**  
scombs@klnb.com | 202-420-7776



## DEVELOPMENT PLAN

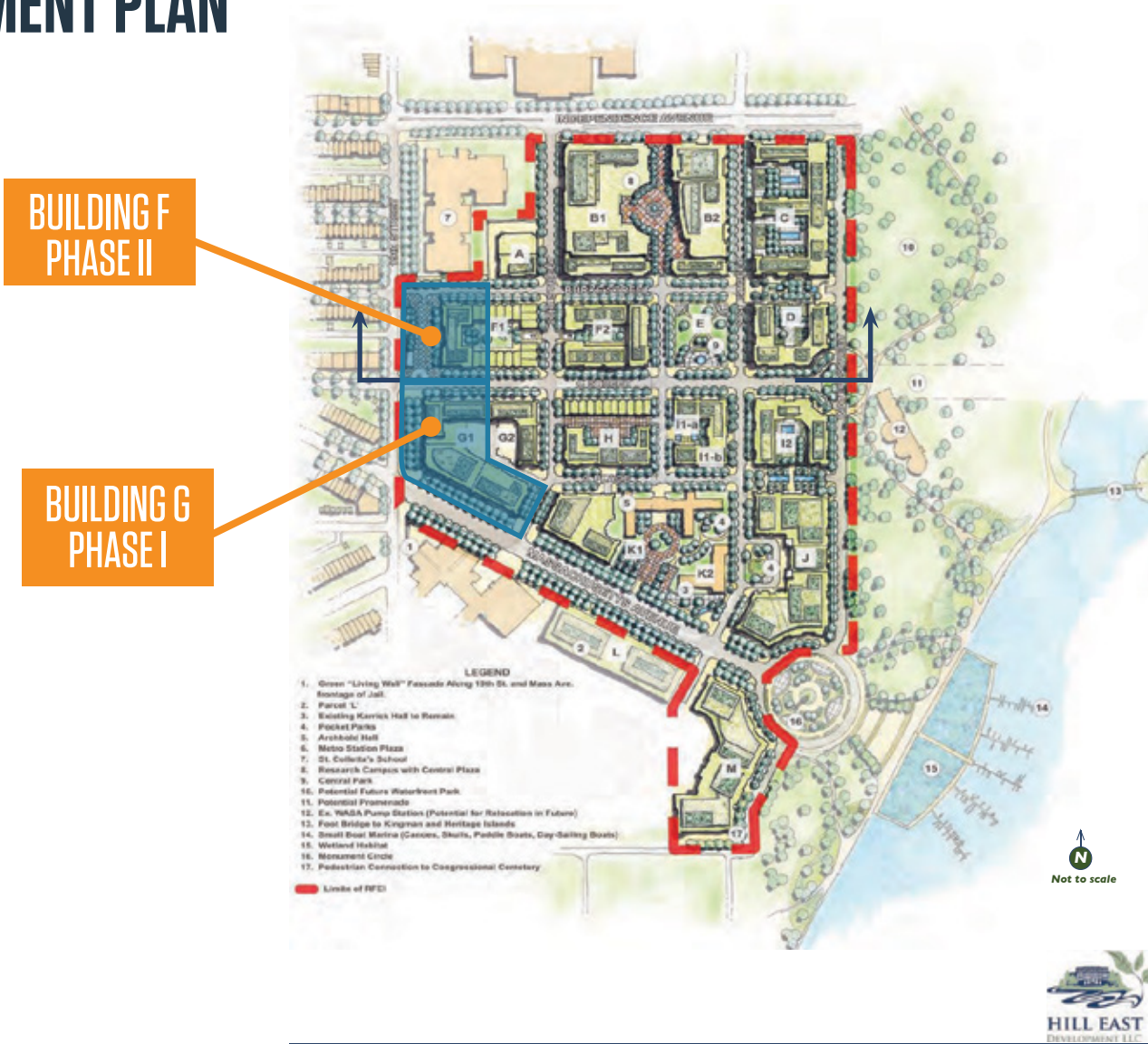

HillEast Waterfront Redevelopment

**MATT SKALET**

mkalet@klnb.com | 202-420-7775

**STEVE COMBS**

scombs@klnb.com | 202-420-7776



# RENDERINGS

## HILL EAST WATERFRONT - PARK KENNEDY

1900 MASSACHUSETTS AVENUE, SE | AKA 1901 C STREET, SE, WASHINGTON, DC 20003



**MATT SKALET**  
mskalet@klnb.com | 202-420-7775

**STEVE COMBS**  
scombs@klnb.com | 202-420-7776



# RENDERINGS

## HILL EAST WATERFRONT - PARK KENNEDY

1900 MASSACHUSETTS AVENUE, SE | AKA 1901 C STREET, SE, WASHINGTON, DC 20003



**MATT SKALET**

mksalet@klnb.com | 202-420-7775

**STEVE COMBS**

scombs@klnb.com | 202-420-7776

**klnb**



# HILL EAST WATERFRONT - PARK KENNEDY

1900 MASSACHUSETTS AVENUE, SE | AKA 1901 C STREET, SE , WASHINGTON, DC 20003

## FOR MORE INFORMATION, PLEASE CONTACT:

**MATT SKALET**

mkalet@klnb.com  
202-420-7775

**STEVE COMBS**

scombs@klnb.com  
202-420-7776

1130 Connecticut Ave, NW, Suite 600, Washington, DC 20036

.....  
**klnb.com**

 [facebook.com/KLNB](https://facebook.com/KLNB)

 [@KLNBLLC](https://twitter.com/KLNBLLC)

 [linkedin.com/company/klnb](https://linkedin.com/company/klnb)

 [instagram.com/klnbllc](https://instagram.com/klnbllc)

**CLICK TO VIEW PROPERTY WEBSITE**

While we have no reason to doubt the accuracy of any of the information supplied, we cannot, and do not, guarantee its accuracy. All information should be independently verified prior to a purchase or lease of the property. We are not responsible for errors, omissions, misuse, or misinterpretation of information contained herein and make no warranty of any kind, express or implied, with respect to the property or any other matters.