

750 9th Street NW

Washington, DC 20001

2ND GENERATION LARGE FORMAT
RESTAURANT AVAILABLE



CityCenterDC

Tatte BAKERY & CAFE

DelFrisco's DOUBLE EAGLE STEAKHOUSE

Seven REASONS

corepower YOGA

12,266 SF
AVAILABLE

WARBY PARKER

WAVANA
COFFEE, BAKERY, KITCHEN

H St





9th St NW

JENNIFER PRICE
202.420.7768
jprice@klnb.com

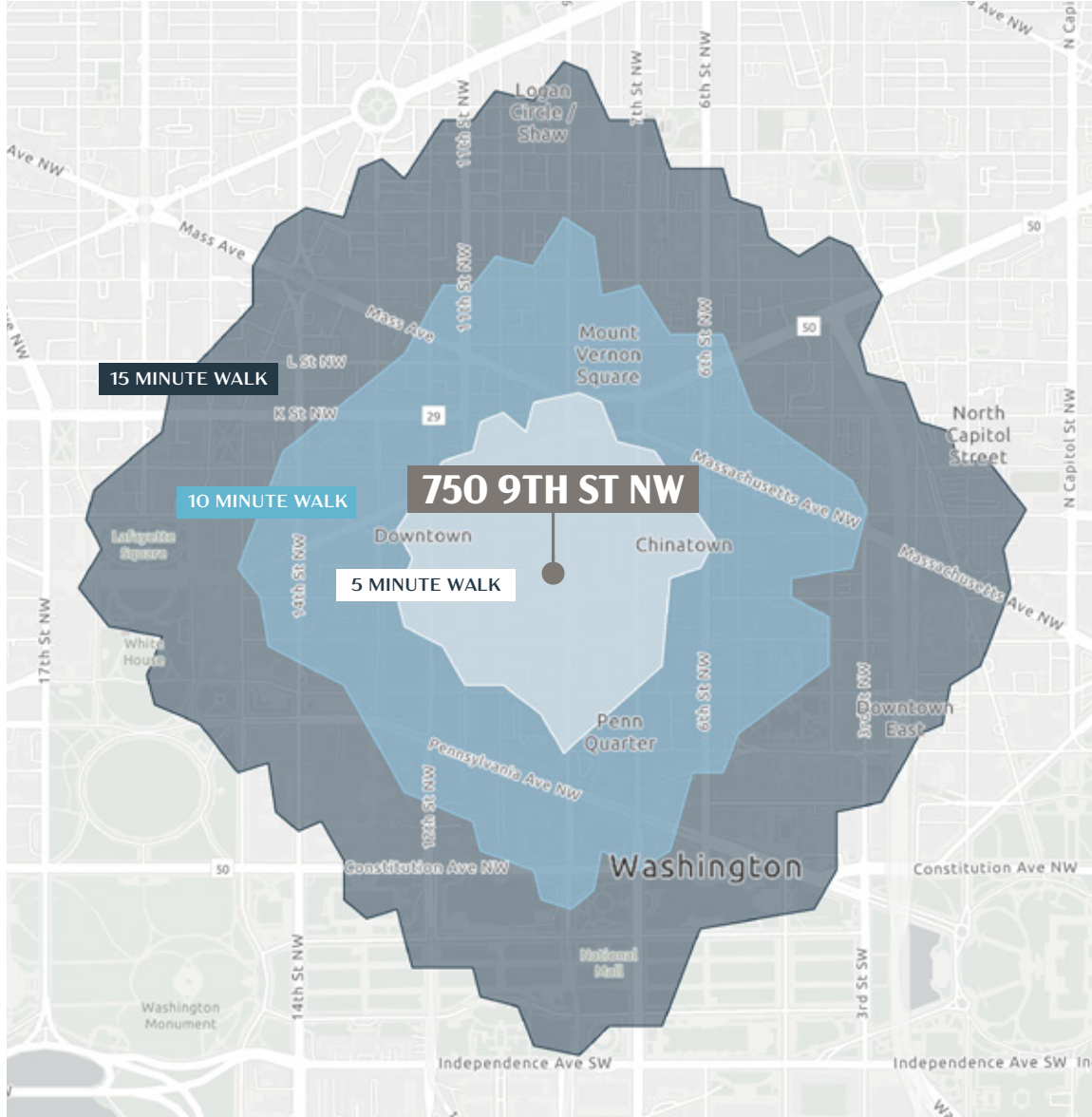
KIM STEIN
202.652.2338
kstein@klnb.com

TRADE AREA / DEMOGRAPHICS



	5 MIN WALK	10 MIN WALK	15 MIN WALK
 POPULATION	1,831	10,981	28,415
 DAYTIME POPULATION	27,400	98,382	173,211
 AVERAGE HOUSEHOLD INCOME	\$210,990	\$187,188	\$173,582
 HIGHER EDUCATION	84%	89%	82%
 HOUSEHOLDS	1,074	7,134	17,560

SITE PLAN

PRIVATE DINING ROOM WITH SERVER STATION AND RESTROOMS



OPEN KITCHEN

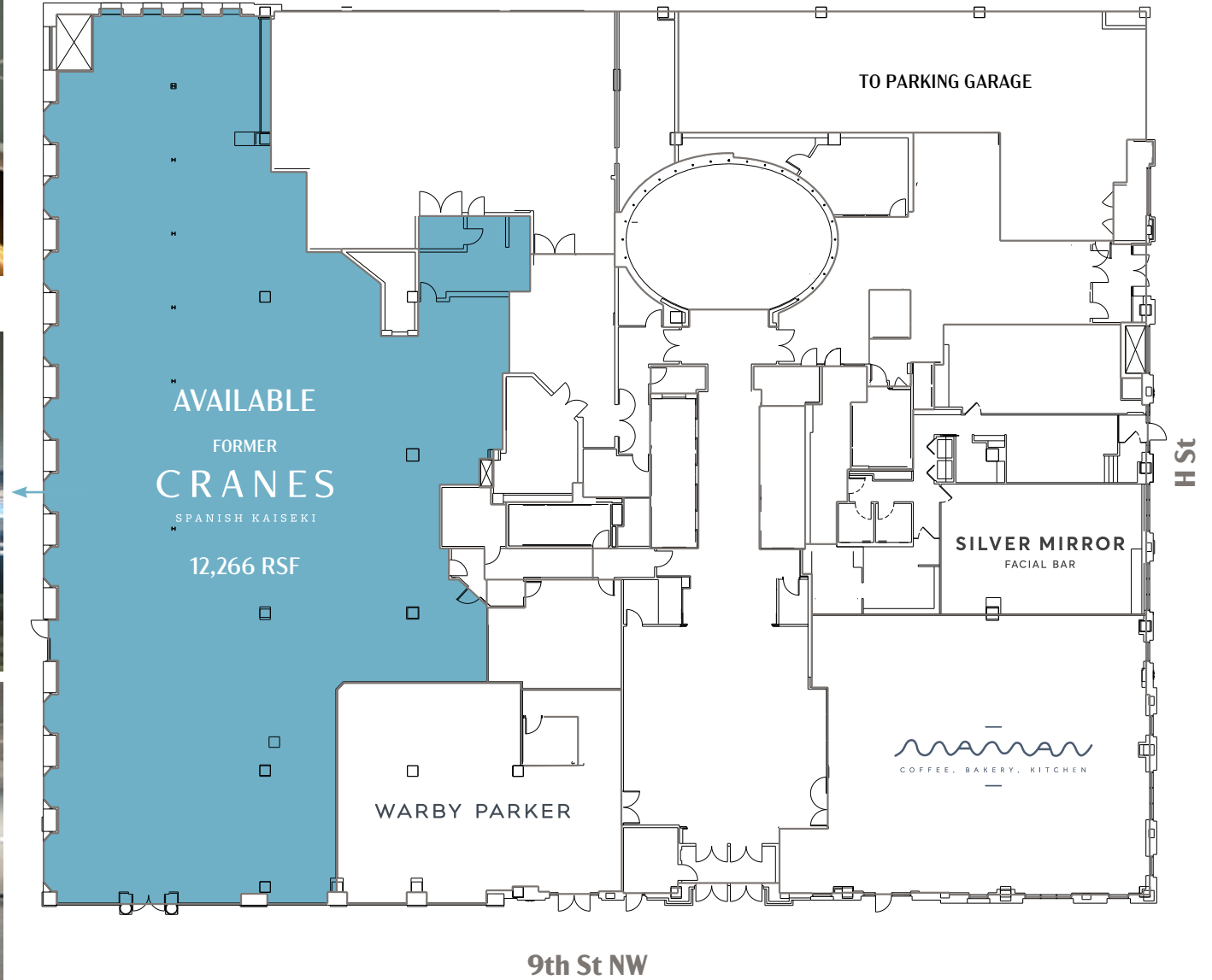

750 9th Street NW

750 9th St NW,
Washington, DC 20001

FOR INQUIRES CONTACT

JENNIFER PRICE | 202.420.7768 | jprice@klnb.com

KIM STEIN | 202.652.2338 | kstein@klnb.com