

# 2824-2828 DORR AVE

2824-2828 Dorr Avenue, Lee-Hi Industrial Park  
Merrifield, Virginia



## WAREHOUSE FOR LEASE

### AVAILABILITY:

*Suite B: 1,243 SF*

- Open Warehouse
- One (1) Drive In Door
- Available Immediately

### PROPERTY HIGHLIGHTS:

- Estimated OPEX: \$5.24 PSF
- Conveniently located within walking distance to the Dunn Loring-Merrifield Metro in the heart of Merrifield.
- Close to I-495, I-66 and Route 50 with exposure on Dorr Ave.
- Restaurants, Retail, & Hotels within walking distance.
- Parking Ratio: 1/1,000 SF.
- Approximate 16' Clear.
- FIOS, Cox, & Xfinity internet available

**Ryan Moody**  
rmoody@klnb.com  
703-268-2739

**Keenan Woofter**  
kwoofter@klnb.com  
703-268-2744

8065 Leesburg Pike, Suite 700  
Tysons, VA 22182  
**klnb.com**



# 2824-2828 DORR AVE

2824-2828 Dorr Avenue, Lee-Hi Industrial Park  
Merrifield, Virginia

SUITE B: 1,243 SF

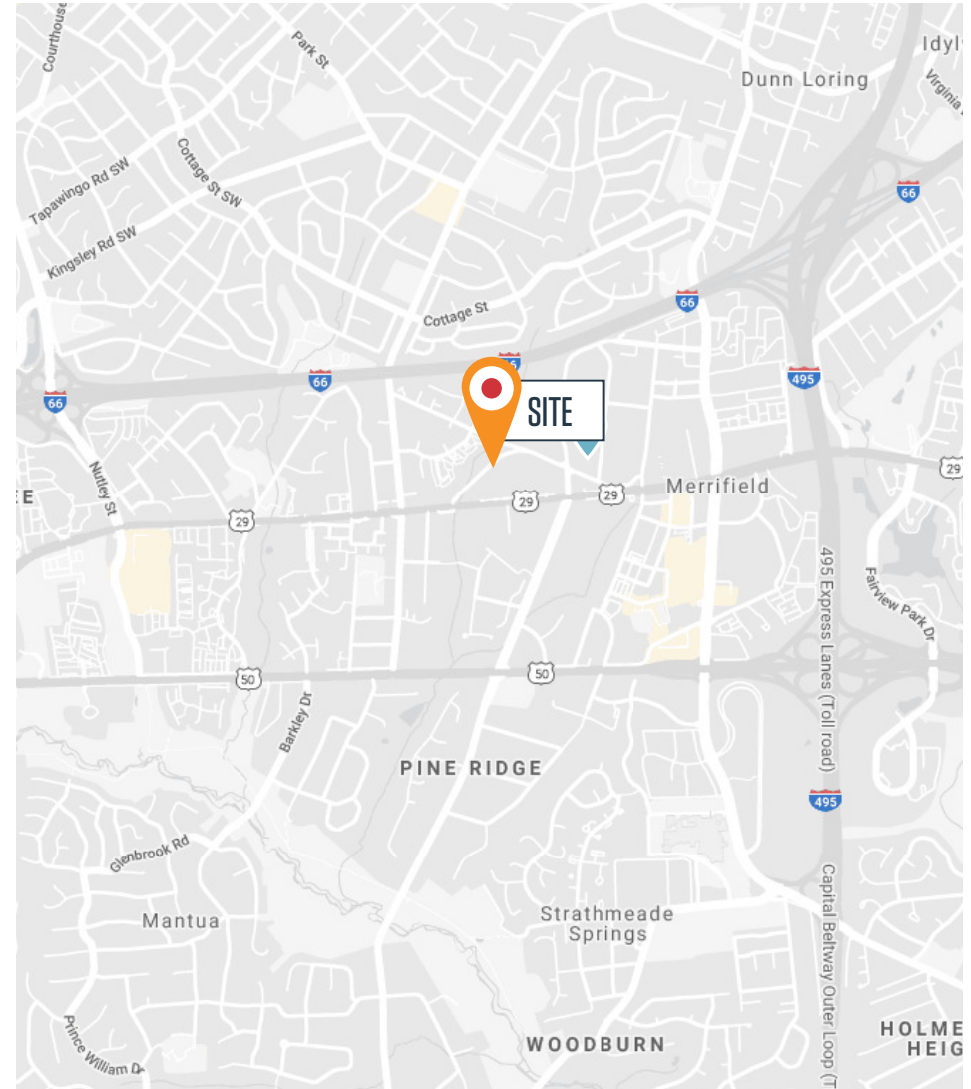
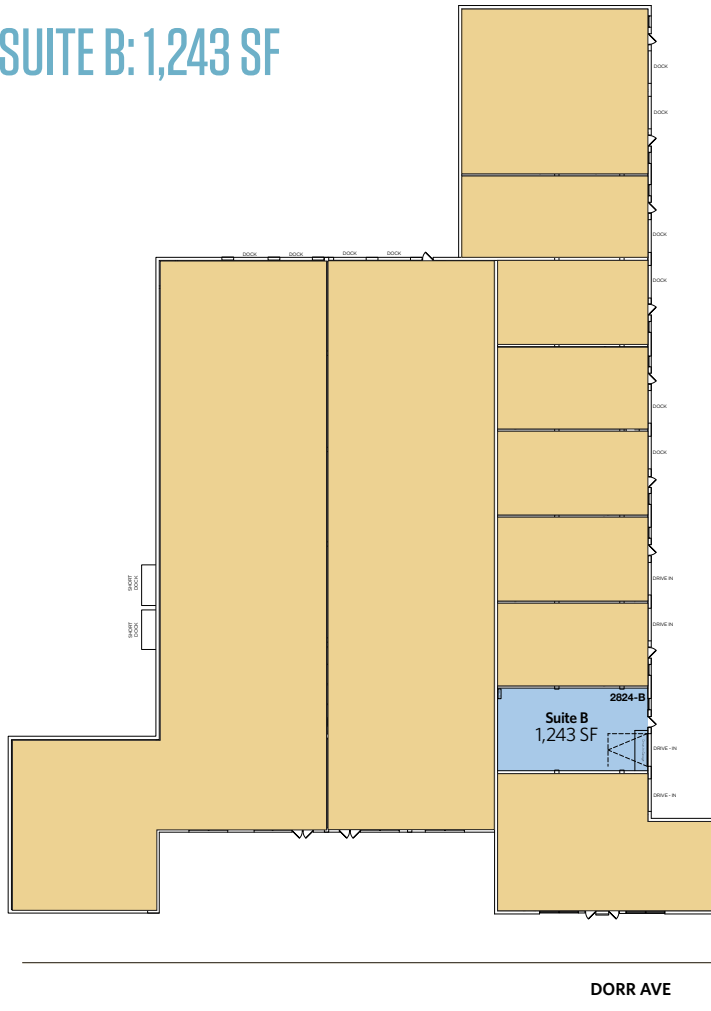

## FLOOR PLAN

[VISIT PROPERTY WEBSITE](#)

 [facebook.com/KLNBCRE](https://facebook.com/KLNBCRE)

 [linkedin.com/company/klnb](https://linkedin.com/company/klnb)

 [instagram.com/klnbcre](https://instagram.com/klnbcre)

While we have no reason to doubt the accuracy of any of the information supplied, we cannot, and do not, guarantee its accuracy. All information should be independently verified prior to a purchase or lease of the property. We are not responsible for errors, omissions, misuse, or misinterpretation of information contained herein and make no warranty of any kind, express or implied, with respect to the property or any other matters.