

PIKESVILLE TOWN CENTER

1206-1220 Reisterstown Road, Pikesville, MD 21208
Baltimore County



NEARBY CO-TENANTS



FIRST WATCH



DUNKIN'

RETAIL FOR LEASE

- Available: 2,735 SF & 1,044 SF
- Highly visible retail endcap space available along Reisterstown Rd (23,225 ADT)
- Space fronts lighted intersection at Sudbrook Ln (4,480 ADT)
- Project includes 22 surface parking spaces

LEASED BY:

klnb

Amanda DeVinney
adevinney@klnb.com
443-632-2045

Brian Finkelstein
bfinkelstein@klnb.com
443-632-2076

Joe Mekulski
jmekulski@klnb.com
443-632-1343

100 West Road, Suite 505, Towson, MD 21204
klnb.com

PIKESVILLE TOWN CENTER

1206-1220 Reisterstown Road, Pikesville, MD 21208
Baltimore County

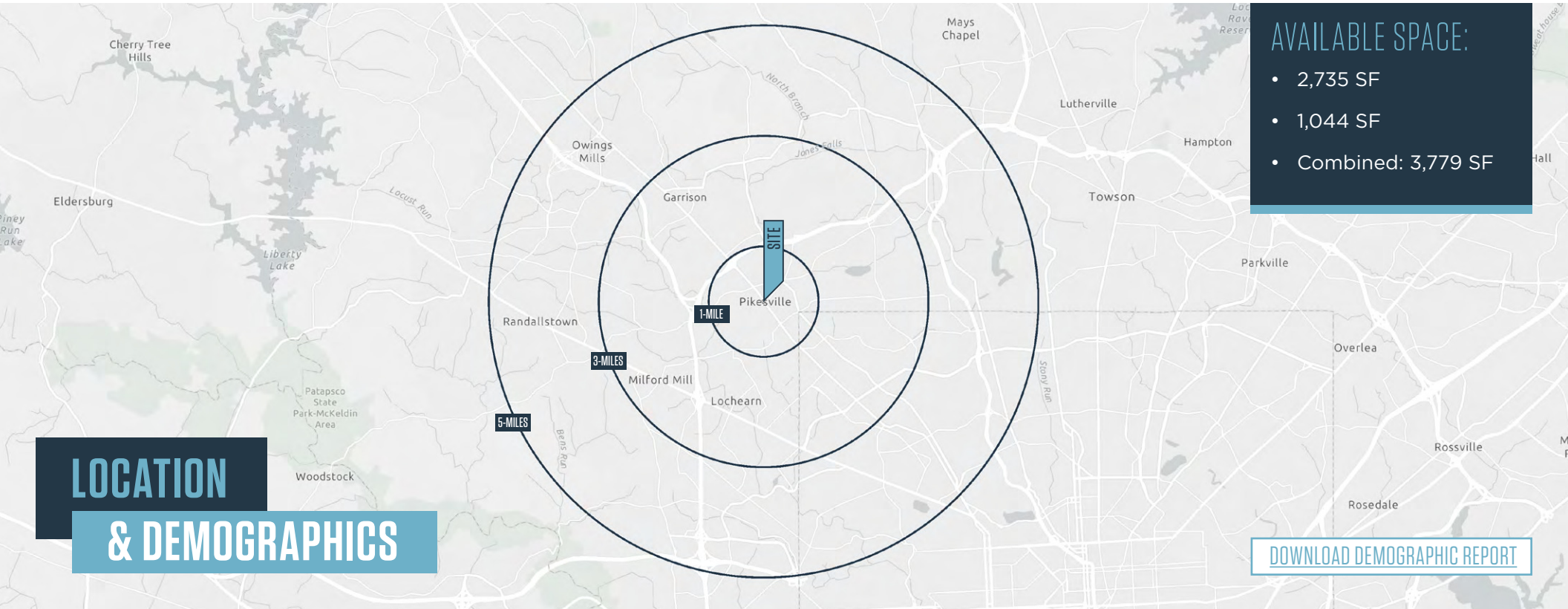

AVAILABLE SPACE:

- 2,735 SF
- 1,044 SF
- Combined: 3,779 SF

LOCATION & DEMOGRAPHICS

[DOWNLOAD DEMOGRAPHIC REPORT](#)

TRAFFIC COUNTS | 2024

Reisterstown Road	23,225 ADT
Sudbrook Lane	4,480 ADT
I-695	175,003 ADT

	1-MILE	3-MILES	5-MILES				
	Population	10,526	116,899	267,023		Households	
					4,733	47,626	109,543
	Daytime Population	14,935	110,179	272,518		Average Household Income	
					\$101,178	\$108,923	\$107,999

Amanda DeVinney
adevinney@klnb.com
443-632-2045

Brian Finkelstein
bfinkelstein@klnb.com
443-632-2076

Joe Mekulski
jmekulski@klnb.com
443-632-1343

100 West Road, Suite 505
Towson, MD 21204
klnb.com



PIKESVILLE TOWN CENTER

1206-1220 Reisterstown Road, Pikesville, MD 21208
Baltimore County

MARKET AERIAL



Amanda DeVinney
adevinney@klnb.com
443-632-2045

Brian Finkelstein
bfinkelstein@klnb.com
443-632-2076

Joe Mekulski
jmekulski@klnb.com
443-632-1343

100 West Road, Suite 505
Towson, MD 21204
klnb.com



PIKESVILLE TOWN CENTER

1206-1220 Reisterstown Road, Pikesville, MD 21208
Baltimore County

CLOSE-UP AERIAL

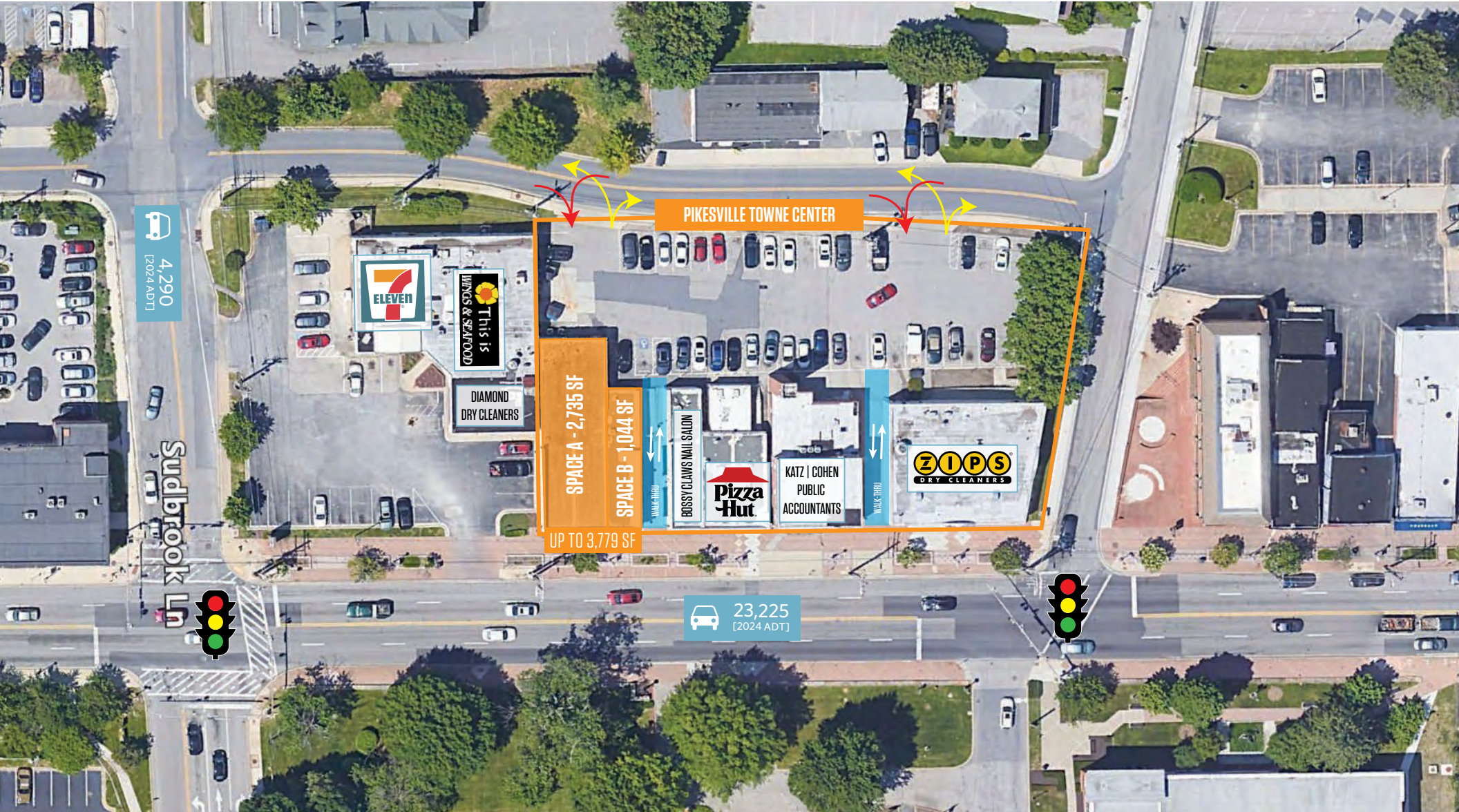

Amanda DeVinney
adevinney@klnb.com
443-632-2045

Brian Finkelstein
bfinkelstein@klnb.com
443-632-2076

Joe Mekulski
jmekulski@klnb.com
443-632-1343

100 West Road, Suite 505
Towson, MD 21204
klnb.com



PIKESVILLE TOWN CENTER

1206-1220 Reisterstown Road, Pikesville, MD 21208
Baltimore County

SITE PLAN

SPACE A - 2,735 SF

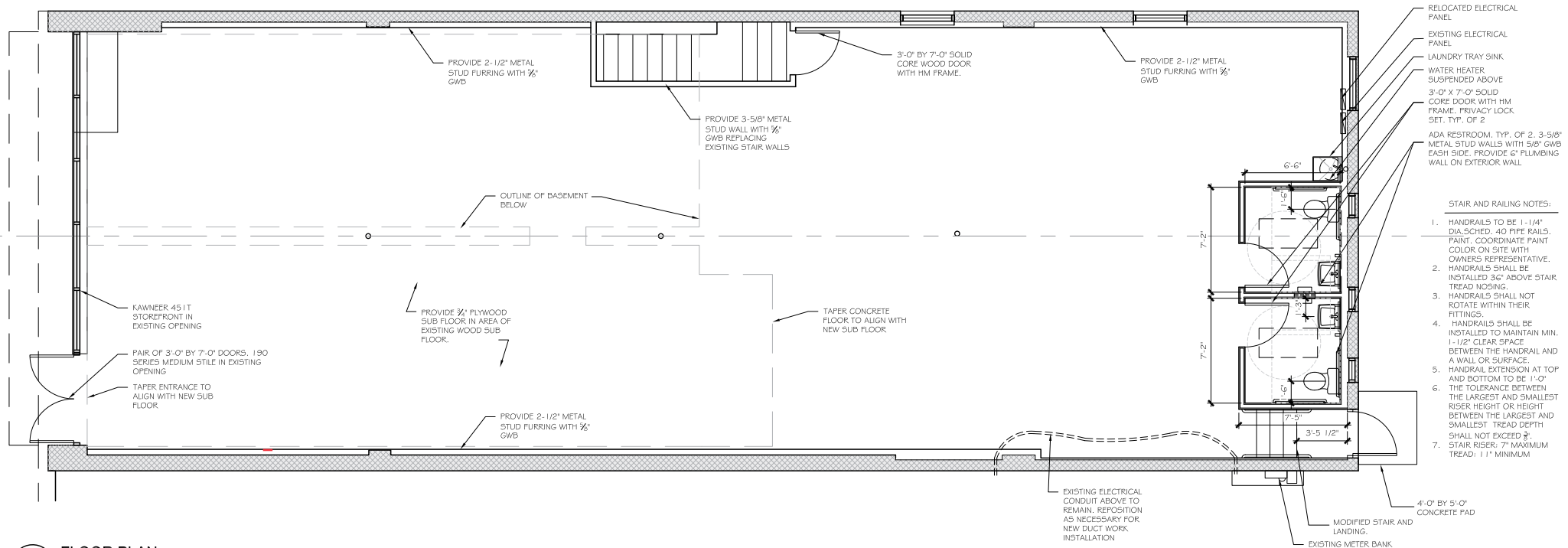

A1 FLOOR PLAN
SCALE: 1/4" = 1'-0"

PIKESVILLE TOWN CENTER

1206-1220 Reisterstown Road, Pikesville, MD 21208
Baltimore County

PHOTOS



Amanda DeVinney
adevinney@klnb.com
443-632-2045

Brian Finkelstein
bfinkelstein@klnb.com
443-632-2076

Joe Mekulski
jmekulski@klnb.com
443-632-1343

100 West Road, Suite 505
Towson, MD 21204
klnb.com

klnb

PIKESVILLE TOWN CENTER

1206-1220 Reisterstown Road, Pikesville, MD 21208

Baltimore County

[CLICK TO VIEW PROPERTY WEBSITE](#)

For More Information, Please Contact:

Amanda DeVinney
adevinney@klnb.com
443-632-2045

Brian Finkelstein
bfinkelstein@klnb.com
443-632-2076

Joe Mekulski
jmekulski@klnb.com
443-632-1343



While we have no reason to doubt the accuracy of any of the information supplied, we cannot, and do not, guarantee its accuracy. All information should be independently verified prior to a purchase or lease of the property. We are not responsible for errors, omissions, misuse, or misinterpretation of information contained herein and make no warranty of any kind, express or implied, with respect to the property or any other matters.

100 West Road, Suite 505
Towson, MD 21204
klnb.com

